

CYCLONE[®]

HD SERIES • DEEP CYCLE

TECHNICAL DATA SHEET

C8V170



SPECIFICATIONS

Part number	C8V170
BCI Group	GC8
Volt	8V
Type	Wet acid, Deep Cycle
Capacity @20HR	170AH
Reserve capacity	315 min. @25 amp.
Terminal type	M8
Container material	Polypropylene

DIMENSIONS

Length	10 1/4" (260 mm)
Width	7 1/8" (181 mm)
Case Height	9 3/4" (248 mm)
Overall Height	11" (279 mm)
Weight	64.4 lbs (29,2 Kg)

Data for information purpose only

DRAWING

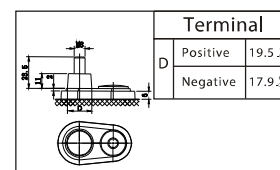
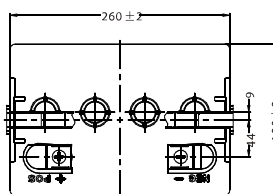
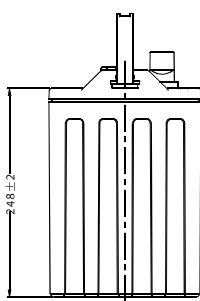
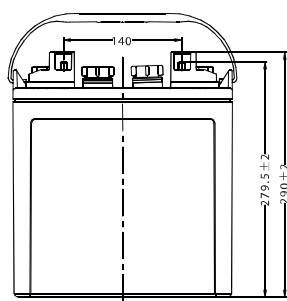

Charging Characteristics (25°C, 77°F)

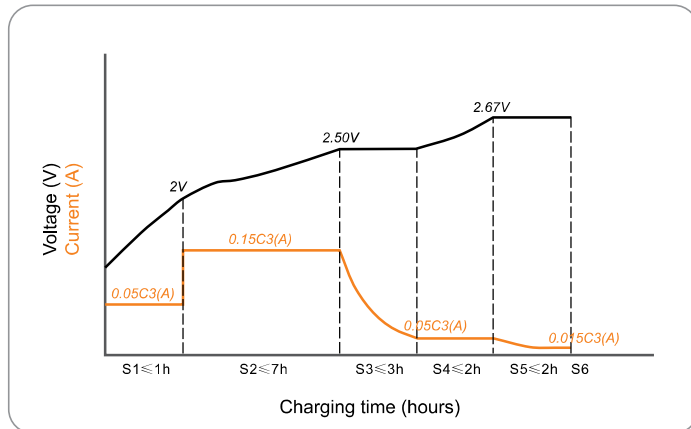

Cycle life in relation to depth of discharge

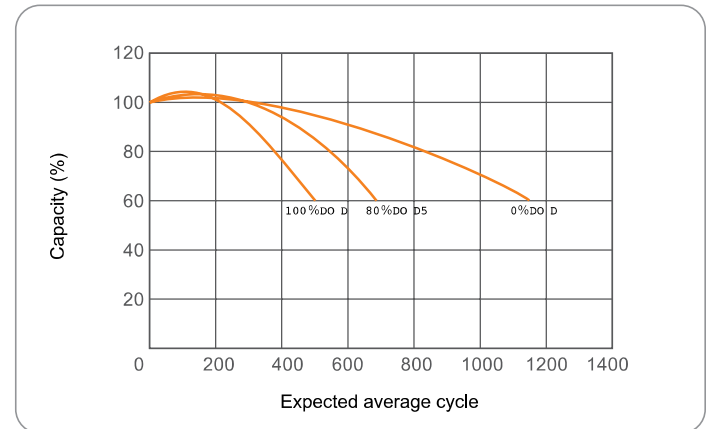

Relationship of OCV and SOC (25°C, 77°F)

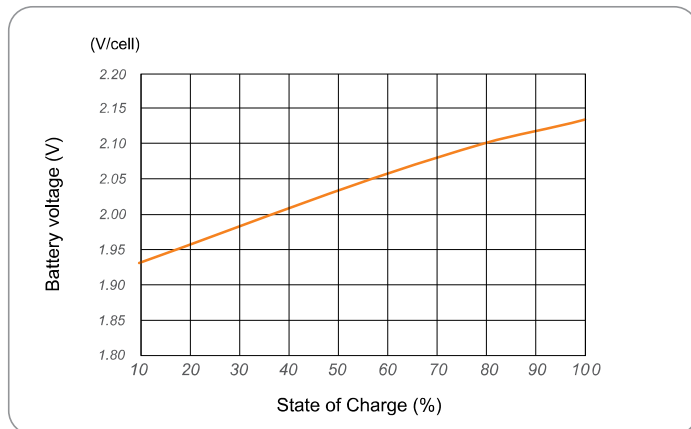

Temperature effects on capacity

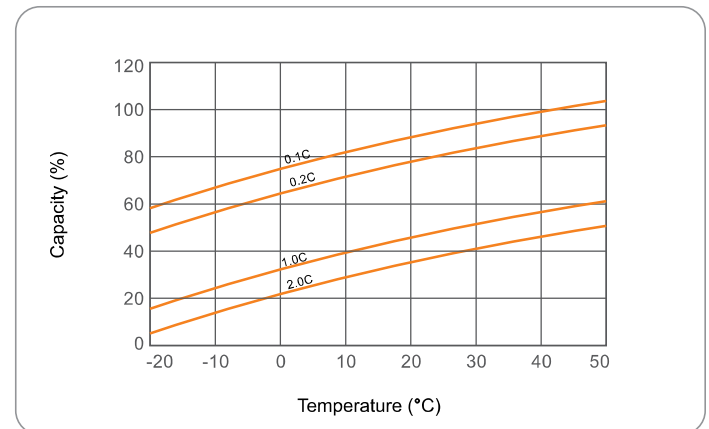

CHARGE METHOD

Initial Charge:

- 0.1C₂₀(A) charging 15h
- 0.05C₂₀(A) charging 10h

The temperature of the battery should be below 50°C during charging.

Float Voltage:

- 2.25V/cell, 9.0V

Equalizing Charge:

- 10.8V

Supplement Charge:

- Charging at a constant voltage of 7.35~7.5V/cell and a limited current 0.25C₂₀(A) until the electrolyte density up to 1.280g/cm³ (30°C) and the current not change for 3 hours.
- Charge with constant current 0.1C₂₀(A) until the voltage between 7.8~8.4V/cell, and voltage maintains for 3 hours and not change.

Two method optional.

RECYCLING

- 99% recyclable