



CHC WiFi Network Onboarding Guide

Connecting Your Device to the CHC WiFi

Contents

1. Windows 11	2
2. Android Phone	7
3. MacOS – Apple Computers.....	11
4. IOS - iPhone.....	17

For all devices:

**You will need your CHC Network Username (e.g. s123456)
and Password.**

Windows 11

1. Click the network icon in the taskbar (bottom-right corner). In Windows 11, this is found in the system tray and displays available WiFi networks.

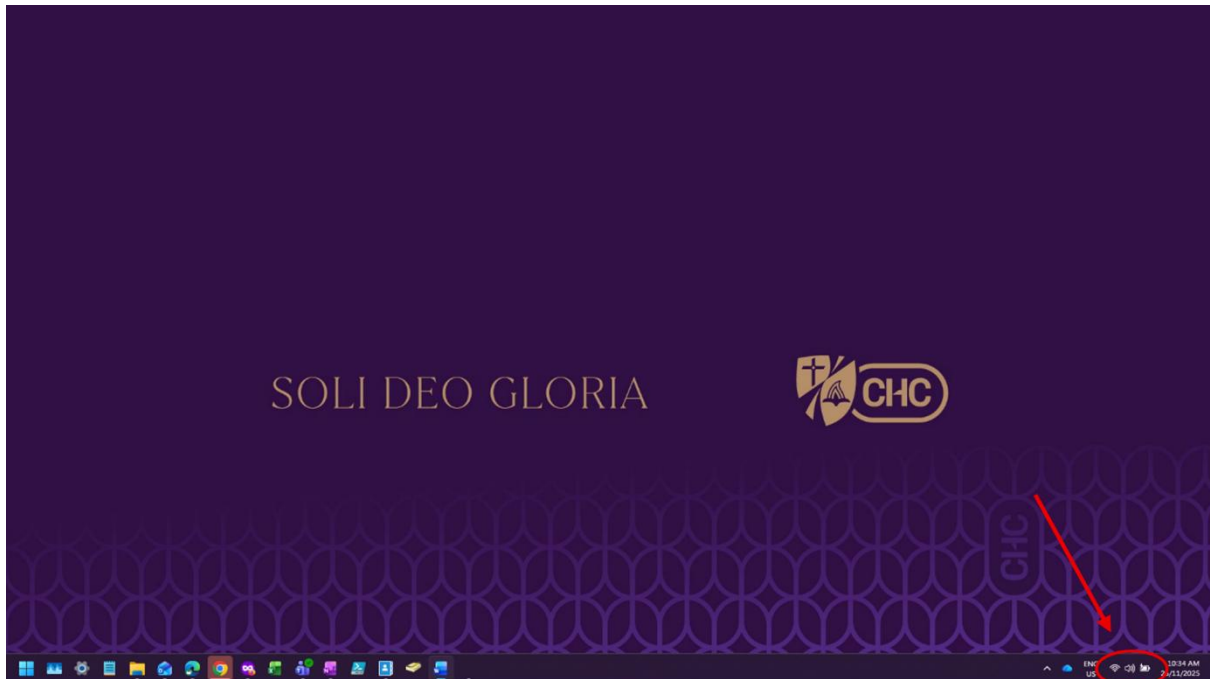

2. Turn on Wi-Fi if it's off. Select CHC_Guest from the list of networks and click Connect.

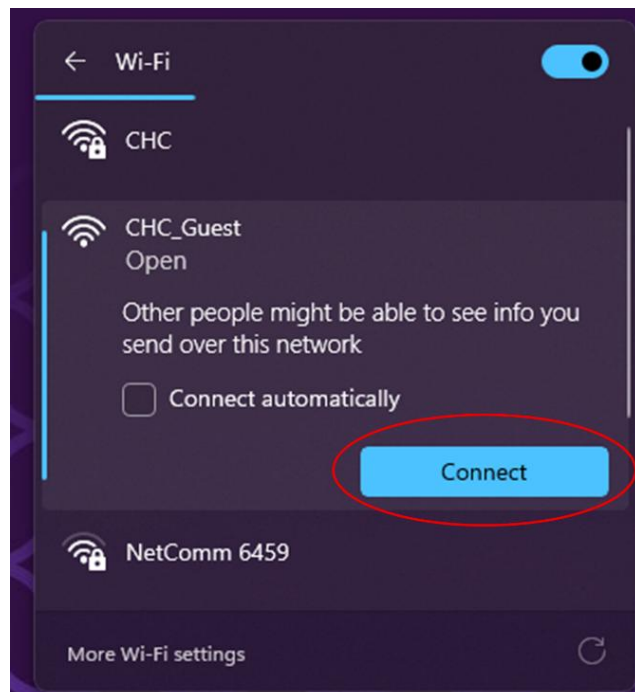

3. Open your preferred web browser (Microsoft Edge, Firefox or Chrome) and go to:
<https://chc.edu.au/student/hub>

- From the Student Portal, scroll down to the second student links section and click the “WiFi Guest Portal” Icon in the bottom Right.

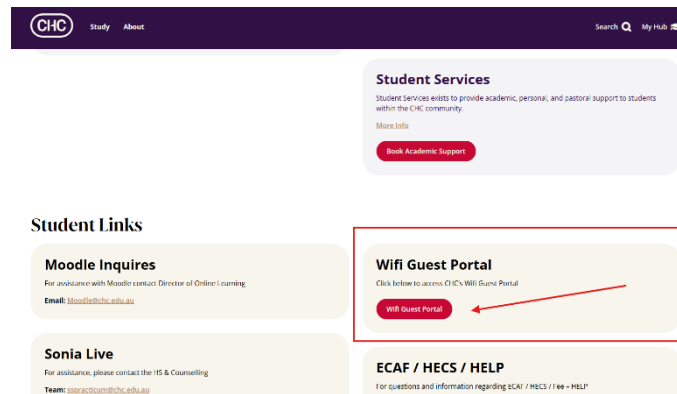

- *IMPORTANT*** On the page that pops up click the “OnBoard your device here” that is in orange text.



- Enter your Username and Password in the credential boxes on the next screen. You will only need your:
 - Student number (e.g. s123456)
 - Password



7. The Following Dialogue Box will show. Click “Start QuickConnect”

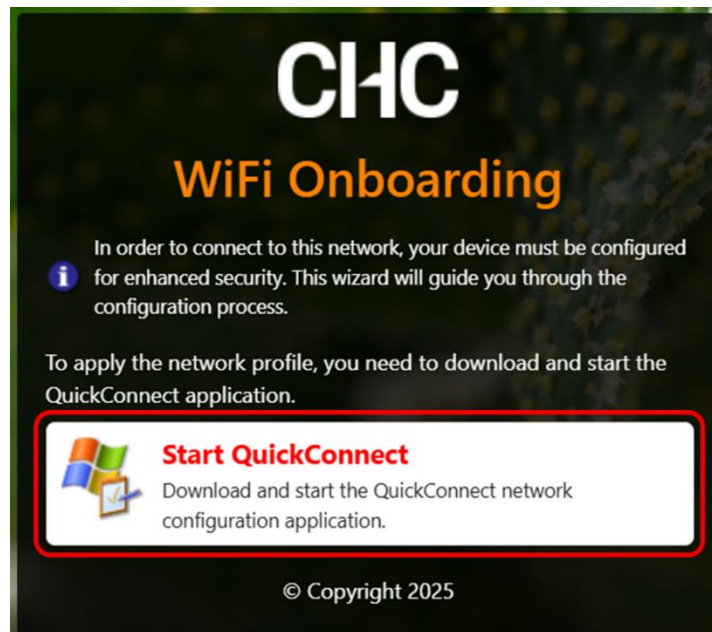

8. The Onboarding Wizard will begin Downloading. After it has downloaded click on the “ArubaQuickConnect.exe” file to open it
- a) You may be prompted by Microsoft Defender that “SmartScreen was not able to scan ArubaQuickConnect.exe”. If so, select the three dots and then select “Keep”

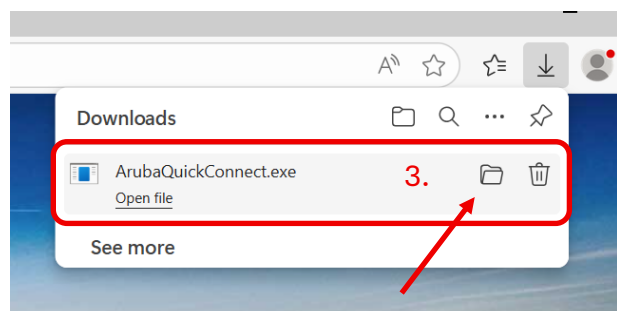
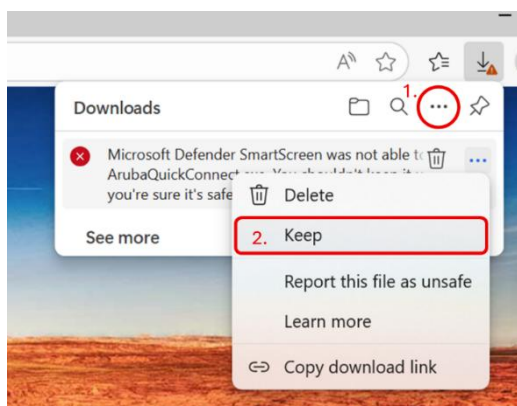
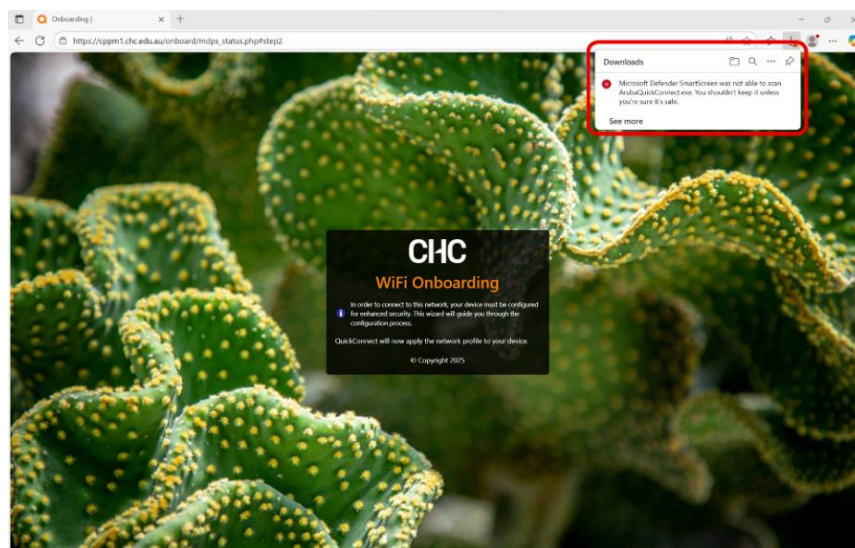

9. You will be prompted by the following pop up from SmartScreen, Click Run.

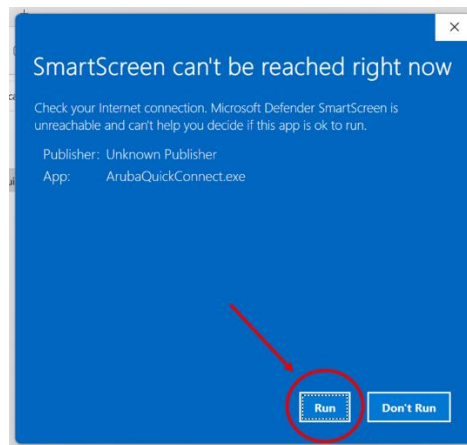

10. The Aruba Wizard will begin Running, Click Next to progress through the Wizard.

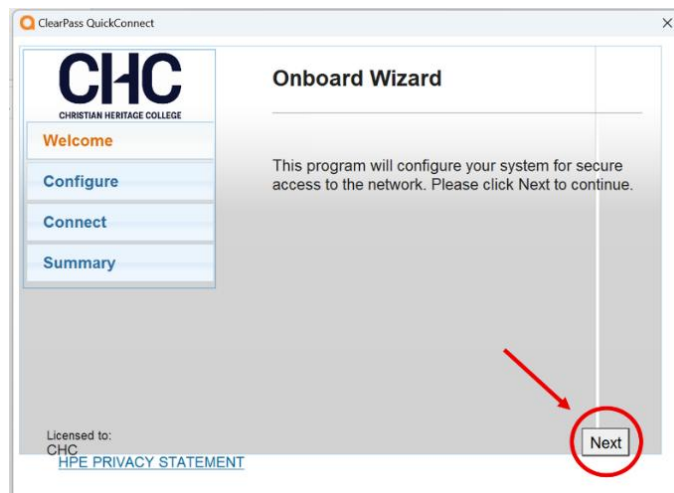

a) When Prompted, Click Yes to accept the CHC Root CA Certificate

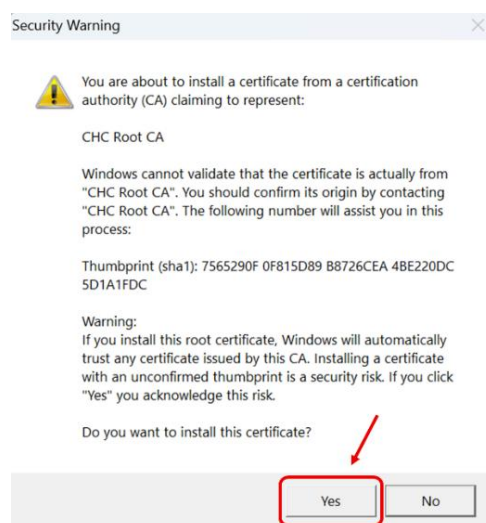

b) After this you will be prompted to “Connect”, when this is completed, click close

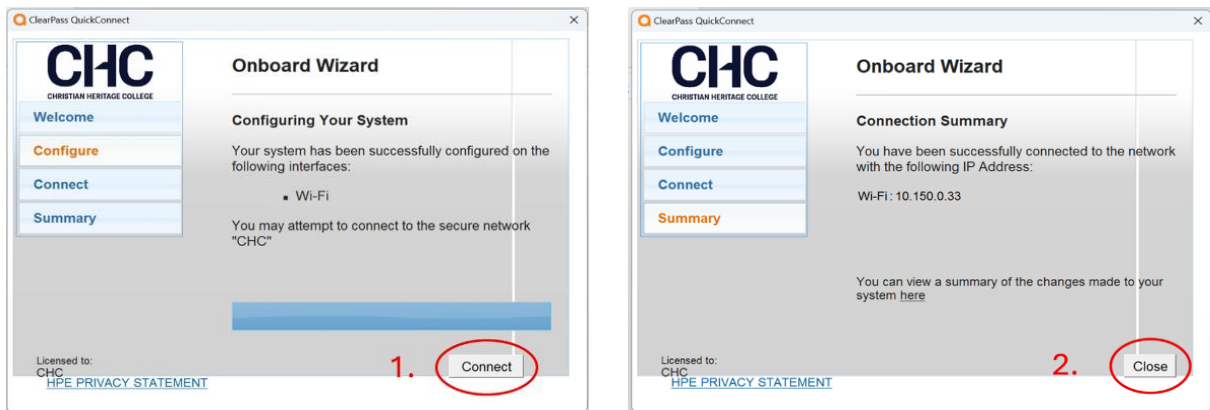

11. You will now be connected to the CHC network. Confirm this by clicking on the network icon in the taskbar and click the arrow to show available networks.

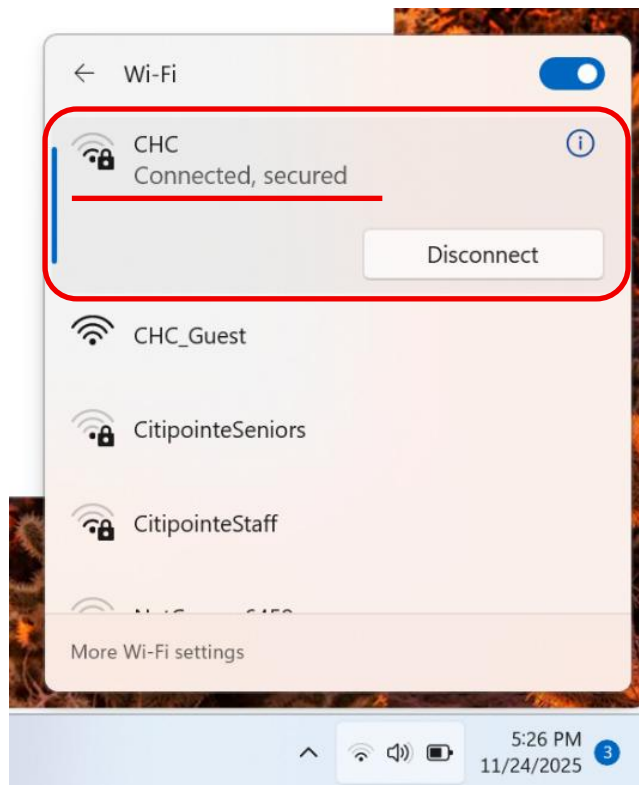

Android Phone

1. Install **ClearPass QuickConnect** from the Playstore.

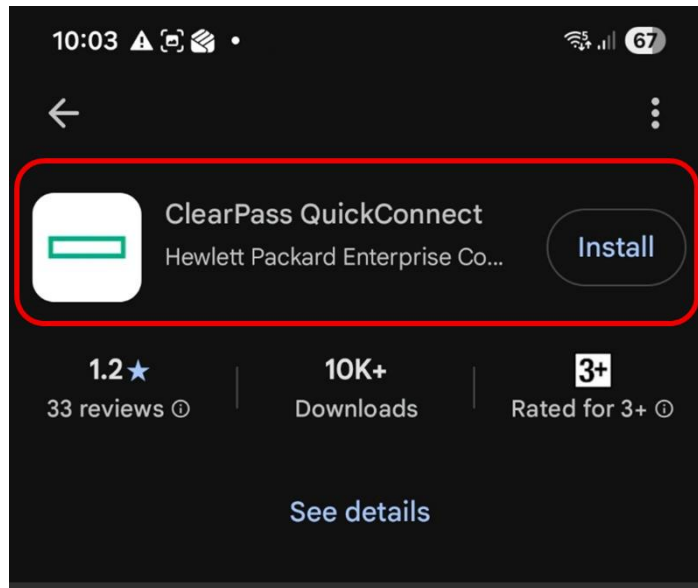

2. Open the App and Click **Continue** > **Allow** each of the **Permissions** > Click **OK**.

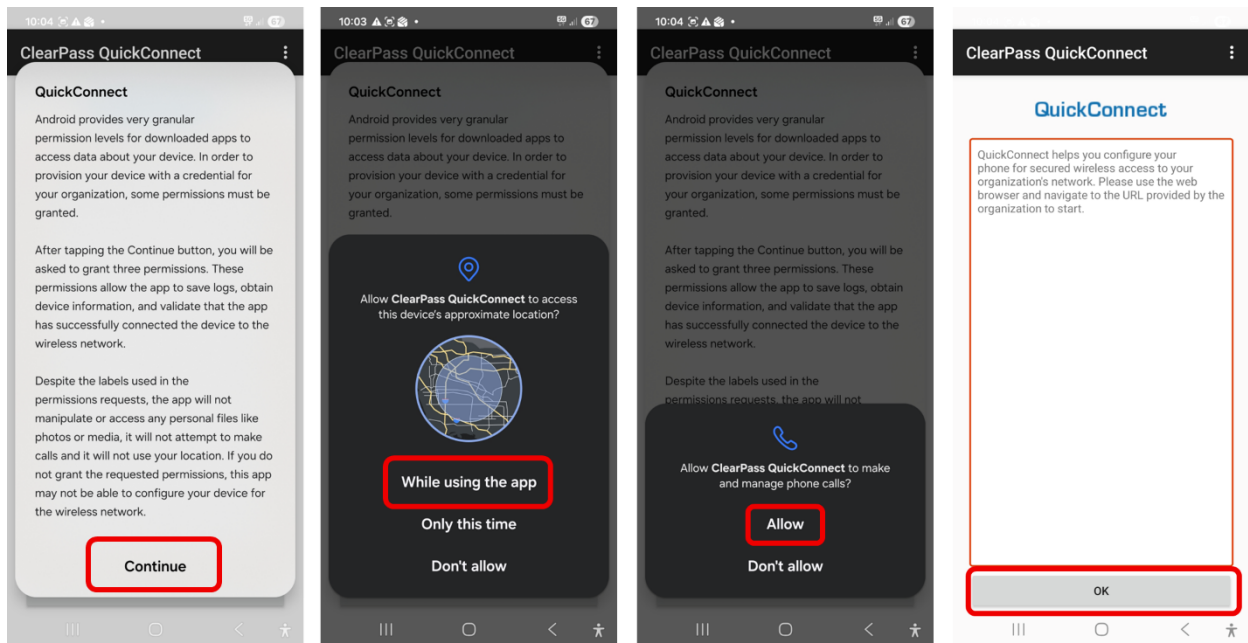

3. Go to **Settings > Connections > WiFi** on your mobile. **Connect** to the **CHC_Guest** Network

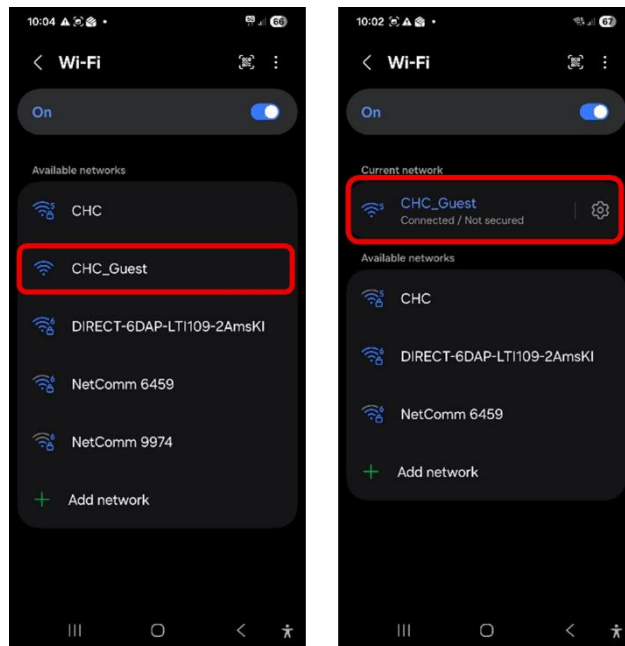

4. Open your internet browser (e.g. Chrome) and go to the **CHC website** <https://chc.edu.au>, then click on the **MyHub** link.
 - a. Scroll Down and click on the **WiFi Guest Portal**

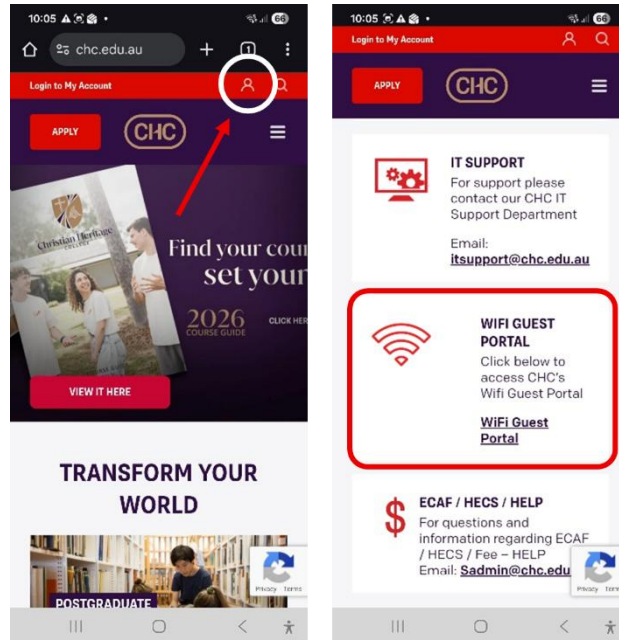

5. ***IMPORTANT*** Click on the “**Onboard your device here**” Text.
 - a. Then on the next screen insert your username and password

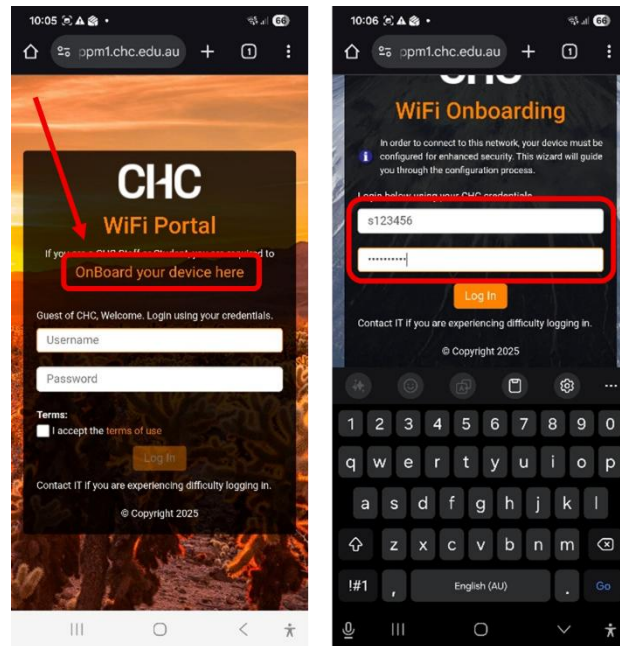

6. You will be prompted to install **QuickConnect**, click on the “I have already installed QuickConnect” text.
 - a. On the next screen **click** on the “Install Network Profile”.
 - b. **Open** the File that was downloaded.

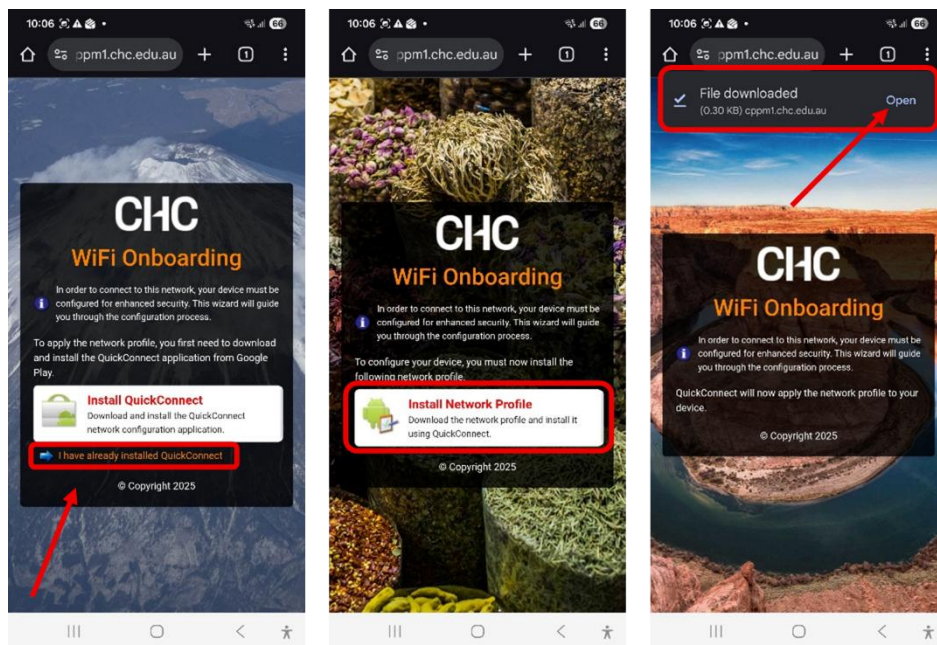

7. Open the ClearPass App (this should happen automatically), You will be prompted to “Allow suggested Networks” Click Allow.
 - a. On the Following Screen, Click “OK”
 - b. You should then be redirected back to the web browser with the notification the “WiFi Onboarding device provisioning Complete”

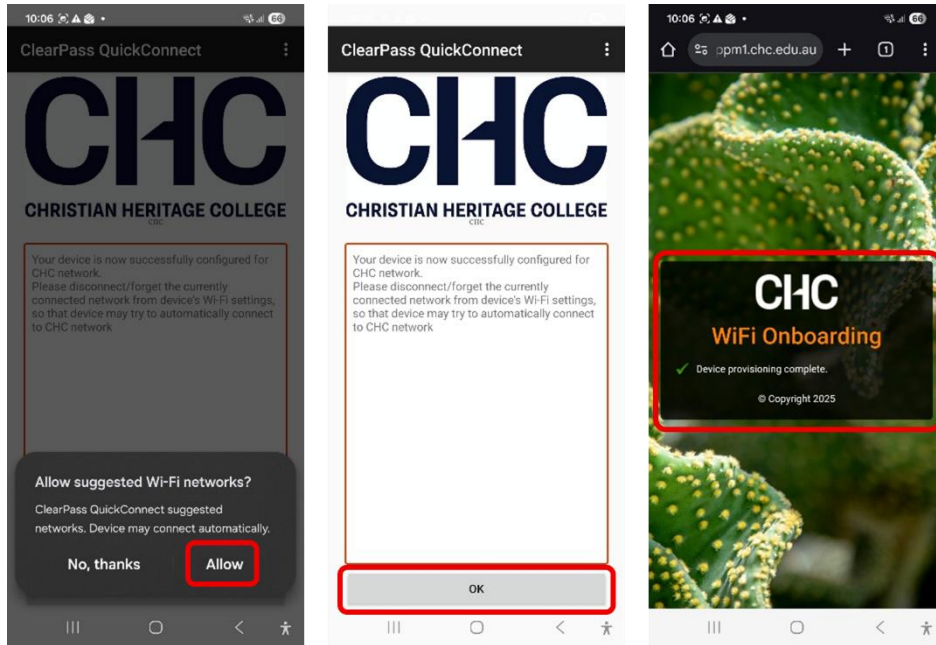

8. To Complete the Process, Go back to your WiFi Connections Page and **Connect** to the main CHC network.
 - a. After this, to ensure correct automatic connection, **Press and Hold** the guest network connection, then click “**Forget Network**”

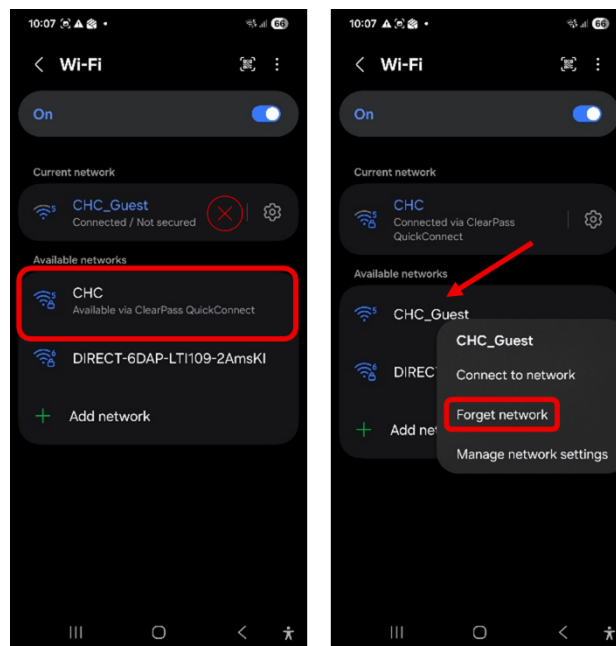

MacOS – Apple Computers

1. From the available WiFi networks, select **CHC_Guest**.

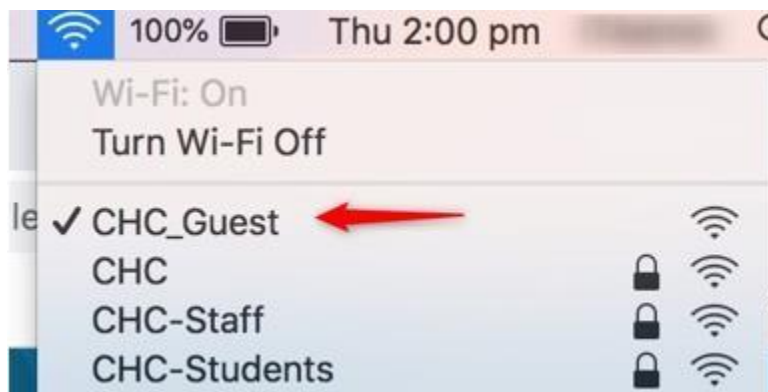

2. Open your browser (e.g. Safari) and go to the **CHC website** <https://chc.edu.au>, then click on **MyHub**.



3. Scroll down and click on the **WiFi Guest Portal**.

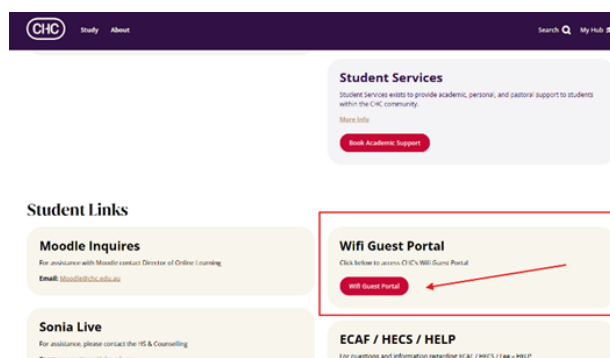

4. The **WiFi Portal** page should appear. Click on “**OnBoard your device here**” Text

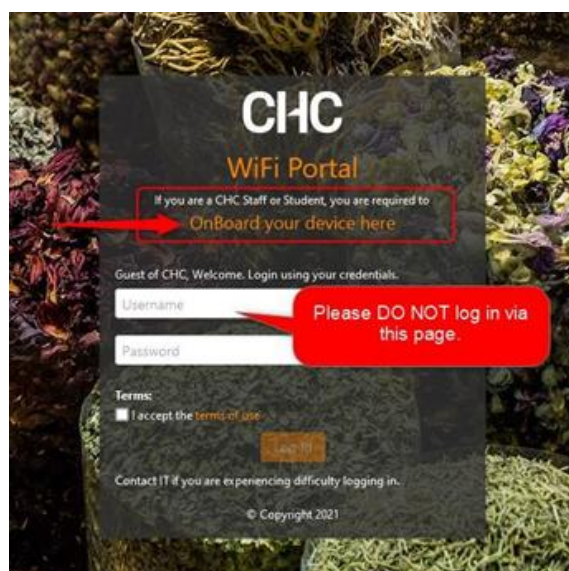

5. On the next screen, enter **your Username and Password** (e.g. s123456 and your password).



6. Click on **Install Certificate**.



7. If a window like below may pop up, tick both options and click **OK**. If it doesn't pop up, skip this step.
 - a. Trust this CA to identify websites.
 - b. Trust this CA to identify email users



8. Click **Install Profile**.



9. Open the **System Preferences**.



10. Click on **Profiles**.



11. Click **Continue** to install “**Device Enrollment**”.

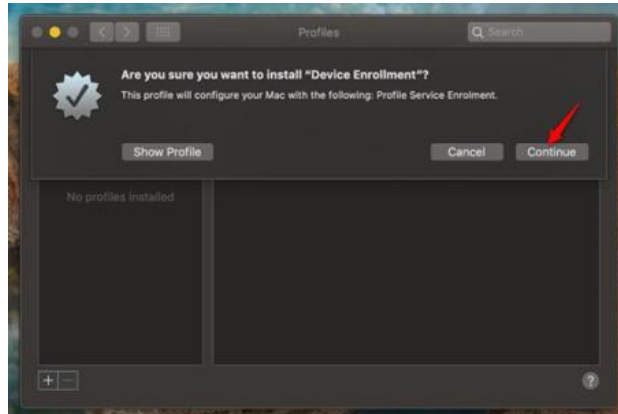

12. The next window will say ‘This profile’s authorship cannot be verified. Make sure you trust the sender before installing’. Click **Install**.

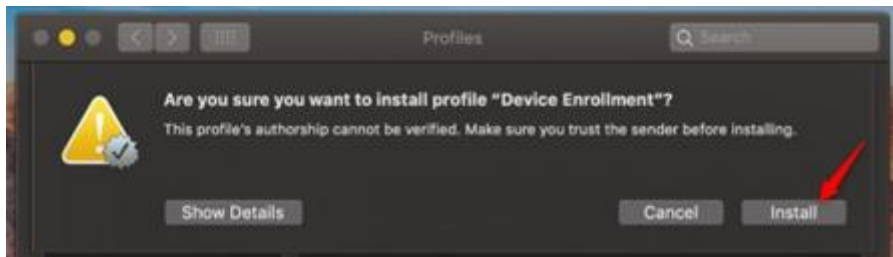

13. Click **Continue** again to install “**Device Enrollment**”.



14. The next window will say ‘This profile’s authorship cannot be verified. Once installed, “CHC Root CA” will be trusted on this Mac’. Click **Install**.

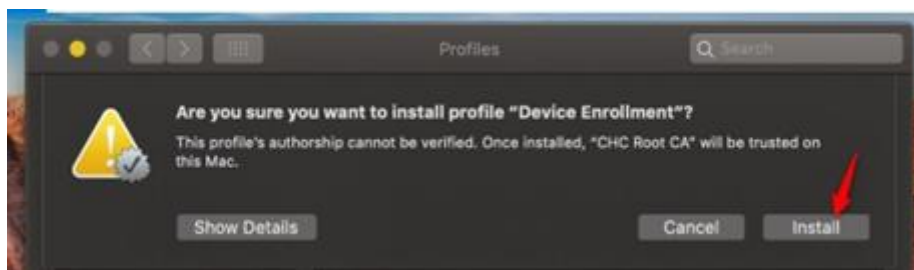

15. Type in your **MacBook** password.

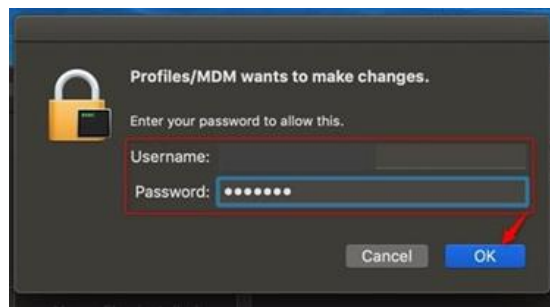

16. **Device Enrolment** window appear. Close this window.

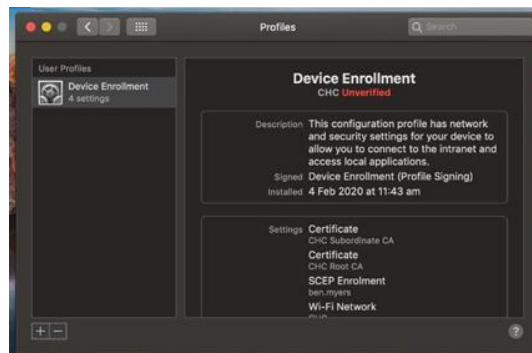

17. WiFi Onboarding has completed.



18. From the available **WiFi** networks, select **CHC**. You are now free to browse.

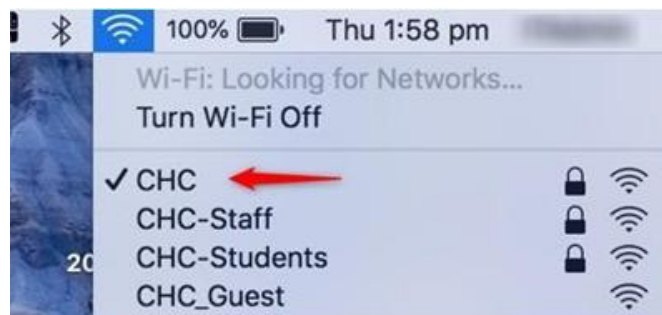

19. To remove **CHC_Guest** WiFi, click on **Open Network Preferences...**

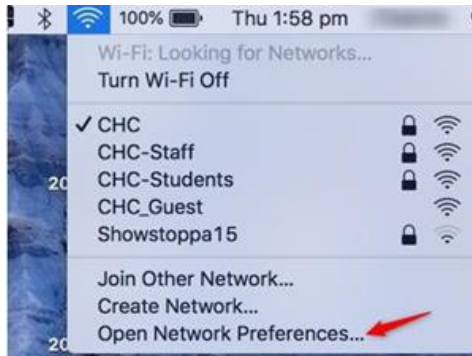

20. Click on **Advanced...**

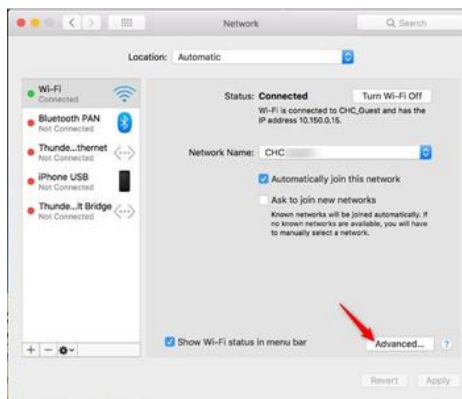

21. Select **CHC_Guest** and remove it by clicking on the **-** sign or unticking. Click **OK**.

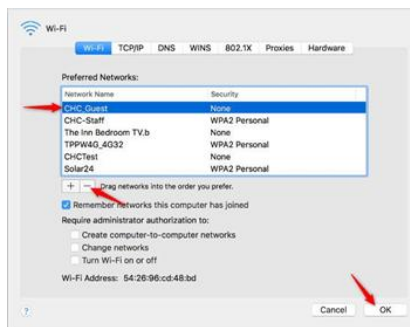

22. Click **Apply**.

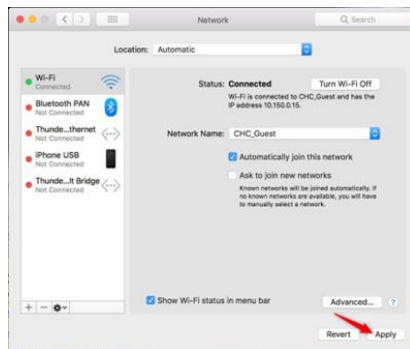

IOS - iPhone

1. Go to your Wi-Fi setting and select **CHC_Guest** Wi-Fi.
 - a. Wait until you are connected to the **CHC_Guest** Wi-Fi (you will see the tick next to it).

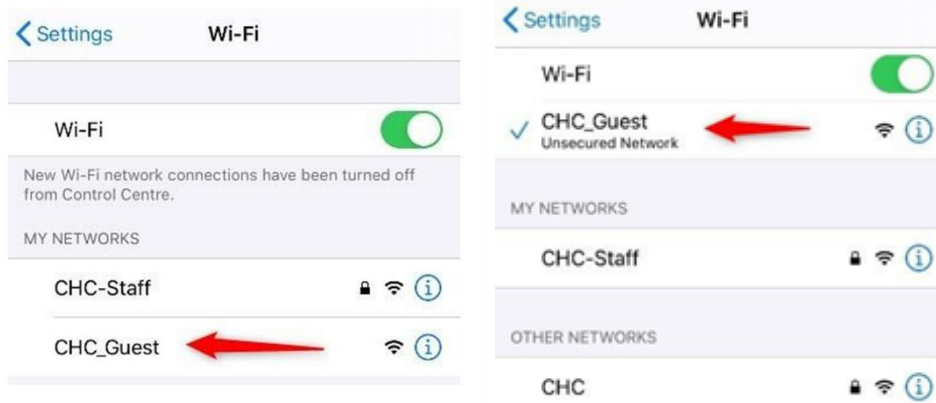

2. Open your web browser (e.g. Safari) and go to the **CHC website** <https://chc.edu.au>, then click on the **MyHub** link.
 - a. Scroll down and click on **WiFi Guest Portal**.

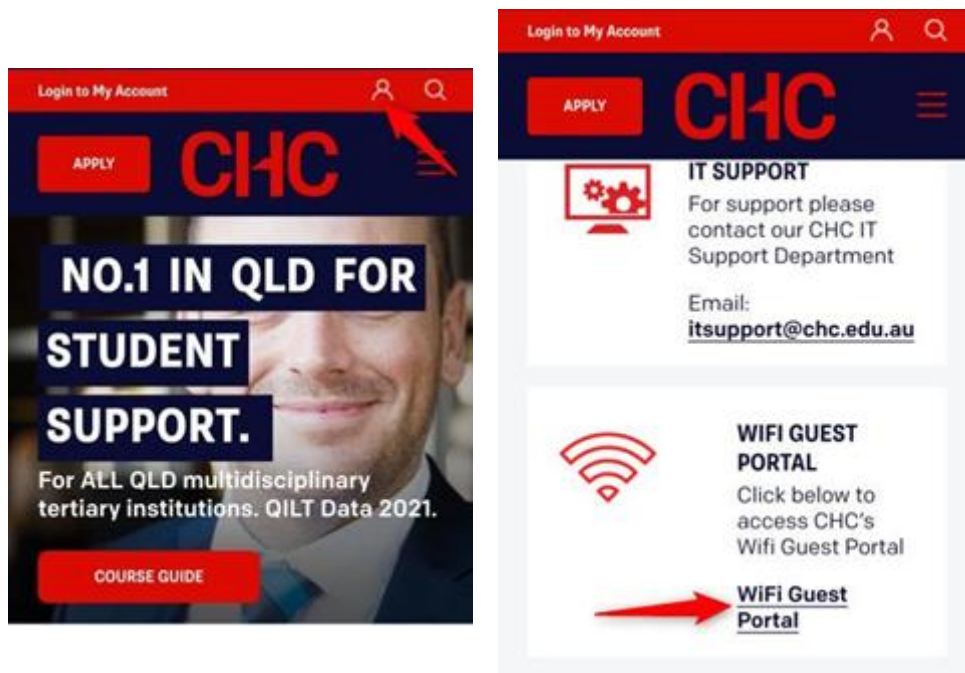



3. Click on the “**OnBoard your device here**” text.
 - a. On the next page enter your **CHC Username and Password** (e.g. s123456 and your password).

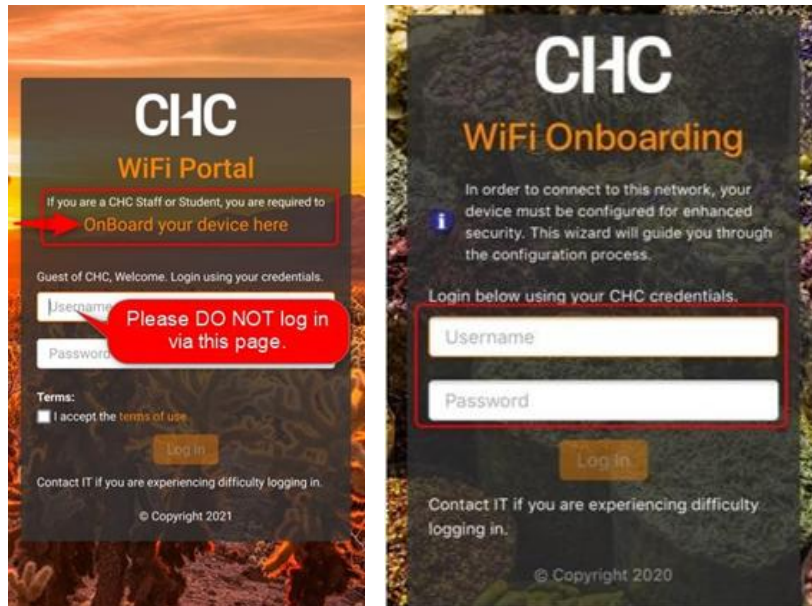

4. Click on **Install Certificate**.
 - a. Click on Allow for download



5. Click on the Allow Download Pop up.
 - a. Then Select Close, when it is finished



6. On the next screen, Click **Install Profile**.



7. Click on the **Allow** Download Pop up.
a. Then Select **Close**, when it is finished

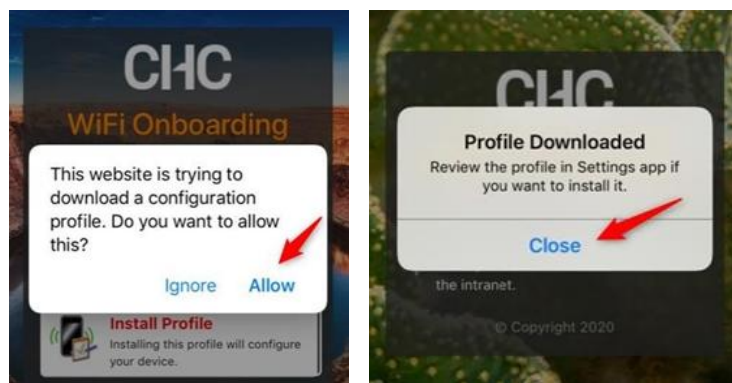

8. Go to the **Settings** and open **Profile Downloaded**.



9. Click **Install** for **CHC Onboard Local Certificate Authority**.
 - a. NB: You may be required to enter your iPhone passcode.



10. Click **Install**.
 - a. Then Click the **Install** button again.

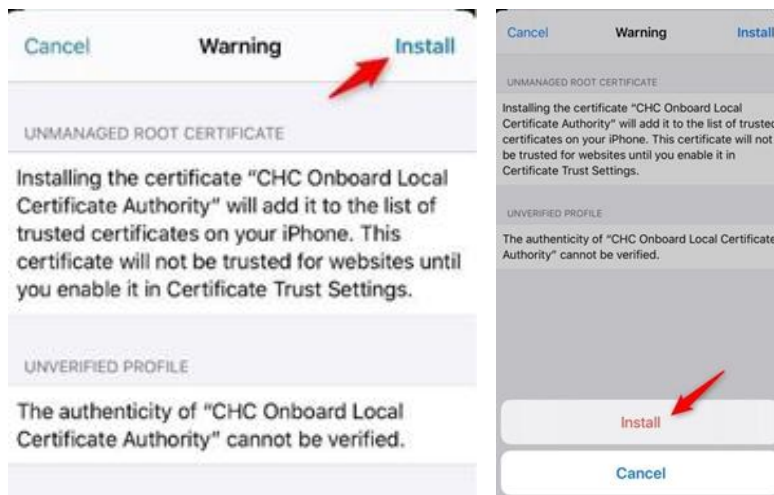

11. The **CHC Onboard Local Certificate Authority** verified (green tick) will appear.
Click **Done**.

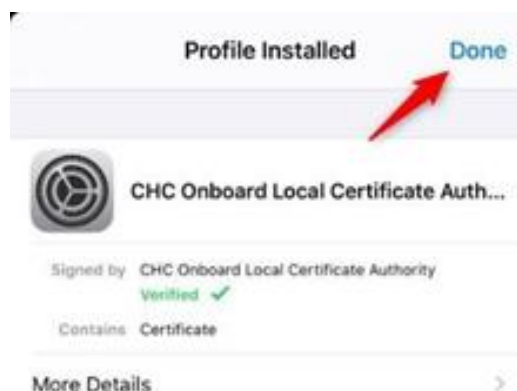

12. Click **Install** for the **Profile**.
 - a. Then Click the **Install** button again.

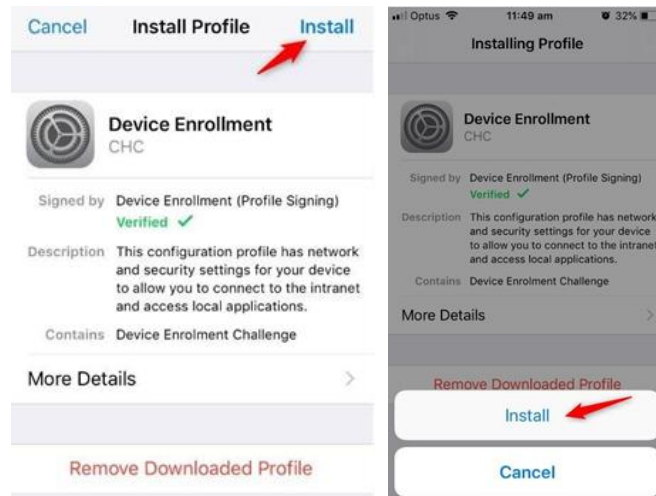

13. Click to **Install** the "CHC Root CA".
 - a. Then Click the **Install** button again.



14. Click **Done**.

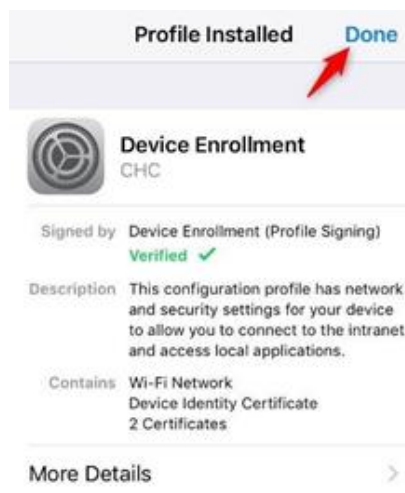

15. You should now see two configuration profiles in the **Settings > General > Profiles**.

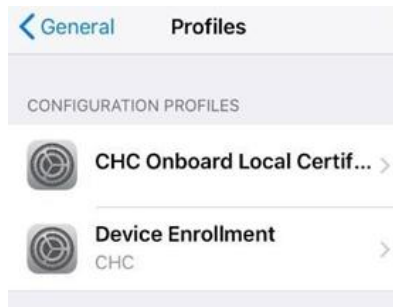

16. Go back to your browser and confirm that the WiFi Onboarding has completed.



17. Go to the **Settings > WiFi** and select **CHC**.

a. CHC WiFi is now connected. You are free to browse.

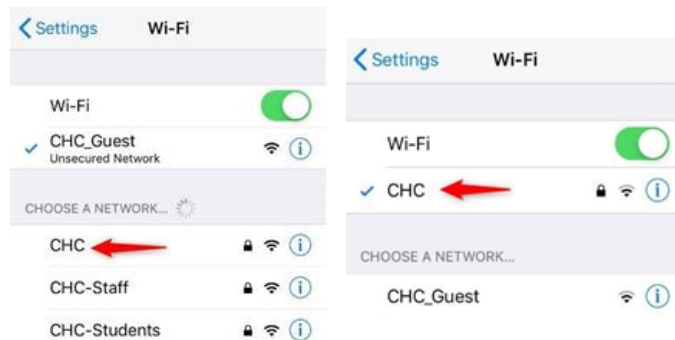

18. To remove the **CHC_Guest Wi-Fi**, click on the **i** icon.

a. Then click on the “Forget this Network” Text.

