



DEMOUNTABLE CONCEPTS

• AMERICA'S SWAP BODY •

Dual Air-Swap System Quick Guide



Demountable Concepts, Inc.
200 Dr. Leo J. McCabe Blvd.
Glassboro, NJ 08028 USA

LOCAL (856) 863-0900
WEB demount.com

(844) 364-4021



Demountable containers, standard truck bodies equipped with retractable legs.



Straight trucks with a pneumatic lifting system installed on their chassis for mounting, demounting, locking, and transporting containers.

Statement of Compliance

The cargo containment system installed upon this truck chassis or semi-trailer, when properly maintained in good working and operating order, complies with the North American Cargo Securement Standard, which is codified in the following sections of the U.S. Department of Transportation, Federal Motor Carrier Safety Administration Part 393- Parts and Accessories Necessary for Safe Operation, Subpart I - Protection Against Shifting and Falling Cargo (May 2015), §§ 393.100, 393.102, 393.104, 393.106, 393.114. In addition, this system complies with Part 1 and 2 of the North American Cargo Securement Standard.

The cargo containment system also complies with Canadian National Safety Code for Motor Carriers NSC Standard 10 for Cargo Securement, Divisions 2, 3, 4, 5 (June 2013)

This vehicle is certified as a Final Stage vehicle and complies with all FMVSS regulations in effect on the date of final manufacture.

See more at: www.demount.com/compliance

An improperly secured container that falls off a chassis can result in injury or death.

It is the driver's responsibility to make sure that the container is properly locked onto the chassis before each trip.

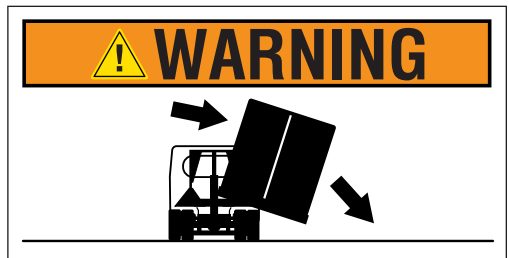

Be sure all people are clear of the container when mounting and demounting.

Do not operate equipment without proper training from Demountable Concepts or an authorized training provider.

To avoid injury ALWAYS USE HANDLES to operate legs.

- Review the pre-trip inspection procedure in this manual before every operation and report any defect or problem on your daily driver inspection report.
- Read and understand all safety labels on the equipment.
- Failure to check that chassis is centered and straight when backing under or pulling out is the primary cause of damage.

When demounting bodies:

- Be sure all legs are in proper position with the leg brace and the spring bolt pin engaged.
- Light plug must be disconnected.
- Bodies must be unlocked.

When transporting the container on chassis:

- The container must be locked in place -- Visually confirm by checking locking hooks and levers before each trip.
- All legs must be stored and locked in place.
- Light plug must be connected.
- Vehicle must be set to ride height.



1. Inside the cab, start the truck.
 - Engage the parking brake.
 - Air pressure must be 120 PSI for the system to operate.

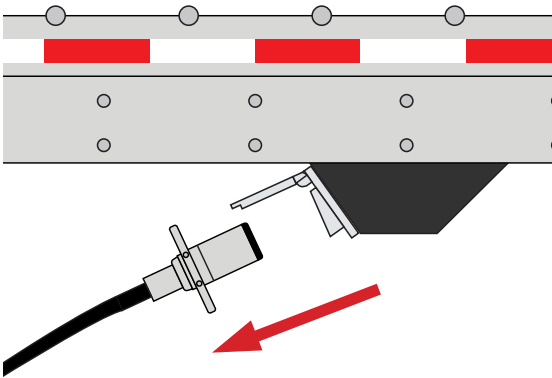

2. Locate and disconnect the light plug on the container near the lifter control box behind the cab.
 - Store it in the storage holder.

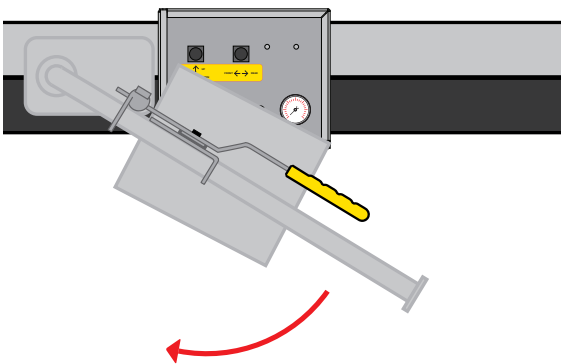

3. At the lifter control box:
 - Remove the locking key.
 - Push the safety handle inward to release the locking assembly.
 - Lower the locking bar to expose the controls.

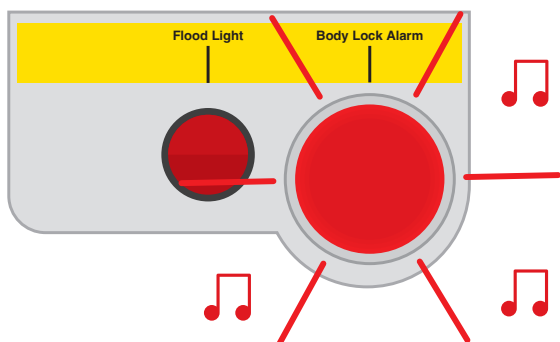

4. The container is now unlocked from the chassis.
- The alarm in the cab will flash and make a sound.
 - This will continue until the locking assembly is engaged.

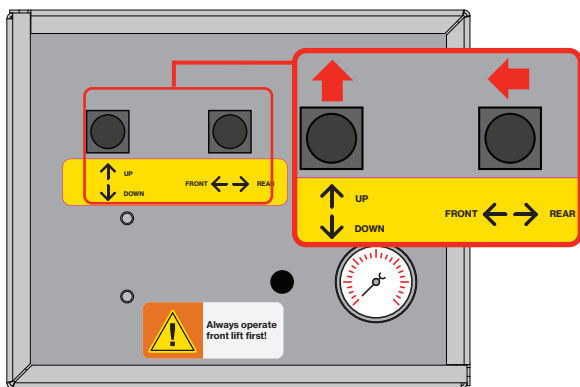

5. **Always operate the front lift assembly first.**

- Inside the control box, set the selector lever to front.
- Raise the front lift assembly by holding the lift control lever in the up position.

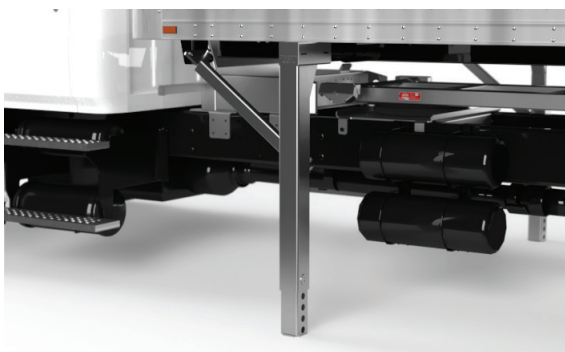

6. Set the front legs.

When working with legs:

- **Always wear gloves for hand protection.**
- **Never put fingers into the holes in the legs.**

There is a lower telescoping section of the leg. Once the ideal height is determined for your swap yard, this will not have to be adjusted on a daily basis.



WARNING: To Avoid Injury Always Use Handles When Working With Legs

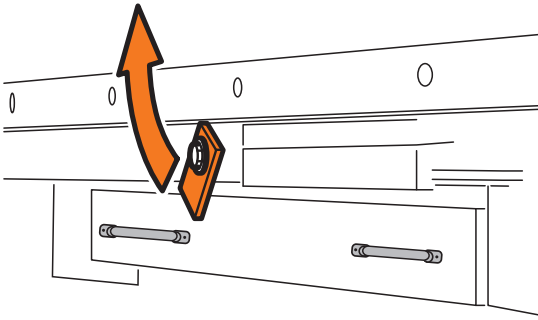

7. Start with the driver-side front leg:

- Swivel the secondary safety device to the side.

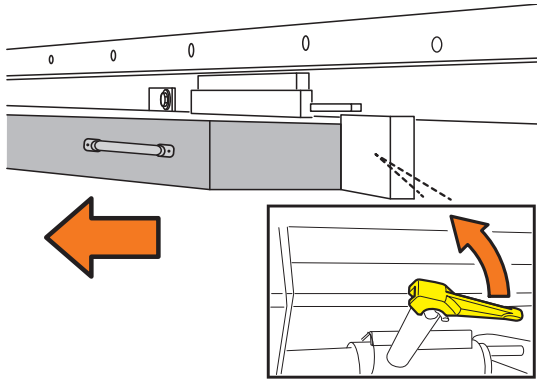

- ### 8.
- Unlock the spring bolt by pulling the actuation handle.
 - Using the handles, grab the support leg from below with both hands and carefully pull it out until it stops.

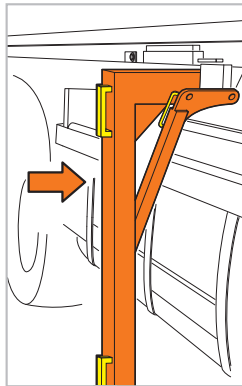
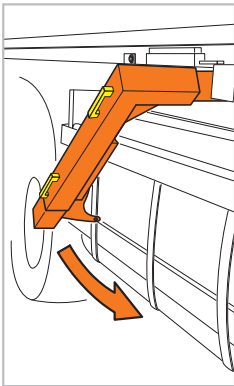

- ### 9.
- Gently lower the leg to the vertical position. Do not drop it.
 - Remove leg brace from the holder and secure it to the container.

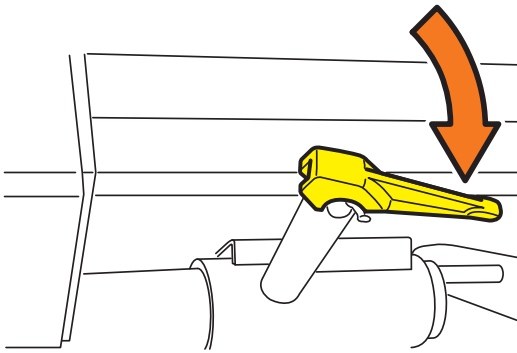

10. • Lock leg assembly by folding over the actuation handle of the spring bolt.

Push the leg in and out until the spring bolt pin is engaged and snapped into position.



11. The support leg is only securely locked when the leg brace and the spring bolt pin are engaged.

Repeat same steps on the passenger-side front leg.

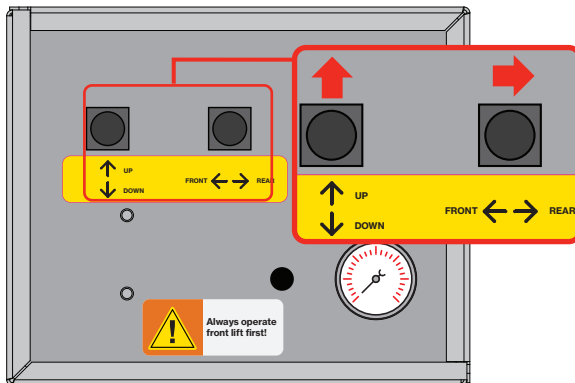

12. Return to the control box and move the selector lever to rear.

- Raise the rear lift assembly by holding the lift control lever in the up position.

Note: Front lift assembly will automatically lower when rear lift is raised.

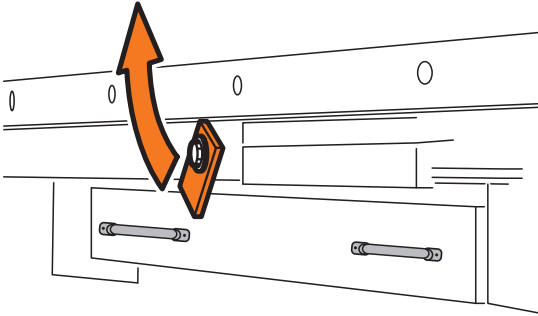

13. Start with the driver- side rear leg:

- Swivel the secondary safety device to the side.

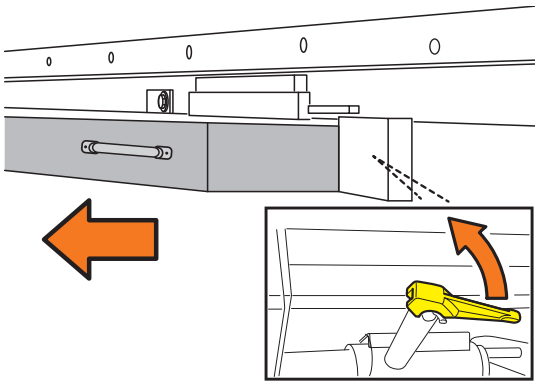

- 14.** • Unlock the spring bolt by pulling the actuation handle.
- Using the handles, grab the support leg from below with both hands and carefully pull it out until it stops.

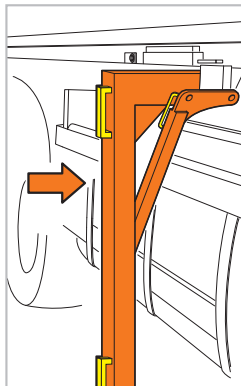
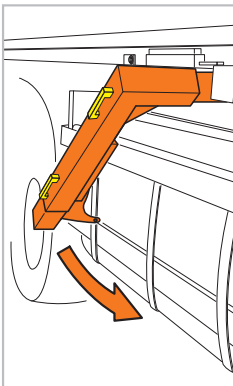

- 15.** • Gently lower the leg to the vertical position. Do not drop it.
- Remove leg brace from the holder and secure it to the container.

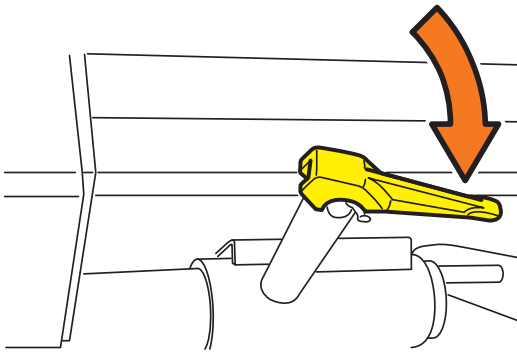

16. • Lock leg assembly by folding over the actuation handle of the spring bolt.

Push the leg in and out until the spring bolt pin is engaged and snapped into position.

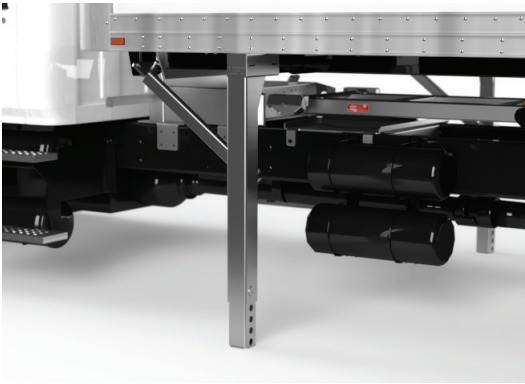

17. The support leg is only securely locked when the leg brace and the spring bolt pin are engaged.

Repeat same steps on the passenger-side front leg.

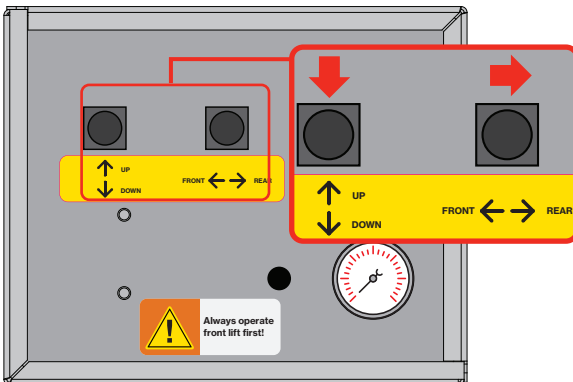

18. Return to the control box.

Lower the rear of the lift assembly by moving the selector lever to rear and holding the lift control lever in the down position.

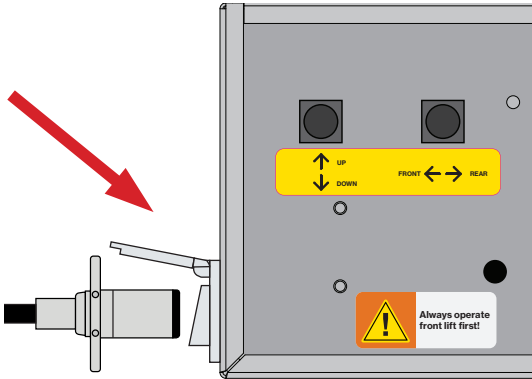

19. Double check that light plug is disconnected from the container.
- It must be inserted the storage holder on the side of the control box.

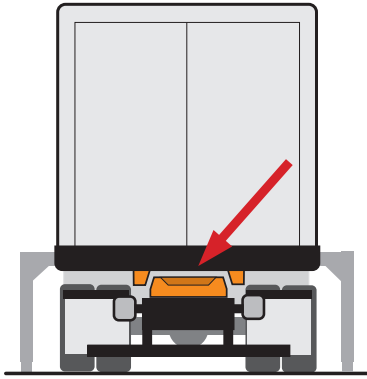

20.



Warning: Check for clearance before pulling out



21. Return to the cab of the truck.
- Pull straight out until the chassis is clear of the container.

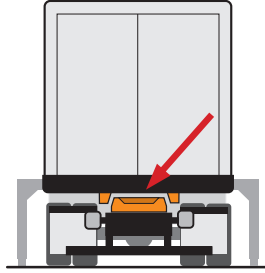
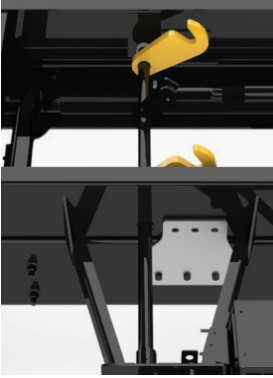

1. Make sure the locking hooks are in the unlocked and down position.

The in-cab container lock alarm will sound until a container is locked in place.

Make sure the chassis is aligned straight in front of the container. If needed, lower the air-suspension.



2. Slowly back the truck straight under the container until the front stops on the lifter contact the front of the container.

- Exit the cab and check alignment.
- Go to the lifter control box.

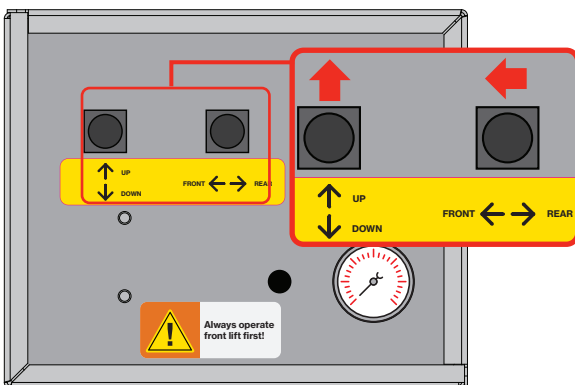

3. **Always operate the front lift assembly first.**

- Inside the control box, set the selector lever to front.
- Raise the front lift assembly by holding the lift control lever in the up position.

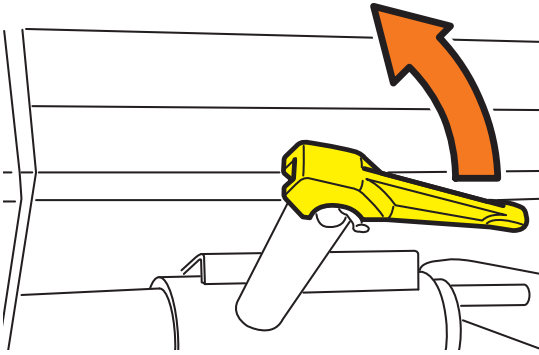

4. Store the front legs. Start with the driver-side front leg:

- Unlock the spring bolt by pulling the actuation handle.



Warning: To Avoid Injury Always Use Handles When Working With Legs

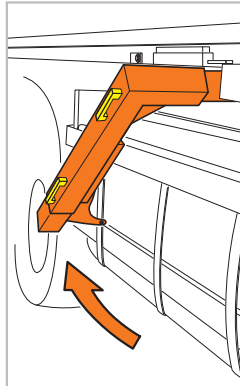
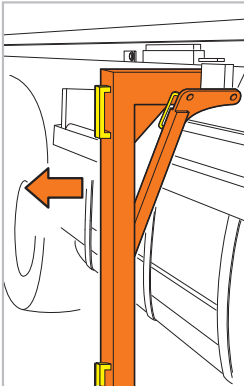

- 5.**
- Release the leg brace from the container and store it in the holder.
 - Lift and rotate leg until it is horizontal and then push it in to the storage carrier.

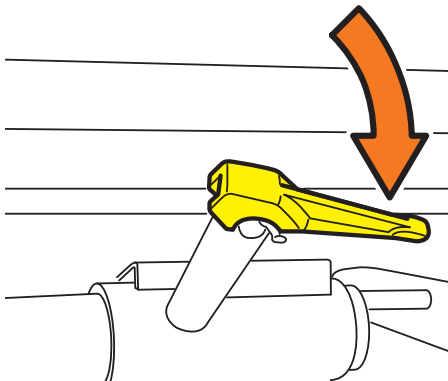

6. Lock the spring bolt

- Push the leg in and out until the spring bolt pin is engaged and snapped into position.

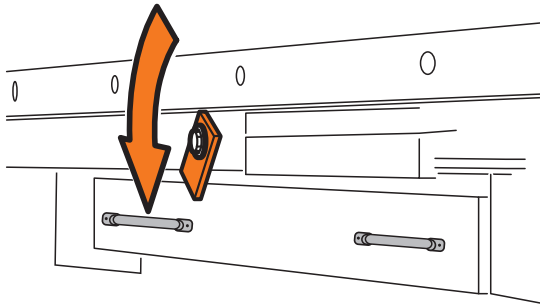

7. • Secure the secondary safety device

Repeat same steps on the passenger side front leg.

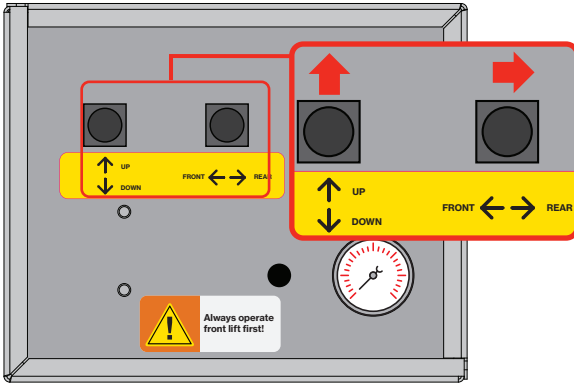

8. Return to the control box and move the selector lever to rear.

- Raise the rear lift assembly by holding the lift control lever in the up position.

Note: Front lift assembly will automatically lower when rear lift is raised.

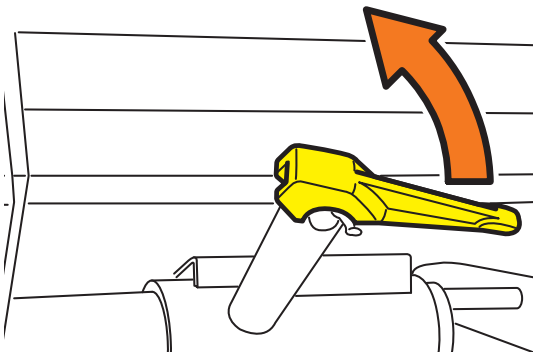

9. Store the rear legs. Start with the driver-side rear leg:

- Unlock the spring bolt by pulling the actuation handle.



Warning: To Avoid Injury Always Use Handles When Working With Legs

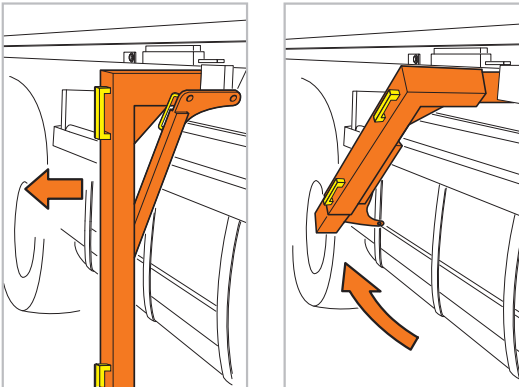

10. • Release the leg brace from the container and store it in the holder.
- Lift and rotate leg until it is horizontal and then push it in to the storage carrier.

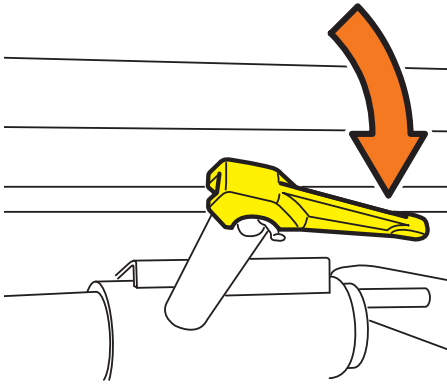

11. Lock the spring bolt
- Push the leg in and out until the spring bolt pin is engaged and snapped into position.

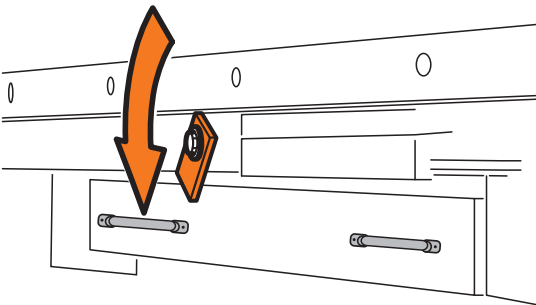

12. • Secure the secondary safety device
- Repeat same steps on the passenger side rear leg.**

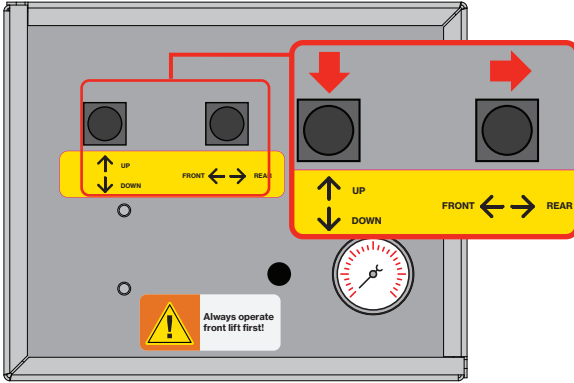

- 13.** Return to the control box.

Lower the rear of the lift assembly by moving the selector lever to rear and holding the lift control lever in the down position.

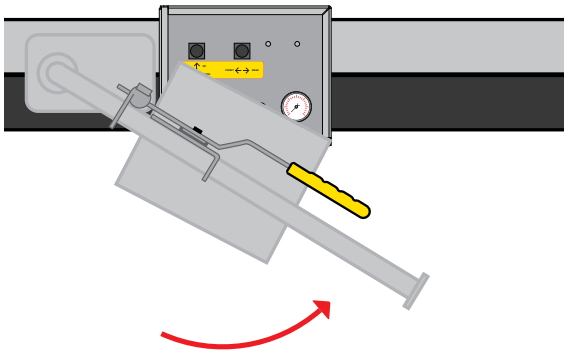

- 14.** Lock the container onto the truck by raising the lifter locking bar.

- The hooks will engage, locking the container to the chassis.

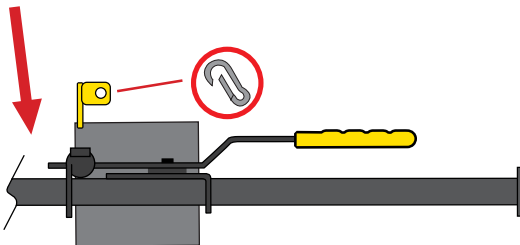

- 15.** The yellow spring-loaded safety handle will move into place.

- Insert the safety locking key.
- Use secondary safety clip to ensure the key stays in place.

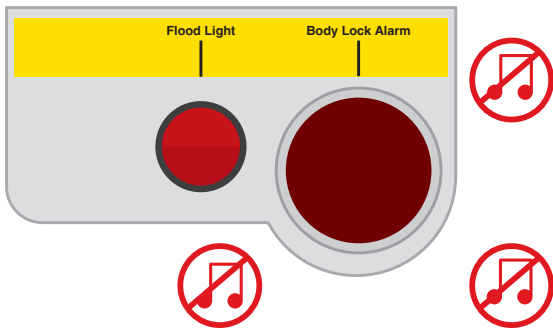

16. When the locking hooks are engaged the alarm on the dash will stop flashing and sounding.

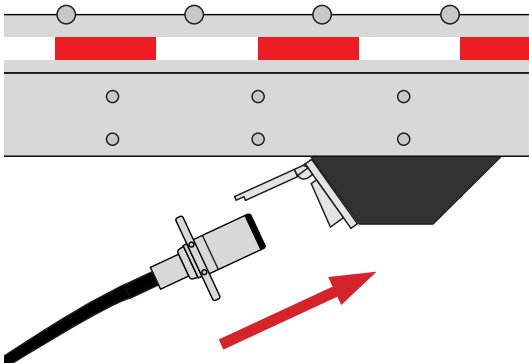

17. Remove the light plug from the storage holder.
- Plug it into the receptacle on the container.

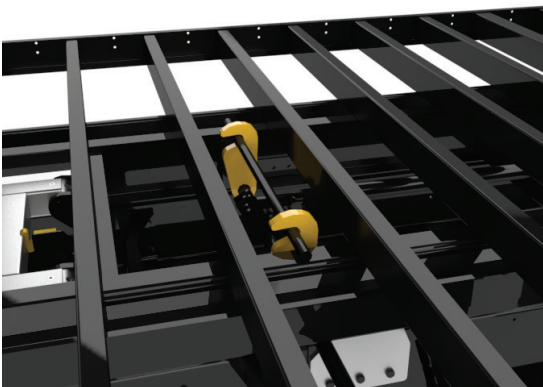

18. Confirm that the container is locked onto the truck.
- Visually check that the container locking hooks are securely attached to the locking bars on the underside of the container.

19. An improperly secured container that falls off a chassis can result in injury or death. It is the driver's responsibility to make sure that the container is properly locked onto the chassis before each trip.



20. Return to the cab.

Be sure suspension is at normal ride height.

The truck is now ready to be driven.



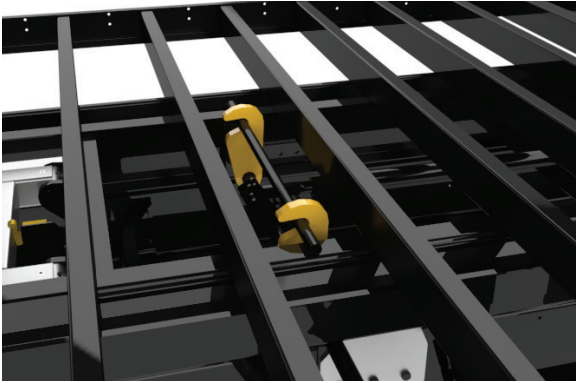

Each set of hooks must be undamaged, working correctly, and the container must be locked onto the chassis.

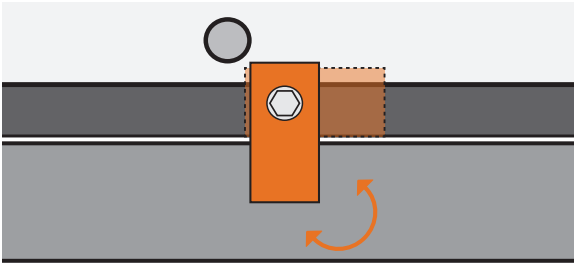

All legs must be properly stowed and locked.

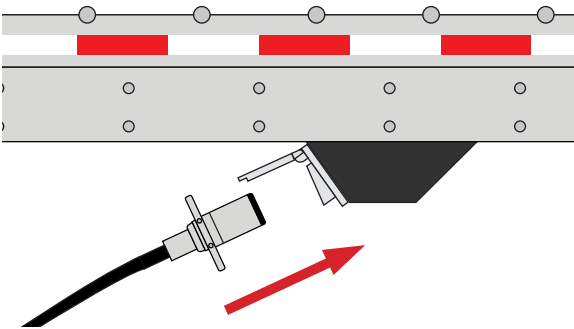

The light plug must be plugged into the container and lights must be functional.

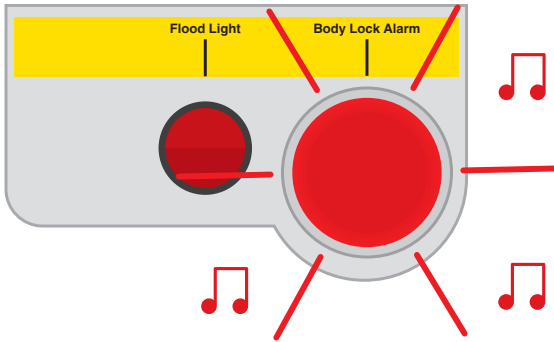

The in-cab alarm must work properly. When container is unlocked the alarm sounds and flashes.

Operator responsibilities:

- Read and understand all safety labels on the equipment
- Be properly trained on this equipment by Demountable Concepts or an authorized training provider
- Perform pre-trip inspection before every trip and report defects or problems on your daily driver vehicle inspection report (DVIR)
- Be sure the container is properly locked onto the body
- To avoid injury always use handles when working with legs
- Be sure all people are clear of the container when mounting and demounting
- Safely operate equipment at all times
- Only operate vehicle with air suspension at normal ride height.

When demounting bodies:

- All legs must be deployed and in the proper position with safety locks in place
- Bodies must be unlocked
- Air suspension must be lowered
- The in cab alarm and light must function correctly - alarm light and buzzer are ON
- The light plug must be disconnected and stored
- Perform pre-trip inspection before every trip and report defects or problems on daily driver vehicle inspection report (DVIR)

When transporting the container on the chassis:

- The container must be locked in place
- Visually confirm by checking locking hooks and levers before each trip
- Safety lockout key is correctly in place
- Hooks must be undamaged and functioning correctly
- All legs must be locked and stored in place
- The light plug must be connected and container lights must be functional
- The in cab alarm and light must function correctly - alarm light and buzzer are OFF
- Perform pre-trip inspection before every trip and report defects or problems on daily driver vehicle inspection report (DVIR)

Statement of Compliance

The cargo containment system installed upon this truck chassis or semi-trailer, when properly maintained in good working and operating order, complies with the North American Cargo Securement Standard, which is codified in the following sections of the U.S. Department of Transportation, Federal Motor Carrier Safety Administration Part 393- Parts and Accessories Necessary for Safe Operation, Subpart I - Protection Against Shifting and Falling Cargo (May 2015), §§ 393.100, 393.102, 393.104, 393.106, 393.114. In addition, this system complies with Part 1 and 2 of the North American Cargo Securement Standard.

The cargo containment system also complies with Canadian National Safety Code for Motor Carriers NSC Standard 10 for Cargo Securement, Divisions 2, 3, 4, 5 (June 2013)

This vehicle is certified as a Final Stage vehicle and complies with all FMVSS regulations in effect on the date of final manufacture.

See more at: www.demount.com/compliance

**WARNING!**

Operation of the airbag lifting device is prohibited if it is not functioning correctly.

WARNING!

Repair activities may only be carried out by qualified personnel using suitable tools. Do not work in any way which impairs safety when handling the airbag lifting device.

WARNING!

Maintenance work may only be carried out by authorized, trained personnel. These persons must also have read and understood this documentation.

WARNING!

Continually check the airbags for damage, as otherwise there is a risk of accidents.

WARNING!

If air-bag(s) must be removed (only possible when airbag lifting device is raised), then the airbag lifting device must be braced mechanically to prevent it from lowering.

CAUTION!

Malfunctions and unanticipated changes in the airbag lifting device must be rectified without delay.

NOTICE!

These specifications apply to normal transport conditions. Where operating conditions are less favorable, the maintenance and inspection intervals must be adapted accordingly.

Chassis-Lift Servicing	Servicing Interval	Activity
Visual inspection of airbag lifting device	Daily/before starting (before each use)	<p>Check the airbag lifting device for cracks, deformation and loose bolted connections and the airbag itself for cuts or pinching.</p> <p>Damaged airbag lifting devices must immediately be taken out of operation and repaired or replaced.</p>
Visual inspection of locking hooks	Daily/before starting (before each use)	<p>Check the hooks and linkage for looseness, damage, bending or other irregularities.</p> <p>Damaged hooks must immediately be taken out of operation and repaired or replaced.</p>
Lubrication of bearings	90 Days	<p>Each month, lubricate the bearings on the frame using the grease nipples and also grease the lifting pads two times (2X).</p> <p>Normal, commercially available and water-repellent grease can be used for lubrication.</p>

Chassis-Lift Servicing	Servicing Interval	Activity
Wear inspections of airbag, bearing.	During vehicle inspection	At regular intervals, check the wearing parts, in particular the airbag and bearing. To do this, raise the airbag lifting device to its maximum height without any load. If there are any visible signs of cuts, pinching or abrasion that could have damaged the airbag, the bag must immediately be replaced.
Drain air bag	Monthly	With the body removed, raise the air lift to full height to increase pressure. Open manual drain valve on locking frame.

Daily Maintenance Check List

- Check warning system
- Check that locking lever is in good working order

90-Day Maintenance Check List

- Check all truck lights
- Check light plug
- Remove body from truck and power wash truck chassis
- Grease all locking shafts
- Grease locking lever
- Check measurements of front hooks
- Check measurements of rear hooks
- Adjust front and rear hooks if required
- Check body Stops

**WARNING**

Damaged components, i.e. components that are permanently deformed, broken or cracked must always be replaced.

Servicing Support Legs

Support legs acc. to EN 284 generally do not require any particular maintenance.

To ensure that the support leg can be moved easily in the support bearing, the support tube can be greased if required.

The support tube on the support bearing should be lubricated at least every three months.

Support legs as well as their attachment and mounting on the swap body should be regularly checked for correct function, damage and wear. The intervals must be defined according to the frequency of changes, e.g. at least every 14 days if there are several changes every day, or at least every 3 months if the change intervals are longer.

Support Legs with Safety Struts

The strut brake is intended to prevent the strut from falling down. The optimum setting has been reached when the strut moves down slowly under its own weight.

If the force required is too great or the braking effect is too low, it will be possible to compensate by changing the tightening torque. It is recommended for the braking effect to be checked at the aforementioned intervals and corrected if necessary.



DEMOUNTABLE CONCEPTS

• AMERICA'S SWAP BODY •

Contact Info: US, Canada & Mexico

Demountable Concepts, Inc.
200 Dr. Leo J. McCabe Blvd.
Glassboro, NJ 08028 USA

Online: demount.com
Toll Free: (844) 364-4021