



THE SCOTTSDALE RESORT & SPA

EVERY GREAT EVENT BEGINS WITH THE PERFECT SETTING—AND AT THE SCOTTSDALE HOTEL RESORT & SPA, WE OFFER A VARIETY OF SPACES WHERE STORIES UNFOLD, MEMORIES ARE MADE, AND CONNECTIONS ARE CELEBRATED.



MEETING & FUNCTION SPACE

- 45,000 Square Feet of Flexible Interior Space
- 40,000 Square Feet of Exterior Function Space Full Service & Experienced Conference Planning Department
- Complete Meeting Package & Modified Packages
- 2 Full Serve Break Stations
- Full Service & on-site Audio Visual Department
- Ergonomic Chairs Available for All Meetings
- On-Site Transportation.



FACILITIES / RECREATION / SERVICES

- 2 Heated Swimming Pools
- Cabana Rentals
- Adjacent McCormick Ranch Golf Club with 36 Holes
- On-site UPS Service
- Dry Cleaning
- Fitness Center with Life Fitness™ Cardio Machines
- + Peloton™ Bikes
- Luna Spa
- Self-Parking & Valet Parking



DINING & ENTERTAINMENT

- La Fogata Kitchen and Bar
- Barnaby's Café & Wine Bar
- The Madam Cocktail Bar
- Twisted Vine Poolside Bar & Grill
- The Social Boardroom - pool table, golf simulator and shuffle board

GROUND LEVEL

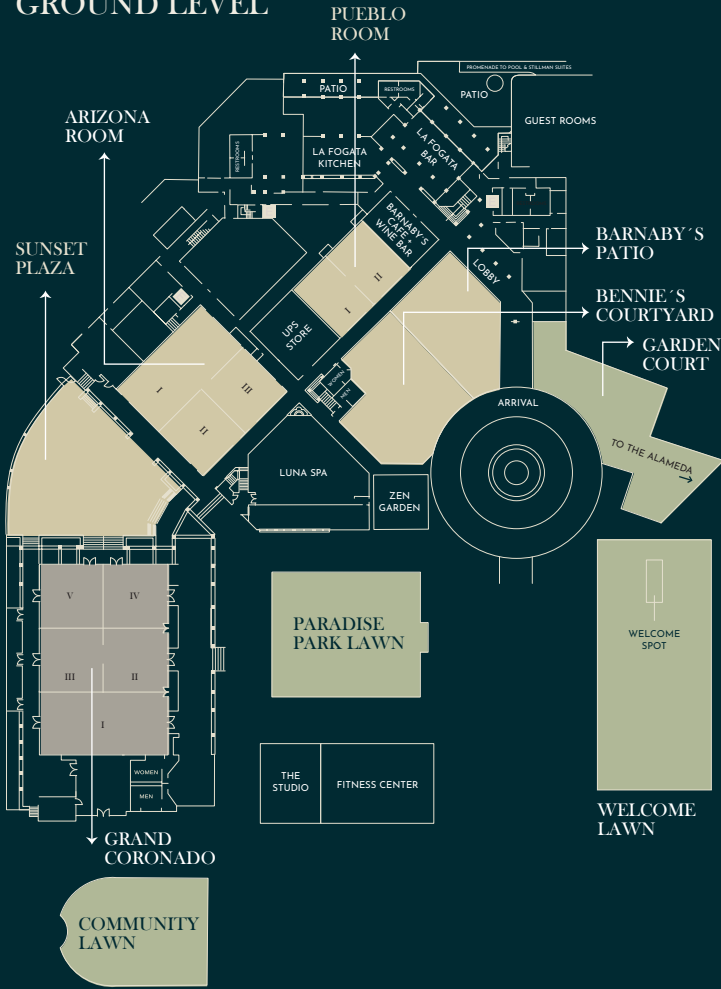

LOCATION	DIMENSIONS	SQ. FEET	THEATRE	SCHOOLROOM	U-SHAPE	BANQUET
GRAND CORONADO Ceiling Height - 22' Soffit 20'	120x 80	10,000	1,000	640	N/A	700
I	40x80	3,200	324	144	76	210
II	40x40	1,600	144	70	36	90
III	40x40	1,600	144	70	36	90
IV	40x40	1,600	144	77	36	90
V	40x40	1,600	144	70	36	90
ARIZONA ROOM	78x78	6,084	660	308	88	420
I	78x39	3,042	254	132	80	180
II	39x39	1,520	120	70	36	90
III	39x39	1,521	120	77	36	90
II & III	78x39	3,042	248	132	80	180
PUEBLO ROOM	89x41	2,296	432	240	84	270
I	31x41	1,271	108	64	30	80
II	25x41	1,025	108	64	30	80
BENNIE'S COURTYARD	-	-	-	-	-	180
SUNSET PLAZA	-	-	-	-	-	350
MCCORMICK POOL	-	-	-	-	-	-
STILLMAN POOL	-	-	-	-	-	330
THE ALAMEDA	-	-	-	-	-	600
PARADISE PARK LAWN	-	-	-	-	-	500
COMMUNITY LAWN	-	-	-	-	-	250
GARDEN COURT	-	-	-	-	-	60
WELCOME LAWN	-	-	-	-	-	30
MCCORMICK COURT	-	-	-	-	-	110

UPPER LEVEL

LOCATION	DIMENSIONS	SQ. FEET	THEATRE	SCHOOLROOM	U-SHAPE	BANQUET
MARICOPA ROOM	178x78	6,084	1660	308	88	420
I	78x39	3,042	264	132	80	180
II	39x39	1,521	120	77	36	90
III	39x39	1,521	120	77	36	90
II & III	78x39	3,042	248	132	80	180
APAGO ROOM	66x40	2,640	220	144	52	190
I	33x40	1,320	110	60	24	80
II	33x40	1,320	110	60	24	80
APACHE ROOM	105x41	24,305	480	272	84	270
I	39x41	1,599	124	64	30	90
II	39x41	1,599	124	64	30	90
III & IV	27x41	1,107	96	36	24	70
III	27x20	540	50	18	18	30
IV	27x21	567	50	18	18	30
COUNCIL ROOM	31x21	651	48	30	20	40
TREATY	33x21	693	48	30	20	40
HOPI	21x14	294	16	9	N/A	10
SOCIAL BOARDROOM	-	-	-	-	-	-
VISTA VERDE	-	-	-	-	-	140

