

SAFETY INSTRUCTIONS



- ⚠ Please read the instructions carefully before use.
- ⚠ Do not disassemble or refit the product.
- ⚠ Press the touch sensor properly.
- ⚠ Handle with care during installation or moving.
- ⚠ Keep the mirror dry; moisture reduces the sensitivity of the product.
- ⚠ Turn off the power before cleaning. The surface of the mirror should be cleaned with glass cleaner; please make sure the mirror is completely dry before using it.
- ⚠ Turn off the power and avoid direct sunlight if not used or stored for a long period of time.
- ⚠ Keep out of children's reach.
- ⚠ Make sure that your charging device is adequate for the mirror voltage rating before using it.
- ⚠ Avoid exposure to extreme heat or fire to avoid the risk of an explosion.
- ⚠ Stop using the product immediately if abnormal conditions occur.
- ⚠ Electrical installation must be completed by a registered electrician only

* We reserve the right to any modifications of the product involving design and specification. All materials here are for your reference only and are subject to the products you receive. No further notice will be given of any technical parameters changed.

MADE IN CHINA

Distributed by



www.propelindustries.co.nz

0800 427 335

TITAN

LED MIRRORS

One touch control for ultimate clarity and ambiance

WALL-MOUNTED LED BATHROOM MIRROR

OPERATIONAL MANUAL

FEATURES

- 5mm thick high definition eco-friendly glass mirror
- Built-in touch sensor controls LED light temperature and brightness
- Automatic demister function
- Hardwire for wall switch control

SPECIFICATIONS

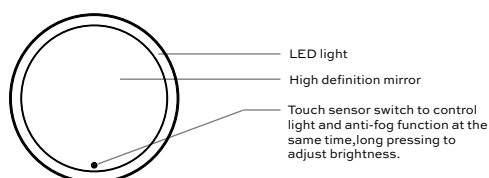

Product Name Wall-mounted LED bathroom mirror

Materials Aluminium + Glass

LED Colour Temperature 6000K/3000K±200K

Product Size As shown below

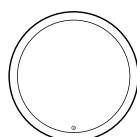

TITAN-ROUND-60 600mm	TITAN-ROUND-90 900mm
TITAN-ROUND-75 750mm	TITAN-ROUND-120 1200mm

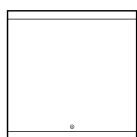

TITAN-CUBO-7590 750x900mm	TITAN-CUBO-12090 1200x900mm
TITAN-CUBO-9090 900x900mm	TITAN-CUBO-15090 1500x900mm

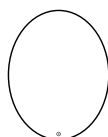

TITAN-OVAL-7090
700x900mm

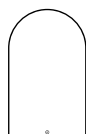

TITAN-HORIZON-60100
600x1000mm



TITAN-ECLIPSE-60100
600x1000mm

OPERATING INSTRUCTIONS



【ON/OFF】 Short press/tap on the light button to turn mirror on/off.



【Adjustable Colour Temperature】 Short press/tap the light button to adjust the colour temperatures between warm and cool light.



【Dimmable Brightness】 Long hold press on the light button to adjust the brightness of the mirror light in any of the colour temperature settings.

【Memory Function】 The mirror will remain in the last used state, without the need to adjust the brightness.

INSTALLATION METHOD

① Measure, mark and drill the holes for the mounting bracket so that they are centered and level on the wall.

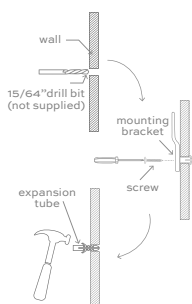

③ Mirror can now be hung on hanging cleat and wired to power source.

hanging cleat

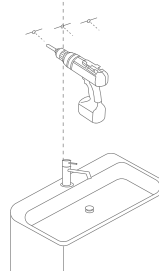

② Insert expansion tubes into drill holes before installing the mounting bracket by screwing into place.

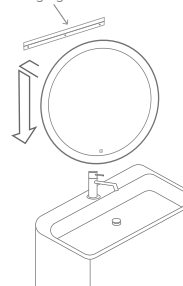

*Electrical installation must be completed by a registered electrician only