

Description

Anti-Ligature Pull Handle,

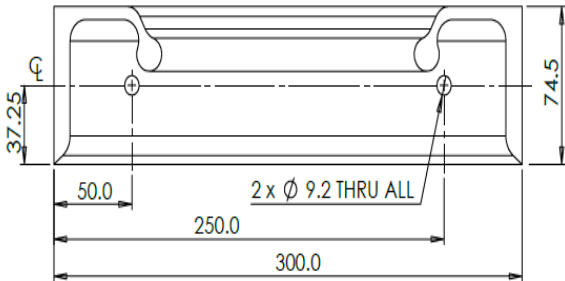

Technical Features

Function & Operation Pull handle designed to remove the ligature point provided by normal door hardware.

Summary of Features Anti-tamper screws

- Options
- BOLT FIX
FACE FIX
BACK TO BACK
BACK TO BACK WITH PLATE

Dimensions

Dimensions 300x74.5mm

Finishes

Finishes Available POWDER COATED FINISHES

BIM Assist™

BC(A)R Assist™*

Guarantee

10 Year

Description

Anti-Ligature Pull Handle,

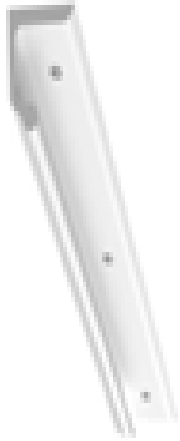

Specification Text

GENERAL HARDWARE

- Manufacturer: dortrend
- Product reference: ANTWH2PCBK
- Type: Anti-Ligature Pull Handle
- Size: AS DIAGAM
- Material/ finish:ALUM P COAT
- AVAILABLE IN UP TO FULL DOOR SIZE

