

REF: 31231

PRICE: £350,000

SIX-BEDROOM HMO

Licensed for 6 People

16 Willowfield Square, Eastbourne, BN22 8AN



Summary

A six-bedroom House in Multiple Occupation (HMO) located in a sought-after residential area of Eastbourne. The property is fully occupied, producing a robust annual rental income of £39,360. The residence is maintained in excellent condition and is currently managed to a high standard by a reputable local HMO specialist agent.

Location

The property is situated in Willowfield Square, offering convenient access to Eastbourne's extensive amenities. Eastbourne features a population of over 100,000 and provides a comprehensive range of shopping and leisure facilities. The town is increasingly popular with students, families, and professionals commuting to London and Brighton. Excellent transport links include direct rail connections to London Victoria, Gatwick Airport, Brighton, and Ashford International, alongside easy access to the A22 and M25.

Accommodation

The property offers well-proportioned living space across multiple floors:

- Six Bedrooms: Three rooms feature private ensuite shower rooms, while the remaining three rooms share a communal shower room.
- Communal Facilities: A shared kitchen is available for resident use.
- Condition: The property is in reasonable decorative order throughout and benefits from professional management.

Room Details

	Size (exc ensuites)	Current Monthly Rent	Annual Rent
Room 1	11.3 sq m	£625	£7,500
Room 2	10.4 sq m	£495	£5,940
Room 3	9.2 sq m	£575	£6,900
Room 4	14.9 sq m	£635	£7,620
Room 5	9.3 sq m	£475	£5,700
Room 6	11.8 sq m	£475	£5,700
Shower Room	7.8 sq m		
Kitchen	9.9 sq m		
Total		£3,280	£39,360

EPC Rating – D (60)

Council Tax Band – C

Tenure – Freehold



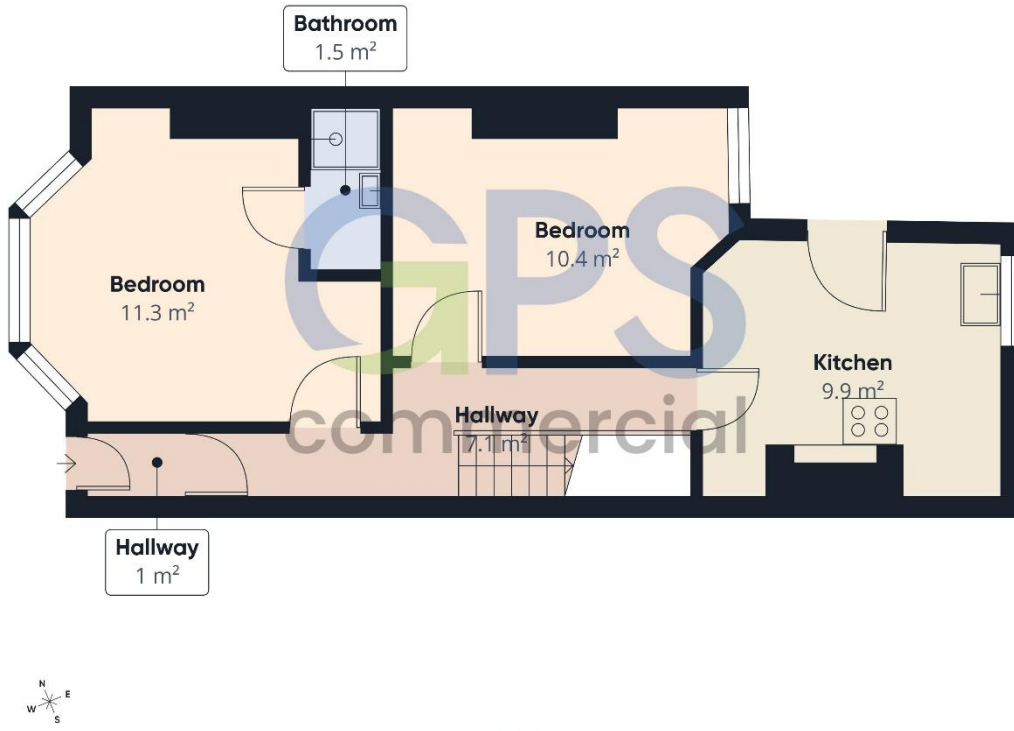

Approximate total area⁽¹⁾
41.2 m²

(1) Excluding balconies and terraces

Calculations reference the BCS IPMS 3C standard. Measurements are approximate and not to scale. This floor plan is intended for illustration only.

GIRAFFE360



Approximate total area⁽¹⁾
39 m²

(1) Excluding balconies and terraces

Calculations reference the BCS IPMS 3C standard. Measurements are approximate and not to scale. This floor plan is intended for illustration only.

GIRAFFE360



25 The Waterfront, Sovereign Harbour, Eastbourne, BN23 5UZ

Tel: 01323 727271 Email: info@gps-direct.com www.gps-direct.com

NOTICE: GPS have provided these particulars just for illustration and prospective buyers or tenants must instruct their own advisors to check all matters relating; physically to the property, its title, any planning consents & building regulations and outgoing; to any associated business. These particulars do not constitute an offer or form part of a contract. GPS has not conducted a detailed survey or tested services, appliances, or fittings; and any dimensions, floor plans and photographs provided are for indicative purposes only. GPS offer no warranties in relation to the property.