

Pine Creek

1,459 sq. ft.
3 BR / 2-1/2 BA



Nestled in the woods with nature this home welcomes you. This three bedroom home is perfect for that weekend getaway, your retirement home with extra bedrooms upstairs for overnight guests, or an income producing rental cabin. The main floor features the timbered cathedral ceiling, open kitchen, the Master Bedroom has his and hers closets and laundry is conveniently close by. Large covered porch is the perfect place to enjoy nature.

A full set of blueprints of this plan is available. Photo and floor plans may differ slightly from actual blueprints.



HOCHSTETLER
LOG HOMES & TIMBERS

552 St. Rt. 95, Loudonville, Ohio
Call 800.368.1015

Pine Creek

Optional Plan

Pine Creek 2

1,459 sq. ft.

3 BR/2 BA

Pine Creek 2 has similar layout to the original with the Master Bedroom on the second floor.



Optional Basement Plans

Pine Creek (Optional Basements)

Optional basements add 1 or 2 bedrooms, a recreation room, bathroom and utility room.

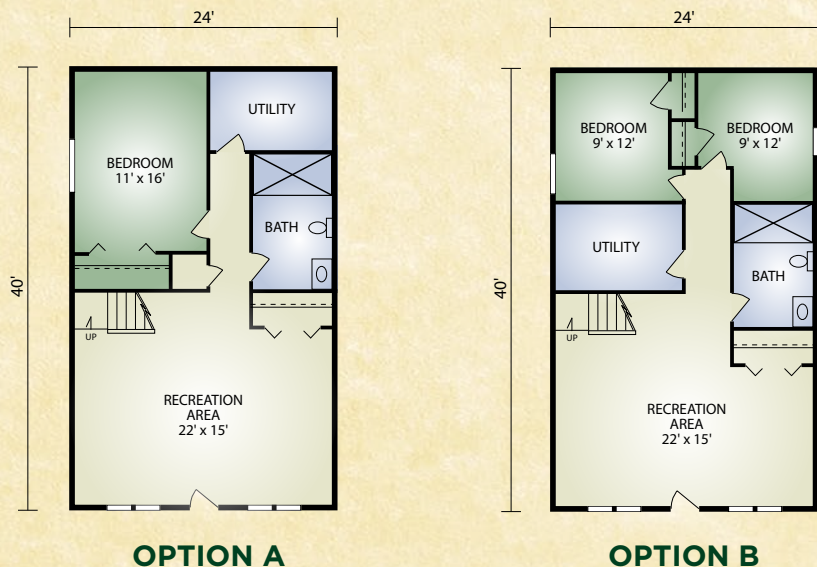

HOCHSTETLER
LOG HOMES & TIMBERS

552 St. Rt. 95, Loudonville, Ohio
Call 800.368.1015