

ProLine CCD Camera

PL4240

ProLine sets the standards in key performance areas that include: download speeds, cooling, low noise operation, anti-ghosting technology, image quality, and linearity. ProLine frame quality is second to none thanks to careful design, implementation, and setup.

Technical Data

Sensor Type	Back Illuminated CCD
Sensor	e2v CCD42-40-1-368 (MB)
Active Pixels	2048 x 2048
Pixel Size (microns)	13.5 x 13.5 μm
Imaging Area (Diagonal)	27.6 X 27.6 mm (39.1 mm)
Full Well Capacity (e-)	100000 electrons
Typical_Readout Noise	10 e- RMS @ 500 kHz; 14 e- @ 2 MHz
Dynamic Range	79.7 dB
Anti-Blooming	None
Cooling Method	Air (Optional liquid)
Max. Cooling (Air)	60°C below ambient
Temperature Stability	0.1°C
Dark Current (typical)	0.2 eps at -30C
Interface	USB 2.0
Digitization Clock	500 kHz and 2 MHz
Data Bit Depth	16
Non-Linearity	<1%
Channels	1
Shutter	65 mm
Lens Mount	Optional Nikon F-mount or Canon EOS
Subarray Readout	Standard
External Trigger In/Out	Standard
SDK / Software	USB2 / FLIGrab
Weight	5.6 lbs (2.5 kg)
Environment	-30°C to 45°C 10% - 90% Relative Humidity
Power	

12V (100-240V AC to 12V DC power supply included). With TEC off: <1A.
TEC at 100%: 4.6A. Shutter open: 4A pulse for 100msec. Shutter held open, add 0.22A.



Absolute Quantum Efficiency

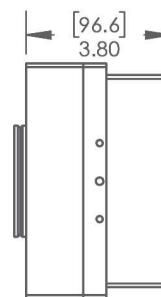
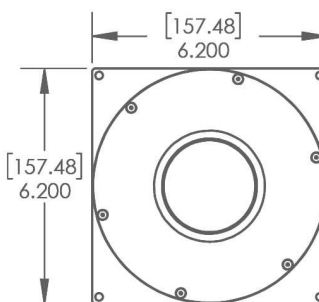
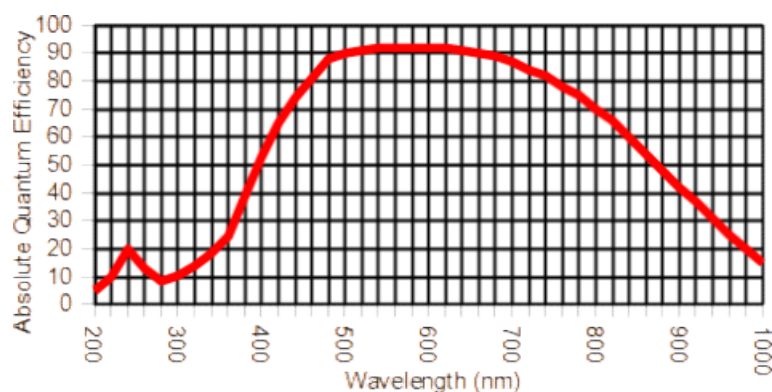

Finger Lakes Instrumentation
FLIcamera.com
USA 585-624-3760