

City of Baldwin City  
PO Box 86  
Baldwin City, Kansas 66006  
Council Meeting Agenda

Baldwin City Public Library  
800 7th St  
Baldwin City, KS 66006

TUESDAY  
November 21st, 2023  
7:00 PM



---

**A. Call to Order-Mayor Casey Simoneau**

**B. Approval of Agenda**

**C. Consent Agenda**

1. Minutes 11.07.2023
2. CMB-Kwik Shop
3. CMB-Casey's
4. CMB-Dollar Store
5. Tobacco License-Kwik Shop
6. Tobacco Licence-Casey's
7. Drinking Establishment License-The Bullpen
8. Christmas Parade

**D. Public Comment:**

*Members of the public are welcome to comment on items relating to City business not listed on this Agenda. Please stand and wait to be recognized by the Mayor. As a general practice, the comments may or may not be acted upon by the Council during the meeting, or Council may refer the items to staff for follow up.*

*If you wish to comment on an item listed on the agenda, a **sign-up sheet** is provided for you to sign in and provide your address. You will be called on when the Agenda item of interest is under discussion by the Council.*

**E. Special Reports or Presentations**

**F. Old Business**

1. CUP-Ordinance 1482-404 5th St

**City of Baldwin City  
PO Box 86  
Baldwin City, Kansas 66006  
Council Meeting Agenda**

**Baldwin City Public Library  
800 7th St  
Baldwin City, KS 66006**

**TUESDAY  
November 21st, 2023  
7:00 PM**



---

**G. New Business**

1. Generator and Truck Lease Bid

**H. Council Committee Reports**

1. Budget and Finance - Scott Lauridsen/Cory Venable
2. Community Development - Cory Venable/Susan Pitts
3. Public Safety - Susan Pitts/Jerry Smith
4. Public Works and Utilities - Julie Constantinescu/Jerry Smith
5. Strategic Planning - Scott Lauridsen/Julie Constantinescu

**I. City Administrator and Staff comments**

**J. Council and Mayor comments**

**K. Executive Session**

**L. Adjourn**

*City Council meets every first and third Tuesday of each month at 7:00 p.m. in the Library community meeting room. Council work sessions are held the last Tuesday of each month at 7:00 p.m. in the American Legion Hall.*

**City of Baldwin City**  
**Minutes**  
**Tuesday, November 7th 2023**

**A. Call to Order**

The Baldwin City Council was called to Regular Session at 7:00 p.m. at the Baldwin City Public Library, 800 7th Street, with Mayor Casey Simoneau presiding.

Present were Council Members: Cory Venable, Susan Pitts, Julie Constantinescu, and Scott Lauridsen.

Also attending: Glenn Rodden-City Administrator; Amara Packard-City Clerk; Lynn Meador-Communications Director; Dakota Loomis-City Attorney, Stu Young-Codes Administrator; Chief Mike Pattrick-Police Department; and Russ Harding-Planning and Zoning.

**B. Approval of Agenda**

Cory Venable moved and Susan Pitts seconded to approve the agenda as presented. Motion carried with a vote of 4 yes and 0 no.

**C. Consent Agenda**

1. Minutes 11.07.2023

Susan Pitts moved and Scott Lauridsen seconded to approve the consent agenda as presented. Motion carried with a vote of 4 yes and 0 no.

**D. Public Comment**

**E. Special Reports or Presentations**

**F. Old Business**

1. Trash Bid

One additional bid came in from another trash company, that was higher than Green Environmentals bid. The term lengths were five, seven, and ten years that the council discussed.

Green Environmental agreed to \$5.00 for any additional cart that citizens want outside of the one they will receive as a customer.

The Budget and Finance Committee will discuss the administrative fee that is currently billed and decide how to adjust it with the new rates.

Julie Constantinescu moved and Susan Cory Venable seconded to approve the bid from Green Environmental for a seven year term with the option of a la carte on recycling and mandatory bulk pick up once a month.

Motion carried with a vote of 4 yes and 0 no.

## **G. New Business**

### **1. Senate Bill 163**

Susan Pitts moved and Cory Venable seconded to table this letter of support for Peaslee Tech.

Motion carried with a vote of 4 yes and 0 no.

### **2. Conditional Use -404 5th St**

This was heard by the Planning Commission on October 10th with a unanimous vote in favor. The City is requesting approval as presented. The house has a private entrance and driveway to the Airbnb section of the home.

Kyle Carlson-404 5th St-is the owner of the home, requesting to have an Airbnb in their home. His mom owns Stony Point Hall just outside of town and he manages it. He and his wife would like to have the ability to have the parents of the bride or groom stay at their house in the airbnb portion, or people traveling in for an event to be able to stay there. They will have a vetted process for people staying there.

Council agreed that there is a great need for airbnb's in our community. This is the first reading.

## **H. Committee Reports**

### **1. Budget and Finance - Scott Lauridsen/Cory Venable**

Next meeting will be 11/10/23 at 7:45 a.m., 2nd floor of City Hall

### **2. Community Development - Cory Venable/Susan Pitts**

Next meeting will be 11/27/23 at 4:00 p.m., 2nd floor of City Hall

### **3. Public Safety - Susan Pitts/Jerry Smith**

Next meeting will be on 11/14/2023 at 4:00 p.m.

### **4. Public Works and Utilities - Julie Constantinescu/Jerry Smith**

Next meeting will be 11/09/23 at 9:00a.m.

### **5. Strategic Planning - Scott Lauridsen/Julie Constantinescu**

- Got notice that 300 surveys have been received.
- Casey wanted to make sure that citizens were aware that the company being used for the surveys does not give out their information, including to city staff.

Next meeting will be 11/10/23 at 2:00pm 2nd Floor of City Hall

#### **I. City Administrator and Staff Comments**

Glenn let everyone know that Christmas lights were going up this week.

#### **J. Council & Mayor Comments**

Mayor Simoneau announced that the City received the funding for the CDBG Grant, for businesses to apply for, that the city applied for, a couple of months ago. The City was awarded \$148,000.00.

Julie Constantinescu asked if there was a contract with the Recreation Commission for the Community Center. Mayor Simoneau said that the Community Development Committee will be working on that.

#### **K. Executive Session**

#### **L. Adjourn**

Mayor Simoneau wished Julie Constantinescu a Happy Anniversary, but forgot to bring a cake.

Julie Constantinescu moved and Susan Pitts seconded to adjourn the regular meeting. Motion carried with a vote of 4 yes and 0 no. Time: 7:53 p.m.

Attest:

---

Amara M. Packard

City Clerk

# CORPORATE APPLICATION FOR LICENSE TO SELL CEREAL MALT BEVERAGES

(This form has been prepared by the Attorney General's Office)

☒ City or ☐ County of Baldwin PARK CITY

## SECTION 1 – LICENSE TYPE

Check One: ☐ New License ☒ Renew License ☐ Special Event Permit

Check One:

☐ License to sell cereal malt beverages for consumption on the premises.

☒ License to sell cereal malt beverages in original and unopened containers and not for consumption on the licensed premises.

## SECTION 2 – APPLICANT INFORMATION

Kansas Sales Tax Registration Number (required): 004486112339F-01

I have registered as an Alcohol Dealer with the TTB. ☒ Yes (required for new application)

Name of Corporation KWIK SHOP, INC	FEIN 486112339		
Corporation Street Address 165 FLANDERS ROAD	Corporation City WESTBOROUGH	State MA	Zip Code 01581-1032
Date of Incorporation 04-01-1960 IN THE STATE OF KANSAS	Articles of Incorporation are on file with the Secretary of State.		<input checked="" type="checkbox"/> Yes <input type="checkbox"/> No
Resident Agent Name CSC	Phone No. 513-562-5738		
Residence Street Address 2900 WANAMAKER DR	City TOPEKA	State KS	Zip Code 66614

## SECTION 3 – LICENSED PREMISE

Licensed Premise (Business Location or Location of Special Event)		Mailing Address (If different from business address)	
DBA Name KWIK SHOP #350752	Name EG RETAIL (AMERICA) LLC / LEGAL DEPARTMENT-LICENSING		
Business Location Address 522 AMES ST	Address 165 FLANDERS ROAD		
City BALDWIN CITY	State KS	City WESTBOROUGH	State MA
Zip 66006	Zip 01581-1032		
Email Address(s) Please separate values with a comma. KS-RETAIL-LICENSING@EG-AMERICA.COM			
Business Phone No. (785) 594-2138	<input checked="" type="checkbox"/> Applicant owns the proposed business location. <input type="checkbox"/> Applicant does not own the proposed business location.		
Business Location Owner Name(s) KWIK SHOP, INC.			

## SECTION 4 – OFFICERS, DIRECTORS, STOCKHOLDERS OWNING 25% OR MORE OF STOCK

List each person and their spouse\*, if applicable. Attach additional pages if necessary.

Name EG RETAIL (AMERICA) LLC	Position 100% SHAREHOLDER	Date of Birth 03/06/2018
Residence Street Address 165 FLANDERS ROAD	City WESTBOROUGH	State MA
Zip Code 01581-1032		
Spouse Name N/A	Position N/A	Date of Birth N/A
Residence Street Address N/A	City N/A	State N/A
Zip Code N/A		
Name NICHOLAS M. UNKOVIC	Position PRESIDENT	Date of Birth 06/02/78
Residence Street Address 1 LYDIA'S PATH	City WESTBOROUGH	State MA
Zip Code 01581		
Spouse Name KRISTIE UNKOVIC	Position N/A	Age 02/26/78
Residence Street Address 1 LYDIA'S PATH	City WESTBOROUGH	State MA
Zip Code 01581		
Name LISA M. N'CHONON	Position TREASURER	Date of Birth 07/07/75
Residence Street Address 63 ANDERSON RD	City POMFRET CENTER	State CT
Zip Code 06259		
Spouse Name YVON-JOEL N'CHONON	Position N/A	Age 11/18/75
Residence Street Address 63 ANDERSON RD	City POMFRET CENTER	State CT
Zip Code 06259		

# SECTION 4 – OFFICERS, DIRECTORS, STOCKHOLDERS OWNING 25% OR MORE OF STOCK (CONTINUED)

Name	LAURA S. SHERMAN	Position	SECRETARY	Date of Birth	04/15/77
Residence Street Address	24 MAGNOLIA ST	City	CONCORD	State	MA
Zip Code	01742				
Spouse Name	TERRY S. SHERMAN	Position	N/A	Date of Birth	11/23/76
Residence Street Address	24 MAGNOLIA ST	City	CONCORD	State	MA
Zip Code	01742				
Name		Position		Date of Birth	
Residence Street Address		City		State	
Zip Code					
Spouse Name		Position		Date of Birth	
Residence Street Address		City		State	
Zip Code					
Name		Position		Date of Birth	
Residence Street Address		City		State	
Zip Code					
Spouse Name		Position		Date of Birth	
Residence Street Address		City		State	
Zip Code					
Name		Position		Date of Birth	
Residence Street Address		City		State	
Zip Code					
Spouse Name		Position		Date of Birth	
Residence Street Address		City		State	
Zip Code					
Name		Position		Date of Birth	
Residence Street Address		City		State	
Zip Code					
Spouse Name		Position		Date of Birth	
Residence Street Address		City		State	
Zip Code					
Name		Position		Date of Birth	
Residence Street Address		City		State	
Zip Code					
Spouse Name		Position		Date of Birth	
Residence Street Address		City		State	
Zip Code					
Name		Position		Date of Birth	
Residence Street Address		City		State	
Zip Code					
Spouse Name		Position		Date of Birth	
Residence Street Address		City		State	
Zip Code					
Name		Position		Date of Birth	
Residence Street Address		City		State	
Zip Code					
Spouse Name		Position		Date of Birth	
Residence Street Address		City		State	
Zip Code					
Name		Position		Date of Birth	
Residence Street Address		City		State	
Zip Code					
Spouse Name		Position		Date of Birth	
Residence Street Address		City		State	
Zip Code					

<b>SECTION 5 – MANAGER OR AGENT INFORMATION</b>		
My place of business or special event will be conducted by a manager or agent.		<input checked="" type="checkbox"/> Yes <input type="checkbox"/> No
If yes, provide the following:		
Manager/Agent Name AMY J STALKFLEET	Phone No. (785) 551-8277	Date of Birth 02/20/76
Residence Street Address 1505 OAK HILL AVE	City and State LAWRENCE, KS	Zip Code 66044
<b>Manager or Agent Spousal Information*</b>		
Spouse Name JASON STALKFLEET	Phone No. (785) 383-7258	Date of Birth 09/03/73
Residence Street Address 1505 OAK HILL AVE	City and State LAWRENCE, KS	Zip Code 66044
<b>SECTION 6 – QUALIFICATIONS FOR LICENSURE</b>		
Applies to each partner or member of a firm or association AND their spouses*. Enter lowest residency length number**.		
Are all persons identified in Sections 4 & 5 Citizens of the United States*?	<input checked="" type="checkbox"/> Yes <input type="checkbox"/> No	
Is the person identified in Section 5 currently a resident of Kansas*?	<input checked="" type="checkbox"/> Yes <input type="checkbox"/> No	
All persons identified in Sections 4 & 5 are at least 21 years old*?	<input checked="" type="checkbox"/> Yes <input type="checkbox"/> No	
All persons in Sections 4 & 5 have been a Kansas resident for at least 7 years prior to submitting this application.**		
Within 2 years immediately preceding the date of this application, have any persons identified in Sections 4 & 5 been convicted of, released from incarceration for or released from probation or parole for any of the following crimes*: (1) Any felony; (2) a crime involving moral turpitude; (3) drunkenness; (4) driving a motor vehicle while under the influence of alcohol (DUI); or (5) violation of any state or federal intoxicating liquor law?	<input type="checkbox"/> Yes <input checked="" type="checkbox"/> No	
Does the partnership, firm or association have a manager, officer, director or stockholder owning in the aggregate more than 25% of the stock of a corporation that has had any license issued pursuant to the Kansas Liquor Control Act, Kansas Club and Drinking Establishment Act or Kansas Cereal Malt Beverage Act, revoked for a violation of such acts?	<input type="checkbox"/> Yes <input checked="" type="checkbox"/> No	
Has the spouse of any partner or member ever been convicted of any of the crimes identified in Section 6 during the time the partner or member held a CMB license?	<input type="checkbox"/> Yes <input checked="" type="checkbox"/> No	
<b>SECTION 7 – DURATION OF SPECIAL EVENT</b>		
Start Date N/A	Time	<input type="checkbox"/> AM <input type="checkbox"/> PM
End Date N/A	Time	<input type="checkbox"/> AM <input type="checkbox"/> PM

Proceed to Section 8 on the next page.



## SECTION 8 – LICENSED PREMISE

In the space below, draw the area you wish to sell or deliver CMB. Include entrances, exits and storage areas. Do not include areas you do not wish to license. If you wish to attach a drawing, check the box: ☒ 8 ½" by 11" drawing attached.



I declare under penalty of perjury under the laws of the State of Kansas that the foregoing is true and correct and that I am authorized by the corporation to complete this application. (K.S.A. 53-601)

SIGNATURE Kwik Shop, Inc. by [Signature] DATE 09/21/23

FOR CITY/COUNTY OFFICE USE ONLY:

☐ License Fee Received Amount \$ \_\_\_\_\_ Date \_\_\_\_\_  
( \$25 - \$50 for Off-Premise license or \$25-200 On-Premise license )

☐ \$25 CMB Stamp Fee Received Date \_\_\_\_\_

☐ Background Investigation ☐ Completed Date \_\_\_\_\_ ☐ Qualified ☐ Disqualified

☐ Verified applicant has registered with the TTB as an Alcohol Dealer

☐ New License Approved Valid From Date \_\_\_\_\_ to \_\_\_\_\_ By: \_\_\_\_\_

☐ License Renewed Valid From Date \_\_\_\_\_ to \_\_\_\_\_ By: \_\_\_\_\_

☐ Special Event Permit Approved Valid From Date \_\_\_\_\_ to \_\_\_\_\_ By: \_\_\_\_\_

A PHOTOCOPY OF THE COMPLETED FORM, TOGETHER WITH THE STAMP FEE REQUIRED BY K.S.A. 41-2702(e), MUST BE SUBMITTED WITH YOUR MONTHLY REPORT (ABC-307) TO THE ALCOHOLIC BEVERAGE CONTROL, 109 SW 9TH ST, 5TH FLOOR, PO BOX 3506, TOPEKA, KS 66601.

\* Applicant's spouse is not required to meet citizenship or age requirements. If renewal application, applicant's spouse is not required to meet the no criminal history requirement. K.S.A. 41-2703(b)(9)

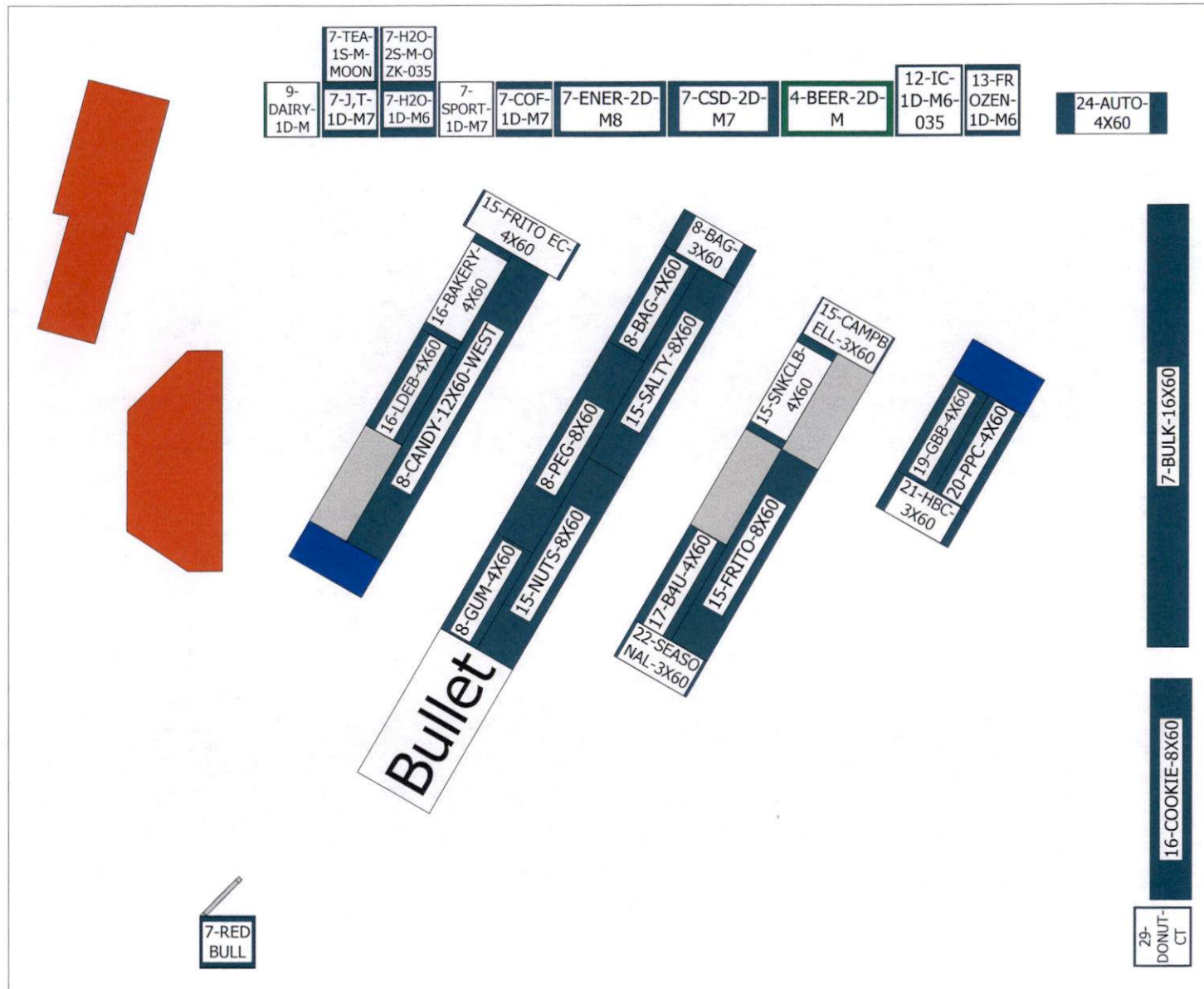

035-0752  
 522 Ames Street, Baldwin City, KS  
 25 Feb 2020





**POG's Added or Moved**

	Added	Name	POG Desc	Category	Height	Width	Depth
1		4-BEER-2D-M	Beer, 2 Doors, Medium (UNASSIGNED)	Beer	78 in	48 in	24 in
2		7-BULK-16X60	12-Pack Warm CSD - 16' X 60"	Packaged Beverages (Non-alcoholic)	60 in	192 in	18 in
3		7-COF-1D-M7	Coffee, 1 Door, Medium, 7 Shelves	Packaged Beverages (Non-alcoholic)	78 in	24 in	24 in
4		7-CSD-2D-M7	CSD 2-Door, Medium, 7 Shelves	Packaged Beverages (Non-alcoholic)	78 in	48 in	24 in
5		7-ENER-2D-M8	Energy, 2 Door, Medium, 8 Shelves	Packaged Beverages (Non-alcoholic)	78 in	48 in	24 in
6		7-H2O-2S-M-OZK-035	Water Sub POG,, 2 Shelves, Medium, Ozarka	Packaged Beverages (Non-alcoholic)	20 in	24 in	24 in
7		7-H2O-1D-M6	Water, 1 Door, Medium, 6 Shelves	Packaged Beverages (Non-alcoholic)	78 in	24 in	24 in
8		7-J,T-1D-M7	Juice, Tea, 1 Door, Medium, 7 Shelves	Packaged Beverages (Non-alcoholic)	78 in	24 in	24 in
9		7-REDBULL	12-Pack Warm CSD - 3' X 60"	Packaged Beverages (Non-alcoholic)	47 in	23 in	22 in
10		7-SPORT-1D-M7	Sport, 1 Door, Medium, 7 Shelves	Packaged Beverages (Non-alcoholic)	78 in	24 in	24 in
11		7-TEA-1S-M-MOON	Tea Sub POG, 1 Shelf, Medium, Moonshine	Packaged Beverages (Non-alcoholic)	10 in	24 in	24 in
12		8-BAG-4X60	Stand-Up Bags - 4' X 60"	Candy	60 in	48 in	18 in
13		8-BAG-3X60	Stand-Up Bags - 3' X 60"	Candy	60 in	36 in	18 in
14		8-CANDY-12X60-WEST	Candy Bars ONLY - 12' X 60" - West Division	Candy	60 in	144 in	18 in
15		8-GUM-4X60	Gum and Mint End Cap - 4' X 60"	Candy	60 in	48 in	18 in
16		8-PEG-8X60	Peg Candy - 8' X 60"	Candy	60 in	96 in	18 in
17		9-DAIRY-1D-M	Dairy, 1 Door, Medium (UNASSIGNED)	Fluid Milk Products	78 in	24 in	24 in
18		12-IC-1D-M6-035	Ice Cream Novelty Upright Case - 1-Door	Packaged Ice Cream/Novelties	78 in	29 in	31 in
19		13-FROZEN-1D-M6	Frozen Food (Stand-Alone) - 1-Door, Medium, 6 Shelves	Frozen Food	72 in	24 in	31 in
20		15-CAMPBELL-3X60	Campbell Salty Snacks - 3' X 60"	Salty Snacks	60 in	36 in	18 in
21		15-FRITO-8X60	Frito DSD Chips- 8' X 60"	Salty Snacks	60 in	96 in	18 in
22		15-FRITO EC-4X60	Frito DSD Chips End Cap- 4' X 60"	Salty Snacks	60 in	48 in	18 in
23		15-NUTS-8X60	Nuts & Seeds - 8' X 60"	Salty Snacks	60 in	96 in	18 in
24		15-SALTY-8X60	Salty - 8' X 60"	Salty Snacks	60 in	96 in	18 in
25		15-SNKLCLB-4X60	Snack Club - 4' X 60"	Salty Snacks	60 in	48 in	18 in
26		16-BAKERY-4X60	Packaged Bakery Sweats - 4' X 60"	Packaged Sweet Snacks	60 in	48 in	18 in
27		16-COOKIE-8X60	Cookie & Cracker - 8' X 60"	Packaged Sweet Snacks	60 in	96 in	18 in
28		16-LDEB-4X60	Little Debbie DSD Snacks - 4' X 60"	Packaged Sweet Snacks	60 in	48 in	18 in
29		17-B4U-4X60	"Better For You" Snacks - 4' X 60"	Alternative Snacks	60 in	48 in	18 in
30		19-GBB-4X60	Gorcery, Bread, & Breakfast - 4' X 60"	Edible Grocery	60 in	48 in	18 in
31		20-PPC-4X60	Paper, Pet, & Cleaning Supplies - 4' X 60"	Non-edible Grocery	60 in	48 in	18 in
32		21-HBC-3X60	Health, Beauty, & Cosmetics - 3' X 60"	Health & Beauty Care	60 in	36 in	18 in
33		22-SEASONAL-3X60	Seasonal Merchandise - 3' X 60"	General Merchandise	60 in	36 in	18 in
34		24-AUTO-4X60	Automotive Merchandise - 4' X 60"	Automotive Products	60 in	48 in	18 in
35		29-DONUT-CT	EG Donut Program - Counter Top Display	Fast Food Retail	64 in	26 in	25 in



**KwikShop**

035-0752  
522 Ames Street, Baldwin City, KS  
25 Feb 2020



## Planogram Section Changes Between Two Floorplans

This table compares the first two floorplans in a multiple-floorplan project.

### Floorplan # 1: 035-0752 - 1

### Floorplan # 2: 035-0752 - 2

ID(Planogram)	Name(Planogram)	Fixture Change	Size Change
1510191415	15-ROCKY-4X60	<span style="color: red;">X</span> Removed from <4 X 60>	- 48.00 in ▼



**KwikShop**

035-0752  
522 Ames Street, Baldwin City, KS  
25 Feb 2020





BLPOST21 Thu Oct 26, 2023 11:29 AM  
07.01.21 POSTING DATE 10/26/2023

City of Baldwin City  
BILLING & LICENSING RECURRING TRANS  
CALENDAR 10/2023, FISCAL 10/2023

OPER: SHA  
JRNL:2350  
PAGE 1

SEQ	CUST#	NAME	BILL TYPE	CREATE	START	END DATE/#	RENEWAL TYPE/FREQ	NEXT RENEWAL DT	DT	
BILL CODE	LINE	DESCRIPTION				PRICE	QTY	EXT PRICE	TAX EXEMPT CODE	GLDIST ID

14	394	KWIK SHOP	CMB	10/26/23	12/31/23		Yearly every 12-31			
CMB	1	CEREAL MALT BEVERAGE				75.00	1.00	75.00	1	CMB
Renewed through 12/31/2024 on Payment										



165 FLANDERS ROAD  
WESTBOROUGH, MA 01581  
PHONE: (888) 200-6211

No. 659969

Check Date: 09/19/2023

Vendor Name: CITY OF BALDWIN CITY

Vendor No: 34587

Check Date: 09/19/2023																							
INVOICE NUMBER	PURCHASE ORDER	INVOICE DATE	MERCHANDISE AMOUNT	DISCOUNT AMOUNT	NET AMOUNT																		
258639		09/19/2023	75.00	0.00	75.00																		
<div>CITY OF BALDWIN CITY 803 EIGHTH STREET P O BOX 86 BALDWIN CITY KS 66006-0086</div> <div><table><tr><th>Description</th><th>Amount</th></tr><tr><td>ACCOUNT #</td><td>394</td></tr><tr><td>KWIK SHOP</td><td></td></tr><tr><td>LICENSE 2024</td><td></td></tr><tr><td>CMB/LIQUOR LIC</td><td>75.00</td></tr><tr><td>ACCOUNT BAL</td><td>.00</td></tr><tr><td>CHECK #</td><td>659969</td></tr><tr><td>CHECK Received</td><td>75.00</td></tr><tr><td>Change</td><td>659969</td></tr></table></div> <div>SHA 10/26/23 11:31 Rcpt# 594040</div>						Description	Amount	ACCOUNT #	394	KWIK SHOP		LICENSE 2024		CMB/LIQUOR LIC	75.00	ACCOUNT BAL	.00	CHECK #	659969	CHECK Received	75.00	Change	659969
Description	Amount																						
ACCOUNT #	394																						
KWIK SHOP																							
LICENSE 2024																							
CMB/LIQUOR LIC	75.00																						
ACCOUNT BAL	.00																						
CHECK #	659969																						
CHECK Received	75.00																						
Change	659969																						

PLEASE DETACH AND RETAIN THIS STATEMENT AS YOUR RECORD OF PAYMENT.

Thank You.

75.00

0.00

75.00

# CORPORATE APPLICATION FOR LICENSE TO SELL CEREAL MALT BEVERAGES

(This form has been prepared by the Attorney General's Office)

☒ City or ☐ County of

**BALDWIN CITY**

## SECTION 1 – LICENSE TYPE

Check One: ☐ New License ☒ Renew License ☐ Special Event Permit

Check One:

☐ License to sell cereal malt beverages for consumption on the premises.

☒ License to sell cereal malt beverages in original and unopened containers and not for consumption on the licensed premises.

## SECTION 2 – APPLICANT INFORMATION

Kansas Sales Tax Registration Number (required): 004-201025921F-01

I have registered as an Alcohol Dealer with the TTB. ☒ Yes (required for new application)

Name of Corporation CASEY'S RETAIL COMPANY	FEIN 20-1025921		
Corporation Street Address ONE SE CONVENIENCE BLVD	Corporation City ANKENY	State IA	Zip Code 50021
Date of Incorporation 04/14/04	Articles of Incorporation are on file with the Secretary of State.		<input checked="" type="checkbox"/> Yes <input type="checkbox"/> No
Resident Agent Name CT CORPORATION SYSTEM	Phone No. 866-331-2303		
Residence Street Address 112 SW 7TH ST, STE 3C	City TOPEKA	State KS	Zip Code 66603

## SECTION 3 – LICENSED PREMISE

Licensed Premise (Business Location or Location of Special Event)	Mailing Address (If different from business address)
DBA Name CASEY'S #3937	Name CASEY'S RETAIL COMPANY, ATTN: BECKY PETERSON
Business Location Address 511 AMES ST	Address 1 SE CONVENIENCE BLVD
City BALDWIN CITY, KS 66006	City ANKENY, IA 50021
State KS	State IA
Zip 66006	Zip 50021
Email Address(s) Please separate values with a comma. BECKY.PETERSON@CASEYS.COM OR LICENSINGTEAM@CASEYS.COM	
Business Phone No. 785-594-2830	<input checked="" type="checkbox"/> Applicant owns the proposed business location. <input type="checkbox"/> Applicant does not own the proposed business location.
Business Location Owner Name(s) CASEY'S RETAIL COMPANY	

## SECTION 4 – OFFICERS, DIRECTORS, STOCKHOLDERS OWNING 25% OR MORE OF STOCK

List each person and their spouse\*, if applicable. Attach additional pages if necessary.

Name	Position	Date of Birth
NO PERSONS INDIVIDUALLY OR IN AGGREGATE OWN 25% OR MORE OF CORPORATE STOCK		
Residence Street Address	City	State
Spouse Name	Position	Date of Birth
Residence Street Address	City	State
Name	Position	Date of Birth
Residence Street Address	City	State
Spouse Name	Position	Age
Residence Street Address	City	State
Name	Position	Date of Birth
Residence Street Address	City	State
Spouse Name	Position	Age
Residence Street Address	City	State

**SECTION 4 – OFFICERS, DIRECTORS, STOCKHOLDERS OWNING 25% OR MORE OF STOCK (CONTINUED)**

Name	Position	Date of Birth
Residence Street Address	City	State Zip Code
Spouse Name	Position	Date of Birth
Residence Street Address	City	State Zip Code
Name	Position	Date of Birth
Residence Street Address	City	State Zip Code
Spouse Name	Position	Date of Birth
Residence Street Address	City	State Zip Code
Name	Position	Date of Birth
Residence Street Address	City	State Zip Code
Spouse Name	Position	Date of Birth
Residence Street Address	City	State Zip Code
Name	Position	Date of Birth
Residence Street Address	City	State Zip Code
Spouse Name	Position	Date of Birth
Residence Street Address	City	State Zip Code
Name	Position	Date of Birth
Residence Street Address	City	State Zip Code
Spouse Name	Position	Date of Birth
Residence Street Address	City	State Zip Code
Name	Position	Date of Birth
Residence Street Address	City	State Zip Code
Spouse Name	Position	Date of Birth
Residence Street Address	City	State Zip Code
Name	Position	Date of Birth
Residence Street Address	City	State Zip Code
Spouse Name	Position	Date of Birth
Residence Street Address	City	State Zip Code
Name	Position	Date of Birth
Residence Street Address	City	State Zip Code
Spouse Name	Position	Date of Birth
Residence Street Address	City	State Zip Code
Name	Position	Date of Birth
Residence Street Address	City	State Zip Code
Spouse Name	Position	Date of Birth
Residence Street Address	City	State Zip Code





**SECTION 8 – LICENSED PREMISE**

In the space below, draw the area you wish to sell or deliver CMB. Include entrances, exits and storage areas. Do not include areas you do not wish to license. If you wish to attach a drawing, check the box: ☒ 8 1/2" by 11" drawing attached.



I declare under penalty of perjury under the laws of the State of Kansas that the foregoing is true and correct and that I am authorized by the corporation to complete this application. (K.S.A. 53-601)

SIGNATURE

*Douglas M. Beeler*

DATE 9/25/2023

**FOR CITY/COUNTY OFFICE USE ONLY:**

☐ License Fee Received Amount \$ \_\_\_\_\_ Date \_\_\_\_\_  
(\$25 - \$50 for Off-Premise license or \$25-200 On-Premise license)

☐ \$25 CMB Stamp Fee Received Date \_\_\_\_\_

☐ Background Investigation

☐ Completed Date \_\_\_\_\_

☐ Qualified

☐ Disqualified

☐ Verified applicant has registered with the TTB as an Alcohol Dealer

☐ New License Approved

Valid From Date \_\_\_\_\_ to \_\_\_\_\_ By: \_\_\_\_\_

☐ License Renewed

Valid From Date \_\_\_\_\_ to \_\_\_\_\_ By: \_\_\_\_\_

☐ Special Event Permit Approved

Valid From Date \_\_\_\_\_ to \_\_\_\_\_ By: \_\_\_\_\_

A PHOTOCOPY OF THE COMPLETED FORM, TOGETHER WITH THE STAMP FEE REQUIRED BY K.S.A. 41-2702(e), MUST BE SUBMITTED WITH YOUR MONTHLY REPORT (ABC-307) TO THE ALCOHOLIC BEVERAGE CONTROL, 109 SW 9TH ST, 5TH FLOOR, PO BOX 3506, TOPEKA, KS 66601.

\* Applicant's spouse is not required to meet citizenship or age requirements. If renewal application, applicant's spouse is not required to meet the no criminal history requirement. K.S.A. 41-2703(b)(9)

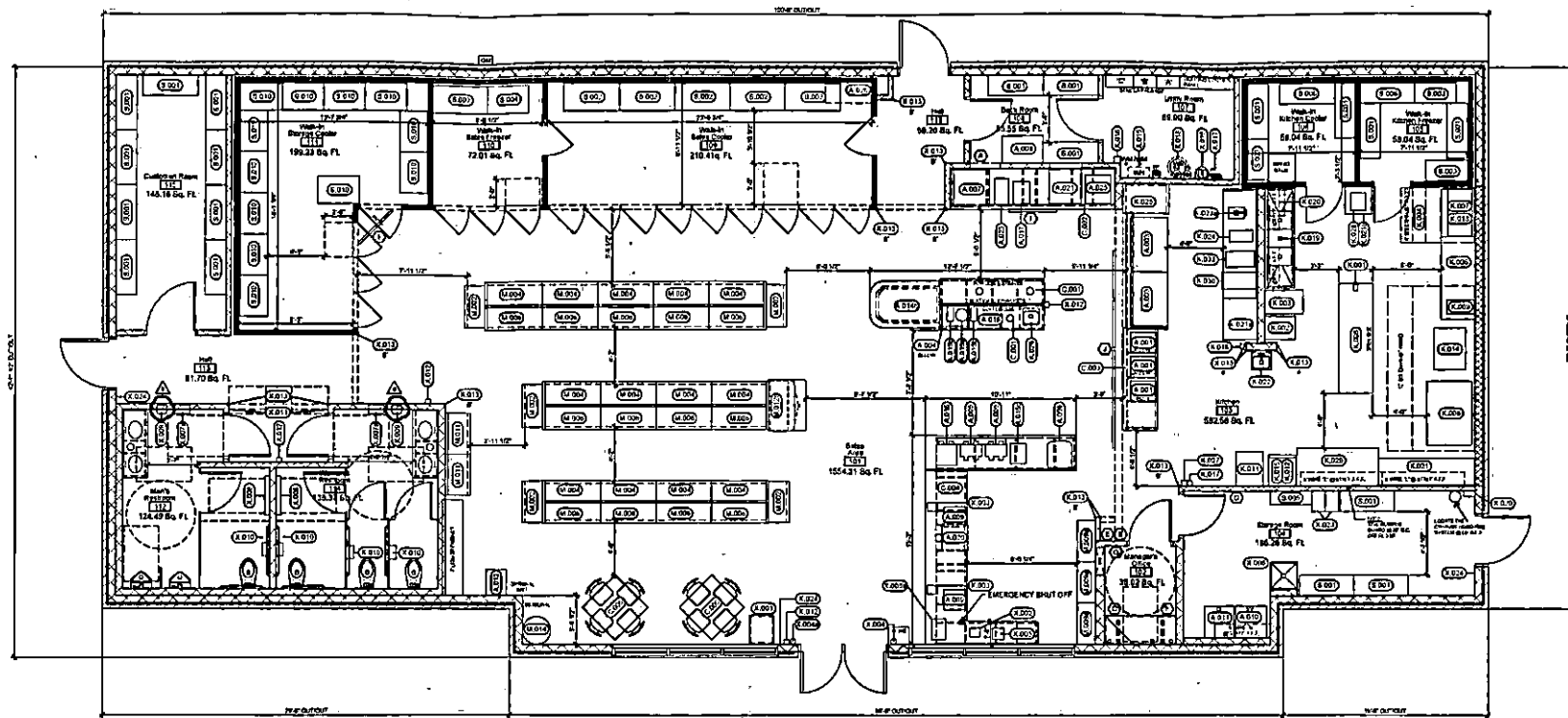

**Equipment and Fixture Floor Plan**   
1/4" = 1'-0"

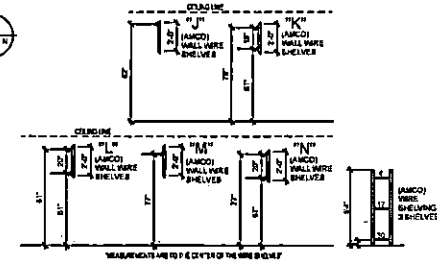
[illegible]

### Shelving Components 1

CONTRACTOR TO ASSEMBLE SHELVES & R.I.S.M  
A STORAGE SHELVING SYSTEM/INCREASING AND TO THE  
CENTER OF THE WAREHOUSE

CONTRACTOR TO ASSEMBLE STORAGE SHELVING, APPROX  
8' OF CLEARANCE FROM BOTTOM RAIL TO FLOOR

### Remote Pull Detail

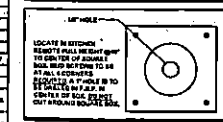

		<b>SCHEMMER</b> Design with Program. Minimum Qualities.	
CASEY'S GENERAL STORE 561 AMES ST. & 108 8TH ST. BIRMINGHAM CITY, ALA. 4 <sup>th</sup> FLOOR STORE (NEAR BOON BRICK-SHED)		 10-17-2020 EQUIPMENT PLAN <b>AQ-101</b>	

# CORPORATE APPLICATION FOR LICENSE TO SELL CEREAL MALT BEVERAGES

8315

(This form has been prepared by the Attorney General's Office)

☒ City or ☐ County of **BALDWIN CITY , KS**

## SECTION 1 – LICENSE TYPE

Check One: ☐ New License ☒ Renew License ☐ Special Event Permit

Check One:

☐ License to sell cereal malt beverages for consumption on the premises.

☒ License to sell cereal malt beverages in original and unopened containers and not for consumption on the licensed premises.

## SECTION 2 – APPLICANT INFORMATION

Kansas Sales Tax Registration Number (required):

00436477242F

I have registered as an Alcohol Dealer with the TTB. ☒ Yes (required for new application)

Name of Corporation

DG Retail, LLC

FEIN

36 - 4577242

Corporation Street Address

100 Mission Ridge

Corporation City

Goodlettsville

State

TN

Zip Code

37072

Date of Incorporation

7/15/2005

Articles of Incorporation are on file with the Secretary of State.

☒ Yes

☐ No

Resident Agent Name

NICOLE MORGAN

Phone No.

(615) 306-0794

Residence Street Address

1398 E HIGHWAY K31

City

MELVERN KS 66510-9322

State

Zip Code

## SECTION 3 – LICENSED PREMISE

**Licensed Premise**  
(Business Location or Location of Special Event)

**Mailing Address**  
(If different from business address)

DBA Name

Dollar General Store #8315

Name

Dollar General Store #8315

Business Location Address

110 NORTH 8TH

Address

100 Mission Ridge Attn: Tax Dept

City

BALDWIN CITY

State

KS

Zip

City

Goodlettsville

State

TN

Zip

37072

Email Address(es) Please separate values with a comma.

tax-beerandwinelicense@dollargeneral.com

Business Phone No.

(615) 306-0794

☐ Applicant owns the proposed business location.

☐ Applicant does not own the proposed business location.

Business Location Owner Name(s)

Jeffery Aiden Simpson

## SECTION 4 – OFFICERS, DIRECTORS, STOCKHOLDERS OWNING 25% OR MORE OF STOCK

List each person and their spouse\*, if applicable. Attach additional pages if necessary.

Name

No person owns 25% or more of stock

Position

Date of Birth

Residence Street Address

City

State

Zip Code

Spouse Name

Position

Date of Birth

Residence Street Address

City

State

Zip Code

Name

Position

Date of Birth

Residence Street Address

City

State

Zip Code

Spouse Name

Position

Age

Residence Street Address

City

State

Zip Code

Name

Position

Date of Birth

Residence Street Address

City

State

Zip Code

Spouse Name

Position

Age

Residence Street Address

City

State

Zip Code

**SECTION 4 – OFFICERS, DIRECTORS, STOCKHOLDERS OWNING 25% OR MORE OF STOCK (CONTINUED)**

Name	Position	Date of Birth
Residence Street Address	City	State Zip Code
Spouse Name	Position	Date of Birth
Residence Street Address	City	State Zip Code
Name	Position	Date of Birth
Residence Street Address	City	State Zip Code
Spouse Name	Position	Date of Birth
Residence Street Address	City	State Zip Code
Name	Position	Date of Birth
Residence Street Address	City	State Zip Code
Spouse Name	Position	Date of Birth
Residence Street Address	City	State Zip Code
Name	Position	Date of Birth
Residence Street Address	City	State Zip Code
Spouse Name	Position	Date of Birth
Residence Street Address	City	State Zip Code
Name	Position	Date of Birth
Residence Street Address	City	State Zip Code
Spouse Name	Position	Date of Birth
Residence Street Address	City	State Zip Code
Name	Position	Date of Birth
Residence Street Address	City	State Zip Code
Spouse Name	Position	Date of Birth
Residence Street Address	City	State Zip Code
Name	Position	Date of Birth
Residence Street Address	City	State Zip Code
Spouse Name	Position	Date of Birth
Residence Street Address	City	State Zip Code
Name	Position	Date of Birth
Residence Street Address	City	State Zip Code
Spouse Name	Position	Date of Birth
Residence Street Address	City	State Zip Code
Name	Position	Date of Birth
Residence Street Address	City	State Zip Code
Spouse Name	Position	Date of Birth
Residence Street Address	City	State Zip Code

<b>SECTION 5 – MANAGER OR AGENT INFORMATION</b>			
My place of business or special event will be conducted by a manager or agent.			<input checked="" type="checkbox"/> Yes <input type="checkbox"/> No
If yes, provide the following:			
Manager/Agent Name <b>NICOLE MORGAN</b>		Phone No. <b>(615) 306-0794</b>	Date of Birth <b>10/19/1980</b>
Residence Street Address <b>1398 E HIGHWAY K31</b>		City and State <b>MELVERN KS 66510</b>	Zip Code <b>66510-9322</b>
<b>Manager or Agent Spousal Information*</b>			
Spouse Name		Phone No.	Date of Birth
Residence Street Address		City and State	Zip Code
<b>SECTION 6 – QUALIFICATIONS FOR LICENSURE</b>			
Applies to each partner or member of a firm or association AND their spouses*. Enter lowest residency length number**.			
Are all persons identified in Sections 4 & 5 Citizens of the United States*?			<input checked="" type="checkbox"/> Yes <input type="checkbox"/> No
Is the person identified in Section 5 currently a resident of Kansas*?			<input checked="" type="checkbox"/> Yes <input type="checkbox"/> No
All persons identified in Sections 4 & 5 are at least 21 years old*?			<input checked="" type="checkbox"/> Yes <input type="checkbox"/> No
All persons in Sections 4 & 5 have been a Kansas resident for at least <b>43</b> years prior to submitting this application.**			
Within 2 years immediately preceding the date of this application, have any persons identified in Sections 4 & 5 been convicted of, released from incarceration for or released from probation or parole for any of the following crimes*: (1) Any felony; (2) a crime involving moral turpitude; (3) drunkenness; (4) driving a motor vehicle while under the influence of alcohol (DUI); or (5) violation of any state or federal intoxicating liquor law?			<input type="checkbox"/> Yes <input checked="" type="checkbox"/> No
Does the partnership, firm or association have a manager, officer, director or stockholder owning in the aggregate more than 25% of the stock of a corporation that has had any license issued pursuant to the Kansas Liquor Control Act, Kansas Club and Drinking Establishment Act or Kansas Cereal Malt Beverage Act, revoked for a violation of such acts?			<input type="checkbox"/> Yes <input checked="" type="checkbox"/> No
Has the spouse of any partner or member ever been convicted of any of the crimes identified in Section 6 during the time the partner or member held a CMB license?			<input type="checkbox"/> Yes <input checked="" type="checkbox"/> No
<b>SECTION 7 – DURATION OF SPECIAL EVENT</b>			
Start Date	Time	<input type="checkbox"/> AM <input type="checkbox"/> PM	
End Date	Time	<input type="checkbox"/> AM <input type="checkbox"/> PM	

Proceed to Section 8 on the next page.

## SECTION 8 – LICENSED PREMISE

In the space below, draw the area you wish to sell or deliver CMB. Include entrances, exits and storage areas. Do not include areas you do not wish to license. If you wish to attach a drawing, check the box: ☒ 8 1/2" by 11" drawing attached.



I declare under penalty of perjury under the laws of the State of Kansas that the foregoing is true and correct and that I am authorized by the corporation to complete this application. (K.S.A. 53-601)

SIGNATURE Ally Hatcher

DATE 09/28/23

### FOR CITY/COUNTY OFFICE USE ONLY:

☐ License Fee Received Amount \$ \_\_\_\_\_ Date \_\_\_\_\_  
(\$25 - \$50 for Off-Premise license or \$25-200 On-Premise license)

☐ \$25 CMB Stamp Fee Received Date \_\_\_\_\_

☐ Background Investigation

☐ Completed Date \_\_\_\_\_

☐ Qualified

☐ Disqualified

☐ Verified applicant has registered with the TTb as an Alcohol Dealer

☐ New License Approved

Valid From Date \_\_\_\_\_ to \_\_\_\_\_ By: \_\_\_\_\_

☐ License Renewed

Valid From Date \_\_\_\_\_ to \_\_\_\_\_ By: \_\_\_\_\_

☐ Special Event Permit Approved

Valid From Date \_\_\_\_\_ to \_\_\_\_\_ By: \_\_\_\_\_

A PHOTOCOPY OF THE COMPLETED FORM, TOGETHER WITH THE STAMP FEE REQUIRED BY K.S.A. 41-2702(e), MUST BE SUBMITTED WITH YOUR MONTHLY REPORT (ABC-307) TO THE ALCOHOLIC BEVERAGE CONTROL, 109 SW 9TH ST, 5TH FLOOR, PO BOX 3506, TOPEKA, KS 66601.

\* Applicant's spouse is not required to meet citizenship or age requirements. If renewal application, applicant's spouse is not required to meet the no criminal history requirement. K.S.A. 41-2703(b)(9)







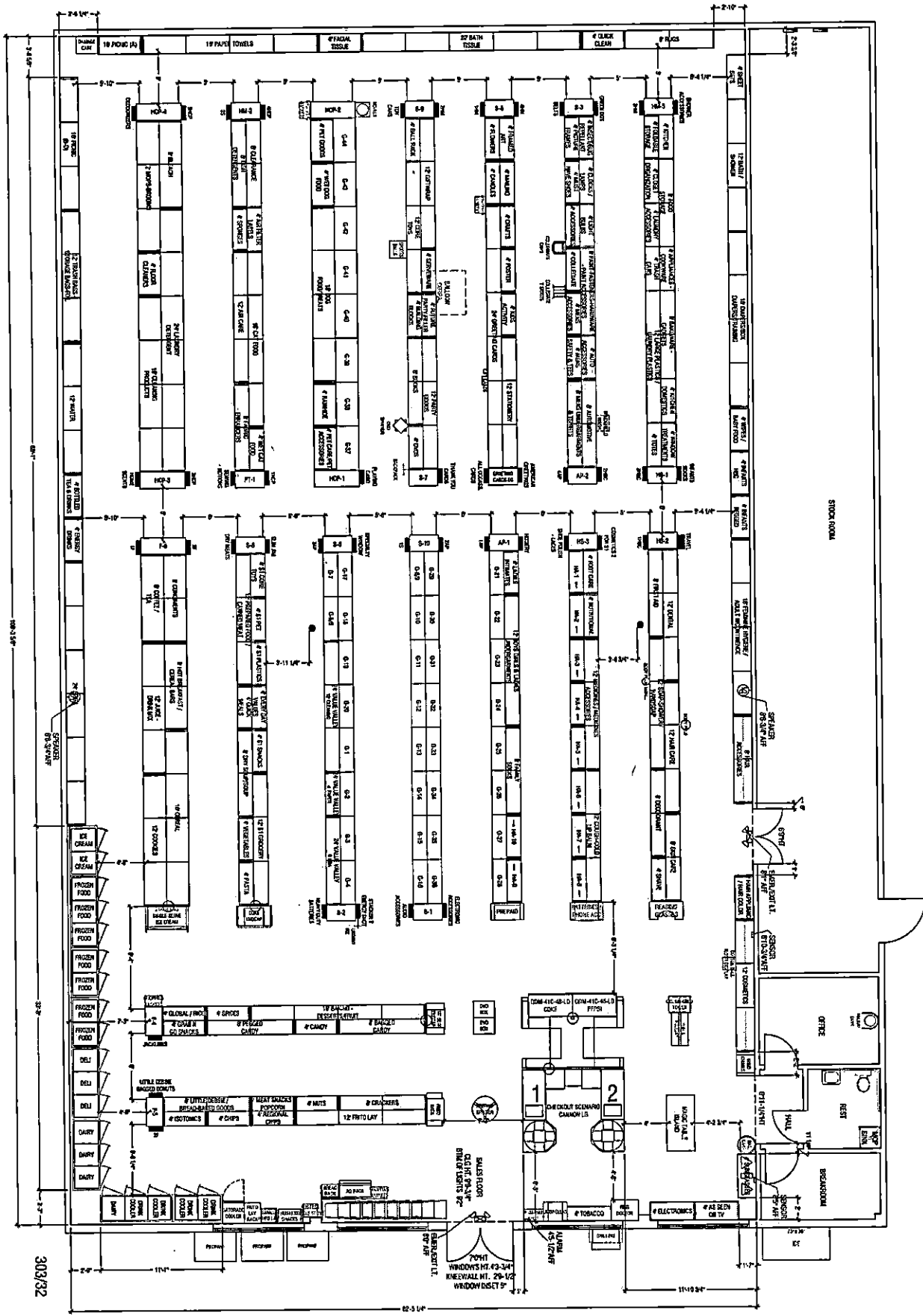

FRAME AND HANG ON OFFICE WALL

**DOLLAR GENERAL**

DATE: 01/15/16 BY: SES  
DRAWING HISTORY  
1) 01/28/16 SES  
2) 02/02/16 SES  
3) 02/02/16 SES  
4) 02/02/16 SES  
5) 02/02/16 SES  
6) 02/02/16 SES  
7) 02/02/16 SES  
8) 02/02/16 SES  
9) 02/02/16 SES  
10) 02/02/16 SES

PROJECT: REMODEL  
SMALL  
CONVENTIONAL  
DO16-6  
STANDARD  
02/21/16  
6.761  
8.000  
9'-0 3/4"  
9'-2"  
168  
\$1,722,699  
08315  
110 NORTH 8TH  
BALDWIN CITY  
MO 64006  
STORE PLANNING HOTLINE  
(816) 855-4192

SEQ	CUST#	NAME	BILL TYPE	CREATE	START	END DATE/#	RENEWAL TYPE/FREQ	NEXT RENEWAL DT	
BILL CODE	LINE	DESCRIPTION			PRICE	QTY	EXT PRICE	TAX EXEMPT CODE	GLDIST ID
6	703	DOLLAR GENERAL	CMB	10/26/23	12/31/23		Yearly every 12-31		
CMB	1	CEREAL MALT BEVERAGE			75.00	1.00	75.00	1	CMB
Renewed through 12/31/2024 on Payment									

Dollar General Corporation · 100 Mission Ridge · Goodlettsville, TN 37072-2171

VENDOR ID 311123BALDWIN CITY CITY OF

CHECK NO. 7717988

DATE 10/12/2023  
PAGE 1

INVOICE NO	DESCRIPTION	PO NUMBER	GROSS	DISCOUNT	NET
202408315BLBWCITY14			\$75.00	\$0.00	\$75.00
TOTALS:			\$75.00	\$0.00	\$75.00

City of Baldwin City  
803 EIGHTH STREET  
P O BOX 86  
BALDWIN CITY KS 66006-0086

Description	Amount
ACCOUNT #	793
DOLLAR GENERAL	
CMB 2024	
CMB/LIQUOR LIC	75.00
ACCOUNT BAL	.00

CHECK # 7717988

CHECK Received 75.00

Change

SHA 10/26/23 11:24 Rcpt# 594036



350 752  
Baldwin  
City  
TOB

# CONFIDENTIAL

The enclosed document contains confidential business information (CBI), personally identifiable information (PII), or other sensitive information requiring special handling. We are providing this information to you because you have required it from us in your official capacity under applicable business licensing laws. Please transmit and store this information with all due care.

## EXEMPTION FROM PUBLIC DISCLOSURE

The enclosed document may be wholly or partially exempt from public disclosure under applicable law, due to the nature of its contents. To the extent that public disclosure is requested or contemplated in the future, please notify us in advance of such disclosure so that we may respond with any objections:

### PRIMARY CONTACT

JASON MELLO, LICENSING COORDINATOR  
JASON.MELLO@EG-AMERICA.COM  
508-270-3158

### MAILING ADDRESS

ATTN: LEGAL DEPARTMENT / LICENSING  
165 FLANDERS ROAD  
WESTBOROUGH, MA 01581

DO NOT REMOVE

PLEASE RETAIN THIS COVER SHEET



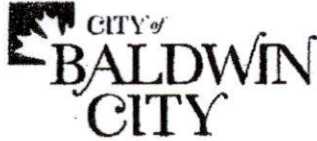

P.O. Box 86 | 803 Eighth Street | Baldwin City, Kansas 66006 | (785)594-6427 | Fax 594-6586 | baldwincity.org

## APPLICATION FOR LICENSE TO SELL TOBACCO PRODUCTS

ALL SECTIONS MUST BE COMPLETED AND PRINTED LEGIBLY FOR PROCESSING.

Name of Business: KWIK SHOP #350752

Name of Owner(s): KWIK SHOP, INC.

Name of Manager(s): AMY STALKFLEET

Location Address: 522 AMES ST / BALDWIN CITY, KS 66006

Mailing Address: 165 Flanders RD / Legal Department / Westborough, MA 01581-1032

Phone Number: BUS - (785) 594-2138 CORP - (508) 270-3158

Tax ID#: 004486112339F01

### IF TOBACCO SALES WILL BE THROUGH VENDING MACHINES, COMPLETE THE FOLLOWING INFORMATION:

Name and address of business in which machine # 1 is located:

\_\_\_\_\_

Name and address of business in which machine # 2 is located:

\_\_\_\_\_

Name and address of business in which machine # 3 is located:

\_\_\_\_\_

Name and address of business in which machine # 4 is located:

\_\_\_\_\_

*I hereby acknowledge receipt of a copy of the ordinance(s) regarding the sale of tobacco products. All employees of the business being licensed have been informed of the requirements. I understand that failure to comply with the ordinance(s) may result in revocation of this license and prosecution through the Municipal Court of Baldwin City as set out in Section 1011. A fee of \$25.00 accompanies this application.*

  
Signature

11/09/23  
Date

\* Submit completed application to the office of the City Clerk



P.O. Box 86 | 803 Eighth Street | Baldwin City, Kansas 66006 | (785)594-6427 | Fax 594-6586 | baldwincity.org

## APPLICATION FOR LICENSE TO SELL TOBACCO PRODUCTS

ALL SECTIONS MUST BE COMPLETED AND PRINTED LEGIBLY FOR PROCESSING.

Name of Business: CASEY'S #3937

Name of Owner(s): CASEY'S RETAIL COMPANY

Name of Manager(s): VICKI GREEN

Location Address: 511 AMES ST, BALDWIN CITY, KS 66006

Mailing Address: 1 SE CONVENIENCE BLVD, ANKENY, IA 50021

Phone Number: 785-594-2830

Tax ID#: FED ID: 20-1025921 OR SALES TAX #: 004-201025921F-01

### IF TOBACCO SALES WILL BE THROUGH VENDING MACHINES, COMPLETE THE FOLLOWING INFORMATION:

Name and address of business in which machine # 1 is located:  
N/A

Name and address of business in which machine # 2 is located:  
\_\_\_\_\_

Name and address of business in which machine # 3 is located:  
\_\_\_\_\_

Name and address of business in which machine # 4 is located:  
\_\_\_\_\_

*I hereby acknowledge receipt of a copy of the ordinance(s) regarding the sale of tobacco products. All employees of the business being licensed have been informed of the requirements. I understand that failure to comply with the ordinance(s) may result in revocation of this license and prosecution through the Municipal Court of Baldwin City as set out in Section 1011. A fee of \$25.00 accompanies this application.*

*Douglas M. Beal*  
Signature  
FOR CASEY'S RETAIL COMPANY

9/25/2023  
Date

\* Submit completed application to the office of the City Clerk

BILL NO	CUST #	CUSTOMER ID	TYPE	POST DATE	REFERENCE	TOT PRICE	TOTAL TAX	TOT AMOUNT	EXP	GL
BILL CODE	LN	BILL DESCRIPTION	UNIT PRICE	QUANTITY						
1842	1	833 CASEY'S TOBACCO LICENSE	TOBACCO	10/26/23		25.00	.00	25.00	1	BILLED LIC
INVOICE TOTAL						25.00	.00	25.00		
TOTAL BILLED						25.00	.00	25.00		

BILLING TYPE	BILLING COUNT	TOTAL AMOUNT	PAID COUNT	TOTAL PAID
TOBACCO TOBACCO LICENSE	1	25.00	0	.00

CATEGORY	BILLING COUNT	TOTAL AMOUNT	PAID COUNT	TOTAL PAID
NONREC NON-RECURRING	1	25.00	0	.00

TOTALS CODE	BILLING COUNT	TOTAL AMOUNT	PAID COUNT	TOTAL PAID
NONE NONE	1	25.00	0	.00

CITY OF BALDWIN CITY  
803 EIGHTH STREET  
P O BOX 86  
BALDWIN CITY KS 66006-0086

ACCOUNT # 833  
CASEY'S GENERAL STORES  
2024 LICENSE  
CHB/LIQUOR LIC  
ACCOUNT BAL .00

Rcpt# 594041  
ACCOUNT # 833  
CASEY'S GENERAL STORES  
LICENSE 2024  
TOBACCO LICENSE  
ACCOUNT BAL .00

CHECK # 403561

Total 100.00  
CHCK Received 100.00  
Change .00

SHA 10/26/23 11:41 Rcpt# 594042

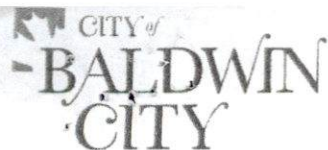

P.O. Box 86, 803 Eighth St. | Baldwin City, KS 66006 | (785) 594-6427 | FAX 594-6586 | www.baldwincity.org

**City of Baldwin City, Kansas  
Alcohol License Application**

Application is hereby made for a ☒ Drinking Establishment ☐ Retail Liquor license from the City of Baldwin City, Kansas.

If a corporation or partnership, please attach a list of names, addresses and birth dates of all officers/partners.

Name of Business to be licensed: <u>THE BC BULLPEN LLC</u>			
Address: <u>811 8TH STREET</u>	<u>BALDWIN CITY</u>	<u>KS</u>	<u>66006</u>
Street	City	State	Zip
Mailing Address: <u>PO BOX 376</u>	<u>BALDWIN CITY</u>	<u>KS</u>	<u>66006</u>
Street	City	State	Zip

Is the establishment within 500 feet of a church, school, or library (measured from building to building)? ☐ Yes ☐ No

**The place of business will be managed by:**

Name: NICOLE MANBECK Phone: 316-833-6111

Home Address 1097 N. 400 RD BALDWIN CITY KS 66006  
Street City State Zip

Place of Birth: MOONDRIDGE Date of Birth: 01-28-1983

Length of Kansas Residency: \_\_\_\_\_

I hereby certify the above information to be true and correct to the best of my knowledge. I have attached a copy of the current license from the State of Kansas and the appropriate fee has been paid to the City Clerk's office. It is understood that should the ownership or location of this establishment change or the status of the establishment change for any reason, this license is null and void and the fees are not refundable or prorated.

NICOLE MANBECK  
Applicant's Printed Name

  
Applicant's Signature

Date: 11/10/23

\*\*\*\*\*

**For office use only:**

All documents and appropriate fee received this \_\_\_\_\_ day of \_\_\_\_\_, 20\_\_\_\_.

License issued this \_\_\_\_\_ day of \_\_\_\_\_, 20\_\_\_\_.

\_\_\_\_\_  
City Clerk

## SPECIAL EVENTS APPLICATION

*Submit completed application to City Clerk Office thirty (30) days prior to event*

Date: 11/09/23

Name of contact person Jenni Fish & Lynn Meador

Phone 785-764-9114

Email jenni@baldwincitychamber.com

Name of Sponsoring Business or Organization (if different than above)

Chamber of Commerce + City of Baldwin City

Address or location of event Downtown

Describe the type of event proposed Christmas Parade

Date(s) of proposed event: December 2, 2023

Hours of operation: 4-8:30pm

Please describe the details of your event in the space provided below. Attach additional sheets if necessary

Christmas parade → approx. 20 floats, tree lighting, Santa photos, fireworks, community Hallelujah Choir

Attendance: Total anticipated attendance: Persons 500-600 Vehicles ?

Electrical - does your event require electricity? ☐ No ☒ Yes (if yes, show location(s) on map)

Barricades - does your event require street closure? ☐ No ☒ Yes (if yes, show location(s) on map)

8<sup>th</sup> & High will remain closed for one block in each direction (N+E) for the duration of the event

Trash: How will trash be managed? ☐ Provide Own Trash Receptacles

☒ Request City Services (show location(s) on map)



**Restrooms:** Number of Portable Restrooms X

Company to place/remove \_\_\_\_\_

Company contact info \_\_\_\_\_

**Structures:** Are temporary buildings, site improvements or alterations, grills, tents, canopies, inflatable structures, or live music proposed with this request? ☐ No ☒ Yes

*If yes, please describe:*

Santa's sleigh, chair & decorations set up in  
Sullivan Square.  
- Fundraiser in Concession Stand - selling hot cocoas

**Signs:** Are signs or attention attracting devices proposed with this event? ☐ No ☒ Yes (if yes, show on map)

**Publicizing Event:** Will the proposed event be advertised to the public?

☐ No ☒ Yes - Flyers ☒ Yes - Newspapers ☐ Yes - Radio/TV (Please attach copy)

**REQUIRED DOCUMENTS CHECK LIST:**

☒ **Completed Application**

☒ **Map** - Attach a map showing street(s) and location of the event as described above.

☐ **Insurance coverage** – Applications for all events *held on public property and/or assisted by the City of Baldwin City must* be accompanied by a Certificate of Insurance identifying the City as "Additional Insured." Proof of liability and bodily injury insurance coverage at a minimum amount of \$500,000.00 combined single limit per occurrence with a minimum aggregate limit of \$1,000,000 is required. Insurance certificates must reference the event to be held and be dated within 30 days of the event. Contact City Clerk Packard at [apackard@baldwincity.gov](mailto:apackard@baldwincity.gov) or call 785.594.6427 to confirm if applicable to your event.

☒ **Non-Profit:** Fee's may be waived by the City Administrator if a letter showing non-profit status is included with application.

☐ **Application fees:** \$100.00

☐ **Utility fees:** If electric service is requested, a fee of \$25.00 plus the cost of electricity used will be assessed.

☐ Applicants must complete a utility card in advance and include with the application.

☐ **Alcohol:** If alcohol is to be served or sold a copy of the *approved KSDR Form ABC-830 Temporary Permit Application and Agreement* on file with the City Clerk.

*I certify that the information contained in and attached to this application is correct, and I agree to abide by the terms of the Code of the City of Baldwin City, Kansas, which regulate special events, and by the specific terms and stipulations of this permit.*

*By signing this application, the applicants for a Special Event Permit agree to hold the City of Baldwin City and its employees harmless for any and all claims, lawsuits, or liability including attorney fees, costs allegedly arising out of loss, damages, or injury to person or person's property occurring during the course of or pertaining to the Special Event caused by the conduct of employees or agents of applicants.*

**Applicants Signature:** \_\_\_\_\_

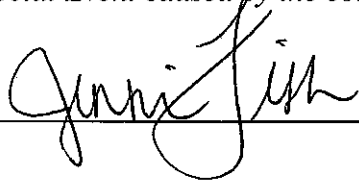

Applications for a special event filed after thirty (30) days prior to the event may not be considered



Saturday

# DECEMBER 2

## A FULL DAY OF HOLIDAY FUN!

### 9am

#### BREAKFAST WITH SANTA

Intermediate Center (9-11am)



Register  
Here

#### HOLIDAY BAZAAR AT VINTAGE PARK

321 Crimson Ave (10am-2pm)

#### HOLIDAY BAZAAR AT NEW LIFE ASSEMBLY OF GOD

118 5th Street (9am-2pm)

#### 11TH ANNUAL XTREAM GINGERBREAD HOUSE PARTY

Lumberyard Arts Center (9:30am-3pm)

# FESTIVAL OF LIGHTS

2023

### 12pm

#### ADULT CRAFTERNOON

Baldwin City Library (12-2pm)

### 4pm

#### BADV'S NUTCRACKER OPEN HOUSE

711 8th Street (4-5:30 pm)

Free activities

### 4:30pm

#### SOUP SUPPER & LIVE NATIVITY SCENE

Baldwin First United Methodist  
Church Fellowship Hall (4:30-6pm)

### 5pm

#### GINGERBREAD HOUSE VIEWING & HOLIDAY ART SHOW

Lumberyard Arts Center (5-7pm)

### 5:30pm

#### PRE-PARADE HOLIDAY SHOW

BADV All Star Dance Team, Kids Academy Choir  
Community Choir presenting Handel's "Hallelujah Chorus"

Bring food  
pantry  
donations to fill  
Santa's Sleigh

### 6pm

#### FESTIVAL OF LIGHTS

# PARADE

Downtown  
Baldwin  
City

#### MAYOR'S CHRISTMAS TREE LIGHTING CEREMONY

#### PICTURES WITH SANTA

#### FIREWORKS

+ Purchase a  
hot chocolate and  
carmel apples at the  
concession stand to  
support Lila Smith in her  
battle with cancer. (5-7pm)

# Christmas Parade 2023

- Barriers: set up between 4 and 4:30pm; 8th St open as soon as parade is over. High St. open by 8:30pm.
- 5pm Community Hallelujah Chorus Choir
- 6pm Parade
- Tree lighting at City Hall
- Fireworks
- Pictures with Santa

Chapel Street

Dearborn Street

Elm Street

Fremont Street

Grove Street

High Street

PARADE

8th Street

barrier to place  
after parade

7th Street

6th Street

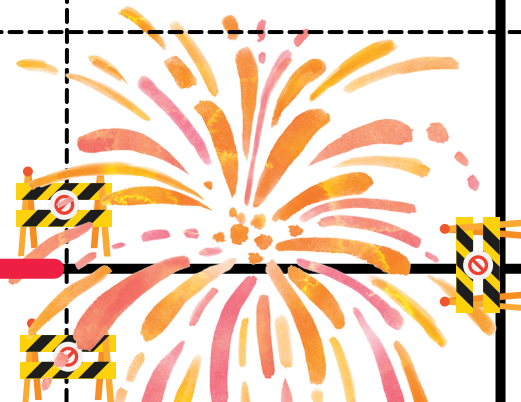

Chapel Street

PARADE

6pm  
to  
7pm

Festival of Lights Parade  
Mayor's Christmas Tree Lighting Ceremony  
Caroling  
Community Hallelujah Chorus Choir  
Pictures with Santa  
Fireworks Display

Dearborn Street

Elm Street



Fremont Street

Grove Street

8th Street

7th Street

6th Street

High Street

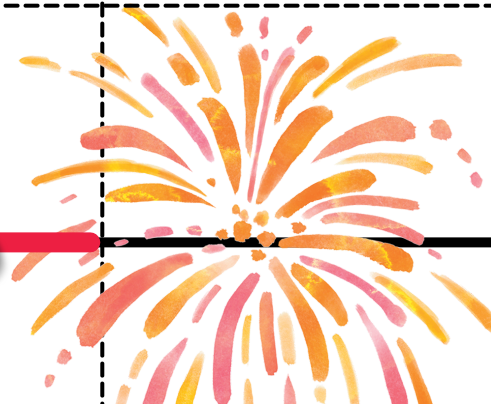

**ORDINANCE NO. 1482**

**AN ORDINANCE GRANTING A CONDITIONAL USE PERMIT FOR THE ESTABLISHMENT OF A SHORT-TERM RENTAL / AIRBNB WITHIN THE CORPORATE LIMITS OF THE CITY OF BALDWIN CITY, KANSAS.**

WHEREAS, application has been made by Kyle Carlson and Staci Carlson, requesting a Conditional Use Permit to allow the establishment of a Short-Term Rental / Airbnb located on the property at 404 5<sup>th</sup> Street, Baldwin City, Kansas; and,

WHEREAS, the Baldwin City Planning Commission conducted a public hearing following published notification in accordance with K.S.A. 12-741, et. seq., as amended, on October 10, 2022; and,

WHEREAS, the Baldwin City Planning Commission has recommended that the City Council of the City of Baldwin City, Kansas, to approve the Conditional Use Permit to allow the establishment of a Short-Term Rental / Airbnb on property at 404 5th Street, Baldwin City, Kansas, be approved subject to certain conditions;

**NOW, THEREFORE, BE IT ORDAINED BY THE GOVERNING BODY OF THE CITY OF BALDWIN CITY, KANSAS, THAT:**

**SECTION 1. SUBJECT REAL ESTATE.** The following described real estate (the “**Subject Real Estate**”) is hereby generally described as Lots 68 & 70 LESS the South 80 feet on Dearborn Street and addressed as 404 5th Street.

**SECTION 2. CONDITIONAL USE PERMIT.** A Conditional Use Permit (“**CUP**”) for the Subject Real Estate is hereby approved in accordance with the CUP application.

**SECTION 3. CONDITIONAL USE PERMIT.** The CUP is and shall be expressly subject to the following conditions of approval:

1. Strict compliance with all applicable zoning and use regulations not modified by the CUP
2. Any failure to comply with the CUP or other applicable zoning and use regulations following notice from the City specifying such failure of compliance shall result in revocation of the CUP and all uses permitted by the CUP shall cease immediately.

**SECTION 4. EFFECTIVE DATE OF ORDINANCE.** This Ordinance shall take effect on its passage and upon its publication as required by law.

Passed by the City Council on 21st day of November, 2023.

\_\_\_\_\_  
Casey Simoneau, Mayor

ATTEST: \_\_\_\_\_  
Amara Packard, City Clerk  
(*Approved as to Form*):

\_\_\_\_\_  
Dakota Loomis, City Attorney

## SCHEDULED CLAIMS LIST

INVOICE#	LINE	DUE DATE	INVOICE DATE	REFERENCE	PAYMENT AMOUNT	DIST ID	GL ACCOUNT	CK TYPE	SQ
BALDWIN STATE BANK									
600066 360 DOCUMENT SOLUTIONS									
81044282	1	10/15/23	10/15/23	LEASE	713.33	01	01.01.2890 OFFICE EQUIPMENT LEASE E-PAYMNT 4145602 10/15/23	INVC	1
	2			LEASE	210.44	01	01.05.2890 OFFICE EQUIPMENT LEASE E-PAYMNT 4145602 10/15/23	INVC	1
	3			LEASE	12.26	01	01.02.2890 OFFICE EQUIPMENT LEASE E-PAYMNT 4145602 10/15/23	INVC	1
	4			LEASE	12.26	01	01.35.2890 OFFICE EQUIPMENT LEASE E-PAYMNT 4145602 10/15/23	INVC	1
	5			LEASE	12.26	12	12.11.2890 OFFICE EQUIPMENT LEASE E-PAYMNT 4145602 10/15/23	INVC	1
	6			LEASE	12.35	11	11.25.2890 OFFICE EQUIPMENT LEASE E-PAYMNT 4145602 10/15/23	INVC	1
				INVOICE TOTAL	972.90				
81244959	1	11/15/23	11/15/23	LEASE	713.33	01	01.01.2890 OFFICE EQUIPMENT LEASE E-PAYMNT 4145604 11/15/23	INVC	1
	2			LEASE	210.44	01	01.05.2890 OFFICE EQUIPMENT LEASE E-PAYMNT 4145604 11/15/23	INVC	1
	3			LEASE	12.26	01	01.02.2890 OFFICE EQUIPMENT LEASE E-PAYMNT 4145604 11/15/23	INVC	1
	4			LEASE	12.26	01	01.35.2890 OFFICE EQUIPMENT LEASE E-PAYMNT 4145604 11/15/23	INVC	1
	5			LEASE	12.26	12	12.11.2890 OFFICE EQUIPMENT LEASE E-PAYMNT 4145604 11/15/23	INVC	1
	6			LEASE	12.35	11	11.25.2890 OFFICE EQUIPMENT LEASE E-PAYMNT 4145604 11/15/23	INVC	1
				INVOICE TOTAL	972.90				
				VENDOR TOTAL	1,945.80				
10068 ADVANCE INSURANCE COMPANY OFKS									
233100001883	1	12/01/23	12/01/23	DEC2023 LIFE,STD,AD&D-CITYPAID	81.44	11	11.24.1165 SHORT TERM DISABILITY E-PAYMNT 4145642 12/01/23	INVC	1
	2			DEC2023 LIFE,STD,AD&D-CITYPAID	140.18	11	11.25.1165 SHORT TERM DISABILITY E-PAYMNT 4145642 12/01/23	INVC	1
	3			DEC2023 LIFE,STD,AD&D-CITYPAID	60.31	11	11.26.1165 SHORT TERM DISABILITY E-PAYMNT 4145642 12/01/23	INVC	1



## SCHEDULED CLAIMS LIST

INVOICE#	LINE	DUE DATE	INVOICE DATE	REFERENCE	PAYMENT AMOUNT	DIST ID	GL ACCOUNT	CK TYPE	SQ
	4		DEC2023	LIFE,STD,AD&D-CITYPAID	158.54	12	12.11.1165 SHORT TERM DISABILITY E-PAYMNT 4145642 12/01/23	INVC	1
	5		DEC2023	LIFE,STD,AD&D-CITYPAID	138.23	18	18.21.1165 SHORT TERM DISABILITY E-PAYMNT 4145642 12/01/23	INVC	1
	6		DEC2023	LIFE,STD,AD&D-CITYPAID	5.35	24	24.01.1165 SHORT TERM DISABILITY E-PAYMNT 4145642 12/01/23	INVC	1
	7		DEC2023	LIFE,STD,AD&D-CITYPAID	45.98	01	01.01.1165 SHORT TERM DISABILITY E-PAYMNT 4145642 12/01/23	INVC	1
	8		DEC2023	LIFE,STD,AD&D-CITYPAID	102.38	01	01.02.1165 SHORT TERM DISABILITY E-PAYMNT 4145642 12/01/23	INVC	1
	9		DEC2023	LIFE,STD,AD&D-CITYPAID	32.93	01	01.03.1165 SHORT TERM DISABILITY E-PAYMNT 4145642 12/01/23	INVC	1
	10		DEC2023	LIFE,STD,AD&D-CITYPAID	299.04	01	01.05.1165 SHORT TERM DISABILITY E-PAYMNT 4145642 12/01/23	INVC	1
	11		DEC2023	LIFE,STD,AD&D-CITYPAID	13.35	01	01.07.1165 SHORT TERM DISABILITY E-PAYMNT 4145642 12/01/23	INVC	1
	12		DEC2023	LIFE,STD,AD&D-CITYPAID	34.71	01	01.35.1165 SHORT TERM DISABILITY E-PAYMNT 4145642 12/01/23	INVC	1
	13		DEC2023	LIFE,STD,AD&D-CITYPAID	2.67	03	03.01.1165 <del>SHORT TERM DISABILITY</del> E-PAYMNT 4145642 12/01/23	INVC	1
				INVOICE TOTAL	1,115.11				
				VENDOR TOTAL	1,115.11				
				40021 AMARA PACKARD					
NOV 2023 MILEAGE	1	11/21/23	11/21/23	310 MILES TO COMFOA CONFERENCE	203.05	01	01.01.2160 TRANSPORTATION	INVC	1
				INVOICE TOTAL	203.05				
				VENDOR TOTAL	203.05				
				600332 AMAZON CAPITAL SERVICES					
11MG-91LW-1LXM	1	11/21/23	11/21/23	FORKS,SPOONS,TOWELS,KLEENEX	85.60	01	01.02.3110 OFFICE SUPPLIES E-PAYMNT 4145644 11/21/23	INVC	1
	2			FORKS,SPOONS,TOWELS,KLEENEX	85.61	11	11.25.3110 OFFICE SUPPLIES E-PAYMNT 4145644 11/21/23	INVC	1
	3			FORKS,SPOONS,TOWELS,KLEENEX	36.45	18	18.21.3680 CUSTODIAL SUPPLIES E-PAYMNT 4145644 11/21/23	INVC	1
				INVOICE TOTAL	207.66				
1393-NY1C-9N3W	1	11/21/23	11/21/23	WATER TRUCK BUMPER	594.98	12	12.12.2540	INVC	1

## SCHEDULED CLAIMS LIST

INVOICE#	LINE	DUE DATE	INVOICE DATE	REFERENCE	PAYMENT AMOUNT	DIST ID	GL ACCOUNT	CK TYPE	SQ
							VEHICLE REPAIRS E-PAYMNT 4145644 11/21/23		
				INVOICE TOTAL	594.98				
16CP-373V-M1CV	1	11/21/23	11/21/23	PHONE CASE-954	12.99	01	01.05.3110 OFFICE SUPPLIES E-PAYMNT 4145644 11/21/23	INVC	1
	2			BOOTS-954	100.00	01	01.05.3610 UNIFORMS E-PAYMNT 4145644 11/21/23	INVC	1
				INVOICE TOTAL	112.99				
171P-9V3Y-1DJP	1	11/21/23	11/21/23	AMAZON-SEAT COVERS-TESLA	149.98	45	45.01.4999 OTHER CAPITAL OUTLAY E-PAYMNT 4145644 11/21/23	INVC	1
	2			TESLA SEAT COVERS/FLASH DRIVES	61.93	01	01.05.3110 OFFICE SUPPLIES E-PAYMNT 4145644 11/21/23	INVC	1
	3			PROMO/DISCOUNT	7.50	01	01.05.3110 OFFICE SUPPLIES E-PAYMNT 4145644 11/21/23	INVC	1
				INVOICE TOTAL	204.41				
1CRW-F43G-H1TP	1	11/21/23	11/21/23	HOT COCOA & APPLE CIDER MIX	43.02	01	01.01.3110 OFFICE SUPPLIES E-PAYMNT 4145644 11/21/23	INVC	1
				INVOICE TOTAL	43.02				
1D1F-COMD-3GVX	1	11/21/23	11/21/23	VOLTAGE TESTER/CLAMP METER	370.20	18	18.23.2530 MACHINE/EQUIP REPAIR E-PAYMNT 4145644 11/21/23	INVC	1
				INVOICE TOTAL	370.20				
1D1P-RH7R-MRLX	1	11/21/23	11/21/23	TIRE SWABS, TYPEWRITER RIBBON	50.27	01	01.02.3800 MATERIALS/SUPPLIES E-PAYMNT 4145644 11/21/23	INVC	1
				INVOICE TOTAL	50.27				
1HXJ-TP9R-FWRQ	1	11/21/23	11/21/23	DMND CUT HDLGHT RPLCMNT GLASS	41.50	11	11.24.2540 VEHICLE REPAIRS E-PAYMNT 4145644 11/21/23	INVC	1
				INVOICE TOTAL	41.50				
1JCT-XXYW-6NLN	1	11/21/23	11/21/23	UNDER ARMOUR BOOTS FOR PD	100.00	01	01.05.3610 UNIFORMS E-PAYMNT 4145644 11/21/23	INVC	1
				INVOICE TOTAL	100.00				
1M09-1HFD-31JG	1	11/21/23	11/21/23	16GB FLASH DRIVES	49.62	01	01.05.3110 OFFICE SUPPLIES E-PAYMNT 4145644 11/21/23	INVC	1
	2			8GB FLASH DRIVES	31.98	01	01.05.3110 OFFICE SUPPLIES E-PAYMNT 4145644 11/21/23	INVC	1

## SCHEDULED CLAIMS LIST

INVOICE#	LINE	DUE DATE	INVOICE DATE	REFERENCE	PAYMENT AMOUNT	DIST ID	GL ACCOUNT	CK TYPE	SQ
	3			PENS	12.79	01	01.05.3110 OFFICE SUPPLIES E-PAYMNT 4145644 11/21/23	INVC	1
	4			WATER FILTER	138.06	01	01.05.7999 MISCELLANEOUS EXPENSES E-PAYMNT 4145644 11/21/23	INVC	1
				INVOICE TOTAL	232.45				
1R9R-CNVW-1MCD	1	11/21/23	11/21/23	MAXMARK INK REFILL	9.50	01	01.01.3110 OFFICE SUPPLIES E-PAYMNT 4145644 11/21/23	INVC	1
				INVOICE TOTAL	9.50				
				VENDOR TOTAL	1,966.98				
				10123 AMERICAN EQUIPMENT CO.					
48445	1	11/21/23	11/21/23	PLOW PARTS, BLADES, LIGHTS	3,565.28	01	01.02.3330 SNOW REMOVAL SUPPLIES	INVC	1
				INVOICE TOTAL	3,565.28				
				VENDOR TOTAL	3,565.28				
				600345 ANCHOR SALES & SERVICE INC					
119306	1	11/21/23	11/21/23	GNR8TR DRWNGZANKR,BLD,PRM,DLVR	11,765.00	11	11.24.4650 GENERATION EQUIPMENT	INVC	1
				INVOICE TOTAL	11,765.00				
				VENDOR TOTAL	11,765.00				
				10347 ARROWHEAD HARDWARE-ACCT#146					
ACCT#146_OCT2023	1	11/21/23	11/21/23	ACCT#146_BALDWIN CEMETERY	37.46	03	03.01.2610 GROUNDS MAINTENANCE	INVC	1
	2			ACCT#146_BALDWIN CEMETERY	51.54	03	03.01.3680 CUSTODIAL SUPPLIES	INVC	1
				INVOICE TOTAL	89.00				
				VENDOR TOTAL	89.00				
				10341 ARROWHEAD HARDWARE-#3261					
ACCT#3261_OCT2023	1	11/21/23	11/21/23	EL DEPT	15.81	11	11.25.4239 POLE LINE HARDWARE	INVC	1
	2			EL DEPT	23.48	11	11.25.3355 MINOR TOOLS/APPARATUS	INVC	1
	3			EL DEPT	8.07	11	11.25.3110 OFFICE SUPPLIES	INVC	1
	4			EL DEPT	209.66	11	11.25.4131 ELECTRICAL LINE EXPENSE	INVC	1
				INVOICE TOTAL	257.02				
				VENDOR TOTAL	257.02				
				600243 ARROWHEAD HARDWARE-#6423					
ACCT#6423_OCT2023	1	11/21/23	11/21/23	POWER PLANT	21.84	11	11.24.3800 MATERIALS/SUPPLIES	INVC	1

# SCHEDULED CLAIMS LIST

INVOICE#	LINE	DUE DATE	INVOICE DATE	REFERENCE	PAYMENT AMOUNT	DIST ID	GL ACCOUNT	CK TYPE	SQ
	2			POWER PLANT	15.60	11	11.24.2520	INVC	1
							BUILDING REPAIRS		
	3			POWER PLANT	72.28	11	11.24.4650	INVC	1
							GENERATION EQUIPMENT		
				INVOICE TOTAL	109.72				
				VENDOR TOTAL	109.72				✓
ACCT#6871_OCT2023	1	11/21/23	11/21/23	600202 ARROWHEAD HARDWARE-ACCT#6871 WASTE WATER TREATMENT	98.18	18	18.22.3680	INVC	1
							CUSTODIAL SUPPLIES		
	2			WASTE WATER TREATMENT	1.00	18	18.21.7999	INVC	1
							MISCELLANEOUS EXPENSES		
	3			WASTE WATER TREATMENT	153.89	18	18.22.2520	INVC	1
							BUILDING REPAIRS		
				INVOICE TOTAL	253.07				
				VENDOR TOTAL	253.07				✓
ACCT#6907_OCT2023	1	11/21/23	11/21/23	10346 ARROWHEAD HARDWARE-#6907 BALDWIN PUBLIC WORKS	448.38	01	01.02.3800	INVC	1
							MATERIALS/SUPPLIES		
	2			BALDWIN PUBLIC WORKS	82.48	01	01.03.3800	INVC	1
							MATERIALS/SUPPLIES		
	3			BALDWIN PUBLIC WORKS	45.99	01	01.02.4210	INVC	1
							STREETS		
	4			BALDWIN PUBLIC WORKS	68.93	12	12.12.3800	INVC	1
							MATERIALS/SUPPLIES		
	5			BALDWIN PUBLIC WORKS	7.79	12	12.12.2540	INVC	1
							VEHICLE REPAIRS		
	6			BALDWIN PUBLIC WORKS	11.98	01	01.03.2520	INVC	1
							BUILDING REPAIRS		
	7			BALDWIN PUBLIC WORKS	82.48	12	12.12.2520	INVC	1
							BUILDING REPAIRS		
	8			BALDWIN PUBLIC WORKS	151.29	01	01.03.7999	INVC	1
							MISCELLANEOUS EXPENSES		
	9			BALDWIN PUBLIC WORKS	144.45	01	01.02.3355	INVC	1
							MINOR TOOLS/APPARATUS		
				INVOICE TOTAL	1,043.77				
				VENDOR TOTAL	1,043.77				✓
BTMA22676	1	11/21/23	11/21/23	20029 BAKER TILLY MUNICIPAL ADVISORS NOV2023 RETAINER:FIN CONSULTG	650.00	01	01.01.2850	INVC	1
							OTHER PROFESSIONAL SERVICE		
	2			NOV2023 RETAINER:FIN CONSULTG	2,600.00	11	11.26.2850	INVC	1
							OTHER PROFESSIONAL SERVICE		
	3			NOV2023 RETAINER:FIN CONSULTG	2,600.00	12	12.11.2850	INVC	1
							OTHER PROFESSIONAL SERVICE		
	4			NOV2023 RETAINER:FIN CONSULTG	650.00	18	18.21.2850	INVC	1
							OTHER PROFESSIONAL SERVICE		
				INVOICE TOTAL	6,500.00				
				VENDOR TOTAL	6,500.00				✓

## SCHEDULED CLAIMS LIST

INVOICE#	LINE	DUE DATE	INVOICE DATE	REFERENCE	PAYMENT AMOUNT	DIST ID	GL ACCOUNT	CK TYPE	SQ
20030 BAKER UNIVERSITY									
ML STREET MAP	1	11/24/23	11/24/23	3 COLOR PRINTS OF STREET MAP	1.50	01	01.01.2331 PRINTING	INVC	1
				INVOICE TOTAL	1.50				
				VENDOR TOTAL	1.50				
600131 BALDWIN CITY - 1015 ORANG									
11/10/23	1	11/25/23	11/25/23	PUBLIC WORKS UTILITIES	102.99	01	01.02.2496 ELECTRIC SERVICE E-PAYMNT 4145620 11/25/23	INVC	1
	2			PUBLIC WORKS UTILITIES	102.99	18	18.23.2496 ELECTRIC SERVICE E-PAYMNT 4145620 11/25/23	INVC	1
	3			PUBLIC WORKS UTILITIES	154.48	12	12.11.2496 ELECTRIC SERVICE E-PAYMNT 4145620 11/25/23	INVC	1
	4			PUBLIC WORKS UTILITIES	154.48	11	11.26.2496 ELECTRIC SERVICE E-PAYMNT 4145620 11/25/23	INVC	1
	5			PUBLIC WORKS UTILITIES	12.05	01	01.02.2498 SEWER SERVICE E-PAYMNT 4145620 11/25/23	INVC	1
	6			PUBLIC WORKS UTILITIES	12.05	18	18.23.2498 SEWER SERVICE E-PAYMNT 4145620 11/25/23	INVC	1
	7			PUBLIC WORKS UTILITIES	18.08	12	12.11.2498 SEWER SERVICE E-PAYMNT 4145620 11/25/23	INVC	1
	8			PUBLIC WORKS UTILITIES	18.08	11	11.26.2498 SEWER SERVICE E-PAYMNT 4145620 11/25/23	INVC	1
	9			PUBLIC WORKS UTILITIES	14.92	01	01.02.2497 WATER SERVICE E-PAYMNT 4145620 11/25/23	INVC	1
	10			PUBLIC WORKS UTILITIES	14.92	18	18.23.2497 WATER SERVICE E-PAYMNT 4145620 11/25/23	INVC	1
	11			PUBLIC WORKS UTILITIES	22.39	12	12.11.2497 WATER SERVICE E-PAYMNT 4145620 11/25/23	INVC	1
	12			PUBLIC WORKS UTILITIES	22.38	11	11.26.2497 WATER SERVICE E-PAYMNT 4145620 11/25/23	INVC	1
				INVOICE TOTAL	649.81				
				VENDOR TOTAL	649.81				
600132 BALDWIN CITY - 1019 HIGH									
11/10/23	1	11/25/23	11/25/23	SEWER DEPT LIFT STATION UTILITIES	27.06	18	18.23.2496 ELECTRIC SERVICE E-PAYMNT 4145621 11/25/23	INVC	1
				INVOICE TOTAL	27.06				

## SCHEDULED CLAIMS LIST

INVOICE#	LINE	DUE DATE	INVOICE DATE	REFERENCE	PAYMENT AMOUNT	DIST ID	GL ACCOUNT	CK TYPE	SQ
VENDOR TOTAL					27.06				
11/10/23	1	11/25/23	11/25/23	600133 BALDWIN CITY - 1028 6TH LIFT STATION UTILITIES	34.19	18	18.23.2496 ELECTRIC SERVICE E-PAYMNT 4145622-11/25/23	INVC	1
INVOICE TOTAL					34.19				
VENDOR TOTAL					34.19				
11/10/23	1	11/25/23	11/25/23	600134 BALDWIN CITY - 1100 B WAREHOUSE BLDG B UTILITIES	8.06	01	01.02.2496 ELECTRIC SERVICE E-PAYMNT 4145623 11/25/23	INVC	1
	2			WAREHOUSE BLDG B UTILITIES	4.88	18	18.23.2496 ELECTRIC SERVICE E-PAYMNT 4145623 11/25/23	INVC	1
	3			WAREHOUSE BLDG B UTILITIES	8.06	12	12.11.2496 ELECTRIC SERVICE E-PAYMNT 4145623 11/25/23	INVC	1
	4			WAREHOUSE BLDG B UTILITIES	3.42	11	11.26.2496 ELECTRIC SERVICE E-PAYMNT 4145623 11/25/23	INVC	1
INVOICE TOTAL					24.42				
VENDOR TOTAL					24.42				
11/10/23	1	11/25/23	11/25/23	600135 BALDWIN CITY - 1100 C WAREHOUSE BLDG C UTILITIES	34.86	11	11.25.2496 ELECTRIC SERVICE E-PAYMNT 4145624 11/25/23	INVC	1
INVOICE TOTAL					34.86				
VENDOR TOTAL					34.86				
11/10/23	1	11/25/23	11/25/23	600136 BALDWIN CITY - 1100 D GAS PUMP STATION BLDG D UTILITIES	7.37	01	01.02.2496 ELECTRIC SERVICE E-PAYMNT 4145625 11/25/23	INVC	1
	2			GAS PUMP STATION BLDG D UTILITIES	7.37	18	18.23.2496 ELECTRIC SERVICE E-PAYMNT 4145625 11/25/23	INVC	1
	3			GAS PUMP STATION BLDG D UTILITIES	7.37	12	12.11.2496 ELECTRIC SERVICE E-PAYMNT 4145625 11/25/23	INVC	1
	4			GAS PUMP STATION BLDG D UTILITIES	7.37	11	11.26.2496 ELECTRIC SERVICE E-PAYMNT 4145625 11/25/23	INVC	1
	5			GAS PUMP STATION BLDG D UTILITIES	7.35	01	01.05.2496 ELECTRIC SERVICE E-PAYMNT 4145625 11/25/23	INVC	1
INVOICE TOTAL					36.83				
VENDOR TOTAL					36.83				

## SCHEDULED CLAIMS LIST

INVOICE#	LINE	DUE DATE	INVOICE DATE	REFERENCE	PAYMENT AMOUNT	DIST ID	GL ACCOUNT	CK TYPE	SQ
11/10/23	1	11/25/23	11/25/23	600137 BALDWIN CITY - 1100 F UTILITY COMPLEX GATE F UTILITIES	5.12	01	01.02.2496 ELECTRIC SERVICE E-PAYMNT 4145626 11/25/23	INVC	1
	2			UTILITY COMPLEX GATE F UTILITIES	5.12	18	18.23.2496 ELECTRIC SERVICE E-PAYMNT 4145626 11/25/23	INVC	1
	3			UTILITY COMPLEX GATE F UTILITIES	5.12	12	12.11.2496 ELECTRIC SERVICE E-PAYMNT 4145626 11/25/23	INVC	1
	4			UTILITY COMPLEX GATE F UTILITIES	5.12	11	11.26.2496 ELECTRIC SERVICE E-PAYMNT 4145626 11/25/23	INVC	1
	5			UTILITY COMPLEX GATE F UTILITIES	5.12	01	01.05.2496 ELECTRIC SERVICE E-PAYMNT 4145626 11/25/23	INVC	1
				INVOICE TOTAL	25.60				
				VENDOR TOTAL	25.60				
11/10/23	1	11/25/23	11/25/23	600138 BALDWIN CITY - 1100 G ELECTRIC DEPT UTILITIES	38.94	11	11.25.2496 ELECTRIC SERVICE E-PAYMNT 4145627 11/25/23	INVC	1
				INVOICE TOTAL	38.94				
				VENDOR TOTAL	38.94				
11/10/23	1	11/25/23	11/25/23	600139 BALDWIN CITY - 1100 PP2 POWER PLANT #2 UTILITIES	65.89	11	11.24.2496 ELECTRIC SERVICE E-PAYMNT 4145628 11/25/23	INVC	1
	2			POWER PLANT #2 UTILITIES	217.80	11	11.24.2498 SEWER SERVICE E-PAYMNT 4145628 11/25/23	INVC	1
	3			POWER PLANT #2 UTILITIES	299.46	11	11.24.2497 WATER SERVICE E-PAYMNT 4145628 11/25/23	INVC	1
				INVOICE TOTAL	583.15				
				VENDOR TOTAL	583.15				
11/10/23	1	11/25/23	11/25/23	600140 BALDWIN CITY - 1101 HIGH RESTROOM AT 11TH ST PARK UTILITIES	28.92	01	01.03.2496 ELECTRIC SERVICE E-PAYMNT 4145629 11/25/23	INVC	1
	2			RESTROOM AT 11TH ST PARK UTILITIES	21.46	01	01.03.2498 SEWER SERVICE E-PAYMNT 4145629 11/25/23	INVC	1
	3			RESTROOM AT 11TH ST PARK UTILITIES	19.25	01	01.03.2497 WATER SERVICE E-PAYMNT 4145629 11/25/23	INVC	1
				INVOICE TOTAL	69.63				

## SCHEDULED CLAIMS LIST

INVOICE#	LINE	DUE DATE	INVOICE DATE	REFERENCE	PAYMENT AMOUNT	DIST ID	GL ACCOUNT	CK TYPE	SQ
				VENDOR TOTAL	69.63				
11/10/23	1	11/25/23	11/25/23	600141 BALDWIN CITY - 1223 SUMMIT LIFT STATION UTILITIES	40.93	18	18.23.2496 ELECTRIC SERVICE E-PAYMNT 4145630 11/25/23	INVC	1
				INVOICE TOTAL	40.93				
				VENDOR TOTAL	40.93				
11/10/23	1	11/25/23	11/25/23	600142 BALDWIN CITY - 1416 N 6TH WATER TOWER NORTH UTILITIES	160.17	12	12.13.2496 ELECTRIC SERVICE E-PAYMNT 4145631 11/25/23	INVC	1
				INVOICE TOTAL	160.17				
				VENDOR TOTAL	160.17				
11/10/23	1	11/25/23	11/25/23	600113 BALDWIN CITY - 203 1ST ST POLICE STATION UTILITIES	552.34	01	01.05.2496 ELECTRIC SERVICE E-PAYMNT 4145605 11/25/23	INVC	1
	2			POLICE STATION UTILITIES	27.33	01	01.05.2498 SEWER SERVICE E-PAYMNT 4145605 11/25/23	INVC	1
	3			POLICE STATION UTILITIES	30.32	01	01.05.2497 WATER SERVICE E-PAYMNT 4145605 11/25/23	INVC	1
				INVOICE TOTAL	609.99				
				VENDOR TOTAL	609.99				
11/10/23	1	11/25/23	11/25/23	600114 BALDWIN CITY - 300 LAWREN WATER TOWER WEST UTILITIES	145.52	12	12.11.2496 ELECTRIC SERVICE E-PAYMNT 4145606 11/25/23	INVC	1
				INVOICE TOTAL	145.52				
				VENDOR TOTAL	145.52				
11/10/23	1	11/25/23	11/25/23	600115 BALDWIN CITY - 317 FRENCH SWIMMING POOL UTILITIES	123.72	01	01.06.2496 ELECTRIC SERVICE E-PAYMNT 4145607 11/25/23	INVC	1
	2			SWIMMING POOL UTILITIES	201.22	01	01.06.2498 SEWER SERVICE E-PAYMNT 4145607 11/25/23	INVC	1
	3			SWIMMING POOL UTILITIES	264.43	01	01.06.2497 WATER SERVICE E-PAYMNT 4145607 11/25/23	INVC	1
				INVOICE TOTAL	589.37				
				VENDOR TOTAL	589.37				



SCHEDULED CLAIMS LIST

INVOICE#	LINE	DUE DATE	INVOICE DATE	REFERENCE	PAYMENT AMOUNT	DIST ID	GL ACCOUNT	CK TYPE	SQ
11/10/23	1	11/25/23	11/25/23	600116 BALDWIN CITY - 400 ORANGE OAKWOOD CEMETERY UTILITIES	101.18	03	03.01.2496 ELECTRIC UTILITY SERVICE E-PAYMNT 4145608 11/25/23	INVC	1
	2			OAKWOOD CEMETERY UTILITIES	48.58	03	03.01.2497 WATER UTILITY EXPENSE E-PAYMNT 4145608 11/25/23	INVC	1
				INVOICE TOTAL	149.76				
				VENDOR TOTAL	149.76				
11/10/23	1	11/25/23	11/25/23	600117 BALDWIN CITY - 426 EISENH WWTp LIFT STATION UTILITIES	53.34	18	18.23.2496 ELECTRIC SERVICE E-PAYMNT 4145609 11/25/23	INVC	1
				INVOICE TOTAL	53.34				
				VENDOR TOTAL	53.34				
11/10/23	1	11/25/23	11/25/23	600118 BALDWIN CITY - 605 HIGH POWER PLANT #1 UTILITIES	2,422.01	11	11.24.2496 ELECTRIC SERVICE E-PAYMNT 4145610 11/25/23	INVC	1
	2			POWER PLANT #1 UTILITIES	50.40	11	11.24.2498 SEWER SERVICE E-PAYMNT 4145610 11/25/23	INVC	1
	3			POWER PLANT #1 UTILITIES	57.85	11	11.24.2497 WATER SERVICE E-PAYMNT 4145610 11/25/23	INVC	1
				INVOICE TOTAL	2,530.26				
				VENDOR TOTAL	2,530.26				
11/10/23	1	11/25/23	11/25/23	600119 BALDWIN CITY - 606 INDIAN MAINTENANCE SHOP UTILITIES	11.83	01	01.02.2496 ELECTRIC SERVICE E-PAYMNT 4145611 11/25/23	INVC	1
	2			MAINTENANCE SHOP UTILITIES	11.83	18	18.23.2496 ELECTRIC SERVICE E-PAYMNT 4145611 11/25/23	INVC	1
	3			MAINTENANCE SHOP UTILITIES	17.75	12	12.11.2496 ELECTRIC SERVICE E-PAYMNT 4145611 11/25/23	INVC	1
	4			MAINTENANCE SHOP UTILITIES	17.74	11	11.26.2496 ELECTRIC SERVICE E-PAYMNT 4145611 11/25/23	INVC	1
				INVOICE TOTAL	59.15				
				VENDOR TOTAL	59.15				
11/10/23	1	11/25/23	11/25/23	600120 BALDWIN CITY - 610 HIGH FIRE STATION UTILITIES	183.17	01	01.04.2496 ELECTRIC SERVICE E-PAYMNT 4145612 11/25/23	INVC	1

## SCHEDULED CLAIMS LIST

INVOICE#	LINE	DUE DATE	INVOICE DATE	REFERENCE	PAYMENT AMOUNT	DIST ID	GL ACCOUNT	CK TYPE	SQ
	2			FIRE STATION UTILITIES	45.52	01	01.04.2498 SEWER SERVICE E-PAYMNT 4145612 11/25/23	INVC	1
	3			FIRE STATION UTILITIES	53.59	01	01.04.2497 WATER SERVICE E-PAYMNT 4145612 11/25/23	INVC	1
				INVOICE TOTAL	282.28				
				VENDOR TOTAL	282.28				
11/10/23	1	11/25/23	11/25/23	600122 BALDWIN CITY - 700 HIGH SULLIVAN SQUARE UTILITIES	182.25	01	01.03.2496 ELECTRIC SERVICE E-PAYMNT 4145613 11/25/23	INVC	1
	2			SULLIVAN SQUARE UTILITIES	42.93	01	01.03.2498 SEWER SERVICE E-PAYMNT 4145613 11/25/23	INVC	1
	3			SULLIVAN SQUARE UTILITIES	56.58	01	01.03.2497 WATER SERVICE E-PAYMNT 4145613 11/25/23	INVC	1
				INVOICE TOTAL	281.76				
				VENDOR TOTAL	281.76				
11/10/23	1	11/25/23	11/25/23	600123 BALDWIN CITY - 720 CHAPEL BAUER BUILDING UTILITIES	84.64	01	01.01.2496 ELECTRIC SERVICE E-PAYMNT 4145614 11/25/23	INVC	1
	2			BAUER BUILDING UTILITIES	16.80	01	01.01.2498 SEWER SERVICE E-PAYMNT 4145614 11/25/23	INVC	1
	3			BAUER BUILDING UTILITIES	10.50	01	01.01.2497 WATER SERVICE E-PAYMNT 4145614 11/25/23	INVC	1
				INVOICE TOTAL	111.94				
				VENDOR TOTAL	111.94				
11/10/23	1	11/25/23	11/25/23	600124 BALDWIN CITY - 724 HIGH DOWNTOWN IRR MTR UTILITIES	560.83	01	01.03.2497 WATER SERVICE E-PAYMNT 4145615 11/25/23	INVC	1
				INVOICE TOTAL	560.83				
				VENDOR TOTAL	560.83				
11/10/23	1	11/25/23	11/25/23	600126 BALDWIN CITY - 801 FIRETR FIRETREE PARK RESTROOM UTILITIES	37.63	01	01.03.2496 ELECTRIC SERVICE E-PAYMNT 4145616 11/25/23	INVC	1
	2			FIRETREE PARK RESTROOM UTILITIES	23.01	01	01.03.2498 SEWER SERVICE E-PAYMNT 4145616 11/25/23	INVC	1
	3			FIRETREE PARK RESTROOM	21.45	01	01.03.2497	INVC	1

# SCHEDULED CLAIMS LIST

INVOICE#	LINE	DUE DATE	INVOICE DATE	REFERENCE	PAYMENT AMOUNT	DIST ID	GL ACCOUNT	CK TYPE	SQ
UTILITIES							WATER SERVICE E-PAYMNT 4145616 11/25/23		
				INVOICE TOTAL	82.09				
				VENDOR TOTAL	82.09				
11/10/23	1	11/25/23	11/25/23	600127 BALDWIN CITY - 803 8TH ST CITY HALL UTILITIES	492.60	01	01.01.2496 ELECTRIC SERVICE E-PAYMNT 4145617 11/25/23	INVC	1
	2			CITY HALL UTILITIES	29.22	01	01.01.2498 SEWER SERVICE E-PAYMNT 4145617 11/25/23	INVC	1
	3			CITY HALL UTILITIES	46.24	01	01.01.2497 WATER SERVICE E-PAYMNT 4145617 11/25/23	INVC	1
				INVOICE TOTAL	568.06				
				VENDOR TOTAL	568.06				
11/10/23	1	11/25/23	11/25/23	600128 BALDWIN CITY - 810 4TH ST SEWER DEPT LIFT STATION UTILITIES	33.93	18	18.23.2496 ELECTRIC SERVICE E-PAYMNT 4145618 11/25/23	INVC	1
				INVOICE TOTAL	33.93				
				VENDOR TOTAL	33.93				
11/10/23	1	11/25/23	11/25/23	600130 BALDWIN CITY - 911 ORANGE WWTP UTILITIES	5,707.62	18	18.22.2496 ELECTRIC SERVICE E-PAYMNT 4145619 11/25/23	INVC	1
	2			WWTP UTILITIES	42.50	18	18.22.2497 WATER SERVICE E-PAYMNT 4145619 11/25/23	INVC	1
				INVOICE TOTAL	5,750.12				
				VENDOR TOTAL	5,750.12				
10/1/2023	1	10/01/23	10/01/23	30176 BALDWIN CITY PROPERTIES LLC EMPLOYEE GYM MEMBERSHIPS	155.75	0180	01.00.0080 OTHER DEDUCTIONS PAYABLE E-PAYMNT 4145599 10/01/23	INVC	1
	2			EMPLOYEE GYM MEMBERSHIPS	3.50	03	03.00.0080 OTHER DEDUCTIONS PAYABLE E-PAYMNT 4145599 10/01/23	INVC	1
	3			EMPLOYEE GYM MEMBERSHIPS	28.00	1180	11.00.0080 OTHER DEDUCTIONS PAYABLE- E-PAYMNT 4145599 10/01/23	INVC	1
	4			EMPLOYEE GYM MEMBERSHIPS	15.75	1280	12.00.0080 OTHER DEDUCTIONS PAYABLE E-PAYMNT 4145599 10/01/23	INVC	1
	5			EMPLOYEE GYM MEMBERSHIPS	7.00	1880	18.00.0080 OTHER DEDUCTIONS PAYABLE	INVC	1

INVOICE#	LINE	DUE DATE	INVOICE DATE	REFERENCE	PAYMENT AMOUNT	DIST ID	GL ACCOUNT	CK TYPE	SQ
				INVOICE TOTAL	210.00		E-PAYMNT 4145599 10/01/23		
11/1/2023	1	11/01/23	11/01/23	EMPLOYEE GYM MEMBERSHIPS	155.75	0180	01.00.0080 OTHER DEDUCTIONS PAYABLE E-PAYMNT 4145603 11/01/23	INVC	1
	2			EMPLOYEE GYM MEMBERSHIPS	3.50	03	03.00.0080 OTHER DEDUCTIONS PAYABLE E-PAYMNT 4145603 11/01/23	INVC	1
	3			EMPLOYEE GYM MEMBERSHIPS	28.00	1180	11.00.0080 OTHER DEDUCTIONS PAYABLE E-PAYMNT 4145603 11/01/23	INVC	1
	4			EMPLOYEE GYM MEMBERSHIPS	15.75	1280	12.00.0080 OTHER DEDUCTIONS PAYABLE E-PAYMNT 4145603 11/01/23	INVC	1
	5			EMPLOYEE GYM MEMBERSHIPS	7.00	1880	18.00.0080 OTHER DEDUCTIONS PAYABLE E-PAYMNT 4145603 11/01/23	INVC	1
				INVOICE TOTAL	210.00				
				VENDOR TOTAL	420.00				
ACCT #8 11/2/2023	1	11/21/23	11/21/23	30172 BALDWIN CITY MARKET SNACKS FOR BAUER BLDG GROUND BR	77.84	01	01.01.3900 PUBLIC RELATIONS	INVC	1
				INVOICE TOTAL	77.84				
				VENDOR TOTAL	77.84				
2023-15560	1	11/24/23	11/24/23	600148 BAUCH, ANDREW D. ATTORNEY FOR NOBLE LATHROM	250.00	01	01.07.2183 DEFENDANT ATTORNEY FEES	INVC	1
				INVOICE TOTAL	250.00				
2023-16184	1	11/24/23	11/24/23	ATTORNEY FOR LACEY GREGG	250.00	01	01.07.2183 DEFENDANT ATTORNEY FEES	INVC	1
				INVOICE TOTAL	250.00				
				VENDOR TOTAL	500.00				
23-1084L#2023-07	1	11/24/23	11/24/23	20200 BG CONSULTANTS INC FIRETREE 5B CONSTRUCTION OBSER	5,448.00	01	01.09.4007 ECONOMIC DEVELOPMENT	INVC	1
				INVOICE TOTAL	5,448.00				
23-1341L_OCT2023	1	11/21/23	11/21/23	CONSULTING SERVICES IN OCT2023	4,000.00	12	12.13.2430 ENGINEERING SERVICES	INVC	1
				INVOICE TOTAL	4,000.00				
				VENDOR TOTAL	9,448.00				
2385	1	11/15/23	11/15/23	20209 BIRD JANITORIAL JANITORIAL SVCS 11/15/23	193.00	01	01.02.2521 JANITORIAL SERVICES	INVC	1

## SCHEDULED CLAIMS LIST

INVOICE#	LINE	DUE DATE	INVOICE DATE	REFERENCE	PAYMENT AMOUNT	DIST ID	GL ACCOUNT	CK TYPE	SQ
	2			JANITORIAL SVCS 11/15/23	193.00	11	E-PAYMNT 4145652 11/15/23 11.26.2521 JANITORIAL SERVICES	INVC	1
				INVOICE TOTAL	386.00		E-PAYMNT 4145652 11/15/23		
2386	1	11/15/23	11/15/23	JANITORIAL SVCS 11/15/23	296.00	01	01.01.2521 JANITORIAL SERVICES	INVC	1
				INVOICE TOTAL	296.00		E-PAYMNT 4145636 11/15/23		
2393	1	11/15/23	11/15/23	JANITORIAL SVCS 11/15/23	591.00	01	01.05.2521 JANITORIAL SERVICES	INVC	1
				INVOICE TOTAL	591.00		E-PAYMNT 4145637 11/15/23		
				VENDOR TOTAL	1,273.00				
14915 FOW	1	11/21/23	11/21/23	150030 BOB ALLEN FORD-OTTAWA FLOWER TRUCK LATCH	90.10	01	01.03.2540 VEHICLE REPAIRS	INVC	1
				INVOICE TOTAL	90.10				
				VENDOR TOTAL	90.10				
927371183	1	11/21/23	11/21/23	112300 BORDER STATES INDUSTRIES, INC ALUT 1/0-2-1/0 WIRE	4,047.14	11	11.25.4239 POLE LINE HARDWARE	INVC	1
				INVOICE TOTAL	4,047.14				
				VENDOR TOTAL	4,047.14				
STM_OCT2023_12345043	1	11/21/23	11/21/23	200026 CINTAS CORPORATION STM_OCT2023_12345043 NON ELECTRC UNIFRM/LINEN/SUPLS	101.90	01	01.02.3610 UNIFORMS	INVC	1
	2			STM_OCT2023_12345043 NON ELECTRC UNIFRM/LINEN/SUPLS	295.45	01	E-PAYMNT 4145650 11/21/23 01.02.2999 OTHER CONTRACTUAL SERVICES	INVC	1
	3			STM_OCT2023_12345043 NON ELECTRC UNIFRM/LINEN/SUPLS	31.20	18	E-PAYMNT 4145650 11/21/23 18.22.2999 OTHER CONTRACTUAL SERVICES	INVC	1
				INVOICE TOTAL	428.55		E-PAYMNT 4145650 11/21/23		
				VENDOR TOTAL	428.55				
STM_OCT2023_12358637	1	11/21/23	11/21/23	600015 CINTAS CORPORATION STM_OCT2023_12358637 EL ONLY:UNIFORMS/LINENS/SUPLS	667.85	11	11.25.3610 UNIFORMS	INVC	1
	2			STM_OCT2023_12358637 EL ONLY:UNIFORMS/LINENS/SUPLS	169.95	11	E-PAYMNT 4145649 11/21/23 11.24.2999 OTHER CONTRACTUAL SERVICES	INVC	1
				INVOICE TOTAL	837.80		E-PAYMNT 4145649 11/21/23		

## SCHEDULED CLAIMS LIST

INVOICE#	LINE	DUE DATE	INVOICE DATE	REFERENCE	PAYMENT AMOUNT	DIST ID	GL ACCOUNT	CK TYPE	SQ
VENDOR TOTAL					837.80				
9/29/2023-10/31/2023	1	11/28/23	11/28/23	120550 CITY OF LAWRENCE 4380 O'CONNELL PHPHSE	86,431.32	12	12.13.2490 WATER TREATMENT FEES E-PAYMNT 4145639 11/28/23	INVC	1
INVOICE TOTAL					86,431.32				
VENDOR TOTAL					86,431.32				
10005999799	1	11/09/23	11/09/23	600209 DELTA COMMUNICATIONS, LLC MONTHLY FIBER INTERNET	91.25	11	11.26.2503 INTERNET CONNECTION FEES E-PAYMNT 4145645 11/09/23	INVC	1
	2			MONTHLY FIBER INTERNET	91.24	12	12.11.2503 INTERNET CONNECTION FEES E-PAYMNT 4145645 11/09/23	INVC	1
INVOICE TOTAL					182.49				
10006001983	1	11/09/23	11/09/23	MONTHLY FIBER INTERNET	80.71	01	01.10.2503 INTERNET CONNECTION FEES E-PAYMNT 4145646 11/09/23	INVC	1
	2			MONTHLY FIBER INTERNET	151.29	11	11.26.2503 INTERNET CONNECTION FEES E-PAYMNT 4145646 11/09/23	INVC	1
	3			MONTHLY FIBER INTERNET	151.29	12	12.11.2503 INTERNET CONNECTION FEES E-PAYMNT 4145646 11/09/23	INVC	1
	4			MONTHLY FIBER INTERNET	26.90	18	18.21.2503 INTERNET CONNECTION FEES E-PAYMNT 4145646 11/09/23	INVC	1
	5			MONTHLY FIBER INTERNET	303.43	01	01.05.2503 INTERNET CONNECTION FEES E-PAYMNT 4145646 11/09/23	INVC	1
INVOICE TOTAL					713.62				
VENDOR TOTAL					896.11				
S453130	1	11/21/23	11/21/23	500651 CORE & MAIN LP 90 METER CPLG MN X PJ CTS	453.48	12	12.12.4235 METERS	INVC	1
INVOICE TOTAL					453.48				
S961001	1	11/21/23	11/21/23	12X1CC BRS SAD 13.20 OD	1,159.52	12	12.12.3800 MATERIALS/SUPPLIES	INVC	1
INVOICE TOTAL					1,159.52				
T136711	1	11/21/23	11/21/23	SENSUS 3/45 SRII TRPL METER	5,988.00	12	12.12.4235 METERS	INVC	1
INVOICE TOTAL					5,988.00				
T890736	1	11/21/23	11/21/23	(6) PVC C900 DR18 PIPE 20'	12,550.00	12	12.12.4810 EQUIPMENT PURCHASES	INVC	1
INVOICE TOTAL					12,550.00				

# SCHEDULED CLAIMS LIST

INVOICE#	LINE	DUE DATE	INVOICE DATE	REFERENCE	PAYMENT AMOUNT	DIST ID	GL ACCOUNT	CK TYPE SQ
VENDOR TOTAL					20,151.00			
0011384675	600204 CSG FORTE PAYMENTS, INC.							
	1	11/10/23	11/10/23	ACH PROCESSING FEES	218.14	11	11.26.2861 CREDIT CARD FEES E-PAYMNT 4145633 11/10/23	INVC 1
	2			ACH PROCESSING FEES	145.43	12	12.11.2861 CREDIT CARD FEES E-PAYMNT 4145633 11/10/23	INVC 1
	3			ACH PROCESSING FEES	96.95	18	18.21.2861 CREDIT CARD FEES E-PAYMNT 4145633 11/10/23	INVC 1
	4			ACH PROCESSING FEES	24.23	24	24.01.2861 CREDIT CARD FEES E-PAYMNT 4145633 11/10/23	INVC 1
INVOICE TOTAL					484.75			
VENDOR TOTAL					484.75			
INV1298287	80362 DASH MEDICAL GLOVES, INC							
	1	11/21/23	11/21/23	NITRILE GLOVES-LG/XL	130.00	01	01.05.3006 SAFETY SUPPLIES	INVC 1
	INVOICE TOTAL					130.00		
VENDOR TOTAL					130.00			
NOVEMBER 2023	600196 DOWNING, SHAYE							
	1	11/30/23	11/30/23	MONTHLY JUDGE COMPENSATION	600.00	01	01.07.1105 APPOINTED OFFICIALS COMP E-PAYMNT 4145653 11/30/23	INVC 1
	INVOICE TOTAL					600.00		
VENDOR TOTAL					600.00			
7001039962	600027 EMPLOYERS MUTUAL CASUALTY CO							
	1	12/01/23	12/01/23	MONTHLY INSURANCE PAYMENT	26,505.35	0176	01.00.0082 INSURANCE PAYABLE E-PAYMNT 4145641 12/01/23	INVC 1
	INVOICE TOTAL					26,505.35		
VENDOR TOTAL					26,505.35			
31633	600340 ETC INSTITUTE							
	1	11/24/23	11/24/23	COMMUNITY SURVEY INVOICE #3	3,825.00	01	01.01.2850 OTHER PROFESSIONAL SERVICE	INVC 1
	INVOICE TOTAL					3,825.00		
VENDOR TOTAL					3,825.00			
SOLARPOWER_OCT2023	50531 EVERGY KANSAS CENTRAL INC.							
	1	11/21/23	11/21/23	SOLAR POWER OCT 2023	6,683.29	11	11.27.2791 EVERGY SOLAR PPA	INVC 1
INVOICE TOTAL					6,683.29			



## SCHEDULED CLAIMS LIST

INVOICE#	LINE	DUE DATE	INVOICE DATE	REFERENCE	PAYMENT AMOUNT	DIST ID	GL ACCOUNT	CK TYPE	SQ
VENDOR TOTAL					6,683.29				
120671 FELD EQUIPMENT CO.									
0430946-IN	1	11/24/23	11/24/23	REPAIR TO PERSONAL PROT EQUIP	2,407.00	01	01.04.2530 MACHINE/EQUIP REPAIR	INVC	1
INVOICE TOTAL					2,407.00				
VENDOR TOTAL					2,407.00				
190558 FURTHER									
16708505	1	11/20/23	11/20/23	PARTICIPANT FEES	72.00	01	01.01.7999 MISCELLANEOUS EXPENSES E-PAYMNT 4145647 11/20/23	INVC	1
INVOICE TOTAL					72.00				
40782809									
	1	11/01/23	11/01/23	HRA FEES	96.34	01	01.07.1161 HEALTH REIMBURSEMENT EXPEN E-PAYMNT 4145586 11/01/23	INVC	1
	2			HRA FEES	19.27	01	01.01.1161 HEALTH REIMBURSEMENT EXPEN E-PAYMNT 4145586 11/01/23	INVC	1
	3			HRA FEES	19.27	11	11.26.1161 HEALTH REIMBURSEMENT EXPEN E-PAYMNT 4145586 11/01/23	INVC	1
	4			HRA FEES	19.27	12	12.11.1161 HEALTH REIMBURSEMENT EXPEN E-PAYMNT 4145586 11/01/23	INVC	1
	5			HRA FEES	19.27	18	18.21.1161 HEALTH REIMBURSEMENT EXP E-PAYMNT 4145586 11/01/23	INVC	1
	6			HRA FEES	19.26	24	24.01.1161 HEALTH REIMBURSEMENT EXPEN E-PAYMNT 4145586 11/01/23	INVC	1
	7			HRA FEES	1,310.19	11	11.24.1161 HEALTH REIMBURSEMENT EXPEN E-PAYMNT 4145586 11/01/23	INVC	1
INVOICE TOTAL					1,502.87				
VENDOR TOTAL					1,574.87				
70030 GALETON									
2696122	1	11/21/23	11/21/23	ROUGH RIDER GLVS FLANNEL	191.16	11	11.25.3006 SAFETY SUPPLIES	INVC	1
INVOICE TOTAL					191.16				
VENDOR TOTAL					191.16				
121830 GORDON CPA LLC									
144-22-3	1	11/21/23	11/21/23	FINAL PYMT ON 2022 AUDIT	350.00	01	01.01.2852 AUDIT/BUDGET SERVICES	INVC	1
	2			FINAL PYMT ON 2022 AUDIT	350.00	11	11.26.2852 AUDIT/BUDGET SERVICES	INVC	1
	3			FINAL PYMT ON 2022 AUDIT	150.00	12	12.11.2852 AUDIT/BUDGET SERVICES	INVC	1

## SCHEDULED CLAIMS LIST

INVOICE#	LINE	DUE DATE	INVOICE DATE	REFERENCE	PAYMENT AMOUNT	DIST ID	GL ACCOUNT	CK TYPE	SQ
	4			FINAL PYMT ON 2022 AUDIT	150.00	18	18.21.2852 AUDIT/BUDGET SERVICES	INVC	1
				INVOICE TOTAL	1,000.00				
				VENDOR TOTAL	1,000.00				
13786246	1	11/21/23	11/21/23	80025 HACH COMPANY CL17 FLAT RATE REPAIR FEE	1,823.50	12	12.12.2530 MACHINE/EQUIP REPAIR	INVC	1
				INVOICE TOTAL	1,823.50				
				VENDOR TOTAL	1,823.50				
3428044	1	11/24/23	11/24/23	600331 HUSCH BLACKWELL LLP RR LAW FIRM OCT 2023	13,109.00	73	73.01.2851 LEGAL SVCS-MIDLAND RAIL	INVC	1
				INVOICE TOTAL	13,109.00				
				VENDOR TOTAL	13,109.00				
CM-098237	1	2/21/23	2/21/23	90553 INLAND TRUCK PARTS BRAKE SHOE CORE RETURNED	72.00-	01	01.02.2540 VEHICLE REPAIRS	INVC	1
				INVOICE TOTAL	72.00-				
				VENDOR TOTAL	72.00-		NO CHECK ISSUING		
67830	1	11/21/23	11/21/23	90601 INTERNATIONAL TECHNICAL SLS 3509078 FILTER ELEMENT	490.21	11	11.24.2530 MACHINE/EQUIP REPAIR	INVC	1
				INVOICE TOTAL	490.21				
				VENDOR TOTAL	490.21				
OCTOBER 2023 STMT	1	11/21/23	11/21/23	1400130 JOHN DEERE FINANCIAL WIRING HARNESS MILL MACHINE	832.61	01	01.02.2530 MACHINE/EQUIP REPAIR	INVC	1
	2			27D LATCH	152.16	01	01.06.2530 MACHINE/EQUIP REPAIR	INVC	1
				INVOICE TOTAL	984.77				
				VENDOR TOTAL	984.77				
11/8/2023	1	11/28/23	11/28/23	1655868 KANSAS GAS SERVICE-1100 1100 ORANGE ST PUBLIC WORKS COMPLEX	98.04	11	11.24.3540 GENERATION FUEL E-PAYMENT 4145640 11/28/23	INVC	1
				INVOICE TOTAL	98.04				
				VENDOR TOTAL	98.04				
3100154	1	11/21/23	11/21/23	111300 KANSAS ONE-CALL SYSTEM, INC OCT 2023 LOCATE CALLS FEE	67.20	11	11.26.2999 OTHER CONTRACTUAL SERVICES	INVC	1

## SCHEDULED CLAIMS LIST

INVOICE#	LINE	DUE DATE	INVOICE DATE	REFERENCE	PAYMENT AMOUNT	DIST ID	GL ACCOUNT	CK TYPE	SQ
	2			OCT 2023 LOCATE CALLS FEE	67.20	12	12.11.2999	INVC	1
							OTHER CONTRACTUAL SERVICES		
				INVOICE TOTAL	134.40				
				VENDOR TOTAL	134.40				
07043	1	11/21/23	11/21/23	111350 KANSAS PEACE OFFICERS ASN KPOA MEMBER RENEWAL	390.00	01	01.05.2720	INVC	1
							DUES		
				INVOICE TOTAL	390.00				
				VENDOR TOTAL	390.00				
OCT 2023 SALES TAX	1	11/25/23	11/25/23	110800 KANSAS DEPARTMENT OF REVENUE OCT 2023 SALES TAX	13,686.22	11	11.00.0630	INVC	1
							SALES TAX REVENUE		
							E-PAYMNT 4145632 11/25/23		
	2			OCT 2023 SALES TAX	2,014.67	12	12.00.0630	INVC	1
							SALES TAX REVENUE		
							E-PAYMNT 4145632 11/25/23		
	3			BALDWIN RETIREMENT REFUND	736.11-	11	11.26.2820	INVC	1
							SALES TAX COLLECTED		
							E-PAYMNT 4145632 11/25/23		
	4			BALDWIN RETIREMENT REFUND	1,065.85-	12	12.11.2820	INVC	1
							SALES TAX COLLECTED		
							E-PAYMNT 4145632 11/25/23		
				INVOICE TOTAL	13,898.93				
				VENDOR TOTAL	13,898.93				
2432-10-23	1	11/21/23	11/21/23	112145 KMEA LABOR FROM MAY THRU OCT 2023 FOR THE CAT GENERATOR PROJECT	126,301.47	11	11.24.4650	INVC	1
							GENERATION EQUIPMENT		
				INVOICE TOTAL	126,301.47				
				VENDOR TOTAL	126,301.47				
EMP1-BA-2023-10	1	11/20/23	11/20/23	112151 KMEA EMP1 OPERATING FUND OCT 2023 KMEA EMP1 OP FUND	61,536.06	11	11.27.2786	INVC	1
							EMP NO 1 OPERATING (via KM)		
							E-PAYMNT 4145638 11/20/23		
				INVOICE TOTAL	61,536.06				
				VENDOR TOTAL	61,536.06				
GRDA-BALD-2023-12	1	12/06/23	12/06/23	112149 KMEA-GRDA OPERATING ACCOUNT DEC 2023 GRDA PWR SPLY PROJECT	81,739.00	11	11.27.2784	INVC	1
							GRDA CONTRACT POWER(via KM)		
							E-PAYMNT 4145643 12/06/23		
				INVOICE TOTAL	81,739.00				
				VENDOR TOTAL	81,739.00				
				112152 KMEA SPA HYDRO PROJECT					

## SCHEDULED CLAIMS LIST

INVOICE#	LINE	DUE DATE	INVOICE DATE	REFERENCE	PAYMENT AMOUNT	DIST ID	GL ACCOUNT	CK TYPE	SQ
SPA-BALD-2023-10	1	11/30/23	11/30/23	112152 KMEA SPA HYDRO PROJECT OCT 2023 SPA HYDRO PROJECT	752.02	11	11.27.2788 SPA HYDRO (via KMEA) E-PAYMNT 4145588 11/30/23	INVC	1
				INVOICE TOTAL	752.02				
				VENDOR TOTAL	752.02				
WAPA-BALD-2023-11	1	12/06/23	12/06/23	121155 KMEA WAPA OPS FUND NOV 2023 WAPA HYDRO PWERSPLY	5,031.00	11	11.27.2789 WAPA Hydro Project E-PAYMNT 4145648 12/06/23	INVC	1
				INVOICE TOTAL	5,031.00				
				VENDOR TOTAL	5,031.00				
0071007-2024	1	11/24/23	11/24/23	120350 LAWRENCE JOURNAL WORLD 2024 JOURNAL WORLD SUBSCRIPTIO 800-578-8748	130.32	01	01.01.2721 SUBSCRIPTIONS/BOOKS	INVC	1
				INVOICE TOTAL	130.32				
				VENDOR TOTAL	130.32				
122813	1	11/21/23	11/21/23	40011 DC TOOLS & SUPPLY M18 BATTERIES & 1/4"HEX DRIVER	796.00	01	01.02.3355 MINOR TOOLS/APPARATUS	INVC	1
				INVOICE TOTAL	796.00				
				VENDOR TOTAL	796.00				
E0500PGHRS	1	10/13/23	10/13/23	130614 MICROSOFT CORPORATION OFFICE 365 ALLOC W/SKYPE	7.20	01	01.10.4010 COMPUTER SOFTWARE E-PAYMNT 4145600 10/13/23	INVC	1
	2			OFFICE 365 ALLOC W/SKYPE	10.80	11	11.26.4010 COMPUTER SOFTWARE E-PAYMNT 4145600 10/13/23	INVC	1
	3			OFFICE 365 ALLOC W/SKYPE	10.80	12	12.11.4010 COMPUTER SOFTWARE E-PAYMNT 4145600 10/13/23	INVC	1
	4			OFFICE 365 ALLOC W/SKYPE	5.40	18	18.21.4010 COMPUTER SOFTWARE E-PAYMNT 4145600 10/13/23	INVC	1
	5			OFFICE 365 ALLOC W/SKYPE	1.80	24	24.01.4010 COMPUTER SOFTWARE E-PAYMNT 4145600 10/13/23	INVC	1
				INVOICE TOTAL	36.00				
E0500PGHSJ	1	10/13/23	10/13/23	OFFICE 365 ALLOC W/SKYPE	55.20	01	01.10.4010 COMPUTER SOFTWARE E-PAYMNT 4145601 10/13/23	INVC	1
	2			OFFICE 365 ALLOC W/SKYPE	82.80	11	11.26.4010 COMPUTER SOFTWARE E-PAYMNT 4145601 10/13/23	INVC	1

## SCHEDULED CLAIMS LIST

INVOICE#	LINE	DUE DATE	INVOICE DATE	REFERENCE	PAYMENT AMOUNT	DIST ID	GL ACCOUNT	CK TYPE	SQ
	3			OFFICE 365 ALLOC W/SKYPE	82.80	12	12.11.4010 COMPUTER SOFTWARE E-PAYMNT 4145601 10/13/23	INVC	1
	4			OFFICE 365 ALLOC W/SKYPE	41.40	18	18.21.4010 COMPUTER SOFTWARE E-PAYMNT 4145601 10/13/23	INVC	1
	5			OFFICE 365 ALLOC W/SKYPE	13.80	24	24.01.4010 COMPUTER SOFTWARE E-PAYMNT 4145601 10/13/23	INVC	1
				INVOICE TOTAL	276.00				
E0500PUFK4	1	11/13/23	11/13/23	OFFICE 365 ALLOC W/SKYPE	55.20	01	01.10.4010 COMPUTER SOFTWARE E-PAYMNT 4145635 11/13/23	INVC	1
	2			OFFICE 365 ALLOC W/SKYPE	82.80	11	11.26.4010 COMPUTER SOFTWARE E-PAYMNT 4145635 11/13/23	INVC	1
	3			OFFICE 365 ALLOC W/SKYPE	82.80	12	12.11.4010 COMPUTER SOFTWARE E-PAYMNT 4145635 11/13/23	INVC	1
	4			OFFICE 365 ALLOC W/SKYPE	41.40	18	18.21.4010 COMPUTER SOFTWARE E-PAYMNT 4145635 11/13/23	INVC	1
	5			OFFICE 365 ALLOC W/SKYPE	13.80	24	24.01.4010 COMPUTER SOFTWARE E-PAYMNT 4145635 11/13/23	INVC	1
				INVOICE TOTAL	276.00				
E0500PUHF2	1	11/13/23	11/13/23	OFFICE 365 ALLOC W/SKYPE	7.20	01	01.10.4010 COMPUTER SOFTWARE E-PAYMNT 4145634 11/13/23	INVC	1
	2			OFFICE 365 ALLOC W/SKYPE	10.80	11	11.26.4010 COMPUTER SOFTWARE E-PAYMNT 4145634 11/13/23	INVC	1
	3			OFFICE 365 ALLOC W/SKYPE	10.80	12	12.11.4010 COMPUTER SOFTWARE E-PAYMNT 4145634 11/13/23	INVC	1
	4			OFFICE 365 ALLOC W/SKYPE	5.40	18	18.21.4010 COMPUTER SOFTWARE E-PAYMNT 4145634 11/13/23	INVC	1
	5			OFFICE 365 ALLOC W/SKYPE	1.80	24	24.01.4010 COMPUTER SOFTWARE E-PAYMNT 4145634 11/13/23	INVC	1
				INVOICE TOTAL	36.00				
				VENDOR TOTAL	624.00				
85539	1	11/21/23	11/21/23	140020 N ZONE SPORTSWEAR EMPLOYEE SHIRTS	204.15	01	01.02.3610 UNIFORMS	INVC	1
	2			EMPLOYEE SHIRTS	170.05	01	01.35.3610 UNIFORMS	INVC	1
	3			EMPLOYEE SHIRTS	359.05	11	11.24.3610 UNIFORMS	INVC	1

## SCHEDULED CLAIMS LIST

INVOICE#	LINE	DUE DATE	INVOICE DATE	REFERENCE	PAYMENT AMOUNT	DIST ID	GL ACCOUNT	CK TYPE	SQ
	4			EMPLOYEE SHIRTS	177.05	12	12.12.3610	INVC	1
							UNIFORMS		
	5			EMPLOYEE SHIRTS	368.56	18	18.22.3610	INVC	1
							UNIFORMS		
				INVOICE TOTAL	1,278.86				
				VENDOR TOTAL	1,278.86				
				140035 NAPA AUTO PARTS					
NAPA OCT 2023 FD	1	11/24/23	11/24/23	BATTERY FOR FIRE DEPT	98.48	01	01.04.3350	INVC	1
							TIRES/BATTERIES		
	2			BLUE MAGIC POLISH FOR FD	7.66	01	01.04.3800	INVC	1
							MATERIALS/SUPPLIES		
	3			BATTERY & ADAPTER FOR FD	142.62	01	01.04.3350	INVC	1
							TIRES/BATTERIES		
				INVOICE TOTAL	248.76				
NAPA_OCT2023_PD	1	11/24/23	11/24/23	UNIT 51-DISC PADS	63.78	01	01.05.2540	INVC	1
							VEHICLE REPAIRS		
	2			MOTOR MOUNT-STOCK	95.12	01	01.05.3310	INVC	1
							VEHICLE OPERATION SUPPLIES		
	3			UNIT 52-LUG NUT	1.95	01	01.05.3310	INVC	1
							VEHICLE OPERATION SUPPLIES		
	4			UNIT 52-LUG NUTS	7.80	01	01.05.3310	INVC	1
							VEHICLE OPERATION SUPPLIES		
	5			PD-WINDSHIELD UNIT	3.20	01	01.05.3310	INVC	1
							VEHICLE OPERATION SUPPLIES		
				INVOICE TOTAL	171.85				
OCT2023_STMT_PUB	1	11/21/23	11/21/23	OCT2023_STMT_PUB	212.99	01	01.02.2540	INVC	1
							VEHICLE REPAIRS		
	2			OCT2023_STMT_PUB	403.24	01	01.02.3350	INVC	1
							TIRES/BATTERIES		
	3			OCT2023_STMT_PUB	91.08	01	01.02.3530	INVC	1
							VEHICLE GAS/OIL		
	4			OCT2023_STMT_PUB	11.86	01	01.02.3800	INVC	1
							MATERIALS/SUPPLIES		
	5			OCT2023_STMT_PUB	143.37	03	03.01.3350	INVC	1
							TIRES/BATTERIES		
	6			OCT2023_STMT_PUB	481.42	11	11.24.2540	INVC	1
							VEHICLE REPAIRS		
	7			OCT2023_STMT_PUB	42.04	11	11.25.3310	INVC	1
							VEHICLE OPERATING SUPPLIES		
	8			OCT2023_STMT_PUB	179.11	11	11.25.2540	INVC	1
							VEHICLE REPAIRS		
	9			OCT2023_STMT_PUB	38.23	11	11.25.3800	INVC	1
							MATERIALS/SUPPLIES		
	10			OCT2023_STMT_PUB	212.99	12	12.12.2540	INVC	1
							VEHICLE REPAIRS		
	11			OCT2023_STMT_PUB	33.66	18	18.22.2540	INVC	1
							VEHICLE REPAIRS		
	12			OCT2023_STMT_PUB	7.99	18	18.22.3530	INVC	1
							VEHICLE GAS/OIL		
				INVOICE TOTAL	1,857.98				

## SCHEDULED CLAIMS LIST

INVOICE#	LINE	DUE DATE	INVOICE DATE	REFERENCE	PAYMENT AMOUNT		DIST ID	GL ACCOUNT	CK TYPE	SQ
VENDOR TOTAL					2,278.59	✓				
76438	1	11/21/23	11/21/23	127795 NORRIS EQUIPMENT CO LLC HOSE-FLEX 62"/BLADE-18 MEDIUM	141.15	03	03.01.2530	MACHINE/EQUIP REPAIR	INVC	1
INVOICE TOTAL					141.15					
VENDOR TOTAL					141.15	✓				
204754	1	11/24/23	11/24/23	70791 GREEN ENVIRONMENTAL SVC, LLC OCT2023 BILLING:TRASH&RECYCLG	11.23	01	01.01.2495	TRASH SERVICE	INVC	1
	2			OCT2023 BILLING:TRASH&RECYCLG	10.20	01	01.02.2495	TRASH SERVICE	INVC	1
	3			OCT2023 BILLING:TRASH&RECYCLG	68.52	01	01.03.2495	TRASH SERVICE	INVC	1
	4			OCT2023 BILLING:TRASH&RECYCLG	74.99	01	01.04.2495	TRASH SERVICE	INVC	1
	5			OCT2023 BILLING:TRASH&RECYCLG	10.20	01	01.05.2495	TRASH SERVICE	INVC	1
	6			OCT2023 BILLING:TRASH&RECYCLG	9.35	03	03.01.2495	TRASH SERVICE	INVC	1
	7			OCT2023 BILLING:TRASH&RECYCLG	64.88	11	11.24.2495	TRASH SERVICE	INVC	1
	8			OCT2023 BILLING:TRASH&RECYCLG	82.50	12	12.11.2495	TRASH SERVICE	INVC	1
	9			OCT2023 BILLING:TRASH&RECYCLG	117.45	18	18.22.2495	TRASH SERVICE	INVC	1
INVOICE TOTAL					449.32					
207035	1	11/24/23	11/24/23	OCT2023 BILLING:TRASH&RECYCLG	18,408.50	24	24.01.2491	CONTRACTUAL SERVICES - TRA	INVC	1
	2			OCT2023 BILLING:TRASH&RECYCLG	1,648.50	24	24.01.2492	RECYCLING COSTS	INVC	1
INVOICE TOTAL					20,057.00					
VENDOR TOTAL					20,506.32	✓				
2360194623	1	11/21/23	11/21/23	160009 PACE ANALYTICAL SERVICES, LLC MONTHLY TESTING FEES	525.70	18	18.22.2202	LAB TESTS	INVC	1
INVOICE TOTAL					525.70					
2360195458	1	11/21/23	11/21/23	MONTHLY TESTING FEE	587.40	18	18.22.2202	LAB TESTS	INVC	1
INVOICE TOTAL					587.40					
VENDOR TOTAL					1,113.10	✓				
AR1/51036224	1	11/21/23	11/21/23	600232 PARKSON CORPORATION AERATION/DIFFUSER PARTS	15,612.11	18	18.22.2530	MACHINE/EQUIP REPAIR	INVC	1
INVOICE TOTAL					15,612.11					



# SCHEDULED CLAIMS LIST

INVOICE#	LINE	DUE DATE	INVOICE DATE	REFERENCE	PAYMENT AMOUNT	DIST ID	GL ACCOUNT	CK TYPE	SQ
				VENDOR TOTAL	15,612.11				
27594	1	11/21/23	11/21/23	160050 PENNY'S AGGREGATE, INC. AB-3 1 1/2"	1,178.45	01	01.02.3341 ROCK/SAND/CHIPS	INVC	1
				INVOICE TOTAL	1,178.45				
				VENDOR TOTAL	1,178.45				
2023-1109	1	11/24/23	11/24/23	160400 POSTMASTER POSTAGE-PERMIT #15 (UB) INV# YYYY-MMDD	500.00	11	11.26.2150 POSTAGE	INVC	1
	2			POSTAGE-PERMIT #15 (UB) INV# YYYY-MMDD	500.00	12	12.11.2150 POSTAGE	INVC	1
				INVOICE TOTAL	1,000.00				
				VENDOR TOTAL	1,000.00				
205	1	11/24/23	11/24/23	600173 JASON PRIER CDBG LAWSUIT JUL-OCT 2023	46,423.56	73	73.01.2851 LEGAL SVCS-MIDLAND RAIL	INVC	1
				INVOICE TOTAL	46,423.56				
207	1	11/24/23	11/24/23	RAIL EVENT FORCLOSURE JUL-OCT	6,650.00	73	73.01.2851 LEGAL SVCS-MIDLAND RAIL	INVC	1
				INVOICE TOTAL	6,650.00				
208	1	11/24/23	11/24/23	TRAIL EASEMENT JUL-OCT 2023	54,112.00	73	73.01.2851 LEGAL SVCS-MIDLAND RAIL	INVC	1
				INVOICE TOTAL	54,112.00				
				VENDOR TOTAL	107,185.56				
OCT2023	1	11/21/23	11/21/23	180790 ROYAL CLEANERS OCT 2023 DRY CLEANING	38.75	01	01.05.3630 DRY CLEANING	INVC	1
				INVOICE TOTAL	38.75				
				VENDOR TOTAL	38.75				
93823110	1	11/21/23	11/21/23	180795 ROYAL METAL IND. INC. SCH 40 ADJ COL WELD CLIP TOPS	1,545.78	11	11.24.4650 GENERATION EQUIPMENT	INVC	1
				INVOICE TOTAL	1,545.78				
				VENDOR TOTAL	1,545.78				
UMB OCT 2023 AP0681	1	11/24/23	11/24/23	30027 UMB-CARD SERVICES GO BOND 2023-A MARKETING & DIS	450.00	40	40.24.2854 COST OF ISSUANCE E-PAYMNT 4145651 11/21/23	INVC	1
	2			DG CO TREASURER SERVICE FEE	1.08	11	11.25.7999 MISCELLANEOUS EXPENSES E-PAYMNT 4145651 11/21/23	INVC	1

## SCHEDULED CLAIMS LIST

INVOICE#	LINE	DUE DATE	INVOICE DATE	REFERENCE	PAYMENT AMOUNT	DIST ID	GL ACCOUNT	CK TYPE	SQ
	3			DG CO TREASURER TITLE FEES	44.75	11	11.25.7999 MISCELLANEOUS EXPENSES E-PAYMNT 4145651 11/21/23	INVC	1
	4			CORRECTION TAPE	14.99	01	01.01.3110 OFFICE SUPPLIES E-PAYMNT 4145651 11/21/23	INVC	1
	5			INK CARTRIDGES FOR MUN COURT	31.89	01	01.07.3110 OFFICE SUPPLIES E-PAYMNT 4145651 11/21/23	INVC	1
	6			HP PRINTER FOR MUN COURT	89.89	01	01.07.3110 OFFICE SUPPLIES E-PAYMNT 4145651 11/21/23	INVC	1
	7			PLEDGE CLEANER FROM AMAZON	14.41	01	01.01.2521 JANITORIAL SERVICES E-PAYMNT 4145651 11/21/23	INVC	1
	8			AMARA WILL REIMBURSE	8.03	01	01.01.7999 MISCELLANEOUS EXPENSES E-PAYMNT 4145651 11/21/23	INVC	1
	9			DONUTS FOR WORKING BRUNCH	62.03	01	01.01.2170 MEALS/LODGING E-PAYMNT 4145651 11/21/23	INVC	1
	10			HALLOWEEN CANDY FOR CITY HALL	57.81	01	01.01.3900 PUBLIC RELATIONS E-PAYMNT 4145651 11/21/23	INVC	1
	11			W2 FORMS FOR 2023	103.40	01	01.01.3110 OFFICE SUPPLIES E-PAYMNT 4145651 11/21/23	INVC	1
	12			FLOWERS FOR G RODDEN'S WIFE	67.99	01	01.01.2450 EMPLOYEE APPRECIATION E-PAYMNT 4145651 11/21/23	INVC	1
	13			KITCHEN SUPPLIES FOR CITY HALL	108.08	01	01.01.3110 OFFICE SUPPLIES E-PAYMNT 4145651 11/21/23	INVC	1
	14			HOMESTEAD WORKING LUNCH	120.00	01	01.01.2170 MEALS/LODGING E-PAYMNT 4145651 11/21/23	INVC	1
	15			ADOBE SOFTWARE FOR CITY HALL	23.88	01	01.01.4010 COMPUTER SOFTWARE E-PAYMNT 4145651 11/21/23	INVC	1
	16			SPOONS & FORKS FROM AMAZON	39.98	01	01.01.3110 OFFICE SUPPLIES E-PAYMNT 4145651 11/21/23	INVC	1
				INVOICE TOTAL	1,238.21				
UMB OCT 2023 GR0426	1	11/24/23	11/24/23	MONTHLY MAPLE PUBLISHING FEE	500.00	01	01.01.2330 LEGAL PUBLICATIONS E-PAYMNT 4145651 11/21/23	INVC	1
	2			DRURY INN WICHITA KS	290.67	01	01.01.2170 MEALS/LODGING E-PAYMNT 4145651 11/21/23	INVC	1
				INVOICE TOTAL	790.67				
UMB OCT 2023 JW 0574	1	11/21/23	11/21/23	PRICE CHOPPER:EMPLOYEE MEALS	120.53	11	11.24.2170 MEALS/LODGING	INVC	1

INVOICE#	LINE	DUE DATE	INVOICE DATE	REFERENCE	PAYMENT AMOUNT	DIST ID	GL ACCOUNT	CK TYPE	SQ
	2			GATEHOUSE SUPPLIES	1,230.93	11	E-PAYMNT 4145651 11/21/23 11.24.2520 BUILDING REPAIRS	INVC	1
	3			DOLLAR GENERAL	4.37	11	E-PAYMNT 4145651 11/21/23 11.24.3110 OFFICE SUPPLIES	INVC	1
	4			KDHE STORAGE TANK PERMIT FEE	53.25	11	E-PAYMNT 4145651 11/21/23 11.24.7999 MISCELLANEOUS EXPENSES	INVC	1
	5			AIR CLASS-II PERMIT MOD	104.50	11	E-PAYMNT 4145651 11/21/23 11.24.7999 MISCELLANEOUS EXPENSES	INVC	1
	6			KDHE ABOVE GROUND STORAGE TANK	12.25	11	E-PAYMNT 4145651 11/21/23 11.24.7999 MISCELLANEOUS EXPENSES	INVC	1
	7			MISCELLANEOUS AND RETAIL STORE	393.29	11	E-PAYMNT 4145651 11/21/23 11.24.3355 MINOR TOOLS/APPARATUS	INVC	1
	8			HARBOR FREIGHT	355.45	11	E-PAYMNT 4145651 11/21/23 11.24.3800 MATERIALS/SUPPLIES	INVC	1
	9			KAN-SEAL	104.00	11	E-PAYMNT 4145651 11/21/23 11.24.2530 MACHINE/EQUIP REPAIR	INVC	1
	10			MUNCHERS BAKERY	79.35	11	E-PAYMNT 4145651 11/21/23 11.24.3900 PUBLIC RELATIONS	INVC	1
	11			HY-VEE	49.07	11	E-PAYMNT 4145651 11/21/23 11.24.3900 PUBLIC RELATIONS	INVC	1
	12			DRURY INN:KMEA CONFERENCE	315.94	11	E-PAYMNT 4145651 11/21/23 11.24.2170 MEALS/LODGING	INVC	1
	13			SUBWAY	13.64	11	E-PAYMNT 4145651 11/21/23 11.24.2170 MEALS/LODGING	INVC	1
				INVOICE TOTAL	2,836.57		E-PAYMNT 4145651 11/21/23		
UMB OCT 2023 LM0657	1	11/24/23	11/24/23	MONTHLY ADOBE SOFTWARE FOR LYNN	39.99	01	01.10.4010 COMPUTER SOFTWARE	INVC	1
	2			FACEBOOK AD FOR BIG HAIR	26.24	01	E-PAYMNT 4145651 11/21/23 01.01.2470 COMMUNITY EVENTS	INVC	1
	3			MONTHLY SPROUT SOCIAL SOFTWARE	99.00	01	E-PAYMNT 4145651 11/21/23 01.10.4010 COMPUTER SOFTWARE	INVC	1
	4			HALLOWEEN CANDY/MASKS/CLOTH	169.94	01	E-PAYMNT 4145651 11/21/23 01.01.3900 PUBLIC RELATIONS	INVC	1
	5			ANNUAL JOB POSTING FEE	800.00	01	E-PAYMNT 4145651 11/21/23 01.01.2200 EMPLOYMENT RECRUITMENT	INVC	1
							E-PAYMNT 4145651 11/21/23		

## SCHEDULED CLAIMS LIST

INVOICE#	LINE	DUE DATE	INVOICE DATE	REFERENCE	PAYMENT AMOUNT	DIST ID	GL ACCOUNT	CK TYPE	SQ
INVOICE TOTAL					1,135.17				
UMB OCT 2023 MR 9254	1	11/21/23	11/21/23	USPS PO NOTICE LTR SENT	8.56	01	01.35.2150 POSTAGE E-PAYMNT 4145651 11/21/23	INVC	1
	2			ADOBE	21.84	01	01.02.7999 MISCELLANEOUS EXPENSES E-PAYMNT 4145651 11/21/23	INVC	1
	3			HOME DEPOT	139.72	03	03.01.2610 GROUNDS MAINTENANCE E-PAYMNT 4145651 11/21/23	INVC	1
INVOICE TOTAL					170.12				
UMB OCT 2023 PM 0715	1	11/21/23	11/21/23	HARBOR FREIGHT	182.39	11	11.25.3800 MATERIALS/SUPPLIES E-PAYMNT 4145651 11/21/23	INVC	1
	2			PRICE CHOPPER:EMPLOYEE LUNCH	153.84	11	11.26.2450 EMPLOYEE APPRECIATION E-PAYMNT 4145651 11/21/23	INVC	1
	3			E.EDWARDS:Z.GRABBE BIB OVERALL	183.20	11	11.25.3610 UNIFORMS E-PAYMNT 4145651 11/21/23	INVC	1
INVOICE TOTAL					519.43				
UMB OCT 2023 RC 9015	1	11/21/23	11/21/23	FLEETWOOD MOWER&RENTS:SULLIVAN	45.90	01	01.03.2530 MACHINE/EQUIP REPAIR E-PAYMNT 4145651 11/21/23	INVC	1
	2			WALMART:TCL TV PUB CONFRNC RM	248.00	01	01.02.3110 OFFICE SUPPLIES E-PAYMNT 4145651 11/21/23	INVC	1
	3			DRURY INN:KMEA CONFRNCE	145.97	01	01.02.2170 MEALS/LODGING E-PAYMNT 4145651 11/21/23	INVC	1
	4			DILLONS:FUEL TO CONFRNCE	20.00	01	01.02.3530 VEHICLE GAS/OIL E-PAYMNT 4145651 11/21/23	INVC	1
	5			WALMART:EMPLOYEE LUNCH	105.87	01	01.02.2450 EMPLOYEE APPRECIATION E-PAYMNT 4145651 11/21/23	INVC	1
INVOICE TOTAL					565.74				
UMB OCT 2023 RH 0699	1	11/21/23	11/21/23	COLUMN PUBLIC NOTICE	550.33	01	01.01.2330 LEGAL PUBLICATIONS E-PAYMNT 4145651 11/21/23	INVC	1
INVOICE TOTAL					550.33				
UMB OCT 2023 SY 0723	1	11/21/23	11/21/23	USPS PO:NOTICE LTRS SENT	17.12	01	01.35.2150 POSTAGE E-PAYMNT 4145651 11/21/23	INVC	1
INVOICE TOTAL					17.12				
UMB OCT 2023 TA 0582	1	11/21/23	11/21/23	FRANKLIN CNTY LANDFILL	52.82	01	01.02.3350 TIRES/BATTERIES E-PAYMNT 4145651 11/21/23	INVC	1

## SCHEDULED CLAIMS LIST

INVOICE#	LINE	DUE DATE	INVOICE DATE	REFERENCE	PAYMENT AMOUNT	DIST ID	GL ACCOUNT	CK TYPE SQ
	2			FRANKLIN CNTY LANDFILL	52.80	12	12.12.3350 TIRES/BATTERIES E-PAYMNT 4145651 11/21/23	INVC 1
	3			FRANKLIN CNTY LANDFILL	16.68	01	01.02.3350 TIRES/BATTERIES E-PAYMNT 4145651 11/21/23	INVC 1
	4			FRANKLIN CNTY LANDFILL	16.68	01	01.03.3350 TIRES AND BATTERIES E-PAYMNT 4145651 11/21/23	INVC 1
	5			FRANKLIN CNTY LANDFILL	16.68	12	12.12.3350 TIRES/BATTERIES E-PAYMNT 4145651 11/21/23	INVC 1
	6			FRANKLIN CNTY LANDFILL	16.68	11	11.25.3350 TIRES/BATTERIES E-PAYMNT 4145651 11/21/23	INVC 1
	7			ANDERSON TIRE	27.50	01	01.02.3350 TIRES/BATTERIES E-PAYMNT 4145651 11/21/23	INVC 1
	8			ANDERSON TIRE	27.50	12	12.12.3350 TIRES/BATTERIES E-PAYMNT 4145651 11/21/23	INVC 1
	9			ANDERSON TIRE	27.50	18	18.22.3350 TIRES/BATTERIES E-PAYMNT 4145651 11/21/23	INVC 1
				INVOICE TOTAL	254.84			
UMB OCT 2023 TB0459	1	11/24/23	11/24/23	HOMESTEAD BREAKFASTS FOR FD	59.00	01	01.04.2170 MEALS/LODGING E-PAYMNT 4145651 11/21/23	INVC 1
	2			TSHIRTS FROM BLUE COLLAR	170.16	01	01.04.3900 PUBLIC RELATIONS E-PAYMNT 4145651 11/21/23	INVC 1
	3			TSHIRTS FROM BLUE COLLAR	253.33	01	01.04.3900 PUBLIC RELATIONS E-PAYMNT 4145651 11/21/23	INVC 1
	4			VANDEBILTS	89.99	01	01.04.3610 UNIFORMS E-PAYMNT 4145651 11/21/23	INVC 1
	5			FORKS/SPOONS/BOWLS FROM DG	49.35	01	01.04.2170 MEALS/LODGING E-PAYMNT 4145651 11/21/23	INVC 1
	6			FOOD/PAPER PLATES FROM DG	63.11	01	01.04.2170 MEALS/LODGING E-PAYMNT 4145651 11/21/23	INVC 1
	7			FOOD FROM HYVEE	408.29	01	01.04.2170 MEALS/LODGING E-PAYMNT 4145651 11/21/23	INVC 1
	8			FOOD FROM BALDWIN CITY MARKET	24.91	01	01.04.2170 MEALS/LODGING E-PAYMNT 4145651 11/21/23	INVC 1
	9			HALLOWEEN CANDY FROM DG	210.00	01	01.04.3900 PUBLIC RELATIONS E-PAYMNT 4145651 11/21/23	INVC 1
				INVOICE TOTAL	1,328.14			

## SCHEDULED CLAIMS LIST

INVOICE#	LINE	DUE DATE	INVOICE DATE	REFERENCE	PAYMENT AMOUNT	DIST ID	GL ACCOUNT	CK TYPE	SQ
UMB_OCT2023_JM0491	1	11/21/23	11/21/23	WALMART- 2 1TB DRIVES	122.42	01	01.05.3110 OFFICE SUPPLIES E-PAYMNT 4145651 11/21/23	INVC	1
				INVOICE TOTAL	122.42				
UMB_OCT2023_MP9197	1	11/21/23	11/21/23	CASEYS- GAS	32.12	01	01.05.3530 VEHICLE GAS/OIL E-PAYMNT 4145651 11/21/23	INVC	1
	2			HUSHMAIL	83.86	01	01.05.4010 COMPUTER SOFTWARE E-PAYMNT 4145651 11/21/23	INVC	1
				INVOICE TOTAL	115.98				
UMB_OCT2023_MR0558	1	11/21/23	11/21/23	SIRCHIE-DRUG TEST KITS	89.30	01	01.05.3110 OFFICE SUPPLIES E-PAYMNT 4145651 11/21/23	INVC	1
	2			BC MARKET-SNACKS FOR STAFF MTG	53.48	01	01.05.7999 MISCELLANEOUS EXPENSES E-PAYMNT 4145651 11/21/23	INVC	1
	3			HOMESTEAD-DONUTS, MAPLE LEAF	72.00	01	01.05.7999 MISCELLANEOUS EXPENSES E-PAYMNT 4145651 11/21/23	INVC	1
	4			WALMART-MAPLE LEAF SUPPLIES	439.21	01	01.05.7999 MISCELLANEOUS EXPENSES E-PAYMNT 4145651 11/21/23	INVC	1
	5			WALMART-MAPLE LEAF SUPPLIES	216.93	01	01.05.7999 MISCELLANEOUS EXPENSES E-PAYMNT 4145651 11/21/23	INVC	1
	6			EZCATER-SUBWAY-MAPLE LEAF FOOD	319.12	01	01.05.7999 MISCELLANEOUS EXPENSES E-PAYMNT 4145651 11/21/23	INVC	1
	7			KHP-VIN INSP FORMS	400.00	01	01.00.0078 VIN VERIFICATION PAYABLE E-PAYMNT 4145651 11/21/23	INVC	1
				INVOICE TOTAL	1,590.04				
UMB_OCT2023_RB0566	1	11/21/23	11/21/23	ARROWHEAD-OFFICE BIT SET	17.99	01	01.05.3110 OFFICE SUPPLIES E-PAYMNT 4145651 11/21/23	INVC	1
	2			DOLLAR GENERAL-COFFEE FILTERS	5.25	01	01.05.3110 OFFICE SUPPLIES E-PAYMNT 4145651 11/21/23	INVC	1
				INVOICE TOTAL	23.24				
				VENDOR TOTAL	11,258.02				
9947629631	1	11/15/23	11/15/23	30050 VERIZON WIRELESS 11/15/23 BILL	455.96	01	01.01.2500 TELEPHONE SERVICE-LAND E-PAYMNT 4145587 11/15/23	INVC	1
	2			11/15/23 BILL	376.26	01	01.02.2500 TELEPHONE SERVICE-LAND E-PAYMNT 4145587 11/15/23	INVC	1
	3			11/15/23 BILL	111.73	01	01.04.2500	INVC	1

SCHEDULED CLAIMS LIST

INVOICE#	LINE	DUE DATE	INVOICE DATE	REFERENCE	PAYMENT AMOUNT	DIST ID	GL ACCOUNT	CK TYPE	SQ
	4		11/15/23	BILL	1,251.37	01	TELEPHONE SERVICE-LAND E-PAYMNT 4145587 11/15/23 01.05.2500	INVC	1
	5		11/15/23	BILL	28.99	01	TELEPHONE SERVICE-LAND E-PAYMNT 4145587 11/15/23 01.07.2500	INVC	1
	6		11/15/23	BILL	70.45	01	TELEPHONE SERVICE-LAND E-PAYMNT 4145587 11/15/23 01.35.2500	INVC	1
	7		11/15/23	BILL	260.29	11	TELEPHONE SERVICE-LAND E-PAYMNT 4145587 11/15/23 11.26.2500	INVC	1
	8		11/15/23	BILL	28.99	12	TELEPHONE SERVICE-LAND E-PAYMNT 4145587 11/15/23 12.11.2500	INVC	1
	9		11/15/23	BILL	153.36	18	TELEPHONE SERVICE-LAND E-PAYMNT 4145587 11/15/23 18.21.2500	INVC	1
				INVOICE TOTAL	2,737.40				
				VENDOR TOTAL	2,737.40				
				BALDWIN STATE BANK TOTAL	683,992.38				
				BSB-BLOCK GRANT ACCOUNT					
206	1	11/24/23	11/24/23	600173 JASON PRIER ORCHARD LANE CULVERT MAY-OCT	1,862.00	01CDBG	01.02.4999 OTHER CAPITAL OUTLAY	INVC	1
				INVOICE TOTAL	1,862.00				
				VENDOR TOTAL	1,862.00				
				BSB-BLOCK GRANT ACCOUNT TOTAL	1,862.00				
				TOTAL MANUAL CHECKS	.00				
				TOTAL E-PAYMENTS	315,688.10				
				TOTAL PURCH CARDS	.00				
				TOTAL ACH PAYMENTS	.00				
				TOTAL OPEN PAYMENTS	370,166.28				
				GRAND TOTALS	685,854.38				

APUPDT00      Fri Nov 17, 2023 1:34 PM  
07.01.21    POSTING DATE:      11/21/2023

City of Baldwin City  
SCHEDULED PAYMENT UPDATE DETAIL  
CALENDAR 11/2023, FISCAL 11/2023

OPER: JF  
JRNL:8708

PAGE    1

INVOICE	LN	DIST ID	DUE DATE	REFERENCE	PAID AMT	CHECK NO		
-----								
		600346		WILLIAMS, JAMES OR KRYSTAL				
1217 ELM EASEMENT	1	01	11/21/23	1217 EASEMENT PAYMENT	607.00	66403		
				** VENDOR TOTAL **	607.00	607.00	.00	607.00
				** PRINTD CHK TOTAL **				607.00
				** GRAND TOTAL **	607.00	607.00	.00	607.00



ACCOUNT NUMBER	ACCOUNT TITLE	DEBITS	CREDITS	NET
01.00.0001	GENERAL FUND CASH ACCT	.00	607.00	607.00-
01.00.0020	ACCOUNTS PAYABLE	607.00	.00	607.00
TRANSACTION TOTALS		607.00	607.00	.00
FUND	NAME	DEBITS	CREDITS	
01	GENERAL FUND	607.00	607.00	
TOTALS		607.00	607.00	