

# HOW THE **FORUM HUB™** SYSTEM WORKS

# FORUM HUB™

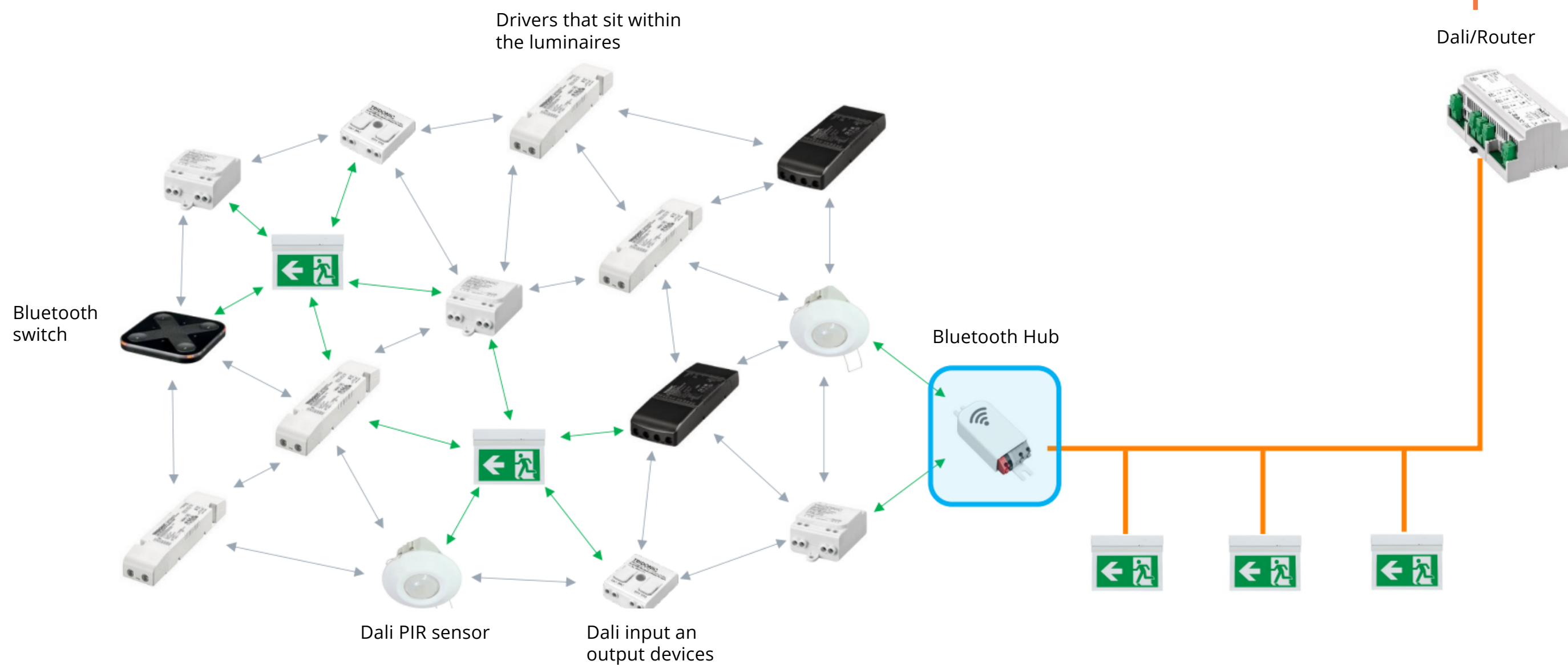

Forum HUB™ utilises open protocol Remote Monitoring System applied to the Building 360 platform which enables the emergency lighting tests are then logged automatically. Each luminaire communicates via Bluetooth through the integrated driver to the remote sceneCOM unit. Each sceneCOM will accommodate one hundred and ninety-two separate fittings. The sceneCOM then relays the LUMDATA back to the cloud storage offering infinite data. Any deviations from the set parameters will be alerted to the designated team either on or off site via SMS or e-mail. The 3D floor plans allow the Engineering Team to view emergency lights down to individual fittings - highlighting luminaires that have failed their automated emergency light test or are close to their predetermined limits.