



## Description

---

The SMAVOO Switch is a highly efficient sensor that ensures the smooth operation of warehouse logistics. It monitors the presence of small boxes (KLTs) and automatically triggers material reordering when needed. With an adjustable height and slim design, it integrates seamlessly into existing shelving systems. Featuring a long battery life of three to six years, it

supports long-term, maintenance-free operation. The SMAVOO Switch optimizes material flow, reducing downtime and improving overall efficiency in warehouse management. Additionally, its hybrid communication options (WiFi & LoRaWAN) provide flexible connectivity for various industrial environments during everyday warehouse operations.

## Key Features

---

- |     |                                    |     |                                      |
|-----|------------------------------------|-----|--------------------------------------|
| 01. | Automatic Replenishment            | 03. | Hybrid Connectivity, Built for Scale |
| 02. | Long Lever with 180° Adjustability | 04. | Ultra-Low Power, Long Battery Life   |
-

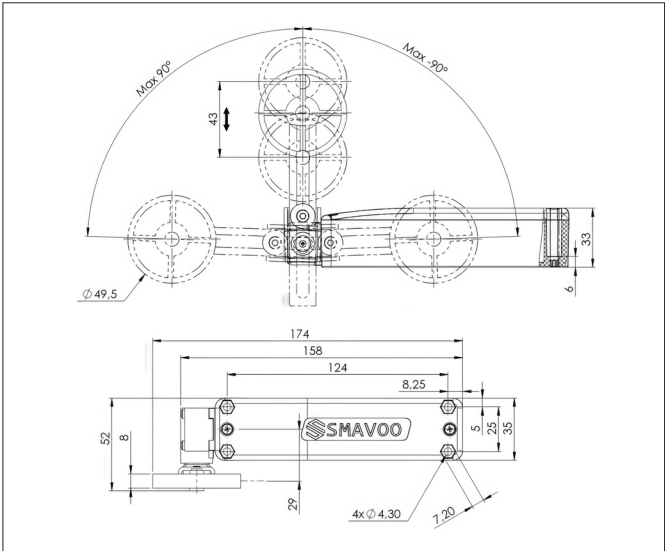

Enclosure	Dimensions	158 mm x 34 mm x 34 mm (enclosure)	80 mm - 123 mm (adjustable arm length)
	Weight	ca. 144 g (without battery)	ca. 200 g (with battery)
	Material & Color	PA6, orange	
	Installation	Standard rocker bracket for common KLT shelving	
Power Management	Power Supply	1x ER26500 lithium battery	
	Lifetime	Battery life of approx. 3 to 6 years in three-shift operation (depending on measurement and transmission frequency)	
Temperature Regulations	Operating Temperature	-10 °C to +40 °C	
	Ingress Protection (IP)	IP40	
Quality & Compliance	Certifications	CE	
	Warranty	24 months	
Device Functionality	Lever Switch	Long lever with 180-degree adjustability	



## ONE.CORE Function

SMAVOO ONE.CORE is the heart of the SMAVOO ecosystem — a fully modular sensor platform designed specifically for demanding industrial environments. Unlike conventional IoT devices with fixed feature sets, ONE.CORE adapts precisely to your requirements through interchangeable communication modules, configurable sensor interfaces, and edge-computing

capabilities. Born out of frustration with proprietary systems that lock companies into inflexible technologies, ONE.CORE is built on open standards and a future-proof design. Start with exactly what you need today and expand the platform seamlessly as your business grows and evolves naturally — all without having to replace your hardware investment.

## ONE.CORE Key Features

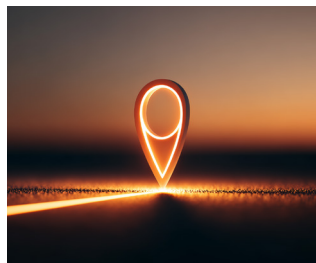

# 01.

Modular Communication:  
WiFi, LoRaWAN, Bluetooth  
Low Energy (BLE)

# 02.

Plug-and-Play Interface for  
Sensors (RFID, Barcode,  
Environment, Movement)

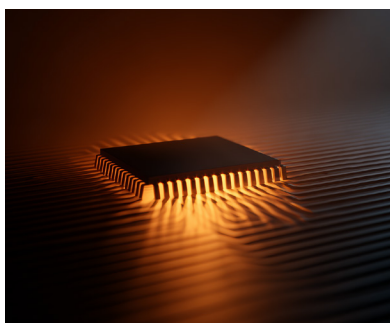

# 03.

Designed for Edge  
Intelligence, Buffering,  
and Fail-Safety

---

ONE.CORE Multiband

---

## Core.CPU

240 MHz Dual Core CPU

ADC voltage monitoring (battery)

520 KB SRAM, 4MB flash

Secure boot with flash encryption

Hardware encryption (AES, RSA, ECC, HASH)

Ultra low power consumption

---

## Core.WiFi

WPA2 Enterprise (EAP-TLS, EAP-TTLS, EAP-PEAP, EAP-FAST)

IEEE 802.11 b/g/n, up to 150 Mbps

X.509 certifications (4096-bit)

Firmware upgrade via Over-the-Air Update (OTA)

---

Core.LoRaWAN  
(optional)

CN470/IN865/EU868/RU864/US915/AU915/KR920/AS923-1&amp;2&amp;3&amp;4

FSK, GFSK, MSK, GMSK, LoRaTM and OOK Modulation

127 dB Dynamic Range RSSI

Over the Air Activation (OTAA)

Activation by Personalization  
(ABP)Advanced Encryption  
Standard (AES)

-144 dBm sensitivity

IEEE802.15.4g

---

Core.BLE  
(optional Core.PDI)

Compliant with Bluetooth v4.2 BR/EDR and Bluetooth LE specifications

NZIF receiver with -94 dBm Bluetooth LE sensitivity

Adaptive Frequency Hopping (AFH)

Bluetooth 4.2 BR/EDR and Bluetooth LE dual mode controller

Multi-connections in Classic Bluetooth and Bluetooth LE

Simultaneous advertising and scanning

---