

One Label. *Two Conversations*

SMAVOO

7.5" Double Label





Description

The SMAVOO 7.5 Double Label is an innovative electronic labeling solution designed for large load carriers. Its dual-display design allows for independent configuration, displaying different data on each side, such as production and logistics information. This ensures seamless communication between

departments, reducing miscommunication and improving efficiency. The label can be wirelessly woken from sleep mode for updates without manual interaction. Additionally, its hybrid communication options (WiFi & LoRaWAN) provide flexible connectivity for various industrial environments.

Key Features

- | | |
|---|--|
| 01. Dual-Sided Display.
Unified Flow. | 03. Durable, Lightweight,
Customizable Display Design |
| 02. Ultra-Efficient,
Paperless Clarity | 04. Built-In OneCore Connector
for New Features |

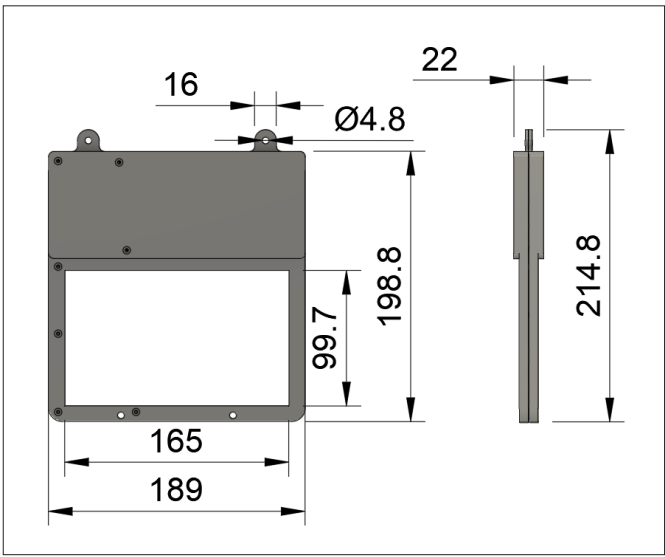

Enclosure	Dimensions	214,8 mm x 189 mm x 22 mm
	Material & Color	ABS, black
	Installation	Mounting via hanging tabs
Power Management	Power Supply	2x AA batteries
	Lifetime	Up to 4 years with one refresh per day
Temperature Regulations	Operating Temperature	0 °C to +40 °C
	Ingress Protection (IP)	IP40
Quality & Compliance	Certifications	CE
	Warranty	24 months
Device Functionality	Display	Dual-sided 7.5" e-paper displays
	External Connector	Service interface

Use-Cases

Goods Receipt



The SMAVOO 7.5" Double Label is a large dual-sided e-paper display for pallets, crates and roll cages. Attached at goods receipt, it turns an inbound pallet into a smart load carrier. One side shows receiving data such as contents, supplier, weight and arrival date, while the other shows put-away or cross-dock instructions. This ensures visibility from any angle and eliminates paperwork. Receivers can verify SKU counts and lot numbers at a glance, from the ERP/WMS. Data updates in real time—if the destination changes, the label updates instantly. Synced, it acts as a live manifest, reducing manual transcription, speeding up receiving and preventing misrouting. The pallet carries its identity and status end-to-end at every step.

Warehouse



In storage and internal logistics, the SMAVOO 7.5" Double Label keeps pallet information readable across large areas. Mounted on loads in high racks, its big e-paper text is legible from the floor, showing item, quantity and location. When a pallet is moved, allocated, or repurposed for a new SKU, the label updates automatically—no relabeling. With screens on both sides, one can face the aisle while the other faces forklift drivers, so data stays visible even when pallets rotate. Each side can show different views for teams, such as storage rules or production notes. High-contrast e-ink performs like paper in glare or low light, reducing mis-picks and keeping a paperless warehouse in sync. It also speeds cycle counts and audits.

Production



Where production and logistics intersect, the 7.5" Double Label aligns both worlds on the same load carrier. One side faces the line with work-order, batch and sequence info; the other faces logistics with transport, staging or storage instructions. This role-specific visibility removes manual relabeling and prevents handover mistakes. As work progresses, the label updates live—showing unit counts, QA holds, and release status—so nothing ships early and nothing waits on emails. The large format supports clear text plus barcodes or QR codes scannable at distance. Result: tighter coordination, fewer delays, and a shared, up-to-date truth on every pallet. When a batch completes, both sides can switch to outbound mode automatically.

Frequently Asked Questions

What makes the dual-sided display more effective than single-sided labels for large load carriers?

The dual-sided design ensures information is always visible regardless of pallet orientation. One side can display warehouse logistics data while the other shows production or shipping information, eliminating the need to turn pallets for reading or use multiple labels. This is especially valuable in tight warehouse aisles where accessing only one side of a pallet is common.

How does the 7.5" screen size improve readability in warehouse environments?

The large 7.5" display is easily readable from ground level, even when mounted on pallets stored high in racks. This significantly improves safety by eliminating the need for workers to climb or use equipment to read small labels. The high-contrast e-paper technology maintains clarity in both bright lighting and low-light warehouse conditions.

Can each side of the label display completely different information simultaneously?

Yes! Each side operates independently, allowing customized content for different departments or processes. For example, the warehouse side might show inventory details and storage locations, while the production side displays work orders and assembly instructions. This targeted communication reduces confusion and improves departmental efficiency.

How quickly can the label update when pallet contents or destinations change?

The label updates in approximately 3 seconds when information changes. This rapid refresh ensures that as pallets move through your facility—from receiving to storage to production—the displayed information remains current without manual intervention. Updates happen automatically through your WMS or ERP system integration.

Can the label integrate with our existing warehouse management and ERP systems?

Absolutely! The label supports both WiFi and LoRaWAN connectivity, allowing seamless integration with most WMS and ERP platforms. Remote firmware updates and over-the-air configuration mean you can deploy these labels without complex on-site programming. Our integration team ensures compatibility with your specific systems.

How does the hybrid connectivity (WiFi/LoRaWAN) ensure continuous operation?

The dual connectivity provides automatic failover between WiFi and LoRaWAN networks. If WiFi coverage is spotty in certain warehouse areas, the label seamlessly switches to LoRaWAN for reliable long-range communication. This ensures continuous updates regardless of your facility's infrastructure limitations.



ONE.CORE *Function*

SMAVOO ONE.CORE is the heart of the SMAVOO ecosystem — a fully modular sensor platform designed specifically for demanding industrial environments. Unlike conventional IoT devices with fixed feature sets, ONE.CORE adapts precisely to your requirements through interchangeable communication modules, configurable sensor interfaces, and edge-computing

capabilities. Born out of frustration with proprietary systems that lock companies into inflexible technologies, ONE.CORE is built on open standards and a future-proof design. Start with exactly what you need today and expand the platform seamlessly as your business grows and evolves naturally — all without having to replace your hardware investment.

ONE.CORE *Key Features*

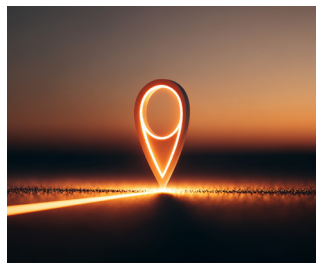

01.

Modular Communication:
WiFi, LoRaWAN, Bluetooth
Low Energy (BLE)

02.

Plug-and-Play Interface for
Sensors (RFID, Barcode,
Environment, Movement)

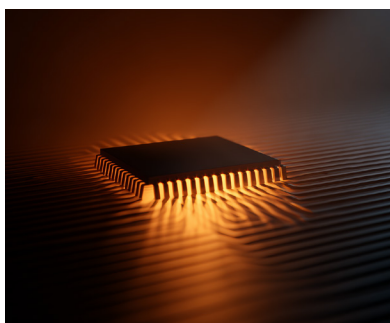

03.

Designed for Edge
Intelligence, Buffering,
and Fail-Safety

ONE.CORE *Multiband*

Core.CPU	240 MHz Dual Core CPU	ADC voltage monitoring (battery)
	520 KB SRAM, 4MB flash	Secure boot with flash encryption
	Hardware encryption (AES, RSA, ECC, HASH)	
	Ultra low power consumption	

Core.WiFi	WPA2 Enterprise (EAP-TLS, EAP-TTLS, EAP-PEAP, EAP-FAST)
	IEEE 802.11 b/g/n, up to 150 Mbps
	X.509 certifications (4096-bit)
	Firmware upgrade via Over-the-Air Update (OTA)

Core.LoRaWAN (optional)	CN470/IN865/EU868/RU864/US915/AU915/KR920/AS923-1&2&3&4	
	FSK, GFSK, MSK, GMSK, LoRaTM and OOK Modulation	
	127 dB Dynamic Range RSSI	Over the Air Activation (OTAA)
	Activation by Personalization (ABP)	Advanced Encryption Standard (AES)
	-144 dBm sensitivity	IEEE802.15.4g

Core.BLE (optional Core.PDI)	Compliant with Bluetooth v4.2 BR/EDR and Bluetooth LE specifications	
	NZIF receiver with -94 dBm Bluetooth LE sensitivity	
	Adaptive Frequency Hopping (AFH)	
	Bluetooth 4.2 BR/EDR and Bluetooth LE dual mode controller	
	Multi-connections in Classic Bluetooth and Bluetooth LE	
	Simultaneous advertising and scanning	

SMAVOO *Solutions*

Hybrid Tracking



Hybrid indoor and outdoor tracking means none of your assets go AWOL on our watch. Our smart trackers give you a real-time overview over your assets, and

seamlessly move from outdoor to indoor. Our RFID solutions make sure you always know what's there - even with tricky interferences or metal parts.

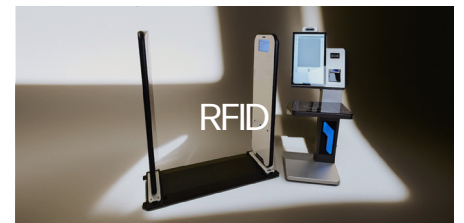

Smart Picking



Smart picking guides your workers from A to B - and our solutions are there to make sure every pick is the right one. From saving paper by replacing picklists with

our EPD Tablets, handsfree Barcode-Scanners or our range of smart labels for KLTs and GLTs - we're always there to make sure the process flows just as intended.

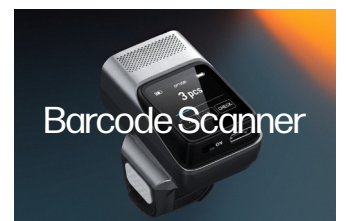

Smart Reordering & eKanban

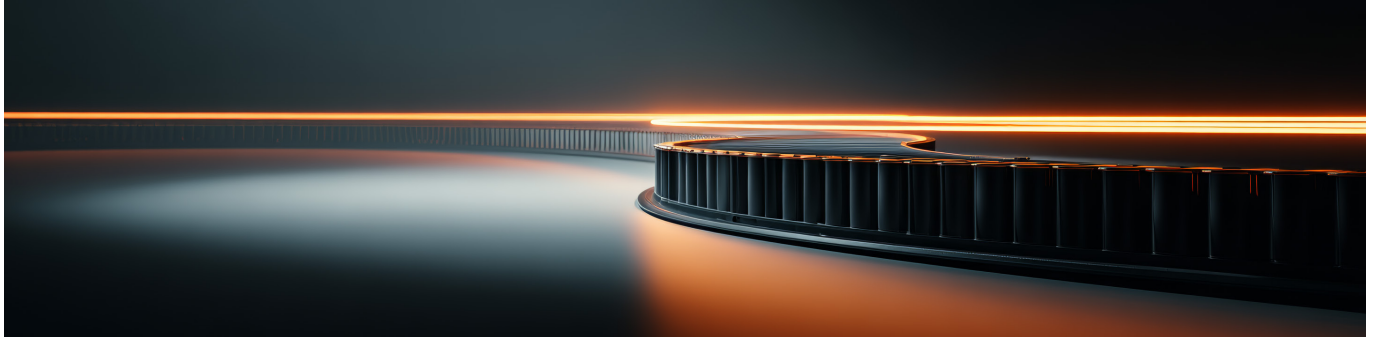

With our range of automatic and semi-automatic line feeding solutions, we make sure your line never stops. From Distance Sensors to Switches and Scales

that detect when material levels are below a certain threshold to Order Cords and Reorder-Buttons: We make sure everything arrives on time, every time.

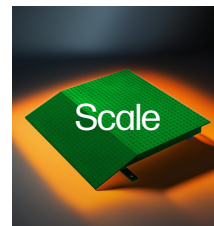
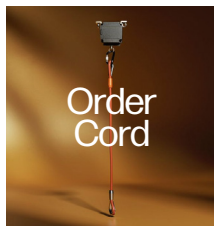

AGV/AMR Sensors



Our range of AGV/AMR sensors make sure your indoor transport is always perfectly coordinated and safe. With light-guided systems, AGV Buzzers and Smart

Barriers, your existing fleet always finds its way through your warehouse - and if you're still looking for an AGV fleet, we've got you covered with our models as well.

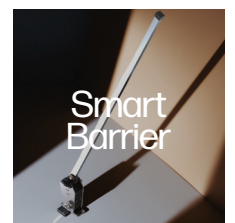
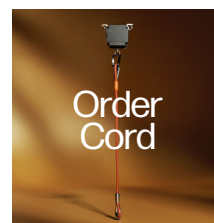

About SMAVOO

At SMAVOO, we believe in all-in-one-solutions: Hardware, Software & Service. We specialize in Industrial IoT (IIoT) solutions for production and logistics. Our expertise spans RFID technology, sensor networks, and software development with the goal

of creating modular systems that make operations efficient, transparent, and error-free. Our customized solutions help companies digitalize their processes and make smarter decisions through real-time tracking across all modern workflows.

Material Flow

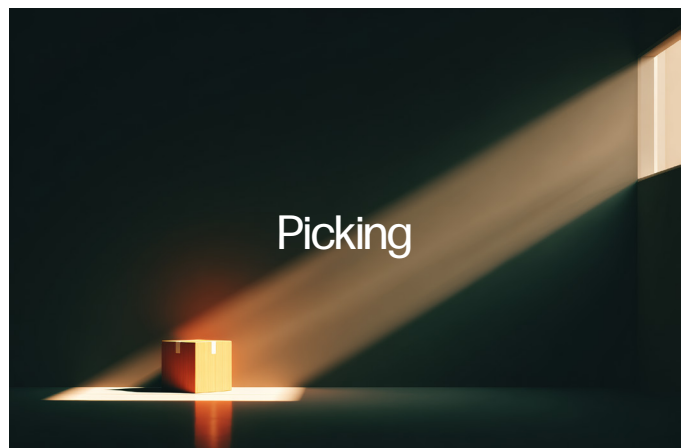
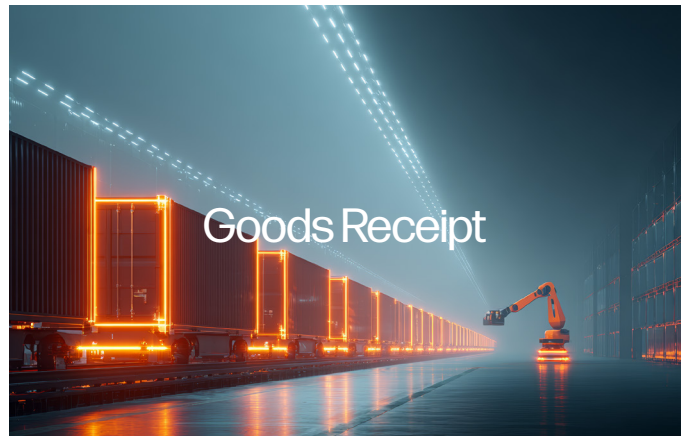

We're not here to bulldoze your workflow: Keep what works, ditch what doesn't. We plug in, make it smarter, and let you scale or pivot without rewriting your playbook. And because we're logistics people too, we know the pain of endless integration projects. We've

been there, done that, and built something better: Fast rollouts, real support, and partnerships that don't vanish after go-live. Our track record? Industry leaders trust us to keep them ahead - because we deliver the goods, not just the sales pitch.

Smart, Seamless and Scalable. Or *Simply SMAVVO*.



Contact Us

Excited about the future? So are we, and we look forward to optimizing your processes together. Whether you're interested in a demo setup or just a casual introduction, you can reach us here.

General Enquiries

sales@smavoo.com
smavoo.com

Dr. Rouven-B. Wiegand

Managing Director
Phone: +49 511 515614 08