



**TOUGH, SLIP-RESISTANT  
OUTDOOR FLOORING**

# DECKING



Build your dream outdoor spaces with Proal's durable, slip-resistant HPL decking.

Featuring

**ABET LAMINATI**



X

E

D

N

I

WHY HPL.....	PAGE 4
PROJECTS.....	PAGE 5
TECHNICAL DRAWINGS.....	PAGE 32

# WHY HPL FOR DECKING

## WEATHER RESISTANCE

HPL excels outdoors, resisting rain, UV rays, and temperature changes, ensuring durability and aesthetics.

## LOW MAINTENANCE

Easy cleaning and minimal upkeep, plus stain resistance, suits busy urban areas for practicality and cleanliness.

## DURABILITY

HPL's durability and resistance make it a long-lasting option, offering protection against wear and tear.

## EASE OF INSTALLATION

Lightweight HPL eases handling and installation, saving time and costs for a swift installation process in construction.



# ELEGANT DECKING FOR A PENTHOUSE ROOFTOP

| LOCATION

LEBANON

| YEAR

2023

| INDUSTRY

RESIDENTIAL













# SERENE POOLSIDE DECKING

LOCATION  
LEDARON

YEAR  
2025

INDUSTRY  
RESIDENTIAL

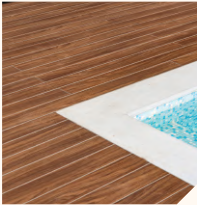

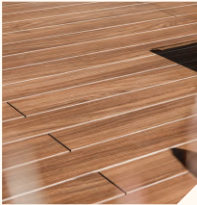





# ELEGANT DECKING FOR A VILLA

LOCATION

Legnano

YEAR

2021

INDUSTRY

RESIDENTIAL

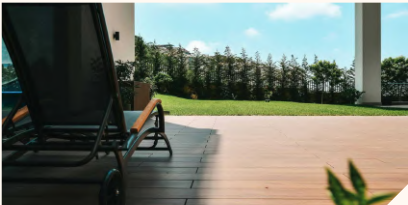











# ELEVATED POOLSIDE WITH WOOD DECKING

LOCATION

DUBAI

YEAR

2024

INDUSTRY

RESIDENTIAL

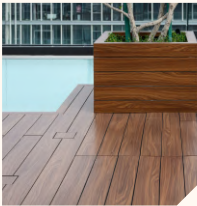
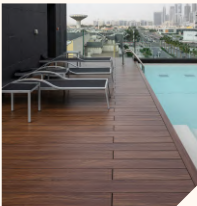

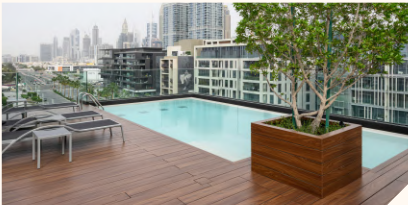

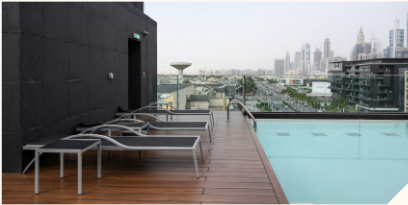

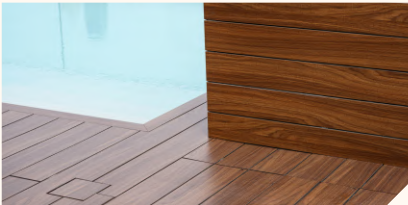



# TIMELESS WOOD DECKING BY THE POOL

LOCATION

DUBAI

YEAR

2024

INDUSTRY

RESIDENTIAL









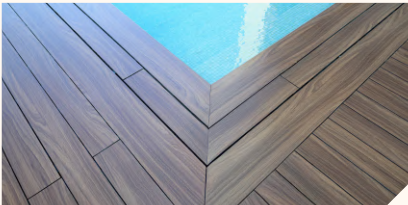







# TECHNICAL DRAWINGS

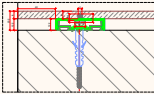
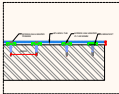





[www.proal.me](http://www.proal.me)