

# Specification Guide

# tumbled

## Sealing of pool coping

### Limestone, Sandstone & Concrete

CODE	AREA	SURFACE DESCRIPTION	PRESEAL	FINAL SEAL	PROCESS
APC1	Pool Coping	<b>Natural Stone Paving</b> Limestone, Sandstone & Concrete are most sensitive to salt attack.	Defender CSD Pure (AP675) Actichem	Stone Sealer Gold (AP177) Water-based or Solv Sealer Gold (AP176) Solvent Based Actichem 15 year warranty	Coping stone should be clean, dry and dust free prior to sealing. Seal all six sides of the stone with Defender CSD Pure. For coping pieces larger than 400mm in any direction, the sealer can be applied by spray, roller or brush. For smaller pieces, the stone can be dipped into a bath of Defender CSD Pure. Allow Defender CSD Pure 3 days minimum to cure. Complete the installation and grouting of the coping stone. Allow sufficient time for the adhesive and grout to cure. See manufacturers guides. Complete 2 applications of either Stone Sealer Gold or Solv Sealer Gold. Keep dry for 12 hours to allow full cure.

### All other natural stone & terracotta

CODE	AREA	SURFACE DESCRIPTION	PRESEAL	FINAL SEAL	PROCESS
APC2	Pool Coping	<b>Natural Stone Paving</b> All other natural stone and terracotta including; Granite, Marble, Cotto etc.	PreSeal (AP171) Actichem	Stone Sealer Gold (AP177) Water-based or Solv Sealer Gold (AP176) Solvent Based Actichem 15 year warranty	Coping stone should be clean, dry and dust free prior to sealing. Seal all six sides of the stone with PreSeal. For coping pieces larger than 400mm in any direction, the sealer can be applied by spray, roller or brush. For smaller pieces, the stone can be dipped into a bath of PreSeal. Allow PreSeal 6-12 hours to cure. Complete the installation and grouting of the coping stone. Allow sufficient time for the adhesive and grout to cure. See manufacturers guides. Complete 2 applications of either Stone Sealer Gold or Solv Sealer Gold. Keep dry for 12 hours to allow full cure.

CODE	ADHESIVES	SILICONE/CAULKING	GROUT
APC3	Laticrete 335 Adhesive Laticrete 254 Adhesive Latapoxy 310 Stone Adhesive Mapei Keraflex Maxi S1 Davco SMP Evo	Maxisil N Mapei - Mepesil LM Ardex ST Laticrete - Latasil	Ardex Laticrete Spectralock Pro Laticrete Permacolor NS Kerakoll Fugabella Grout Mapei Kerapoxy Mapei Keracolor
The recommendations above are given as a guide and should not replace advice given by the manufacturers.			

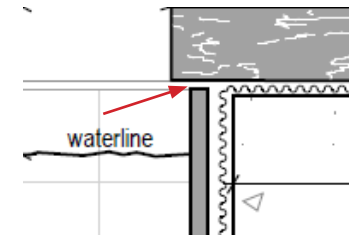

Only use:  
Stone safe silicone above waterline tile.