

MRQ+ Documentation

Movie Render Queue+ window can be opened via the [editor toolbar](#) button or [window menu](#).

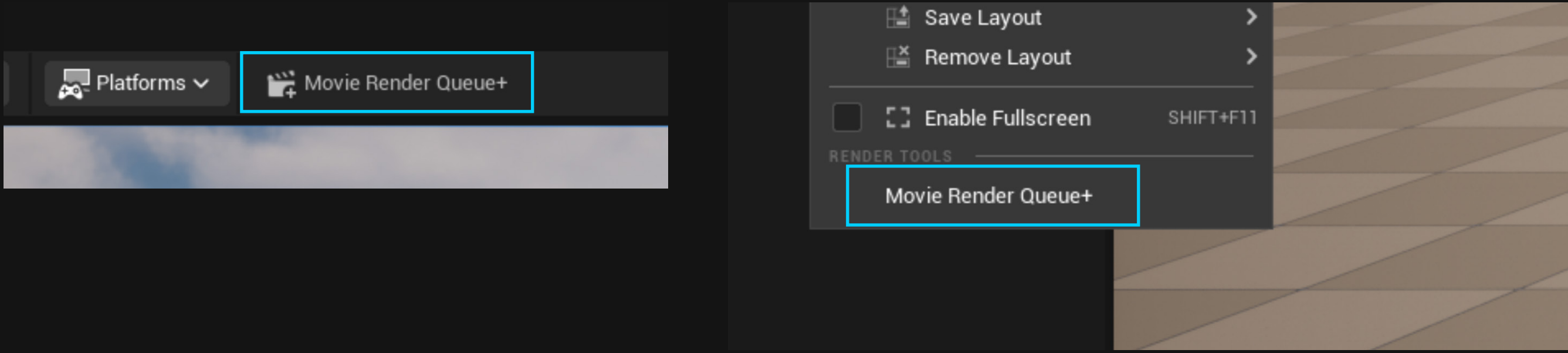

Once the Movie Render Queue+ window is opened, select the [level sequence](#) that you want to render as part of Movie Render Queue.

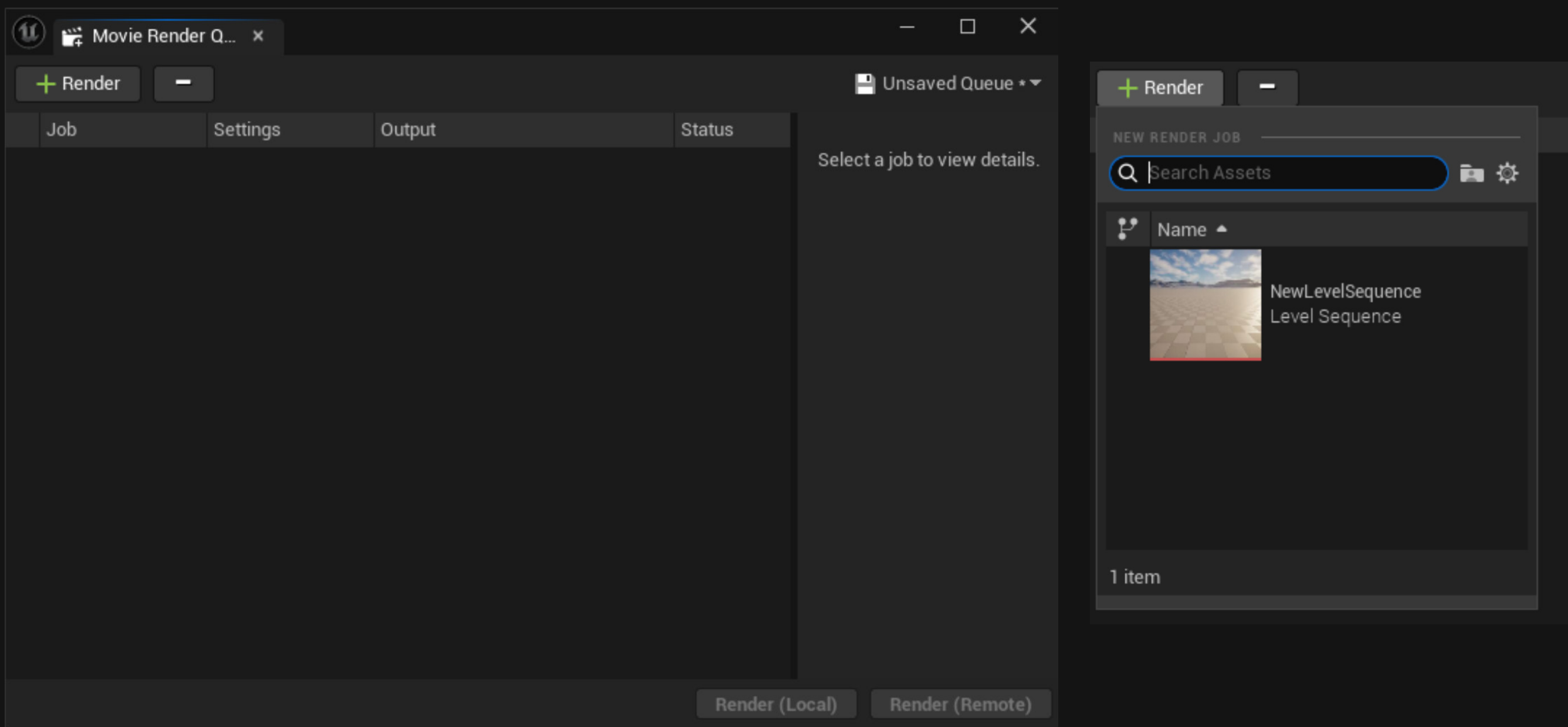

Movie Render Queue provides a [Job Output Config](#) right within the window for easy access.

Or if you want to override a setting for the entire queue, you can select the [Queue Output Overrides](#) tab.

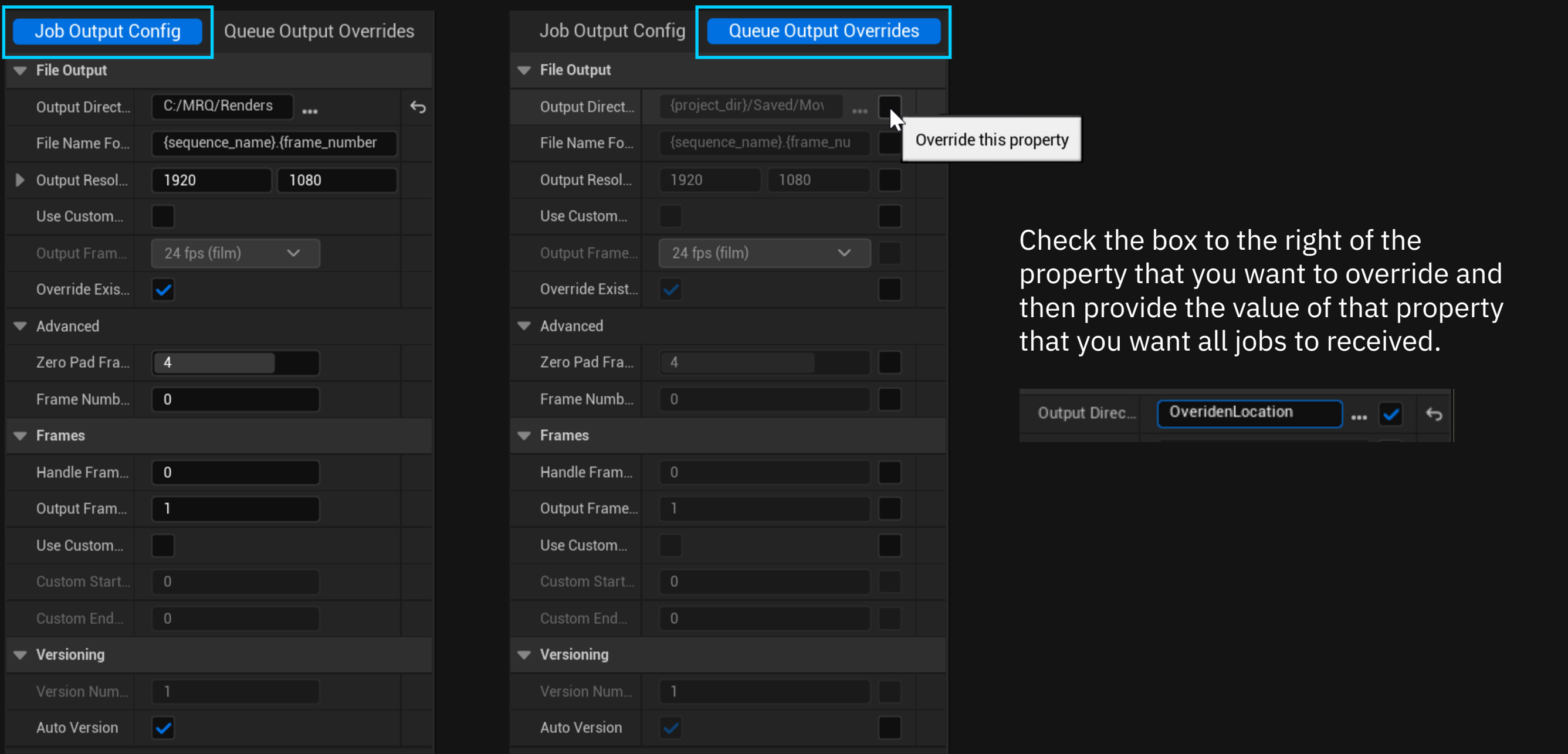

Check the box to the right of the property that you want to override and then provide the value of that property that you want all jobs to received.