

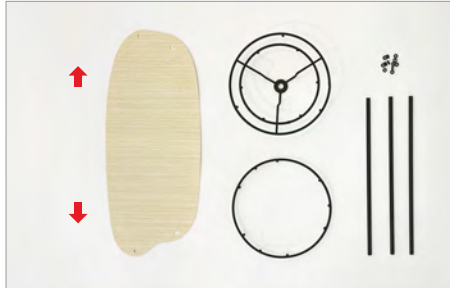

ALBA 40

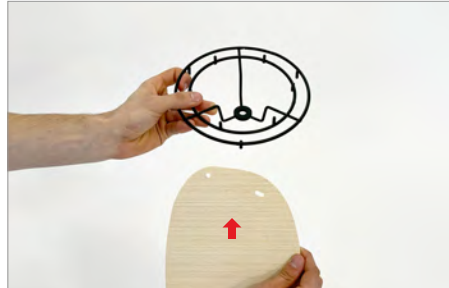

1.



2. Insert the wooden part in the indicated direction.



3. Fit the holes in the top ring.



4. Insert the next piece from above.

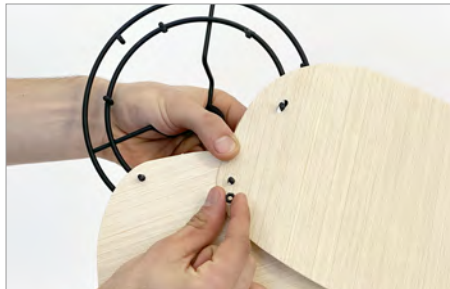

5. Place a NUT.



6. Repeat previous steps.

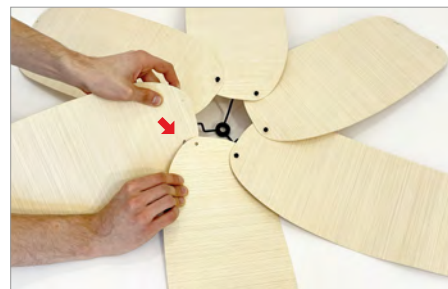

7. Insert the last piece underneath the first one.

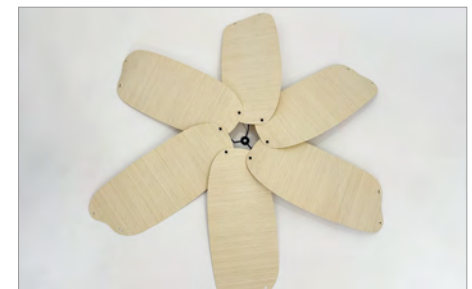

8. Place a NUT.

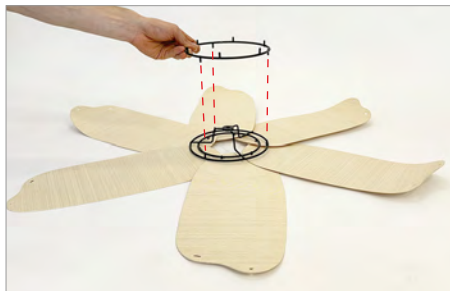

9. Flip the pieces over and grab the bottom ring, aligning the three metal tips facing down.

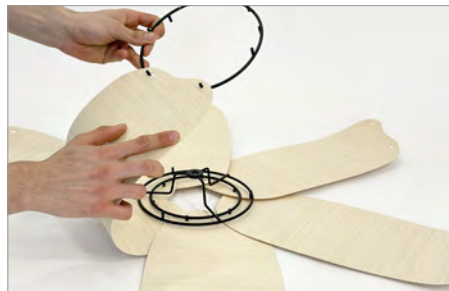

10. Bend the piece and insert it onto the ring.



11. Insert the next piece and place a nut.



12. Repeat previous steps.

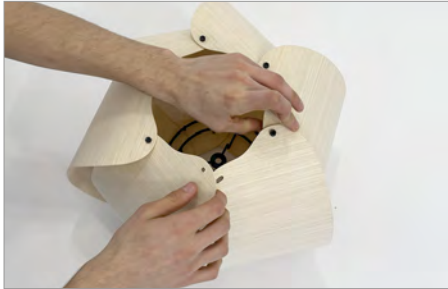

13. Insert the last piece underneath the first one.

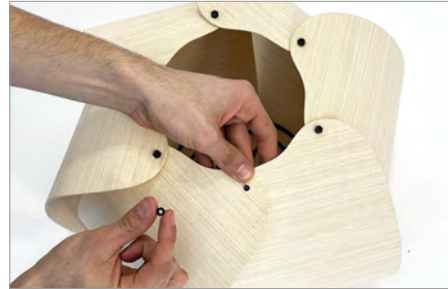

14. Place a NUT.

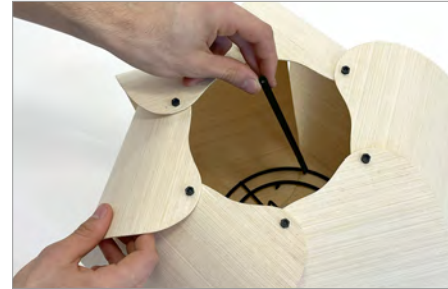

15. Grab the rod and insert it into the metal tip at the bottom.



16. Insert the same rod it into the upper metal tip.



17. Repeat previous steps.



18.

PARTS

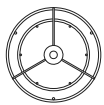

x 1



x 1

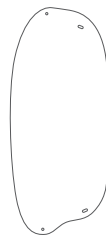

x 6



x 3



Nuts
x 12

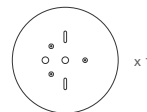

x 1



x 1



x 1



x 2



x 1

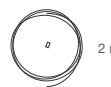

2 m

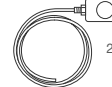

2 m

MEASURES

D 40 cm / 15.7 in

H 33 cm / 13 in

BULB 100 w max.



This product requires professional installation.
Please contact a certificate electrician.