

# CLARISSA MODULO

## C 140

WEPLIGHT  
^ A R G E N T I N A

© 2014 Weplight S.A. All right reserved.

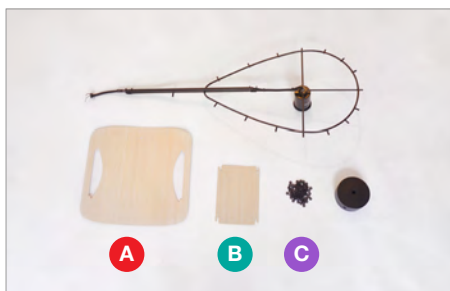

1. Verify all parts.

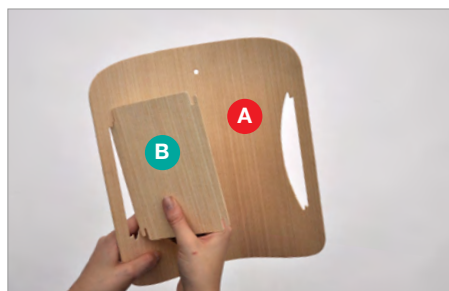

2. Insert B on top back of A. Verify hole on top.



3. Insert B down forward of A.



4. Push top side forward.

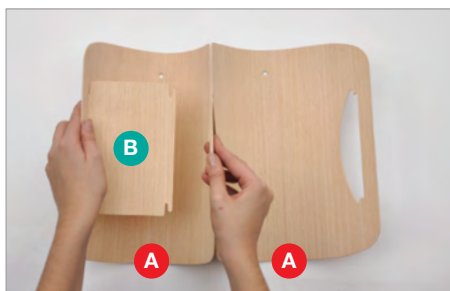

5. Insert B in both A simultaneously.



6. Insert B on top back.



7.



8. Insert B down forward.

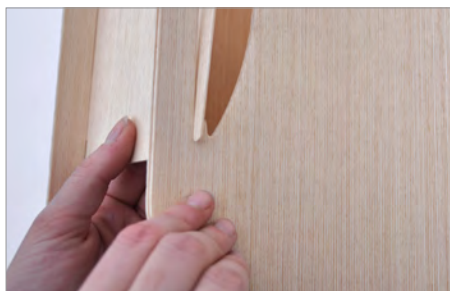

9. Verify that all corners of B are installed forward.



10. Repeat previous steps.  
Always assemble next part behind previous part.



11.



12.



13.



14.



15.



16.



17. Insert rubber washers.

x 3

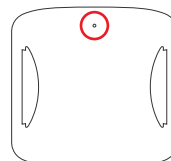

**A** One top Hole  
x 54



**B** x 54



**C** Rubber Washers



x 1

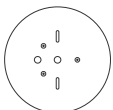

x 1



x 1



x 1



x 1



x 2



x 3



X 4



X



2

L 140 cm / 55.1 in

L 140 cm / 55.1 in

H 28 cm / 11 in

BULB 100 w max. (3)



This product requires professional installation.  
Please contact a certificate electrician.