

- NOTES:
- THIS DRAWING APPLIES TO THE PEDALS OF THE 10468 PRODUCT LINE THAT ARE SET AT A 25 DEGREE RESTING ANGLE, HAVE AN AUXILIARY STOP INSTALLED, AND USE A HALL EFFECT SENSOR.
 - SENSOR ELECTRICAL SPECIFICATIONS:
 - RECOMMENDED SUPPLY VOLTAGE: DC 5V ±5%
 - MAX PERMISSIBLE APPLIED VOLTAGE: DC 30V
 - INPUT CURRENT: (PER CHANNEL) 16MA
 - MINIMUM LOAD RESISTANCE: 10KΩ
 - RESOLUTION: 0.088° (12-BIT)
 - ACCURACY: ±0.6% OF ACTIVE ELECTRICAL ANGLE
 - SENSOR ENVIRONMENTAL SPECIFICATIONS:
 - PROTECTION CLASS: IP67
 - TEMPERATURE RANGE: -40°C TO 125°C
 - LIFETIME: >1,000,000 CYCLES

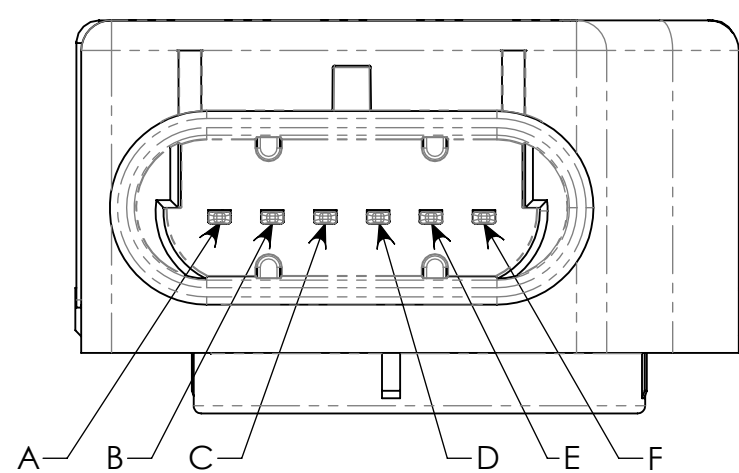

SENSOR PINOUT	
A	OUT1
B	COM1-
C	VCC1 (+5V)
D	VCC2 (+5V)
E	COM2-
F	OUT2

MATING CONNECTOR:
 DELPHI #12162261 HOUSING
 DELPHI #12103881 PINS
 DELPHI #12048086 SEAL

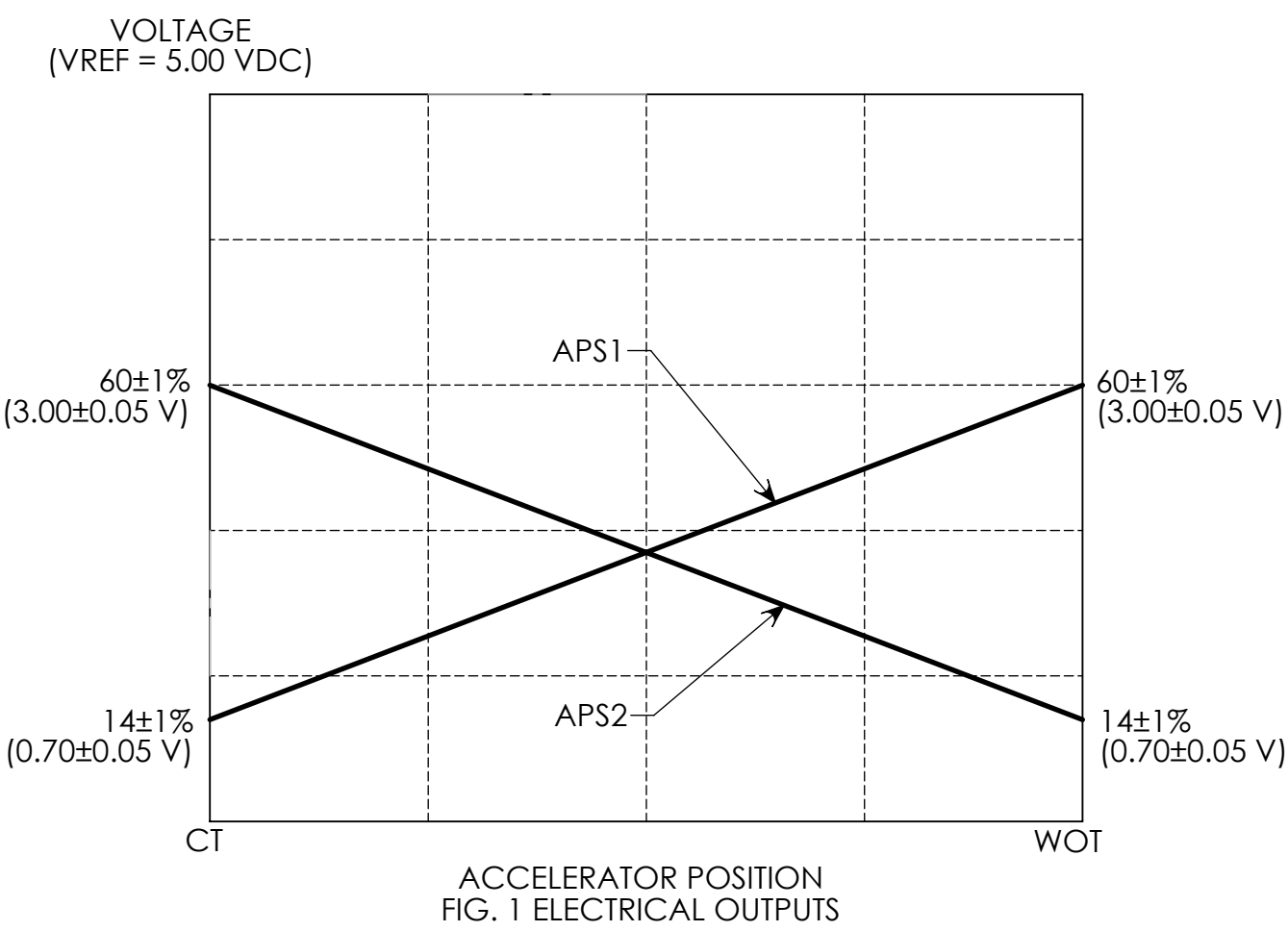
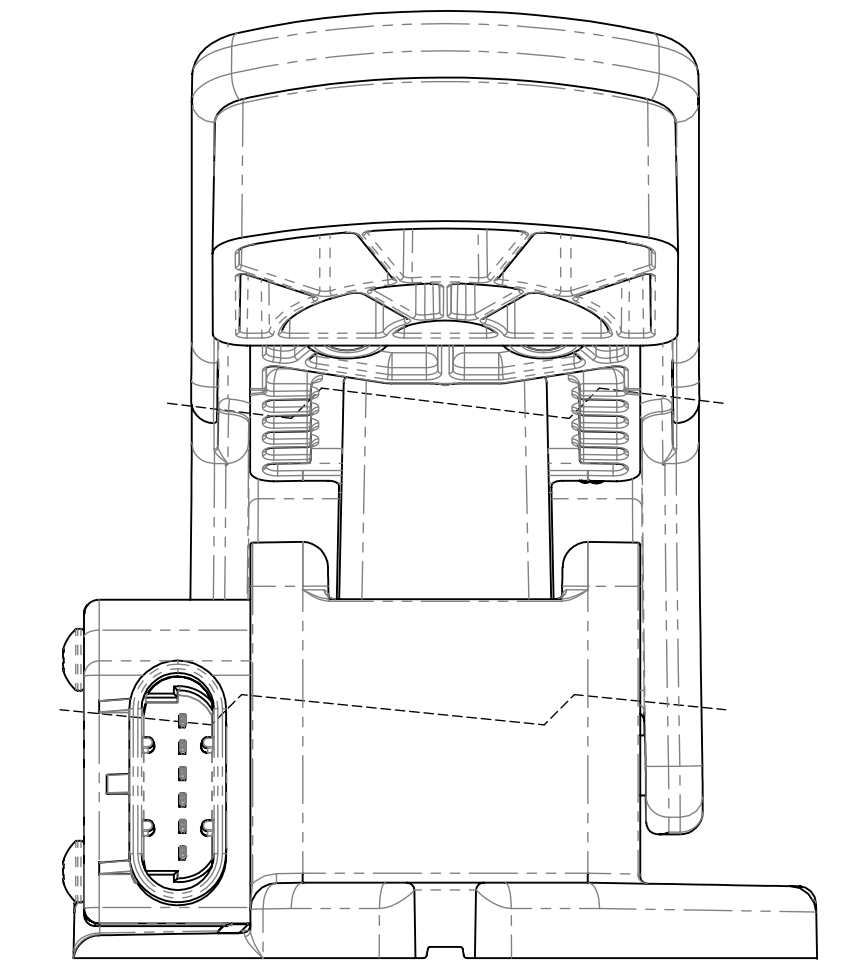
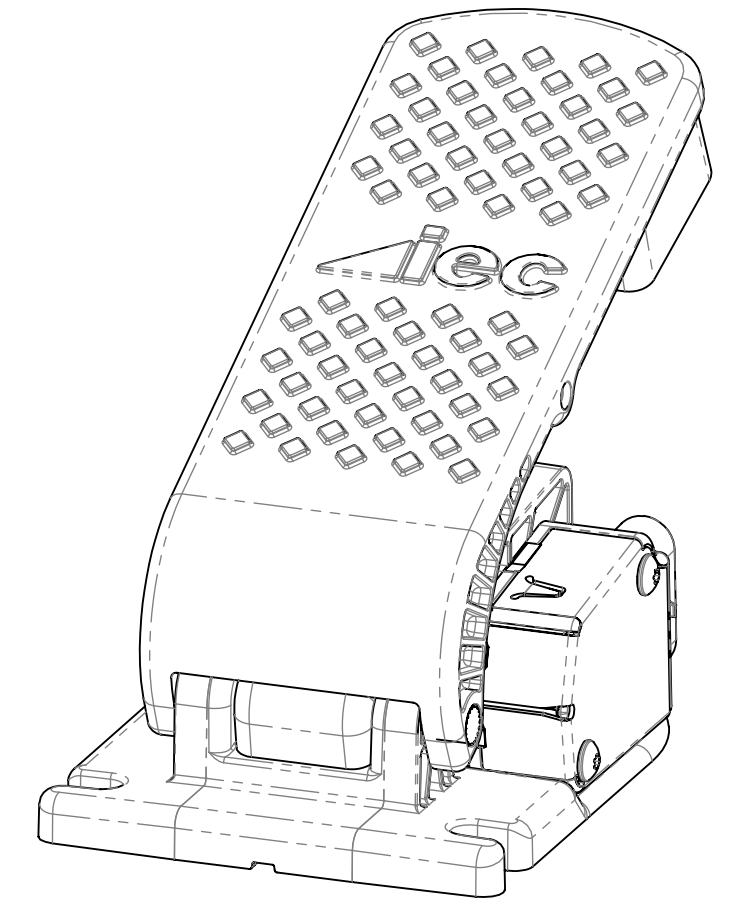
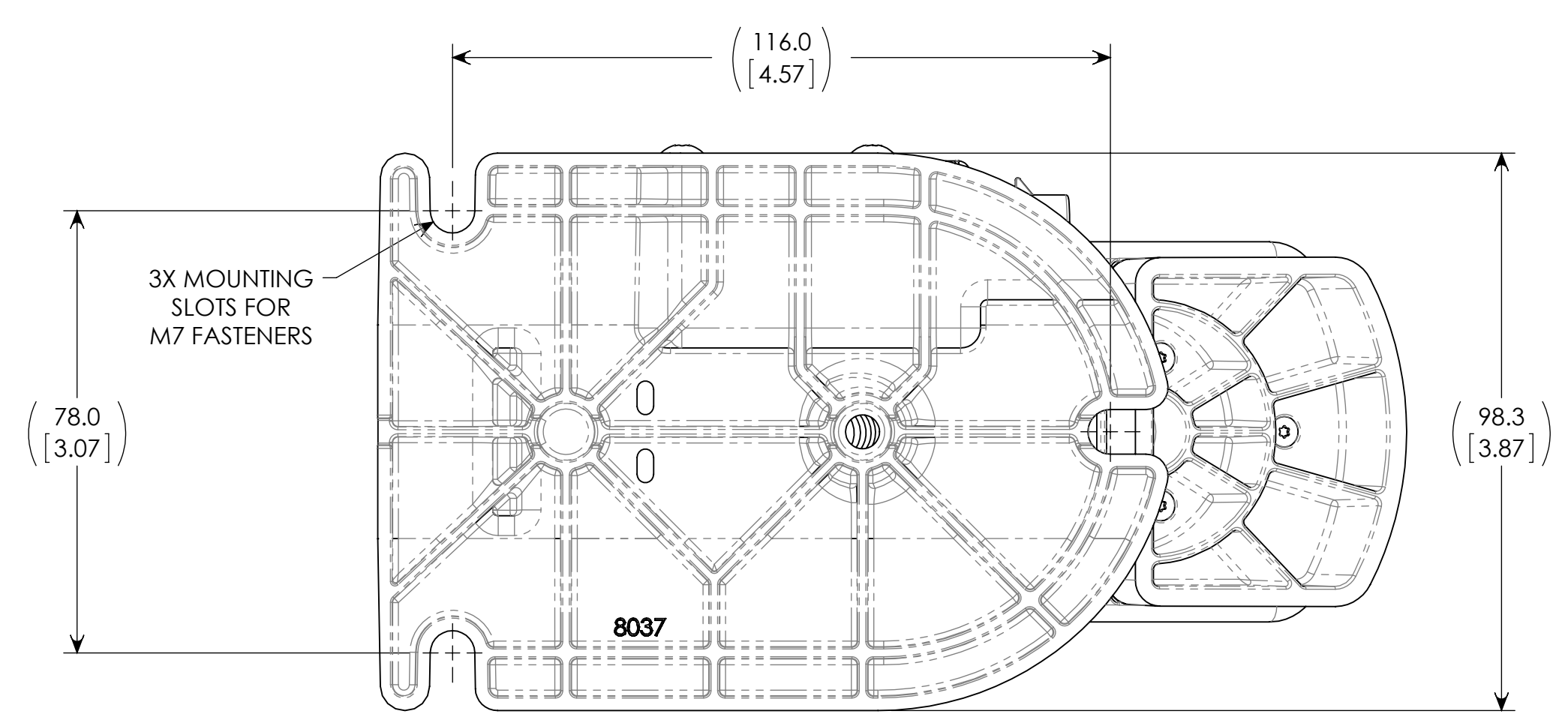
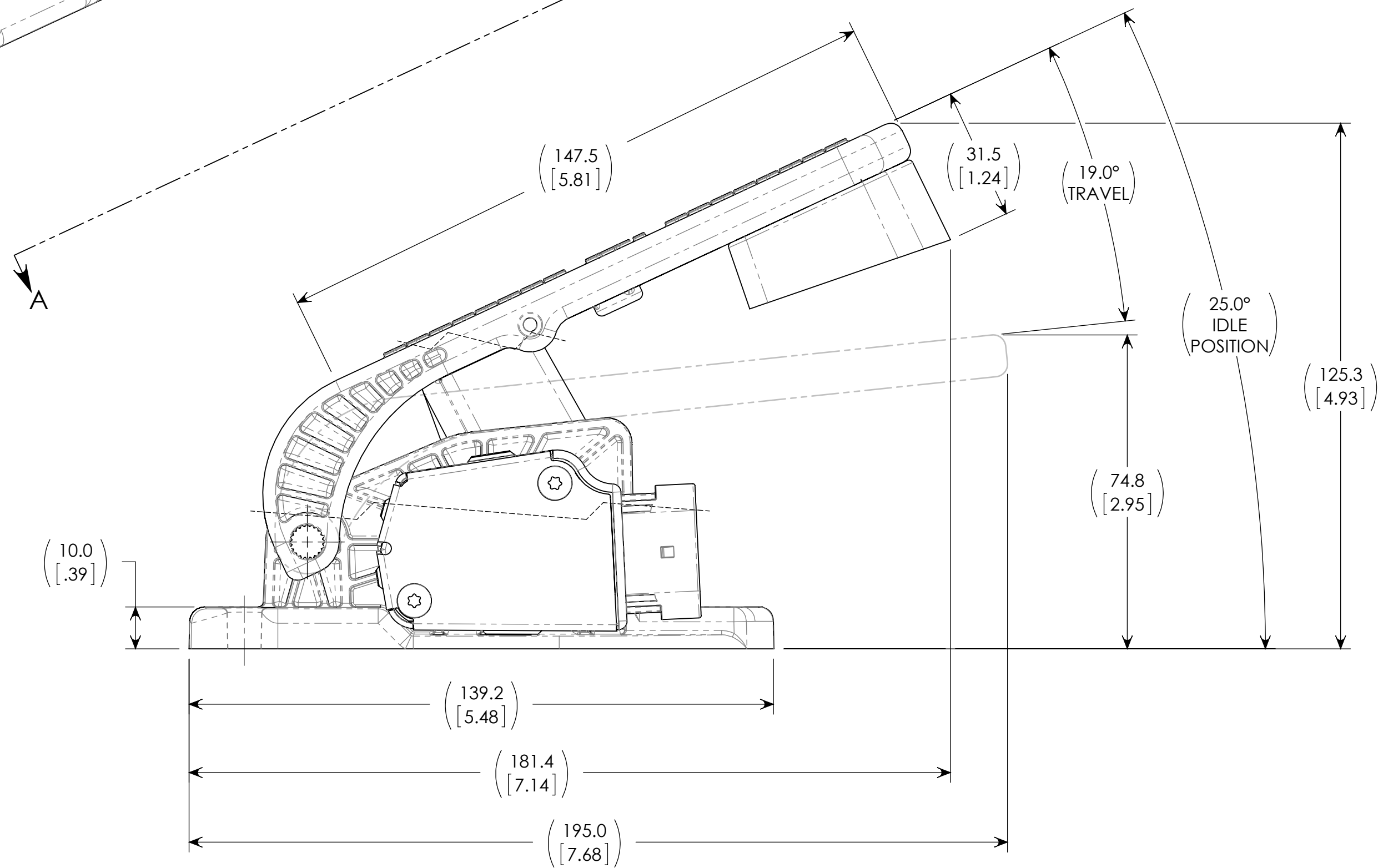
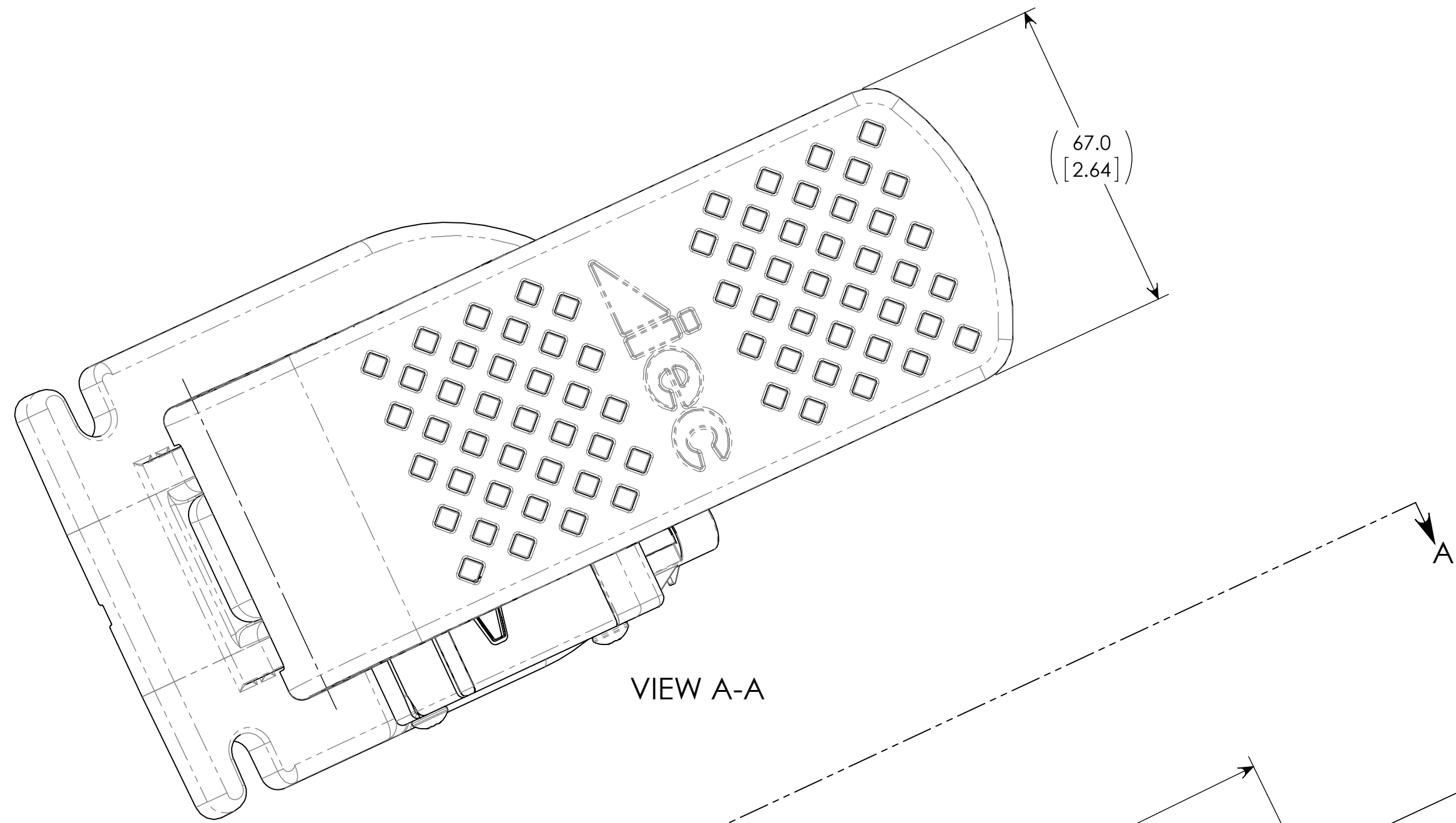

10468-XX-X-X-XXXX

RESTING ANGLE
 25 - 25° RESTING ANGLE
 ** - OTHERS UPON REQUEST

SENSOR OUTPUT
 1460 - 1.4% TO 60%
 * - OTHERS ON REQUEST

STOP OPTION
 0 - NO STOP
 1 - STANDARD STOP
 * - OTHERS ON REQUEST

SENSOR CONFIGURATION
 0 - DUAL ANALOG
 S - SWITCH
 C - DUAL ANALOG CROSS PATTERN
 * - OTHERS ON REQUEST

STANDARD PART #
10468-25-1-C-1460

INITIALS	DATE	UNLESS OTHERWISE SPECIFIED	INDUSTRIAL ELECTRONIC CONTROLS
DRAWN BY	JDK 7/27/17	DIMENSIONS ARE IN METRIC mm	ROCKFORD, IL 61109
CHECKED BY		DUAL DIM [] ARE IN ENGLISH in	
MATERIAL PER BOM		ANGULAR BEND ----- ±°	TITLE
OTHER		ANGULAR BEND ----- ±°	PEDAL ASSEMBLY, 25 DEG HAL SENSOR
FINISH		ZERO PLACE DECIMAL ----- ±-	SIZE
		ONE PLACE DECIMAL ----- ±-	DRAWING #
		TWO PLACE DECIMAL ----- ±-	REVISION
		INTERPRET GEOMETRIC TOLERANCES PER ASME Y14.5	D 10468-25-1-X-XXXX A
		DO NOT SCALE DRAWING	
		SCALE: 1:1	
		SHEET 1 OF 1	