

Contour

BALANCE FULL-SIZE KEYBOARD WIRED

Product manual

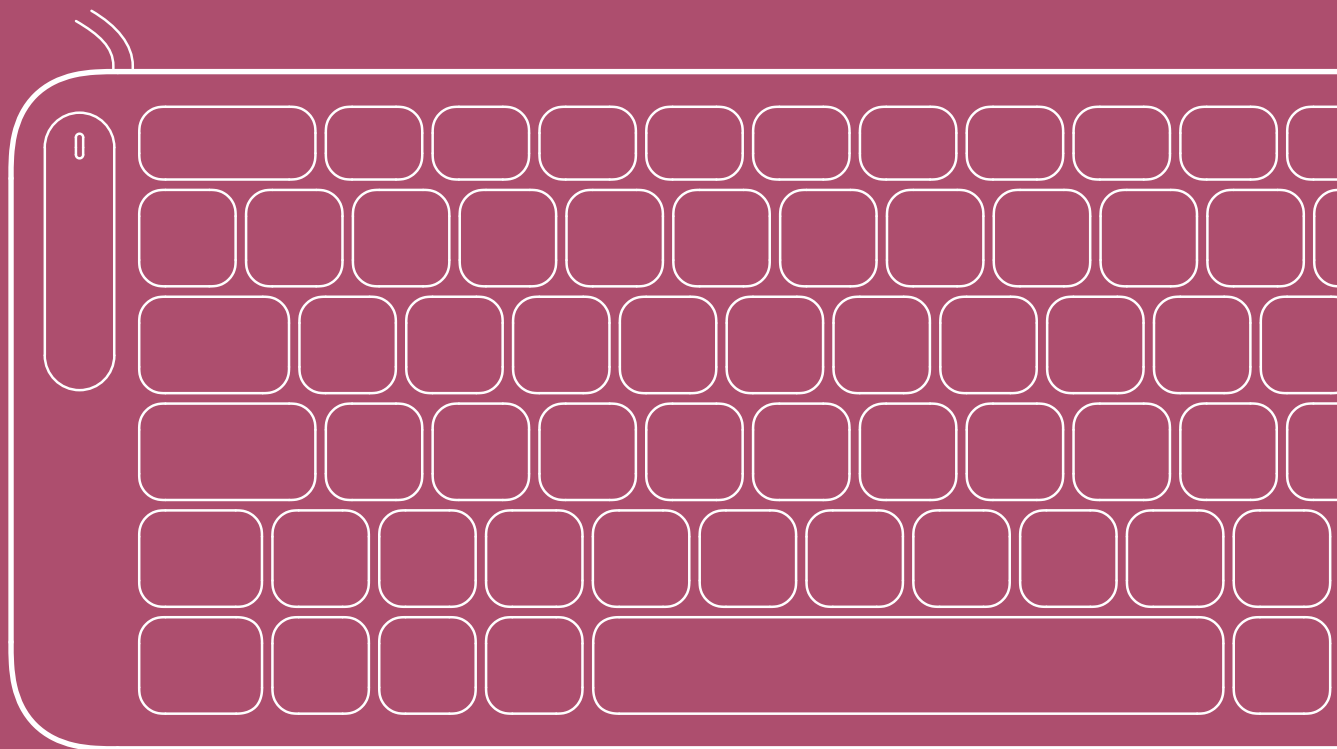

TABLE OF CONTENTS.

What's in the box	1
Meet Balance	1
Get set up for comfort	2
Quick connect guide	2
Tilt options	3
Media keys & customization	5
Function keys	5
Caps lock & num lock	6
Cleaning & maintenance	7
Safety, legal & warranty info	7



WHAT'S IN THE BOX.

You'll find everything you need for a seamless set-up inside the box.

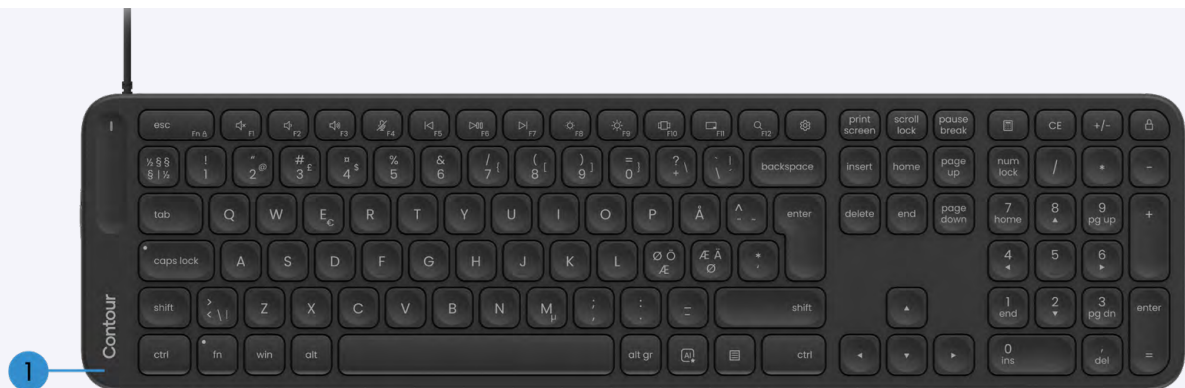

1. Balance Keyboard Wired
2. USB-C to USB-A adaptor

MEET BALANCE.

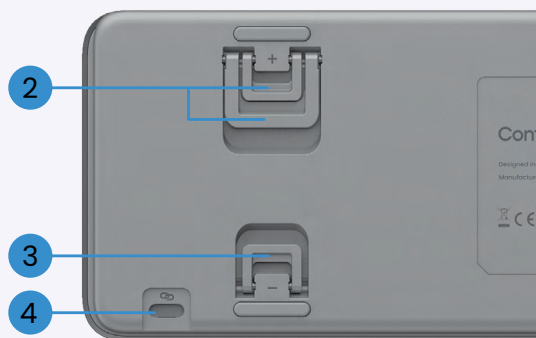

1. Power LED
2. Positive tilt legs
3. Negative tilt legs
4. SnapLink attachments

GET SET UP FOR COMFORT.

Before you start typing, set yourself up for all-day comfort.

Relax your shoulders. Keep your elbows at 90 degrees, close to your body. Your forearms should be parallel to the floor, with wrists in a straight, neutral position.

Whether you're pairing your Balance Keyboard with Contour Touch, your set-up matters.



Contour Touch:

Line up the H key and the centre of the touchpad with your monitor and body

Position the keyboard close to the touchpad, and keep the Contour Touch far enough from the desk edge so your forearms are supported when resting

QUICK CONNECT GUIDE.

If you have the wired version of Balance Keyboard, just plug the USB cable into any available USB port in your PC.

Your computer will connect to the keyboard automatically. No extra steps needed.

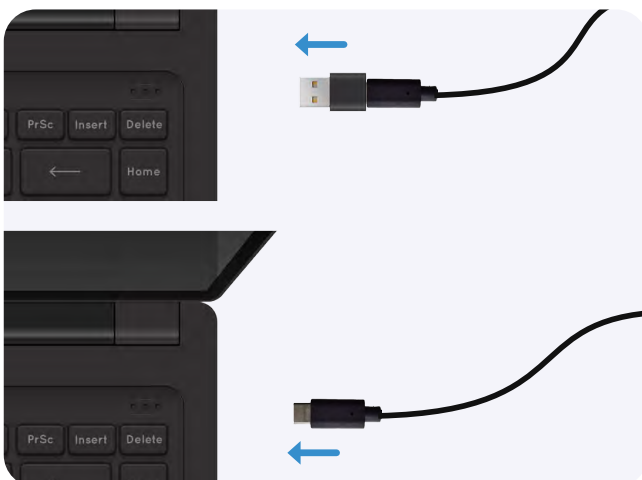

The cable comes with a USB-A adaptor pre-installed

Just slide the adaptor off and plug in the USB-C connector instead

TILT OPTIONS.

Balance Keyboard gives you five tilt options to suit your set-up, posture needs, and personal preference.

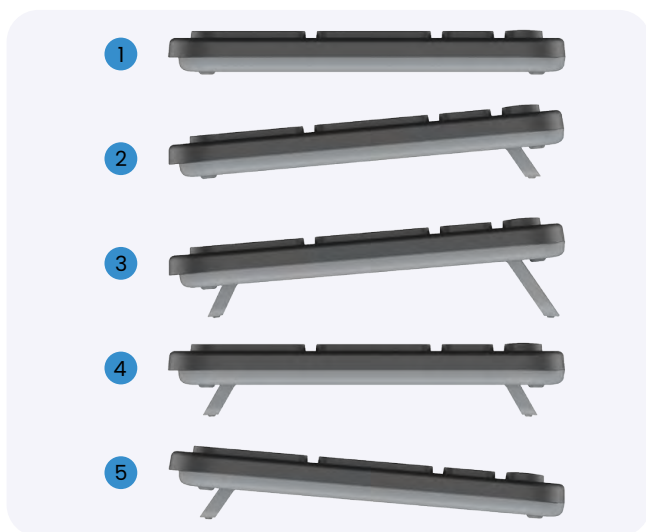

1. **Flat** – for Touch, Balance Wrist Rest and UniMouse (recommended ergonomic option)
2. **Positive tilt** – for Touch, Balance Wrist Rest and UniMouse
3. **Elevated positive tilt** – for RollerMouse or SliderMouse
4. **Elevated** – for RollerMouse or SliderMouse
5. **Negative tilt** – for RollerMouse or SliderMouse (recommended ergonomic option)

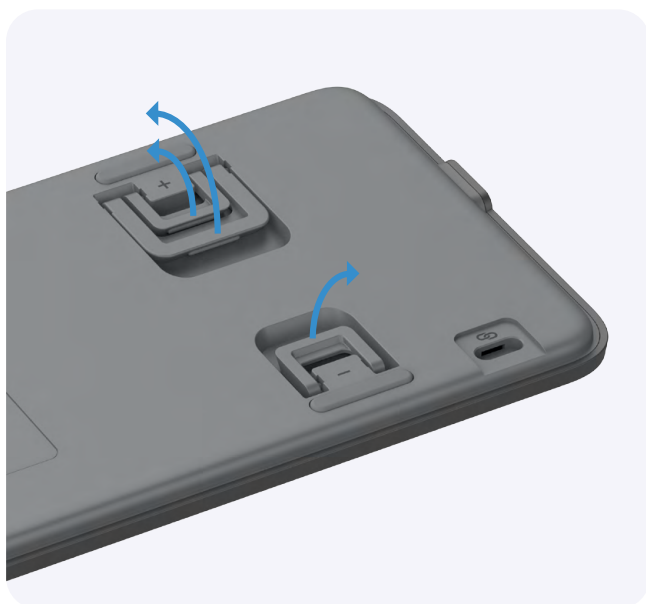

The + and – symbols on the tilt legs show you if you are choosing positive or negative tilt

MEDIA KEYS & CUSTOMISATION.

Your Balance Keyboard comes ready with preset media keys to get you going right away.

Want to make it your own?

Download the Contour software to customise the media keys based on your preferences and unlock the full potential of your keyboard

[Visit cd.now/sw](https://cd.now/sw) to get started

Full-Size media keys



Number	Default assignment
1	Mute/unmute sound
2	Volume down
3	Volume up
4	Mute/unmute microphone
5	Previous track
6	Play/pause
7	Next track
8	Brightness down
9	Brightness up
10	Task view
11	Show desktop
12	Search
13	Open settings
14	Open calculator
15	Clear entry
16	Negative number toggle
17	Lock computer
18	Open Copilot or other AI assistant



FUNCTION KEYS.

Function keys & fn lock

By default, the top row of your keyboard is set for media keys like volume, play/pause, and more. Need traditional F-keys instead? You've got options:



For one-time use:

Hold down the fn key and short press any F-key



To switch modes:

Want to make F-keys the default? Just hold down the fn key and short press the esc key

The fn lock LED will turn on

To switch back to media keys as default, hold down the fn key and short press the esc key again

CAPS LOCK & NUM LOCK.



Caps lock:

Press the key once to turn caps lock on or off, when LED on the key is lit, caps Lock is on



Num lock:

Press the key once to switch your numpad from numbers to navigation - or back again

CLEANING & MAINTENANCE.

Balance Keyboard is designed to be easy to maintain - and yes, it can be safely disinfected.

Follow these steps to clean the product safely and keep your warranty intact:

- Unplug any cables and make sure the device is turned off before cleaning
- Use an alcohol-based solution (up to 70% concentration) for disinfection
- Never apply liquid directly to the keyboard. Instead, lightly dampen a soft, clean cloth with the solution and gently wipe down the surface
- Avoid soaking, dripping, or letting moisture pool. Too much liquid can harm sensitive components
- Once wiped, make sure everything is dry before using the keyboard again

SAFETY, LEGAL AND WARRANTY INFO.

Warranty

If there is a functional defect due to faulty manufacturing, we will replace the product. This warranty does not cover damage that results from misuse of the product.

Attention!

If you attempt to dismantle your product, you will invalidate your warranty.

Contour Design Nordic A/S

Nyropsgade 43, 1. floor
DK-1602 Copenhagen V, Denmark
Contact Support: cd.now/support

Contour Innovations LLC

10 Industrial Drive
Windham, New Hampshire 03087, USA
Contact Support: cd.now/support

For more information please visit:

www.contourdesign.com

Tested to comply with FCC and IC standards.

