

Contour

# BALANCE MID-SIZE KEYBOARD WIRED

Product manual

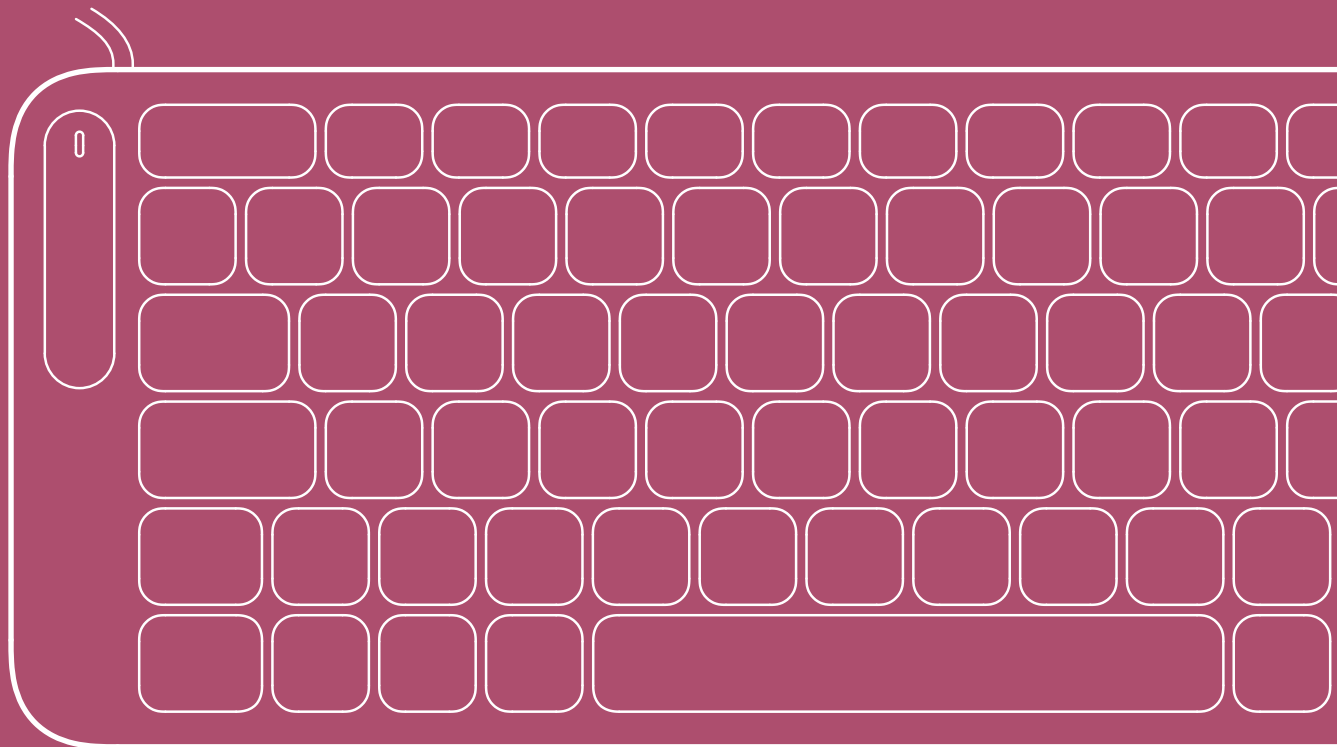

# TABLE OF CONTENTS.

What's in the box	1
Meet Balance	1
Get set up for comfort	2
Quick connect guide	3
Tilt options	3
Media keys & customization	4
Function keys	5
Caps lock & num lock	6
Cleaning & maintenance	7
Safety, legal & warranty info	7



# WHAT'S IN THE BOX.

You'll find everything you need for a seamless set-up inside the box.



1. Balance Keyboard Wired

2. USB-C to USB-A adaptor

# MEET BALANCE.



1. Power LED

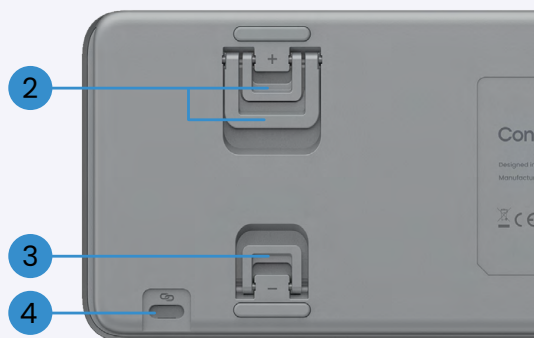

2. Positive tilt legs

3. Negative tilt legs

4. SnapLink attachments

# GET SET UP FOR COMFORT.

Before you start typing, set yourself up for all-day comfort.

Relax your shoulders. Keep your elbows at 90 degrees, close to your body. Your forearms should be parallel to the floor, with wrists in a straight, neutral position.

Whether you're pairing your Balance Keyboard with a RollerMouse or SliderMouse your set-up matters.



## RollerMouse or SliderMouse:

Line up the H key on your keyboard and the scroll wheel on your RollerMouse or SliderMouse with the centre of your monitor – and your body. This helps keep your posture natural and balanced

Position the keyboard close to the rollerbar, and keep the RollerMouse far enough from the desk edge so your forearms are supported when resting

# QUICK CONNECT GUIDE.

If you have the wired version of Balance Keyboard, just plug the USB cable into any available USB port in your PC.

Your computer will connect to the keyboard automatically. No extra steps needed.

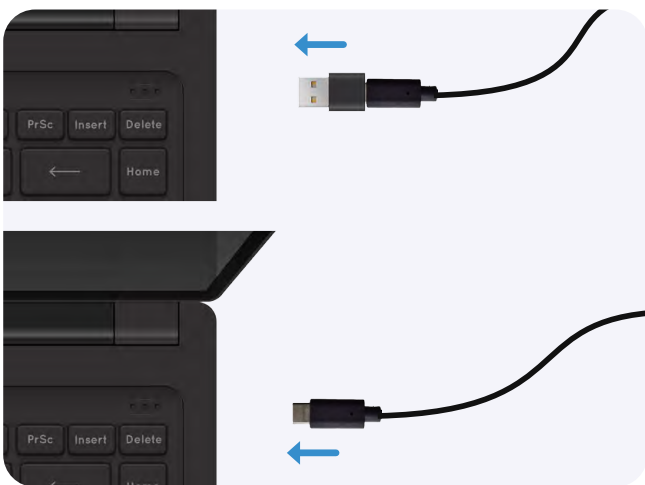

## The cable comes with a USB-A adaptor pre-installed

Just slide the adaptor off and plug in the USB-C connector instead

# TILT OPTIONS.

Balance Keyboard gives you five tilt options to suit your set-up, posture needs, and personal preference.

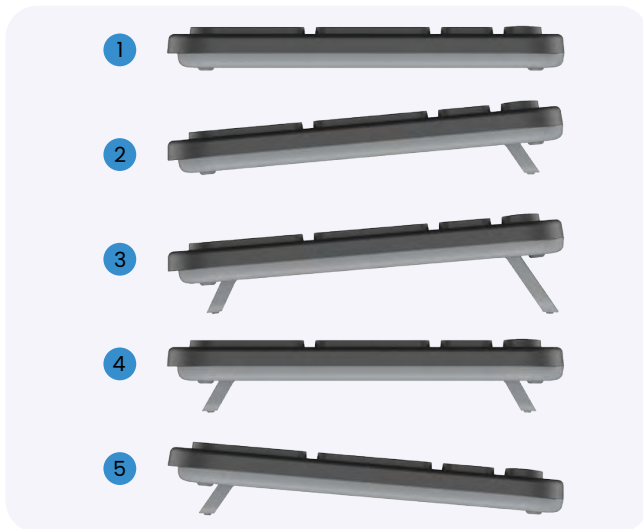

1. **Flat** – for Touch, Balance Wrist Rest and UniMouse (recommended ergonomic option)
2. **Positive tilt** – for Touch, Balance Wrist Rest and UniMouse
3. **Elevated positive tilt** – for RollerMouse or SliderMouse
4. **Elevated** – for RollerMouse or SliderMouse
5. **Negative tilt** – for RollerMouse or SliderMouse (recommended ergonomic option)

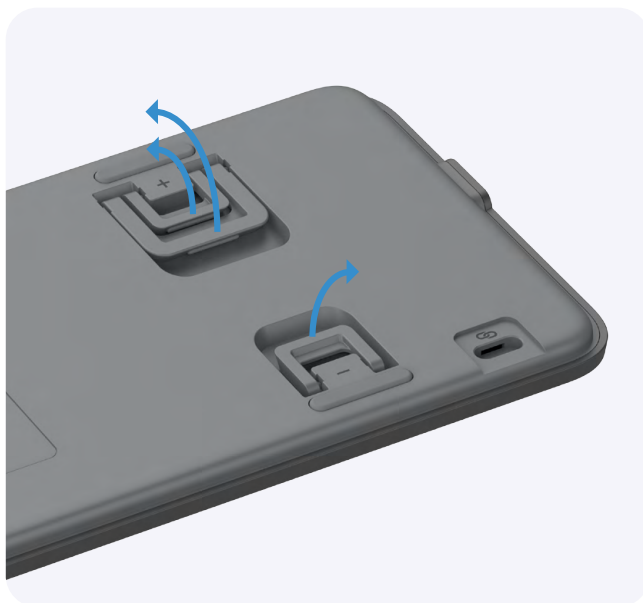

The + and – symbols on the tilt legs show you if you are choosing positive or negative tilt

# MEDIA KEYS & CUSTOMISATION.

Your Balance Keyboard comes ready with preset media keys to get you going right away.

## Want to make it your own?

Download the Contour software to customise the media keys based on your preferences and unlock the full potential of your keyboard

[Visit cd.now/sw](https://cd.now/sw) to get started

## Mid-Size media keys



Number	Default assignment
1	Mute/unmute sound
2	Volume down
3	Volume up
4	Mute/unmute microphone
5	Previous track
6	Play/pause
7	Next track
8	Brightness down
9	Brightness Up
10	Open settings
11	Show desktop
12	Print screen / snipping tool
13	Open calculator
14	Clear entry
15	Negative number toggle
16	Lock computer
17	Open Copilot or other AI assistant



# FUNCTION KEYS.

## Function keys & fn lock

By default, the top row of your keyboard is set for media keys like volume, play/pause, and more. Need traditional F-keys instead? You've got options:

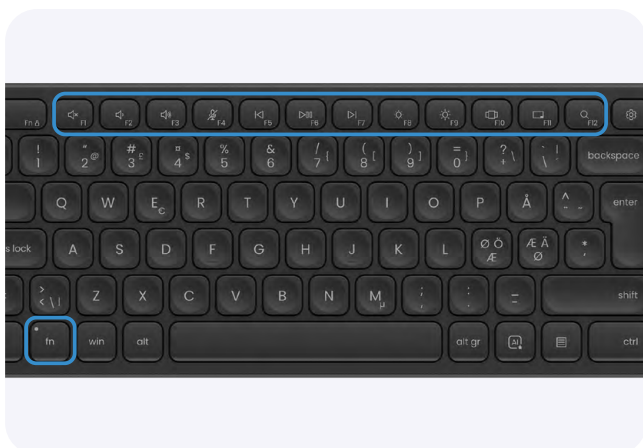

### For one-time use:

Hold down the fn key and short press any F-key



### To switch modes:

Want to make F-keys the default? Just hold down the fn key and short press the esc key

The fn lock LED will turn on

To switch back to media keys as default, hold down the fn key and short press the esc key again

# CAPS LOCK & NUM LOCK.



## Caps lock:

Press the key once to turn caps lock on or off, when LED on the key is lit, caps Lock is on



## Num lock:

Press the key once to switch your numpad from numbers to navigation - or back again

# CLEANING & MAINTENANCE.

Balance Keyboard is designed to be easy to maintain - and yes, it can be safely disinfected.

**Follow these steps to clean the product safely and keep your warranty intact:**

- Unplug any cables and make sure the device is turned off before cleaning
- Use an alcohol-based solution (up to 70% concentration) for disinfection
- Never apply liquid directly to the keyboard. Instead, lightly dampen a soft, clean cloth with the solution and gently wipe down the surface
- Avoid soaking, dripping, or letting moisture pool. Too much liquid can harm sensitive components
- Once wiped, make sure everything is dry before using the keyboard again

## SAFETY, LEGAL AND WARRANTY INFO.

### Warranty

If there is a functional defect due to faulty manufacturing, we will replace the product. This warranty does not cover damage that results from misuse of the product.

### Attention!

If you attempt to dismantle your product, you will invalidate your warranty.

### Contour Design Nordic A/S

Nyropsgade 43, 1. floor  
DK-1602 Copenhagen V, Denmark  
Contact Support: [cd.now/support](https://cd.now/support)

### Contour Innovations LLC

10 Industrial Drive  
Windham, New Hampshire 03087, USA  
Contact Support: [cd.now/support](https://cd.now/support)

### For more information please visit:

[www.contourdesign.com](https://www.contourdesign.com)

Tested to comply with FCC and IC standards.

