



## Specifications

Length	67"
Width	30"
Height	21 ½"
Immersion Depth	
Shipping Weight	460 Lbs*
Water Capacity	78 US Gal*

\*Approximately

## Product Features

- o Seamless One-Piece Solid Surface Resin Soaker Tub
- o Fluted Design on surface of tub
- o Leveling Feet Included
- o White Drain Assembly Included
- o Integral overflow channel
- o Center Drain
- o Drain hole size 1.9"

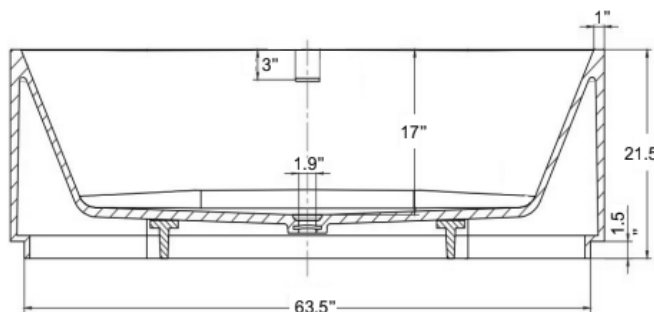
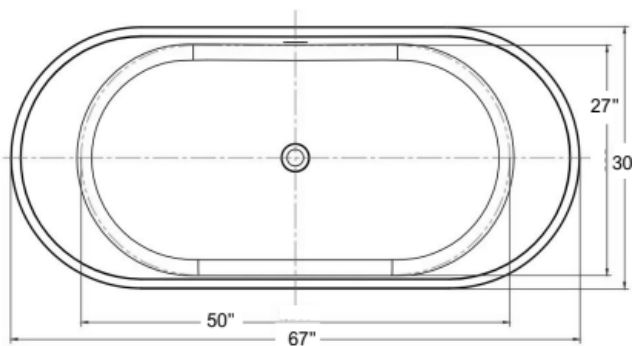

Note: ALL MEASUREMENTS ARE IN INCHES & HAVE TOLERANCE OF +/- ¼"

While we strive to provide accurate measurements for our customers, mistakes happen.

Our goal is to help things run smoothly from shipment to installation, so if you notice any errors in our spec sheets, please let us know.

Our products are handmade & finished so you can expect a tolerance of +/- ¼" measurements. We strongly recommend waiting until your ordered product is on-site before attempting any rough-in, carpentry, and/or plumbing.

If you want to verify any of our measurements, please feel free to call or email us.

Keeping with our policy of continuing improvement, Venco® reserves the right to change product specifications without notice. For latest specifications, please contact Venco® directly or check our website [www.venco.ca](http://www.venco.ca)



Venco Products Ltd.  
7584 Vantage Place  
Delta, BC  
Canada V4G 1A5  
Tel: +1 (604)-940-4960  
[www.venco.ca](http://www.venco.ca)