



*Banff Park Lodge*

IN THE HEART OF BANFF

201 LYNX STREET

BANFF, ALBERTA, T1L 1K5

1-800-661-9266

WWW.BANFFPARKLODGE.COM

## GUEST SERVICES

- Special group & weekday rates available.
- Recreation centre featuring an indoor swimming pool, hot plunge pool, whirlpool & fitness room.
- Ski, snowboard & bike storage.
- Concierge, laundry & room service available.
- Underground parking available for vehicles under 6ft.
- La Terrazza & Crave Mountain Grill Restaurants in-house.

## GUEST ROOMS

- 211 rooms on-site.
- 47" LED HD TV with digital connectivity.
- Convenience fridge, iron & ironing board in each room.
- Telephone with private voicemail.
- Complimentary in-room coffee & tea.
- Private balcony or patio.
- Flexible to your budget with sister properties **Bow View Lodge & Peaks Hotel & Suites.**

## LOCATION

- Banff Park Lodge is the only 4 star Canada Select full service resort hotel & conference centre in downtown Banff.
- Steps away from the Bow River & countless local activities.
- Black Tie Ski Rentals, Black Diamond Bike Rentals, Bearhead Photography Gallery & Salon 1463 on site.
- 1.5 hour drive from Calgary.





*Banff Park Lodge*

201 LYNX STREET

BANFF, ALBERTA, T1L 1K5

1-800-661-9266

SALES@BANFFPARKLODGE.COM

WWW.BANFFPARKLODGE.COM

## MAIN LEVEL

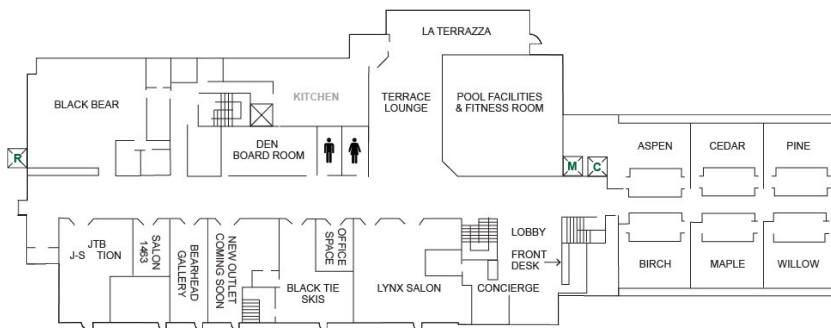

## MEZZANINE

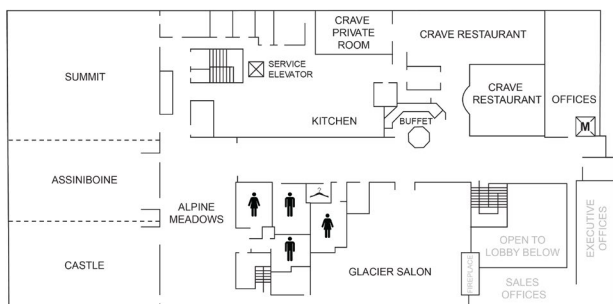

## FUNCTION ROOMS

ROOMS	DIMENSIONS	SQ.FT.	CEILING	DANCE FLOOR	THEATRE	CLASSROOM	BANQUET	RECEPTION	U-SHAPE	HOLLOW SQUARE	BOARDROOM	HALF ROUNDS
Summit	52' X 54'	2868	16'	17'3" x 19'9"	250	100	152	250	55	60	-	100
Assiniboine	29' X 54'	1566	13'	29'5" x 19'9"	120	65	80	150	35	39	-	65
Castle	30' X 54'	1620	16'	16'8" x 19'9"	120	65	80	150	35	39	-	65
Summit/Assiniboine	81' X 54'	4374	16'/13'	46'8" X 19'9"	370	165	232	400	90	99	-	165
Castle/Assiniboine	58' X 54'	3186	16'/13'	46'1" X 19'9"	240	130	160	300	70	78	-	130
Ballroom (above three combined)	111' X 54'	5994	16'	63'6" x 19'9"	550	230	400	550	-	-	-	230
Alpine Meadows	27' X 60'	1620	16'	-	-	-	-	150	-	-	-	-
Glacier Salon	L Shape	1869	16'	14'11" x 15'15"	75	60	88	150	35	39	24	60
Black Bear	44' X 45'	1980	9'6"	12'6" x 17'	100	50	80	150	30	44	22	50
Lynx Salon	27' X 38'	1026	8'6"	-	86	48	72	100	20	23	22	45
Crave Private	15' X 27'	405	16'	-	-	-	20	30	-	-	20	-
Den Boardroom	18' X 36'	648	8'	-	40	30	32	30	-	-	20	-
Tree Rooms (Aspen, Cedar, Pine, Willow, Maple, Birch)	20' X 27'	540	8'	-	40	24	24	30	-	-	18	18

## MEETINGS & EVENTS

- The only first class convention, meeting & banquet facility for up to 550 people in downtown Banff.
- Over 19,000 sq ft of convention facilities.
- Large windows & high ceilings.
- Flexible spaces.
- Complete audio visual equipment available onsite.
- Catering & complete meeting package (CMP) options.
- Fully air-conditioned convention & banquet space.

**OUR CMP IS DESIGNED TO TAKE THE GUESSWORK OUT OF YOUR PLANNING PROCESS!**