

PINNACLE HOTEL

AT THE PIER



PLANNING KIT



FLEXIBLE MEETING & EVENT SPACE

ON THE WATERFRONT IN NORTH VANCOUVER



10 – 400 GUESTS



4 ROOMS



UP TO 8,000 SQ FT

IN THIS BOOKLET

Pinnacle Hotel at the Pier	3
Meetings & Conferences	4
Events	5
Guestrooms & Accommodations	6
Food & Beverage	6
Pinnacle Ballroom	7
Pier Salon	8
Portside	9
Private Dining Room	10
Second Level Floorplan	11
Waterfront North Vancouver	12



PINNACLE HOTEL AT THE PIER

Located in Historic Lower Lonsdale, our location makes experiencing North Vancouver convenient and stress-free. Being locally owned, we focus on community and offering personalized services that connect you to the things that make North Vancouver special.

THE PLACE TO GATHER

Book your next meeting or event at the Pinnacle and create an experience that your guests will remember and want to experience again. Our premier North Vancouver event facilities feature high-end finishes, natural light, rooms with a waterfront view and features that will add style and elegance to your personalized décor and set up. From lavish weddings, annual general meetings to professional corporate events, our flexible space offers it all. A fantastic location, incredible views and personalized services.



MEETINGS & CONFERENCES

With 4 rooms and up to 8,000 sq ft of event space, we can easily host anywhere from 10 to 400 guests for many types of meetings--big or small.

SMALL SPACES: Host as few as 10 guests in many of our naturally lit waterfront rooms starting from just 380 sq ft. Perfect for small meetings, press conferences, seminars, workshops, board meetings and more. Discover our Pier Salon that offer great versatility and panoramic views for almost any setup--whether it be a theatre, classroom, U-shape, square, reception, or banquet.

LARGE SPACES: With a variety of venues and room for up to 400 guests in our 4,617 sq ft Ballroom with panoramic views. Accommodate all your needs when planning everything from general meetings, to dinners & banquets and all types of functions. Our Pinnacle Ballroom, Pier Salon, and Portside meeting spaces are flexible in meeting your vision.

CONFERENCES: Maximize your conference, convention, or tradeshow with access to more than 8,000 sq ft of combined space—including our Pinnacle Ballroom with floor to ceiling windows with natural light and panoramic views.

BREAKOUT SPACES: Convenient spaces to convene and collaborate. Easily plan breakout sessions of any size in a quiet and intimate setting just steps from your main event.

“ABSOLUTELY PERFECT”

“Everything was absolutely perfect in every way.

I don't think I've ever been to a meeting that has run so seamlessly!”

-Danielle & Charlene



EVENTS

From our intimate Pier Salon to our elegant grand ballroom with waterfront views, our versatile spaces are perfect for any event.

SMALL EVENTS: Host as few as 10 guests in many of our naturally lit waterfront rooms starting from just 380 sq ft. Versatile for almost any setup—whether it be a small party, intimate dinner, birthday, anniversary, meet-up, or networking event. Discover our Portside room, for those more intimate gatherings.

LARGE EVENTS: With a variety of event venues and room for up to 400 guests in our 4,617 sq ft Ballroom with panoramic views. Easily accommodate all your needs when planning social events, fundraisers, graduation ceremonies, receptions, and all types of parties. Our Pinnacle Ballroom, Pier Salon, and Portside room event venues are easily flexible to meet your vision.

UNIQUE SPACES: Get creative and make your event one to remember. Pier 7 Restaurant across from the hotel offers an oceanfront private dining room on the second floor, boasting breathtaking views of downtown Vancouver.

“STAFF & FOOD WERE ALL FANTASTIC”

“If we ever needed anything or had to adjust our schedule the staff were right there to help. Everyone at our conference commented on how fantastic the food was – fresh and full of variety.”

-Alex Chappie, Thought Exchange



GUESTROOMS & ACCOMMODATIONS

Experience breathtaking waterfront views of Downtown Vancouver's dynamic skyline from our spacious rooms and suites. All our guestrooms offer the comfort, convenience, and hotel amenities you've come to expect, including free wifi, swimming pool, hot tub, health & fitness club, and on-site dining. Make the most of your stay with small luxuries that make you feel at home.

HARBOURVIEW: Offering panoramic views of Burrard Inlet and downtown Vancouver from our harbour view rooms.

MOUNTAINSIDE: Showcasing impressive urban views, immersing you in the buzzing energy of Lower Lonsdale from our mountainside rooms.

SUITES: Our premium studios offer a generous layout on the mountainside with no need to choose between comfort, space, and function.

FOOD & BEVERAGE

Select from a variety of options including All-Day Packages and save. Customize your menu the way you want--whether it be cultural, dietary, or creative, our on-site culinary team is well equipped to handle it all.

PRIVATE DINING ROOM: Host up to 10 people in our signature west-coast inspired lobby restaurant's Private Dining Room.

THE LOBBY RESTAURANT: Conveniently located in the Pier Hotel, The Lobby Restaurant offers everything from casually elegant business lunches and signature dinners to scrumptious weekend brunches, enjoy impeccable service and relaxed harbor-side dining.

ON-SITE CULINARY TEAM: Our creative and experienced on-site culinary professionals are here to heighten your guests' experience. Using only fresh and sustainable ingredients from local suppliers, we strive to provide upscale-casual dining experiences customized to your event or meeting.



PINNACLE BALLROOM

The heart of the Pinnacle Hotel at the Pier’s meeting space is the 4,800 square foot Pinnacle Ballroom. With 16 foot high windows, the glass front walls of the Pinnacle Ballroom allow for natural light to stream in with panoramic views of the downtown Vancouver skyline and harbour.

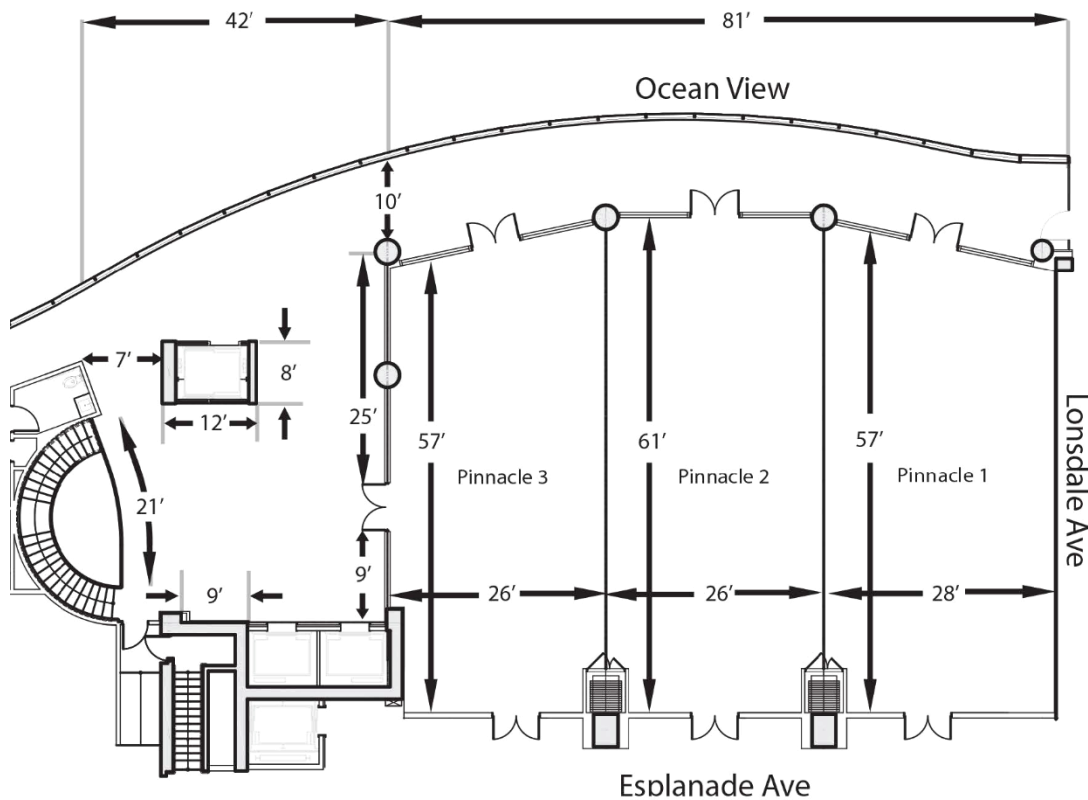

ROOM	DIMENSIONS	SQUARE FOOTAGE	CEILING HEIGHT	THEATER	RECEPTION	BANQUET (ROUNDS OF 10 / 12)	CLASSROOM	BOARDROOM
PINNACLE ONE	57 x 28	1,596	16	120	100	60 / 80	50	30
PINNACLE TWO	61 x 26	1,596	16	120	100	60 / 80	50	30
PINNACLE THREE	57 x 26	1,482	16	120	100	60 / 80	50	30
PINNACLE BALLROOM (ALL SECTIONS)	57 x 81	4,617	16	400	400	225 / 300	180	-
PINNACLE BALLROOM FOYER	11 x 81	891	13	-	100	-	-	-



PIER SALON

The 1,585 square feet of Pier Salon is divisible by two into Pier One and Pier Two. This function space is ideal for receptions and executive meetings. As a whole, this venue will seat a maximum of 100 with the added bonus of an adjacent outdoor terrace.

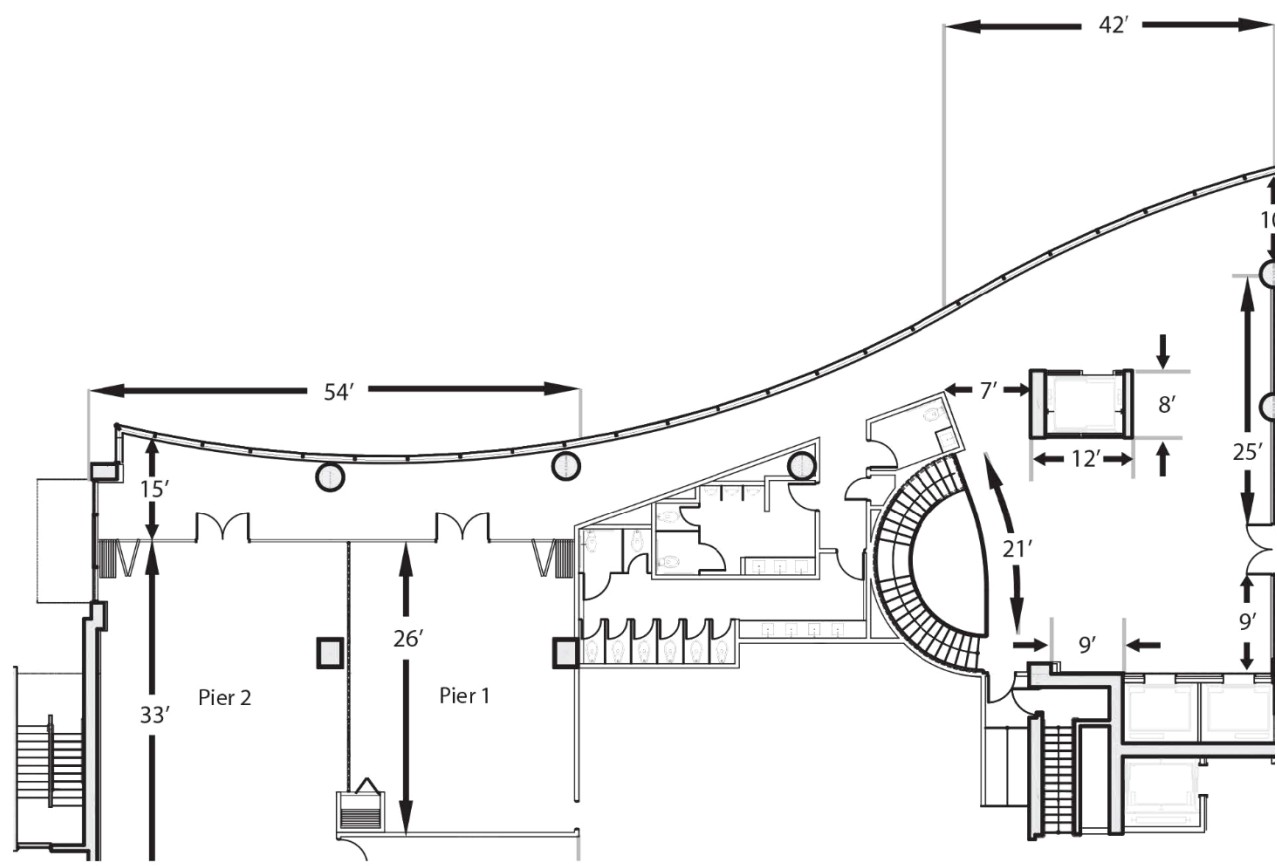

ROOM	DIMENSIONS	SQUARE FOOTAGE	CEILING HEIGHT	THEATER	RECEPTION	BANQUET (ROUNDS OF 10)	CLASSROOM	BOARDROOM	U-SHAPE
PIER ONE	26 x 25	650	14	40	40	30	20	15	12
PIER TWO	33 x 28	924	14	80	100	50	40	25	30
PIER SALON (ALL SECTIONS + FOYER)	48 x 54	2,395	14	130	120	100	-	-	-



PORTSIDE

New to our meeting room options—located beside the Lobby Restaurant. A very versatile room for breakout options or a larger private dining area with floor to ceiling windows and a wall-mounted TV for use during your meeting or events.

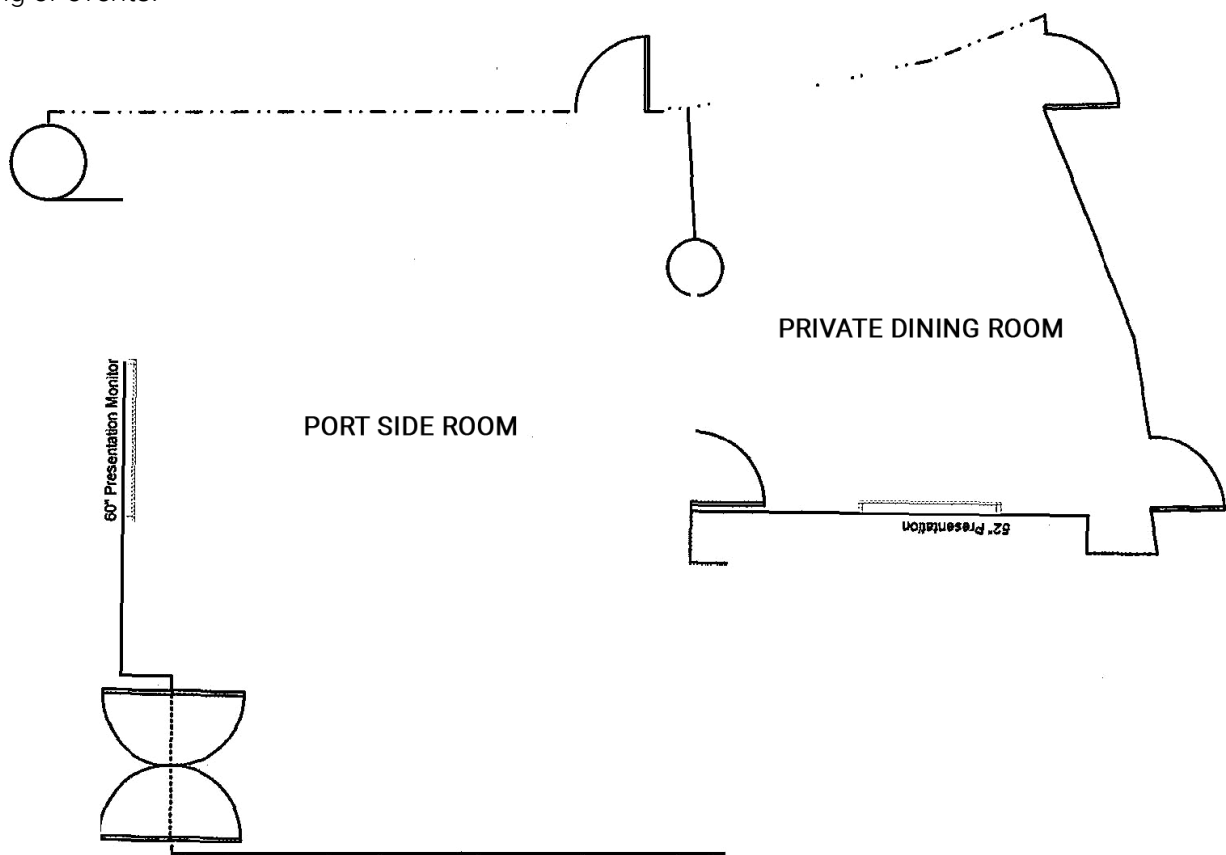

ROOM	DIMENSIONS	SQUARE FOOTAGE	CEILING HEIGHT	THEATER	RECEPTION	BANQUET (ROUNDS OF 10)	CLASSROOM	BOARDROOM
PORT SIDE	25 x 28	700	16	40	40	30	20	20



PRIVATE DINING ROOM

From a creative cocktail party to a professional business lunch, our private dining room is perfect for intimate dining and exclusive celebrations. This private space accommodates up to 10 people and includes use of a wall mounted TV.

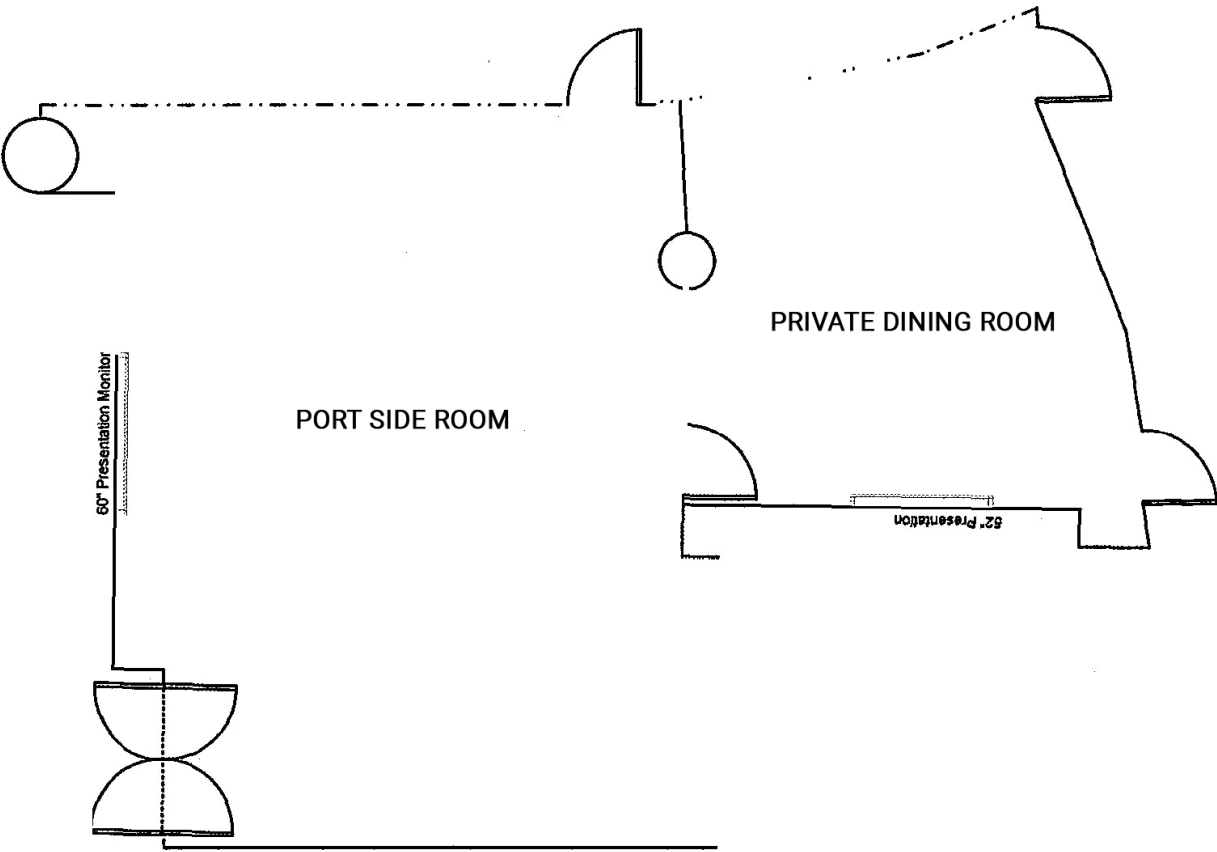

ROOM	DIMENSIONS	SQUARE FOOTAGE	CEILING HEIGHT	THEATER	RECEPTION	BANQUET (ROUNDS OF 10)	BOARDROOM
PRIVATE DINING ROOM	19 x 20	380	16	-	-	-	10

SECOND LEVEL FLOORPLAN

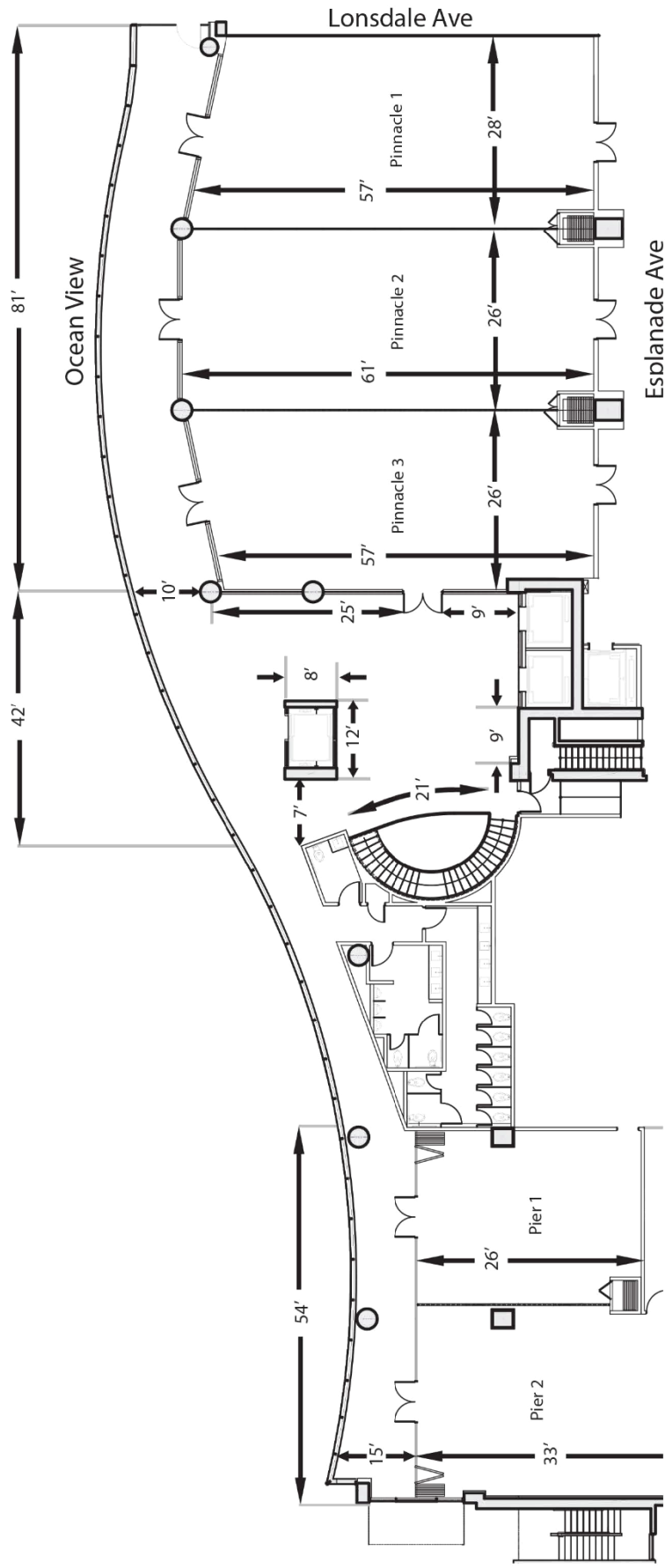

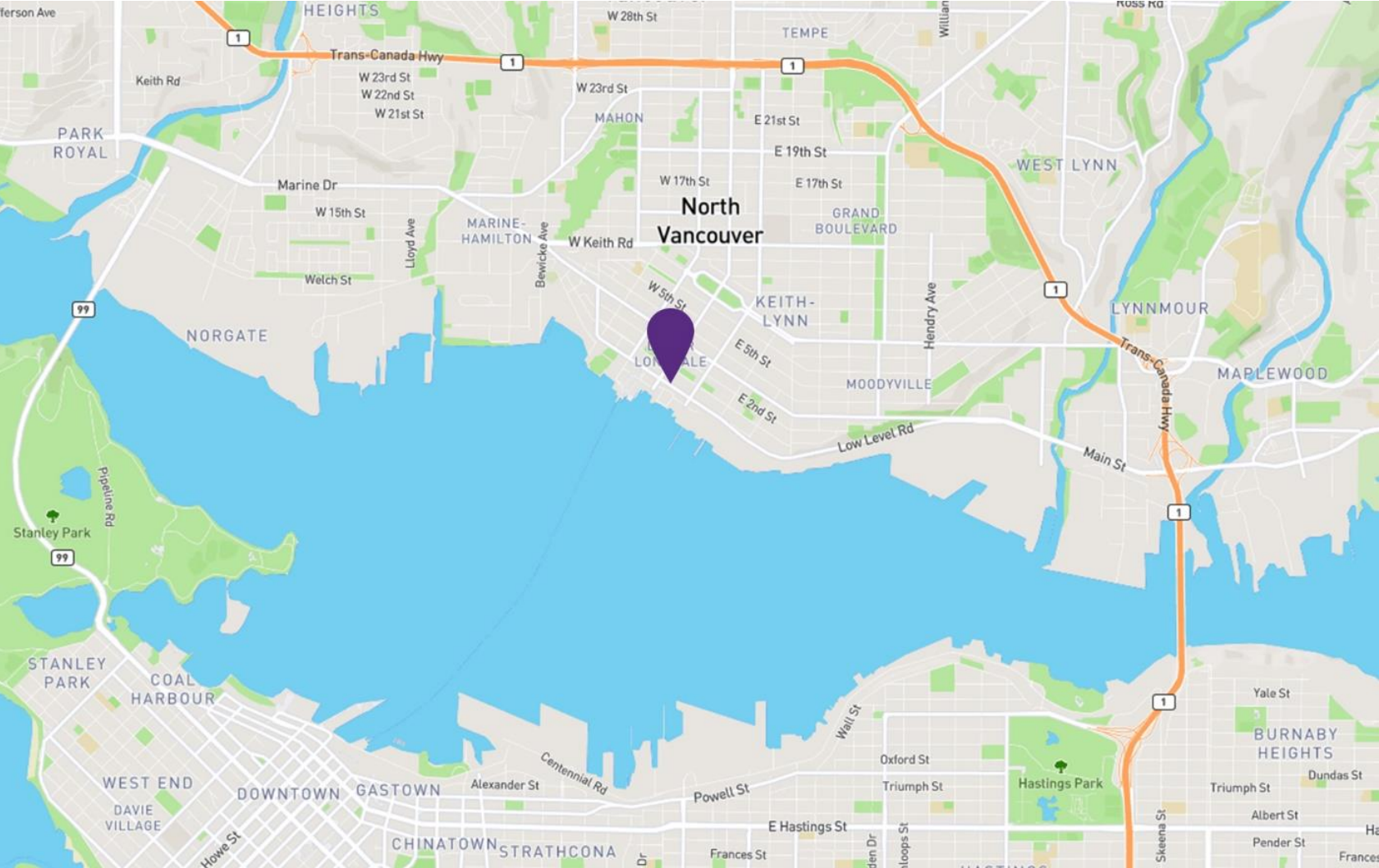

WATERFRONT NORTH VANCOUVER

Situated right where you want to be, Pinnacle at the Pier Hotel is located at the foot of Lonsdale Avenue in the oldest neighborhood in North Vancouver. Once home of the Wallace Shipyards, the area has been developed as a historical site, complete with parks, seaside walks, shops, and historical maritime artifacts.

Our location is just minutes from top attractions like Lonsdale Quay, Polygon Gallery, The Pier, and a 12 minute Seabus ride to downtown.

PINNACLE HOTEL AT THE PIER

138 VICTORY SHIP WAY, NORTH VANCOUVER, BC, V7L 0B1

1.604.986.7437