

DUAL ACTION WOCD INSTALLATION INSTRUCTIONS

1

CONTENTS AND TOOLS

Contents

1. WOCD (Left or Right)
2. Screws (4 pairs)
3. Screw post
4. Shims(3pcs)

WARNING

1. Follow manufacturer's instructions for hand or power tools. Always wear safety glasses. Failure to do so may result in injury and/or product damage.
2. Use caution when working at elevated heights and around unit openings. Follow manufacturer's instructions for ladders and/ or scaffolding. Failure to do so may result in injury or death.

Tools needed

1. Drill
2. 1/4" Drill Bit
3. Tape measure
4. Pencil
5. Phillips head screw driver

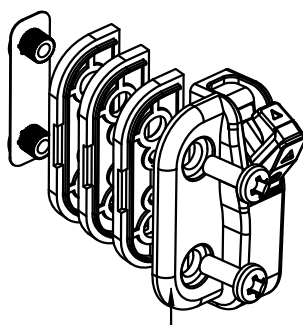

WOCD
(LEFT)

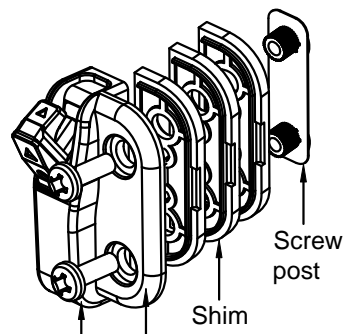

WOCD
(RIGHT)

Screw post

Shim

Screw

2

WOCD INSTALLATION INSTRUCTIONS

STEP 2.
Measure 3.75" up
from top of
bottom sash
and mark
hole locations

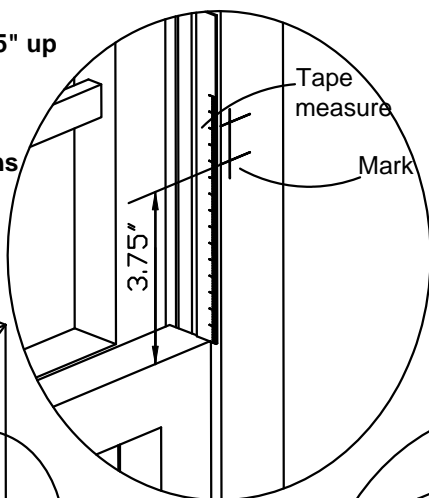

STEP 3.
Drill holes
on marked
centers

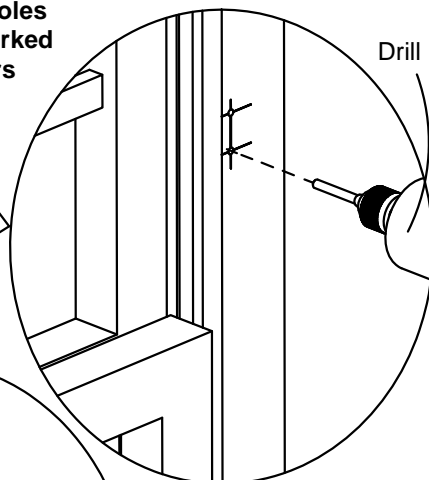

STEP 1.
Close and lock
window

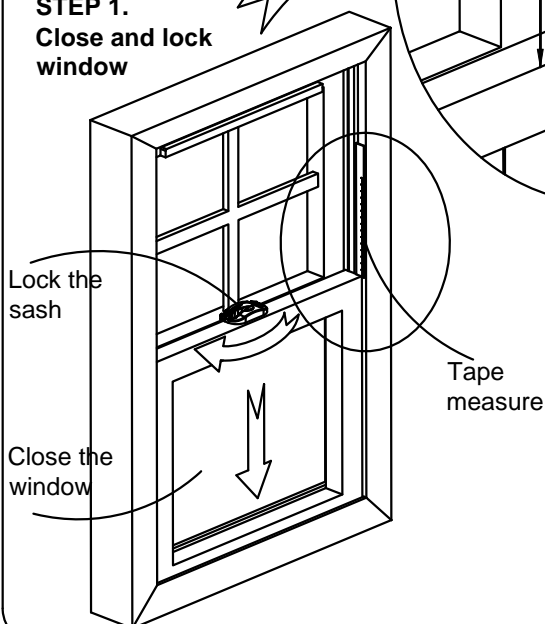

Screw post

Screw

WOCD

Tape measure

3

SELECT PROPER SHIM

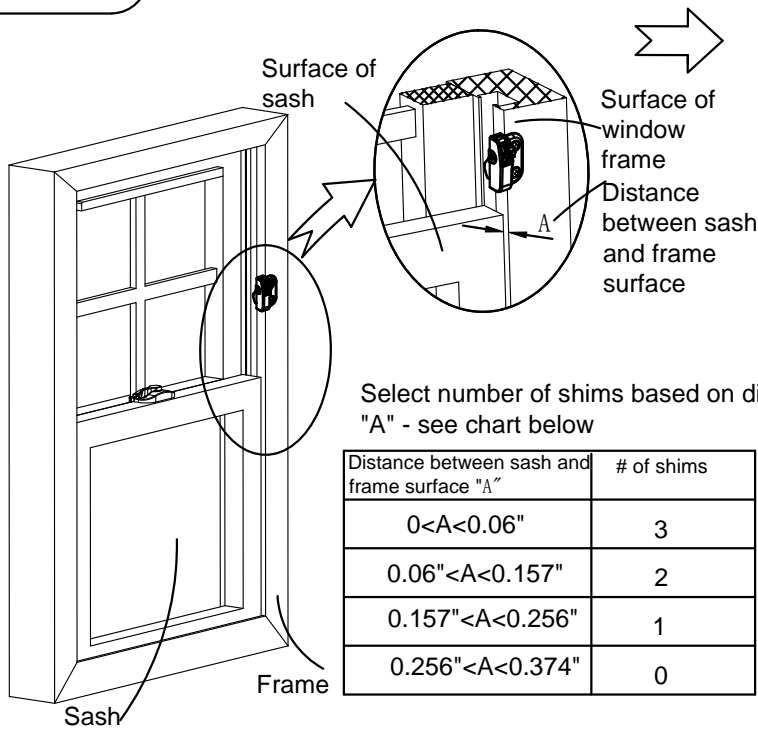

WARNING

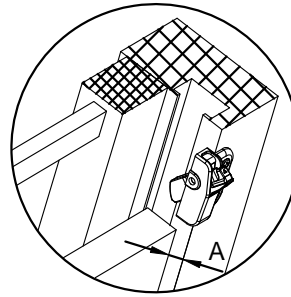

Without shim

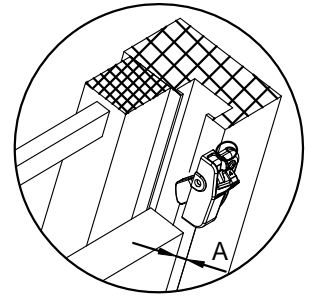

With 1 shim

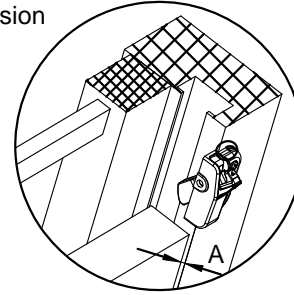

With 2 shims

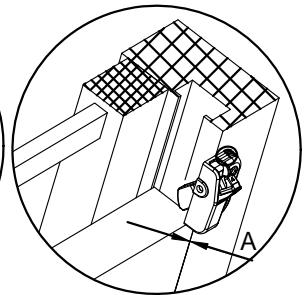

With 3 shims

4

VERIFY WOCD FUNCTION



WARNING

1. Verify correct opening control device operation. Clear opening must be less than 4".
2. WOCD is not a security device that provides intrusion protection.

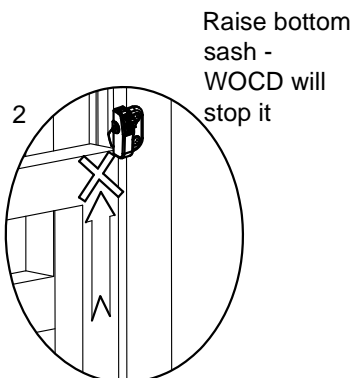
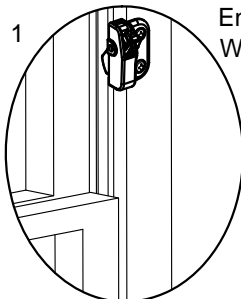
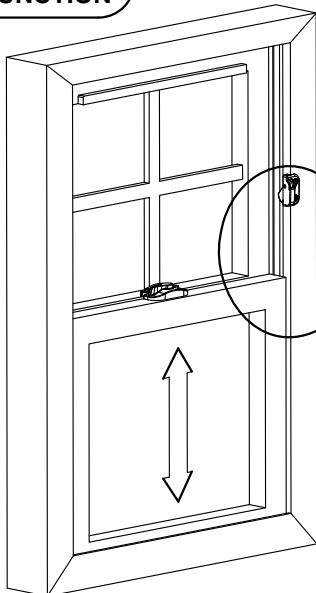

Opening must be less than 4"

LESS THAN 4"

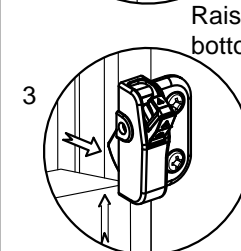
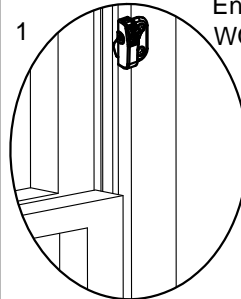

Tongue of WOCD retracted in housing

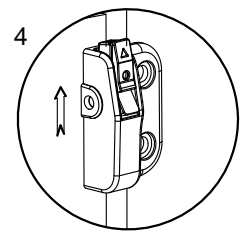

Lower bottom sash - WOCD will reset

