

Product	
Catalog No.	
Fixture Type	Notes

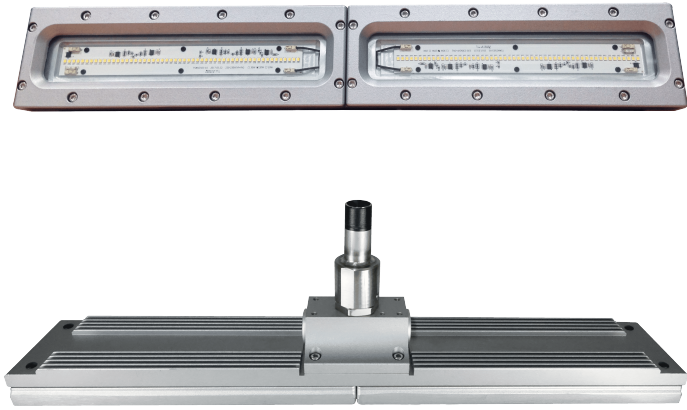

EX1103 LED EXPLOSION PROOF LINEAR LIGHT

EX1103 is a hazardous location luminaire designed for Class I Division 1 and Class II Division 2 environments. Offering 40W and 60W options, it delivers up to 6000 lumens with excellent reliability. Built with aluminum alloy housing and tempered glass, it provides IP67/NEMA 6 protection and operates in extreme conditions from -40°F to +131°F. With a service life of 60,000 hours, multiple mounting options, and UL/CSA certifications, EX1103 is ideal for oil, gas, and petrochemical facilities.

APPLICATIONS

- Oil Refinery Complex
- Petrochemical Complex
- Painting Facility
- Natural Gas Transport
- Offshore Platforms (Oil & Gas)
- LPG Transport

FEATURES

- Explosion-proof (CID1, CID2)
- 40W/60W selectable
- High efficacy up to 6000 lm
- Long 60,000-hr life
- Wide beam angle (116°×113°)
- IP67/NEMA 6

SPECIFICATION SUMMARY

Category	Specification	Data
Category Performance	Wattage	40W / 60W (Optional)
	Delivered Lumens	3,600~6,000lm
	Lumen Efficacy	90-100lm/W
	Color Temperature	3000K / 5000K (Optional)
	CRI (Ra)	70+ / 80+
Electrical	Input Voltage	120V / 277V (Optional)
	Dimming	-
	Power Factor	>0.90
Physical	Housing	Aluminum Alloy
	Operation Temperature	CID1: -40°F ~ +131°F (T6) CID2: ~ +131 °F(T6)
	IP Rating	IP 67
	Mounting Options	Ceiling, Wall Mount, Hanging Mount
	Dimension	25.85" × 8.2" × 4.13"

LIFESPAN AND WARRANTY

Rated Life	50,000 Hrs
Warranty	5 Years
Certification	UL

CERTIFICATION

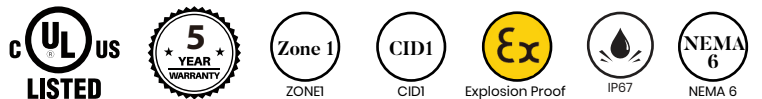

40W

Class I, Division 1, Group B, C, D
Class I, Division 2, Group A, B, C, D
Class II, Division 2, Groups F, G
Class III

60W

Class I, Division 1, Group B, C, D
Class I, Division 2, Group A, B, C, D

EX1103 LED EXPLOSION PROOF LINEAR LIGHT

PERFORMANCE DATA

PRODUCT CODE	WATTS	lm/W	DELIVERED LUMENS	INPUT VOLTAGE	CRI (Ra)	CCT
EX1103	40W	110	4400	AC120 / 277V	70	5000K
EX1103	40W	100	4000	AC120 / 277V	80	3000K
EX1103	60W	110	6600	AC120 / 277V	70	5000K
EX1103	60W	100	6000	AC120 / 277V	80	3000K

MOUNTING OPTION & DIMENSION

Wall Mount 90° [WHT (W90)]

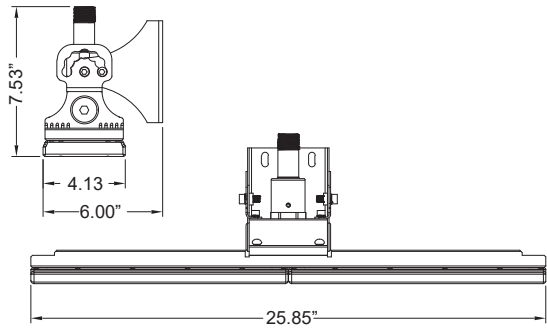

17.0 lb

Hanging Mount 90° [WHT (H90)]

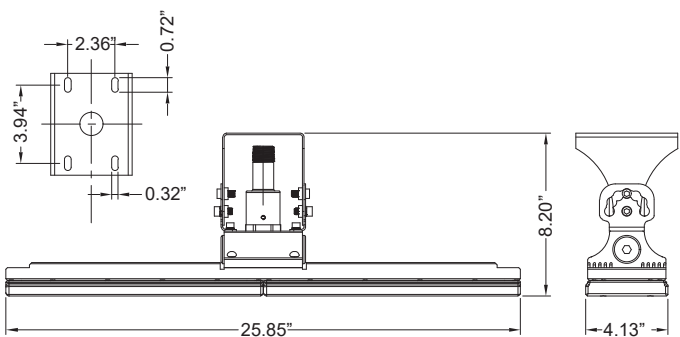

17.0 lb

Ceiling (C90)

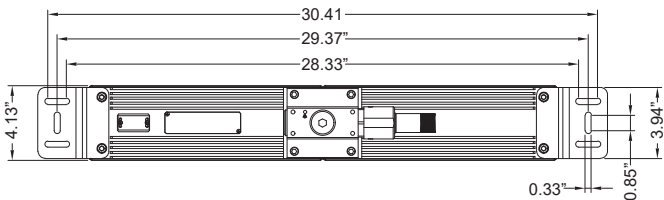

17.4 lb

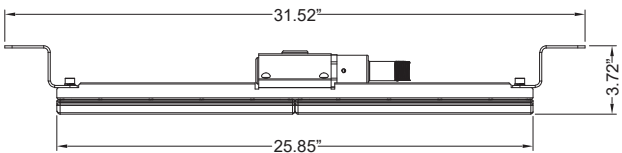

●Octagonal Box [WHT(O)]

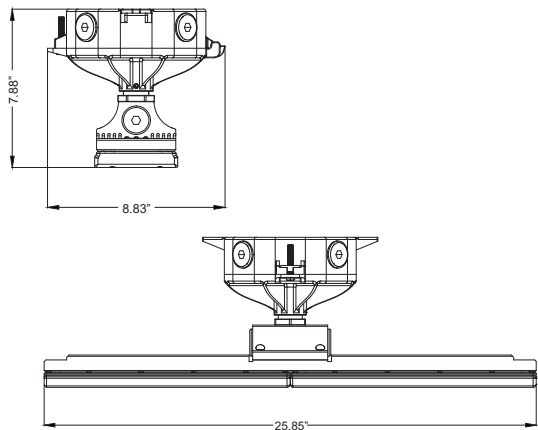

This mounting bracket is only applicable to C1D2 protection

●Small Octagonal Box [WHT(OS)]

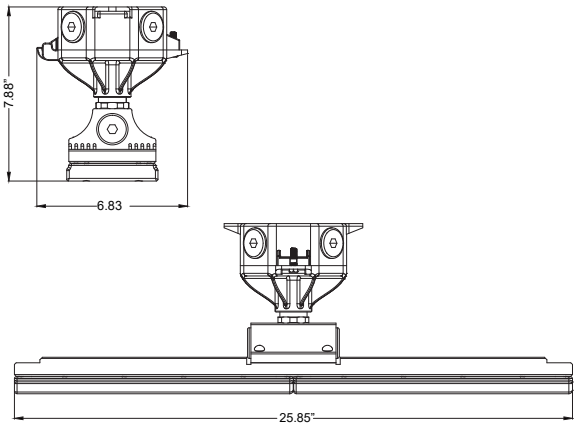

This mounting bracket is only applicable to C1D2 protection

EX1103 LED EXPLOSION PROOF LINEAR LIGHT

PHOTOMETRY

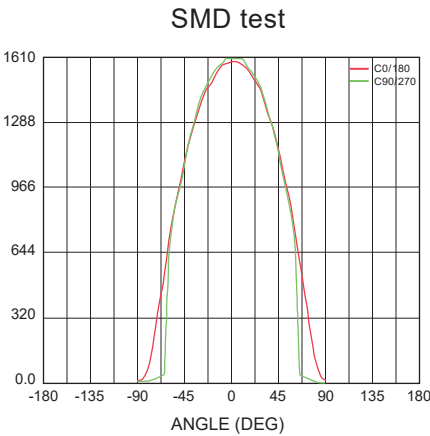
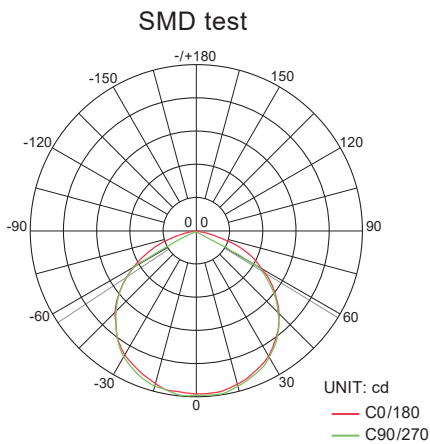

ORDERING INFORMATION

EX1103						
Series SKU	Wattage	Efficacy	CRI	Input Voltage	CCT	Mounting (Optional)
EX1103	040: 40W 060: 60W	S: 100 lm/W P: 110 lm/W	M: 80 L: 70	U: 120V H: 277V	30: 3000K 50: 5000K	CL: Ceiling WM: Wall Mount 90° HM: Hanging Mount 90° OB: Wall / Hanging Mount (Octagonal Box) SO: Wall / Hanging Mount (Small Octagonal Box)

Example: EX1103-040SMU-30WM
Lead times will vary depending on options selected.
Consult with your sales representative.

MISCELLANEOUS

CONSTRUCTION:
INSTALLATION:
OPTICS:
LISTINGS:
ELECTRICAL:
GOVERNMENT PROCUREMENT:

NOTE