

## GENERAL INFORMATION

The THORNE LASER G is a decorative garden bollard featuring a laser-cut aluminum shade over a frosted acrylic diffuser, creating patterned 360° ambient illumination. Combining sculptural aesthetics with functional light output, it offers IP65 protection, dimmable LED performance, and finish options suited for modern outdoor environments.

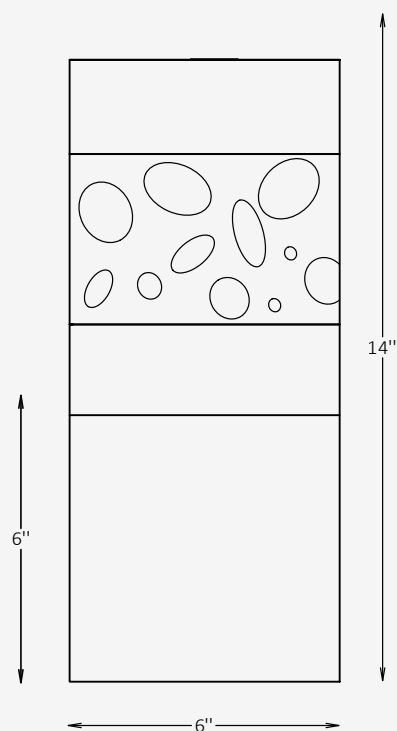

## SPECIFICATIONS

Material	Extruded Aluminum + PMMA
Lens	Frosted, Acrylic
Diameter	6" / Custom on request*
Total Height	14"
Base Height	8"
Light Source Type	LED
Power	9.5W / 17W
Input Voltage	110-277V, 50-60 Hz
LED Output	48 lm/W
CCT	2200K / 2700K / 3000K / 4000K / 5000K
CRI	90
Dimming & Driver	Integral, 0-10V
Light Distribution	Type V 360° symmetrical light distribution
IP Rating	IP 65
Warranty	5 years
Finishes	16 standard finishes 8 wood-effect finishes 12 metallic finishes Custom on request*

## OTHER VERSIONS AVAILABLE



## CERTIFICATION



## Ordering Information

Select one item from each category below. If your desired option is unavailable, please contact our team for support or custom solutions.

Code	Diameter Ø	Height	Material
<input checked="" type="checkbox"/> <b>THRL-G</b> Garden	<input type="checkbox"/> <b>6</b> 6" <input type="checkbox"/> <b>Cus</b> Custom on request	<input type="checkbox"/> <b>14</b> 14" <input type="checkbox"/> <b>Cus</b> Custom on request	<input checked="" type="checkbox"/> <b>AL</b> Extruded Aluminum
CCT	Wattage / Lumens	Light Distribution	Dimming
<input type="checkbox"/> <b>22</b> 2200K <input type="checkbox"/> <b>30</b> 3000K <input type="checkbox"/> <b>40</b> 4000K <input type="checkbox"/> <b>50</b> 5000K	<input type="checkbox"/> <b>45</b> 9,5 W / 450 lm <input type="checkbox"/> <b>81</b> 17 W / 815 lm <input type="checkbox"/> <b>Cus</b> Custom on request	<input checked="" type="checkbox"/> <b>LD5</b> Type V 360° symmetrical light distribution	<input type="checkbox"/> <b>NN</b> Non-Dimmable <input type="checkbox"/> <b>DM</b> 0-10V
Body Finish Options	Base Finish Options	Mounting	Laser-Cut Pattern
<input type="checkbox"/> <b>ST</b> Standard <input type="checkbox"/> <b>WE</b> Wood effect <input type="checkbox"/> <b>MC</b> Metallic <input type="checkbox"/> <b>Cus</b> Custom on request	<input type="checkbox"/> <b>ST</b> Standard <input type="checkbox"/> <b>WE</b> Wood effect <input type="checkbox"/> <b>MC</b> Metallic <input type="checkbox"/> <b>Cus</b> Custom on request	<input checked="" type="checkbox"/> <b>SM</b> Surface-mounted	<input type="checkbox"/> <b>NB</b> Nebula <input type="checkbox"/> <b>SR</b> Strata <input type="checkbox"/> <b>OB</b> Orbis <input type="checkbox"/> <b>FR</b> Fragment <input type="checkbox"/> <b>PS</b> Pulse <input type="checkbox"/> <b>DR</b> Drift

## Finishes

### Standard finishes

RAL 7004	RAL 7005	RAL 9022	RAL 9023	RAL 9005	RAL 8029	RAL 8015	RAL 8017	RAL 8028	RAL 6013	RAL 6011	RAL 6003
RAL 6006	RAL 9003	RAL 9010	RAL 9016								

**RAL K7 CLASSIC COLORS**  
(80-95% GLOSS): RAL\_ \_ \_ \_

All RAL Classic colors are available with no setup fee.

On your specification submittal, choose your RAL color by entering the 4-digit RAL code (e.g., RAL 3003).

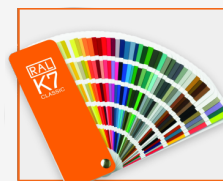

### Wood-effect finishes

WO WHITE OAK	OA OAK	HO HONEY OAK	MP MAPLE	WT WALNUT	MG MAHOGANY	DO DARK OAK	ES ESPRESSO

### Metallic finishes

001 SUNLIT GOLD	003 IMPERIAL GOLD	005 DESERT BRONZE	007 AMBER ALLOY	009 SIENNA BRONZE	014 REDWOOD GLOW	017 AGED CITRON	018 ARCTIC STEEL	019 CARAMEL BRASS	020 CEDAR FLAME	021 CHARRED OAK	023 OBSIDIAN STEEL

## Standard Laser-Cut Shield Designs

Shields are available in both 180° and 360° formats, with options ranging from standardized perforation patterns to fully bespoke designs. Solid 180° configurations can also be provided.

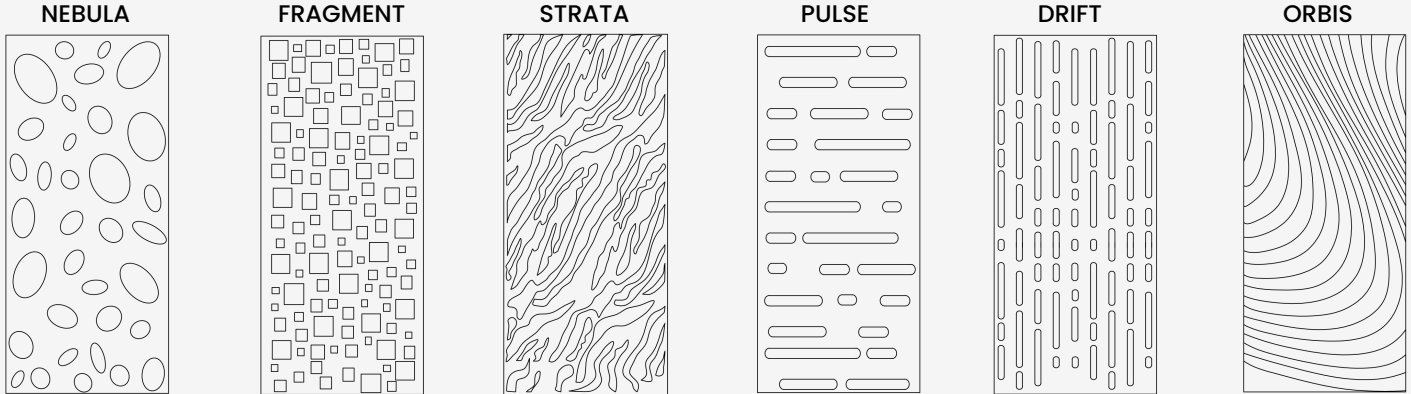

## Bolt Patterns

for Surface-mounted Installation

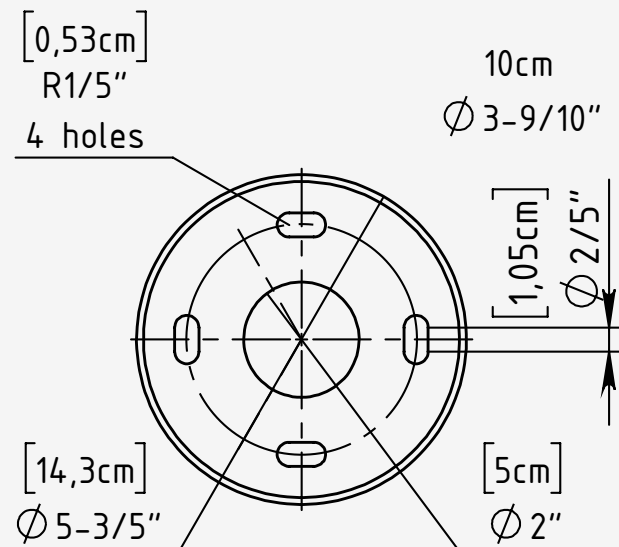

<b>Mounting Type</b>	Surface-mounted
<b>Base Plate Material</b>	Stainless Steel
<b>Bolt Mounting Circle</b>	Ø: 4-7/10"
<b>Number of Anchor Bolt</b>	4 equally holes (90° apart)
<b>Bolt Size</b>	1/4"-20 x 3 1/4" concrete anchor bolt

### Installation Notes:

- Use a manufacturer-supplied base plate to position anchor bolts accurately.
- Ensure bolts are embedded vertically and aligned to avoid fixture tilt.
- Grouting under the base plate is recommended for leveling and load distribution.
- Allow clearance for wiring through the center opening and access to bolt heads if concealed.