



### GENERAL INFORMATION

The QUANTREX SB is a heavy-duty, non-illuminated security bollard engineered to provide reliable impact protection for commercial, industrial, and public-realm environments. Constructed from high-density polyethylene with a reinforced stainless-steel core, it delivers long-lasting durability, corrosion resistance, and excellent energy absorption performance. Designed for both safety and visual clarity, QUANTREX SB withstands vehicle impact loads and maintains its appearance with minimal maintenance, making it ideal for pathways, parking areas, building perimeters, and high-traffic zones.

### SPECIFICATIONS

|          |  |
|----------|--|
| Material | High-density polyethylene / Stainless Steel        |
| Lens     | N/A  |
| Diameter | 5.25" / 6.63"                                      |
| Height   | 40"  |
| Warranty | 5 years  |
| Finishes | Blue, Yellow, Black, Light Grey<br>Stainless Steel |

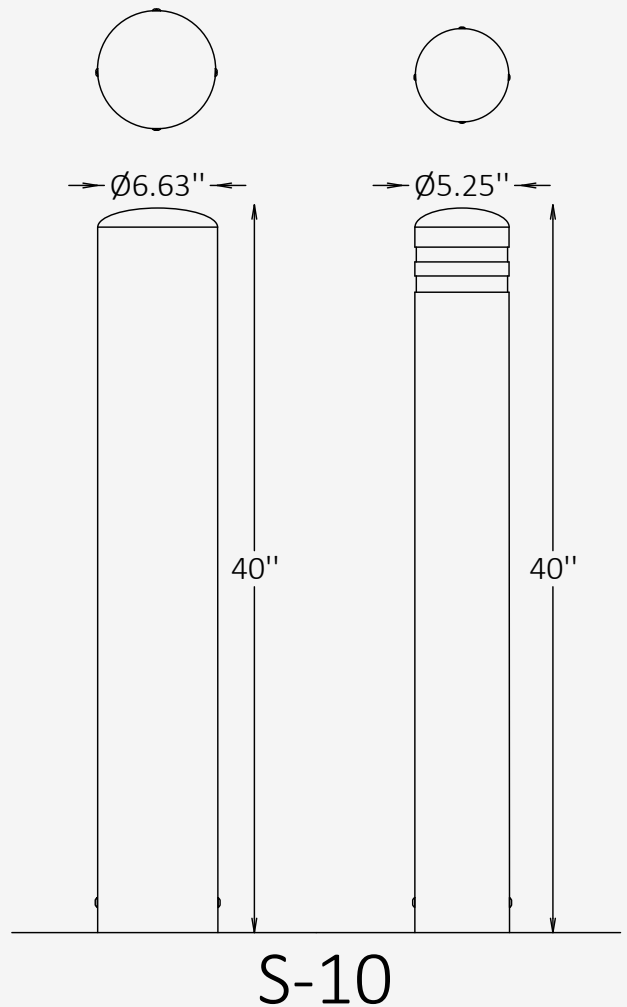
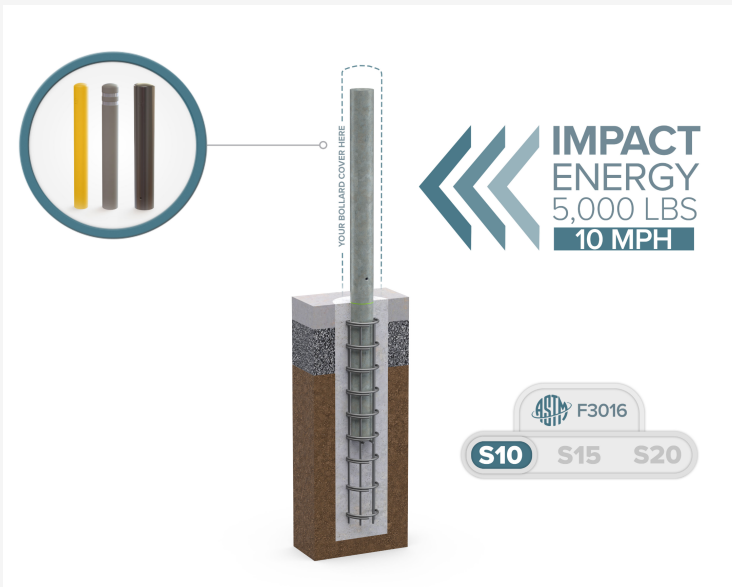

### CERTIFICATION



## Ordering Information

Select one item from each category below. If your desired option is unavailable, please contact our team for support or custom solutions.

| Code  | Cover Type / Diameter / Height  | ASTM Rating   | Cover Finish Option   |
|---|---|---|---|
| <input checked="" type="checkbox"/> <b>QNR-SB</b><br>Non-Lit Security Bollard | <input type="checkbox"/> <b>HDPE</b><br>High-density polyethylene / 5.25" / 40"<br><input type="checkbox"/> <b>HDPE-R</b><br>High-density polyethylene + Reflector / 5.25" / 40"<br><input type="checkbox"/> <b>SS</b><br>Stainless Steel / 6.63" / 40" | <input checked="" type="checkbox"/> <b>S10</b><br>ASTM Rating S10 | <input type="checkbox"/> <b>BU</b><br>Blue<br><input type="checkbox"/> <b>YL</b><br>Yellow<br><input type="checkbox"/> <b>BL</b><br>Black<br><input type="checkbox"/> <b>LGR</b><br>Light Grey<br><input type="checkbox"/> <b>SS</b><br>Stainless Steel<br><small>*Blue, yellow, black, and light gray finishes are only available for HDPE and HDPE-R cover types.</small> |

## Finishes

### Standard cover finishes



### Metallic cover finishes



## Crash-Tested S10 Bollard Mounting Details / Stainless Steel Cover

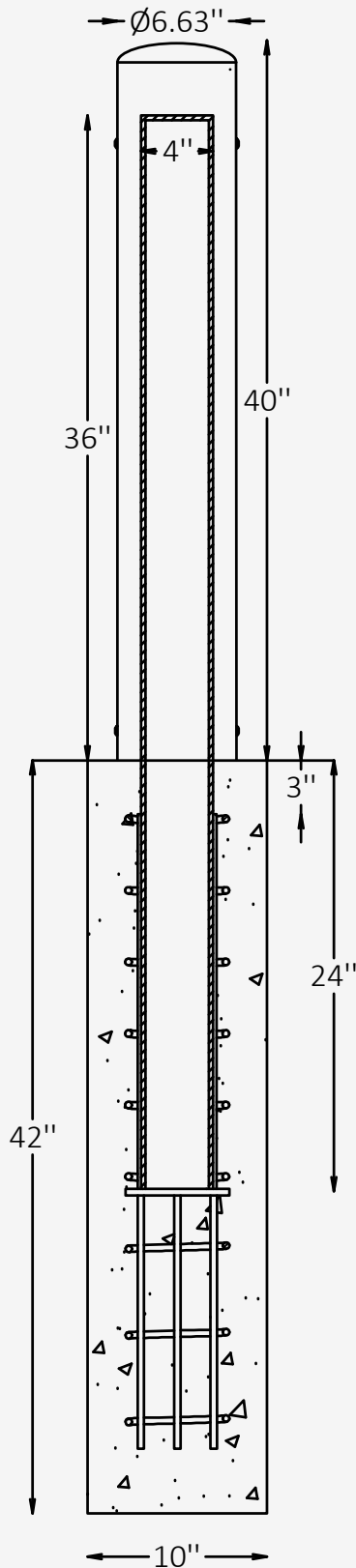

|                       |   |
|-----------------------|---|
| <b>Crash Rating</b>   | ASTM F3016 S10 Crash Rated  |
| <b>Rating Details</b> | Certified to meet ASTM F3016. Tested and proven to stop a 5,000 lb vehicle up to 10 mph.  |
| <b>Minimum qty</b>    | Bollards must be installed in a minimum array of three (3) units to achieve the specified crash rating. A single bollard alone does not meet the tested standard. |

### MINIMUM GROUND CONDITIONS REQUIRED PER ASTM F3016

1a: The concrete is 3000 psi minimum unconfined compressive strength, with one layer of #3 (Ø3/8") rebar spaced at 12" each way, with 1-1/4" cover at bottom. Rebar not shown here.

1b: The base is Type A Grade 1 crushed limestone road base, compacted to 90% of standard proctor density.

1c: The washed sand shall be classified as SP - poorly graded sand & be compacted to a density of not less than 90% maximum dry density

### KITTED SYSTEM

We provide everything but the concrete – core, cover, rebar cage and hardware are all included.

### EASY TO INSTALL

CrashCore Bollards have a simple core drilled installation — so simple you can install one in less than an hour.

## Crash-Tested S10 Bollard Mounting Details / HDPE Cover

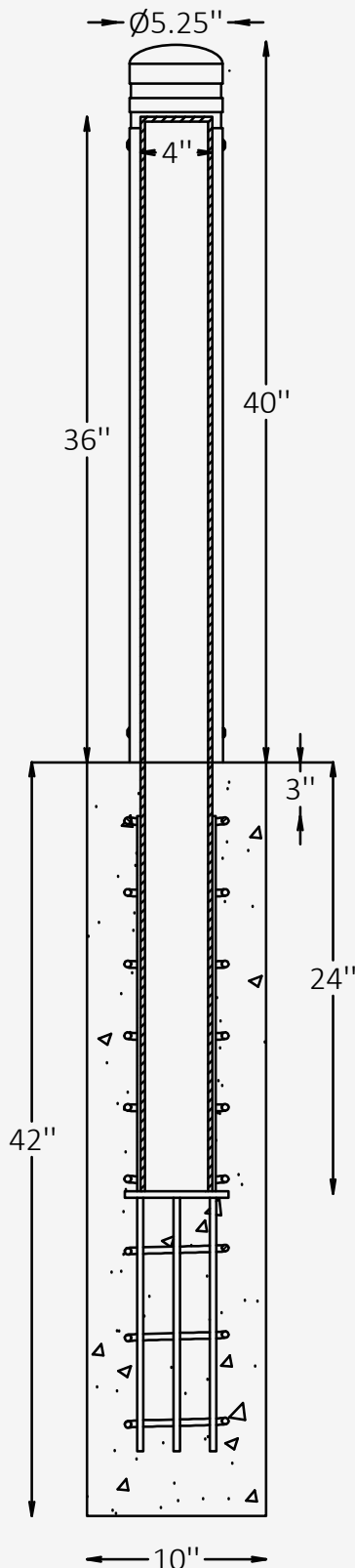

|                       |   |
|-----------------------|---|
| <b>Crash Rating</b>   | ASTM F3016 S10 Crash Rated  |
| <b>Rating Details</b> | Certified to meet ASTM F3016. Tested and proven to stop a 5,000 lb vehicle up to 10 mph.  |
| <b>Minimum qty</b>    | Bollards must be installed in a minimum array of three (3) units to achieve the specified crash rating. A single bollard alone does not meet the tested standard. |

### MINIMUM GROUND CONDITIONS REQUIRED PER ASTM F3016

1a: The concrete is 3000 psi minimum unconfined compressive strength, with one layer of #3 (Ø3/8") rebar spaced at 12" each way, with 1-1/4" cover at bottom. Rebar not shown here.

1b: The base is Type A Grade 1 crushed limestone road base, compacted to 90% of standard proctor density.

1c: The washed sand shall be classified as SP - poorly graded sand & be compacted to a density of not less than 90% maximum dry density

### KITTED SYSTEM

We provide everything but the concrete – core, cover, rebar cage and hardware are all included.

### EASY TO INSTALL

CrashCore Bollards have a simple core drilled installation — so simple you can install one in less than an hour.