

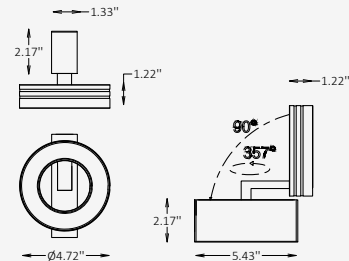

## GENERAL INFORMATION

The A-LOOP SOFT is a circular lighting module for the MODARI A-Track Core magnetic system, providing smooth, uniform illumination within a clean, softened ring profile. Crafted from lightweight aluminum, it brings a sense of fluidity and balance to any track composition. With flexible dimming, multiple CCT options, and an extensive finish palette, A-LOOP SOFT adapts easily to both functional and decorative uses. Its subtle presence enhances modern interiors without overwhelming the space.

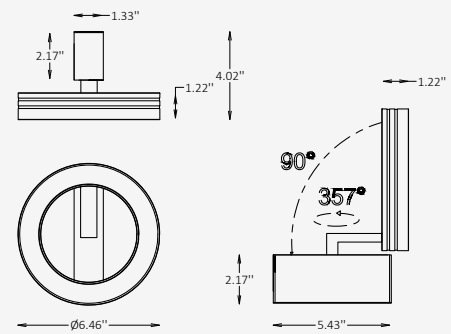

## MODULE SPECIFICATIONS

|                   |  |
|-------------------|--|
| Material          | Aluminum   |
| Lens              | Acrylic, Frosted   |
| Diameter          | 4.72" / 6.46"  |
| Height            | 1.22"  |
| Input Voltage     | DC 24V   |
| Light Source Type | LED  |
| Power             | 12W / 18W  |
| CCT               | 2700K / 3000K / 4000K  |
| CRI               | 80 / 90  |
| Dimming           | Non-Dim / 0-10V / 1-10V / DALI / TRIAC   |
| IP Rating         | IP 20  |
| Warranty          | 5 years  |
| Finishes          | 30 RAL finishes<br>8 wood-effect finishes<br>2 metallic finishes<br>Custom on request* |

## OTHER VERSIONS AVAILABLE

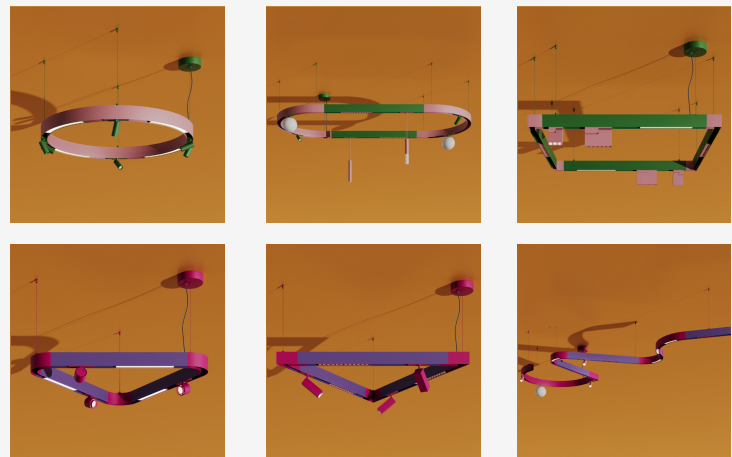

## CERTIFICATION



## A-Loop Soft Module Ordering Information

Select one item from each category below. If your desired option is unavailable, please contact our team for support or custom solutions.

| Code   | Voltage  | Diameter / Height / Wattage / Lumens                               | CCT  |
|--|--|--|--|
| <input checked="" type="checkbox"/> <b>LPS</b><br>A-Loop Soft Module | <input type="checkbox"/> <b>D24</b><br>DC 24V            | <input type="checkbox"/> <b>4</b><br>4.72" / 1.22" / 12 W / 470 lm | <input type="checkbox"/> <b>27</b><br>2700K              |
|  | <input type="checkbox"/> <b>Cus</b><br>Custom on request | <input type="checkbox"/> <b>6</b><br>6.46" / 1.22" / 18 W / 686 lm | <input type="checkbox"/> <b>30</b><br>3000K              |
|  |  |  | <input type="checkbox"/> <b>40</b><br>4000K              |
|  |  |  | <input type="checkbox"/> <b>Cus</b><br>Custom on request |
| Light Distribution   | CRI  | Dimming  | Finish Option  |
| <input checked="" type="checkbox"/> <b>DF</b><br>Diffused            | <input type="checkbox"/> <b>CR8</b><br>80                | <input type="checkbox"/> <b>NN</b><br>Non-Dimmable                 | <input type="checkbox"/> <b>ST</b><br>Standard           |
|  | <input type="checkbox"/> <b>CR9</b><br>90                | <input type="checkbox"/> <b>DM0</b><br>0-10V                       | <input type="checkbox"/> <b>WE</b><br>Wood effect        |
|  |  | <input type="checkbox"/> <b>DM1</b><br>1-10V                       | <input type="checkbox"/> <b>MC</b><br>Metallic           |
|  |  | <input type="checkbox"/> <b>DL</b><br>DALI                         | <input type="checkbox"/> <b>Cus</b><br>Custom on request |
|  |  | <input type="checkbox"/> <b>TR</b><br>TRIAC                        |  |

## A-Loop Soft Module Finishes

### Standard finishes

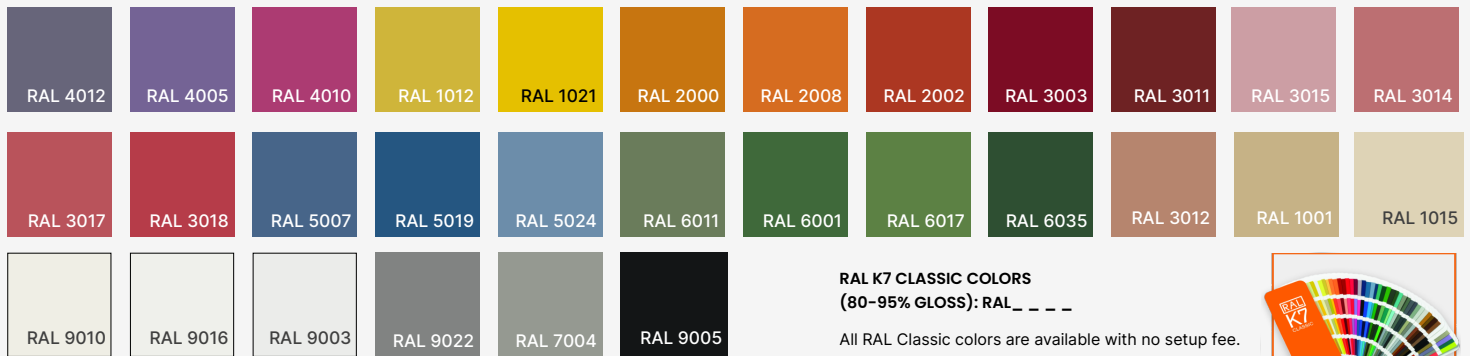

### Wood-effect finishes



### Metallic finishes

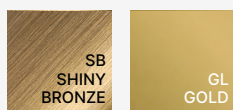

Project

Notes

# Photometric Data

## A-Loop Soft 4

Diffuse

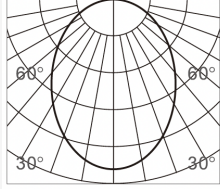

| h(m) | E(lx) | Φ(m)   |
|------|-------|--------|
| 1    | 192   | Φ2.26  |
| 2    | 48    | Φ4.53  |
| 3    | 21    | Φ6.80  |
| 4    | 12    | Φ9.07  |
| 5    | 7     | Φ11.34 |

## A-Loop Soft 6

Diffuse

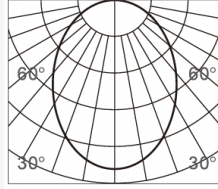

| h(m) | E(lx) | Φ(m)   |
|------|-------|--------|
| 1    | 270   | Φ2.41  |
| 2    | 67    | Φ4.83  |
| 3    | 30    | Φ7.25  |
| 4    | 16    | Φ9.66  |
| 5    | 10    | Φ12.08 |