



B CLASSIC

**A versatile solution:
effective and essential**



Load versatility

The 17 and 22-litre models are supplied with five trays and can house up to three drawers. The 28-litre version is supplied with six trays and can house up to four drawers. Loading is made even more versatile by the **Modular Tray Holder**, an optional accessory that maximises configurability.



Design and cleanability

Essential yet state-of-the-art autoclave design combines aesthetics with practicality. All surfaces ensure the highest degree of sanitisation while the glass touchscreen combines maximum **hygiene** with outstanding **functionality**. Style and practicality, to deliver a cutting-edge sterilization experience.



User-friendly display

The **3.2"** touchscreen ensures effective, intuitive control, allowing users to run the entire sterilization process with the utmost simplicity. Clear and simple graphics make it easy to use the various functions, smoothing every single step.

Designed to be versatile

Modern design and three different volumes ensure maximum flexibility.

This guarantees excellent chamber volume configurability without affecting the external dimensions of the autoclave. Easy-to-clean surfaces and a user-friendly display provide outstanding daily practicality. This versatile, hygienic design maximises convenience without compromising the effectiveness or quality of the sterilization procedures. The outcome: a perfect balance between functionality and ease of use.



Three volumes, one size

The available volumes are **17, 22 and 28** litres. Three different capacities let users select the machine that best suits their needs. The external dimensions - identical on all three machines - make installation easy, even when recessed, minimising the space occupied on worktops.

User-friendly traceability and advanced connectivity

Managing autoclaves, cycle reports and remote technical assistance.

Advanced process reporting controls with automatic software downloads and full Wi-Fi/Ethernet port connectivity can link the machine to Cloud platforms, allowing remote control of the autoclave. Note also that an external barcode printer can be connected.



Downloadable cycle reports

Cycle reports are generated at the end of each cycle and automatically saved on the autoclave memory. Up to 10,000 cycles can be saved. These can be downloaded in PDF format using the USB port on the front of the machine. The **DataSter** software supplied with the machine allows direct automatic downloading of reports to a network or PC folder.



Di.V.A.

Di.V.A. is an optional Cloud environment for sterilization devices. All saved data is made available to operators, allowing them to:

- view reports of completed cycles
- check device efficiency and status
- access video tutorials and user manuals
- consult machine usage statistics.



EasyCheck

An optional in-Cloud platform that delivers remote technical support and significantly reduces service times, **EasyCheck** guarantees efficiency and reliability. Software updates, maintenance interval checks, remote verification of components and sensors, etc. EasyCheck ensures long-lasting autoclave performance.



Traceability software

MyTrace is an optional software for autoclaves. Installable on a practice PC, it's used to associate sterilized instrument sets with patients via a barcode. A cycle archive, a patient list and sterile instrument association make MyTrace an irreplaceable tool for completing the traceability process and ensuring legal protection for the dentist.



Printer

To complete the range, an optional external printer for producing reports or **barcode labels** is available. A useful tool that completes the traceability process and allows pairing of sterilization cycle and sterile instruments.



User ID

Once **operator ID** management has been activated, the device can only be accessed by authorised personnel. Entering a PIN enables the usage chronology function, providing accurate process control. This ensures safe, monitored machine management, creating a controlled, reliable sterilization environment.



Test and maintenance reminder

It's also possible to activate reminders to perform routine tests. These notify the operator of the need to perform **periodic sterilizer tests**: Vacuum Test and Helix - Bowie & Dick Test. At the same time, **maintenance deadline** warnings will be displayed to maximise device efficiency and operability.



Custom cycle

The autoclave has a customisable cycle that lets operators safely adapt the sterilization cycle to the specific needs of the dental practice. By selecting from a pre-set range of legally compliant values, a **custom cycle** can be set up to optimise the process, ensuring the flexibility and precision needed to meet the requirements of different working conditions.

Optimised workflow

User-friendly machine control ensures maximum performance, efficiency and practicality.

Cycle customization, user access tools and reminders provide full control, maximising efficiency and safety.

Ease of use and precision settings ensure a reliable, complete experience with full control of the sterilization process.



Delayed start and extra drying

The **delayed start** option lets users program cycle start times to rationalise the way the machine is used.

The **extra drying** function lets users set customised drying times to cope with difficult loads.

Automated sterilization protocol

The Mocom response to ensure correct implementation of sterilization protocols and protection of patients and health workers.



Collection



1

COLLECTION

The sterilization protocol begins with collecting instruments and materials.



Disinfection



Washing



Rinsing



Drying



2

TETHYS H10

Designed to give you the best. The best performance in a simple and fast workflow. An innovative thermal disinfectant that replaces the numerous manual tasks typical of the stages preceding sterilization, thus reducing workloads. Equipped with the optional HMD accessory, Tethys H10 extends the reconditioning process to rotating instruments, resulting in unparalleled performance.

3

4

5



Inspection and maintenance



6

THALYA - THALYA PLUS

Thalya is the dentist's ally for effective maintenance of rotary instruments. Simple and user-friendly, it allows perfect lubrication and purge maintenance of turbines and handpieces. In the Thalya Plus version, the instruments also undergo a cleaning, disinfection and drying process within a single cycle.



Packaging



7

MILLSEAL

This thermal sealer range meets every possible need. The EVO version allows the automated creation of pouches. The Rolling version, also available with printer, combines sealing speed with flexible sizing of the packages to be sealed. The Manual version delivers user-friendliness and outstanding reliability.



Sterilization



8

AUTOCLAVES

Mocom autoclaves, available in 17, 22 and 28-litre versions, simplify the operator's work by optimising time and costs. Their excellent quality and high-level functions ensure safety, reliability and ease of use.



Traceability



9

MYTRACE

MyTrace is a traceability software that allows users to associate a set of sterilized dental instruments with a patient by reading the barcode or QR code.



Storage



10

STORAGE

If carried out correctly, storage ensures long-lasting instrument sterility.



Technical specifications	B Classic 17	B Classic 22	B Classic 28
Power supply	2220/240 V 50Hz 220/230 V 60Hz		
Rated power	2300 W		
External dimensions (L x H x D)	500 x 490 x 600 mm		
Chamber dimensions (Diam. x Depth)	250 x 350 mm	250 x 450 mm	280 x 450 mm
Total weight	46 kg	49 kg	50 kg
Tank capacity	6l		
Autonomy	From 9 to 13 cycles	From 8 to 12 cycles	From 7 to 11 cycles

Sterilization cycles 220/240 V					
CYCLE	Cycle type	Sterilization time	B Classic 17	B Classic 22	B Classic 28
		(min.)	Cycle times including sterilization times and drying time (min.)*		
134 °C Universal	B	4	42	46	56
121 °C Universal	B	20	58	63	69
134 °C fast	S	4	22	25	28
134 °C Packed solid instruments	S	4	34	39	45
134 °C Prion	B	18	56	60	70
Xxx °C Custom	S	Users can personalise the cycle with temperatures of 134 °C/121 °C, sterilization times starting from 4' (134 °C) or 20' (121 °C) and drying times from 5 to 30 min.			
Vacuum Test		TEST	18	18	19
Helix/B&D Test		TEST	20	24	28
Vacuum Test + Helix/B&D Test (run in sequence)		TEST	42	46	51

* Drying varies according to machine model and volume
Note: times do not take the pre-heat time into account (1-20 min.)

Note: the indicated times are based on an average load
Note: times may vary depending on the load and power supply

Accessories

A complete array of accessories to expand the B Classic function range.

- 1

External printer
Connected to B Classic sterilizers, lets you print cycle-related data on thermal paper or on labels in Barcode format.
- 4

EV aux kit
This kit allows the sterilizer to be interfaced with surgery demineralising systems so the sterilizer only draws water from the system as and when necessary.
- 7

Pure 100
This system, equipped with two ion exchange resins, eliminates the ions that contaminate mains water, allowing for the production of high-quality demineralised water. The device is fully controlled by the sterilizer.
- 2

Front filling kit
This kit allows the sterilizer to be filled frontally via a quick coupling.
- 5

Modular tray holder
Modular housing system to load the sterilizer. Supplied with three pairs of shelves to house trays: lets you make full use of the entire chamber diameter and insert even the bulkiest loads.
- 8

Pure 500
The demineraliser features reverse osmosis technology; this lets users eliminate organic and inorganic substances dissolved in the water to produce water that is ideal for sterilization purposes. The device is fully controlled by the sterilizer.
- 3

Automatic filling kit
Consists of an external pump powered by the sterilizer, allows demineralised water to be drawn from an external recipient.
- 6

Barcode reader
The barcode reader - which can be used on most PCs - lets you complete the traceability process and pair Barcode labels with the patient.
- 9

Twin Pure 500 kit
This Kit allows the Pure 500 demineraliser to be used on two autoclaves simultaneously.



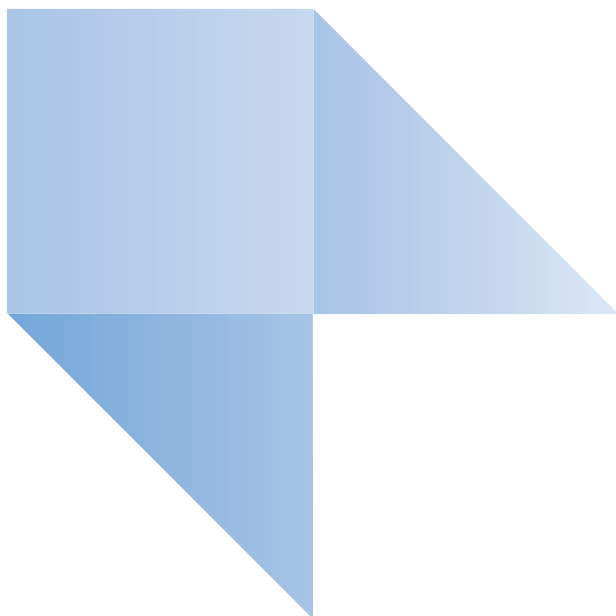

04/2025

MBCLCB1241S00

Cefla s.c. reserves the right to modify the products illustrated in the photos without prior notice. According to the standards in force, in extra-EU areas the availability and specifications of some products and/or characteristics may vary. Please contact your local distributor for further information.



**BU Medical Equipment
Sede Legale ed
Amministrativa
Headquarters**

CEFLA s.c.
Via Selice Provinciale, 23/a
40026 Imola (BO) - Italy
Tel. +39 0542 653111
Fax +39 0542 653344

Stabilimento / Plant

Via Bicocca, 14/C
40026 Imola (BO) - Italy
Tel. +39 0542 653441
Fax +39 0542 653601
www.mocom.it





S CLASSIC

**The efficiency
of simplicity**

Reliable and safe

Streamlines sterilization tasks.

The S Classic has been designed to make work easier by optimising times and costs. Exceptional quality and practicality ensure exceptional safety and reliability. Easy to use, this sterilizer provides full traceability of every single sterilization cycle.

Users can choose between two chamber volumes (17 and 22 litres); their external dimensions are the same, making installation easy in any facility.



Operational control

The 3.2" touchscreen provides comprehensive information on sterilizer usage and status. Users can manage functions and customise the device to maximise its efficiency; an advanced on-screen messaging system completes the interfacing.



Sterilization cycles

S Classic offers five different sterilization cycles, three S types and two N types: these allow, respectively, fast sterilization of wrapped solid instruments and non-wrapped solid instruments. The sterilizer also features an additional cycle, fully customisable by the operator, which maximises flexibility of use.



Water management

Complete with level monitoring sensors, the fill-drain reservoirs are protected by a large easy-to-remove panel, simplifying access, inspection and sanitisation. The frontal quick coupling provides an alternative filling method to top filling. Two additional quick couplings allow the reservoirs to be emptied.



Printers and USB port

All data concerning cycles performed on the sterilizer is recorded on the internal memory and can be downloaded onto a PC in PDF format using any USB stick. The S Classic can be equipped with an external printer (optional), connected via an RS232 serial port; this can be used to print off completed cycle data on thermal paper or to print Barcode labels.

Technical specifications	S Classic 17	S Classic 22
Power supply	220/240 V 50Hz 220/230 V 60Hz	
Rated power	2300 W	
External dimensions (L x H x D)	500 x 490 x 600 mm	
Chamber dimensions (Diam. x Depth)	250 x 350 mm	250 x 450 mm
Total weight	46 kg	49 kg
Tank capacity	6l	
Autonomy	From 9 to 13 cycles	From 8 to 12 cycles

Sterilization cycles 220/240 V				
CYCLE	Cycle type	Sterilization time	S Classic 17	S Classic 22
		(min.)	Cycle times including sterilization times and drying time (min.)*	
134 °C Packed solid instruments	S	4	40	42
121 °C Packed solid instruments	S	20	55	57
134 °C Prion	S	4	54	56
134 °C Unpacked solid instruments	N	4	32	33
121 °C Unpacked solid instruments	N	20	47	48
xxx °C CUSTOM	S	Users can personalise the cycle with temperatures of 134 °C/121 °C, sterilization times starting from 4' (134 °C) or 20' (121 °C) and drying times from 5 to 30 min.		
Vacuum Test	TEST		23	23

* Drying varies according to machine model and volume
 Note: times do not take the pre-heat time into account (1-20 min.)
 Note: the indicated times are based on an average load
 Note: times may vary depending on the load and power supply

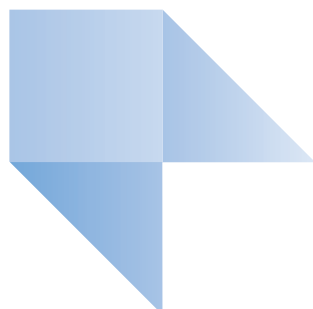

BU Medical Equipment
Sede Legale ed
Amministrativa
Headquarters
CEFLA s.c.
 Via Selice Provinciale, 23/a
 40026 Imola (BO) - Italy
 Tel. +39 0542 653111
 Fax +39 0542 653344



Stabilimento / Plant
 Via Bicocca, 14/C
 40026 Imola (BO) - Italy
 Tel. +39 0542 653441
 Fax +39 0542 653601
www.mocom.it





B FUTURA

**High-performance technology:
practical and flexible**

Efficiency and flexibility

High performance enclosed in modern design

State-of-the-art design that seamlessly combines versatility and hygiene. Easily cleanable surfaces, a user-friendly display and optimised functions ensure everyday practicality, boosting the effectiveness and quality of sterilization procedures.



Water management

The **integrated demineralising filter** lets you supply the sterilizer with normal mains water without any need for external treatment devices. The main advantages: rationalised spaces, streamlined processes, significant savings. Sensors monitor the quality of the demineralised water provided by the integrated filter. Users receive messages on filter status, ensuring autoclave efficiency at all times.

Renewed design

External surfaces have precise joints and fewer attachment points, improving hygiene. The glass touchscreen control panel combines practicality with cleanliness by allowing complete sanitisation of surfaces. Merging great design with practicality, the **distinctive indicator light** on the front of the device clearly indicates sterilizer status. When the door opens, LED lighting is activated, illuminating the work area.



Cycle times and Modular Drying

This autoclave meets the needs of even the most demanding users. Combining reliable high-performance internal components with a control system that optimises each phase reduces sterilization cycle times. The exclusive **Modular Drying** function lets users select the load quantity to be sterilized. This adapts the duration of the drying phase, thus shortening cycle times. A complete B cycle in just 31 minutes.



Versatile installation

Customers can continue to count on a choice of **3 different volumes** - 17, 22 and 28 litres - that have the same external dimensions. Optimal sterilizer design and sizing allow easy installation on normal worktops or inside the columns designed to house these devices.





Custom cycle

The autoclave has a customisable cycle that lets operators safely adapt the sterilization cycle to the specific needs of the dental practice. By selecting from a pre-set range of legally compliant values, a **custom cycle** can be set up to optimise the process, ensuring the flexibility and precision needed to meet the requirements of different working conditions.



Reminders

Regular testing is vital for excellent long-term performance. Test programmes - Vacuum Test, Helix-Bowie & Dick Test - must, like periodic maintenance, be carried out at scheduled intervals. To ensure this is so, **test reminders and scheduled maintenance reminders** are displayed on the screen, ensuring these tasks are performed as scheduled.



Delayed start and extra drying

The **delayed start** option lets users program cycle start times to rationalise the way the machine is used. The **extra drying** function lets users set customised drying times to cope with difficult loads.

Clear, user-friendly communication

5" colour touchscreen provides a simple yet complete interface

The new touchscreen interface organises all the control functions into easy-to-use menus. Everything - from the choice of sterilization cycles to device configuration and customisation of numerous functions - is presented using simple, intuitively understandable graphics.



Touchscreen and video tutorials

The **5" touchscreen** streamlines day-to-day use of the sterilizer through quick responsiveness to commands and user-friendly organisation of all the functions. The high-performance display can also be used to view **video tutorials**, providing a clear visual guide on how to use the sterilizer correctly. To make the most of sterilizer performance, users can also consult the manual at any time.

Connectivity and data management

Integrated Wi-Fi and Cloud platforms for remote assistance and optimised control

Connecting the autoclave to the network via the integrated Wi-Fi system or Ethernet connection links the sterilizer to an integrated data management system, essential for advanced traceability. Users can also take advantage of other features such as automatically saved cycle reports, local or remote consultation and printer management.



Di.V.A.

Di.V.A. is an optional Cloud environment for sterilization devices. All saved data is made available to operators, allowing them to:

- view reports of completed cycles
- check device efficiency and status
- access video tutorials and user manuals
- consult machine usage statistics



SterilConnect

A **highly innovative tool** users will appreciate. Any network-connected mobile device - tablet or smartphone - can be used to interact with the autoclave, simplifying daily management of the sterilization process. A simple yet complete graphic interface lets you monitor device status and manage the various sterilizer functions.



EasyCheck

An optional in-Cloud platform that delivers remote technical support and significantly reduces service times, **EasyCheck** guarantees efficiency and reliability. Software updates, maintenance interval checks, remote verification of components and sensors, etc. EasyCheck ensures long-lasting autoclave performance.



Shared printer

The optional printer lets you complete the sterilization process performed with the autoclave. To optimise management, the **printer can be shared** by multiple sterilizers, where enabled, and connected to the same network. One fast, reliable printing station rationalises use of space and delivers significant savings.



QR code labels

Activating this function lets users create adhesive **QR code** labels to apply to sterile packages at the end of each cycle. The QR code contains unique information that identifies the sterilizer, the cycle used, its outcome and the expiry date of the sterile package. It's also possible to print Barcode labels and cycle reports.

Automated sterilization protocol

The Mocom response to ensure correct implementation of sterilization protocols and protection of patients and health workers.



Collection

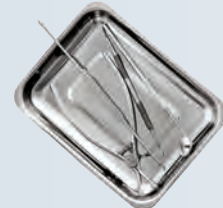

1 COLLECTION

The sterilization protocol begins with collecting instruments and materials.



Disinfection



Washing



Rinsing



Drying



2 TETHYS H10

Designed to give you the best. The best performance in a simple and fast workflow. An innovative thermal disinfectant that replaces the numerous manual tasks typical of the stages preceding sterilization, thus reducing workloads. Equipped with the optional HMD accessory, Tethys H10 extends the reconditioning process to rotating instruments, resulting in unparalleled performance.



Inspection and maintenance



6 THALYA - THALYA PLUS

Thalya is the dentist's ally for effective maintenance of rotary instruments. Simple and user-friendly, it allows perfect lubrication and purge maintenance of turbines and handpieces. In the Thalya Plus version, the instruments also undergo a cleaning, disinfection and drying process within a single cycle.



Packaging



7 MILLSEAL

This thermal sealer range meets every possible need. The EVO version allows the automated creation of pouches. The Rolling version, also available with printer, combines sealing speed with flexible sizing of the packages to be sealed. The Manual version delivers user-friendliness and outstanding reliability.



Sterilization



8 AUTOCLAVES

Mocom autoclaves, available in 17, 22 and 28-litre versions, simplify the operator's work by optimising time and costs. Their excellent quality and high-level functions ensure safety, reliability and ease of use.



Traceability



9 MYTRACE

MyTrace is a traceability software that allows users to associate a set of sterilized dental instruments with a patient by reading the barcode or QR code.



Storage



10 STORAGE

If carried out correctly, storage ensures long-lasting instrument sterility.

Accessories

A complete array of accessories to expand the B Futura function range.

- 1

External printer
Connected to B Futura sterilizers, lets you print cycle-related data on thermal paper or on labels in Barcode or QR code format. To optimise management, the printer can be shared by multiple sterilizers (where enabled) and connected to the same network.
- 2

Front filling kit
This kit allows the sterilizer to be filled frontally via a quick coupling.
- 3

Automatic filling kit
Consists of an external pump powered by the sterilizer, allows demineralised water to be drawn from an external recipient.
- 4

EV aux kit
This kit allows the sterilizer to be interfaced with surgery demineralising systems so the sterilizer only draws water from the system as and when necessary.
- 5

Modular tray holder
Modular housing system to load the sterilizer. Supplied with three pairs of shelves to house trays: lets you make full use of the entire chamber diameter and insert even the bulkiest loads.
- 6

Barcode/QR code reader.
The reader - which can be used on most PCs - lets you complete the traceability process and pair Barcode or QR code labels with the patient.

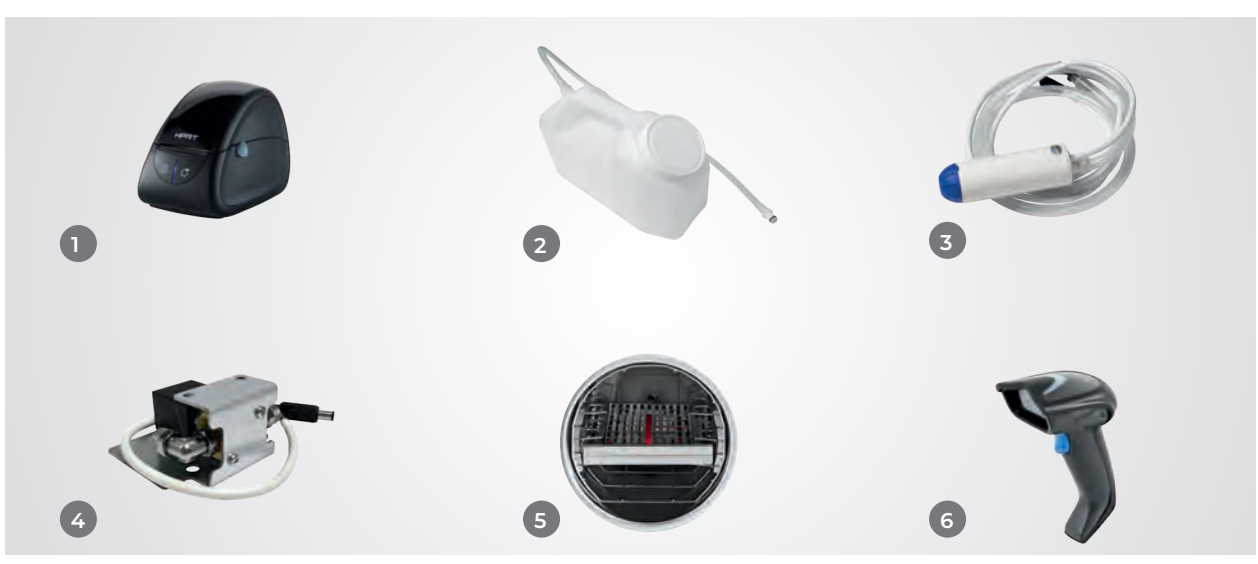

Technical specifications	B Futura 17	B Futura 22	B Futura 28
Power supply	2220/240 V 50Hz 220/230 V 60Hz		
Rated power	2300 W		
External dimensions (L x H x D)	500 x 490 x 600 mm		
Chamber dimensions (Diam. x Depth)	250 x 350 mm	250 x 450 mm	280 x 450 mm
Total weight	47 kg	50 kg	51 kg
Tank capacity	6l		
Autonomy	From 7 to 11 cycles	From 6 to 10 cycles	From 5 to 9 cycles

Sterilization cycles 220/240 V					
CYCLE	Cycle type	Sterilization time	B Futura 17	B Futura 22	B Futura 28
		(min.)	Cycle times including sterilization times and drying time (min.)*		
134 °C Universal	B	4	39 (31)	42 (34)	52 (44)
121 °C Universal	B	20	53 (45)	59 (51)	63 (55)
134 °C fast	S	4	21	24	27
134 °C Packed solid instruments	S	4	32 (25)	37 (30)	41 (34)
134 °C Prion	B	18	53 (45)	57 (49)	67 (59)
Xxx °C Custom	S	Users can personalise the cycle with temperatures of 134 °C/121 °C, sterilization times starting from 4' (134 °C) or 20' (121 °C) and drying times from 5 to 30 min.			
Vacuum Test		TEST	18	18	19
Helix/B&D Test		TEST	20	24	28
Vacuum Test + Helix/B&D Test (run in sequence)		TEST	42	46	51

* Drying varies according to machine model and volume
Note: times in brackets show performance with modular drying activated, observing the indicated loads

Note: times do not take the pre-heat time into account
Note: the indicated times are based on an average load
Note: times may vary depending on the load and power supply

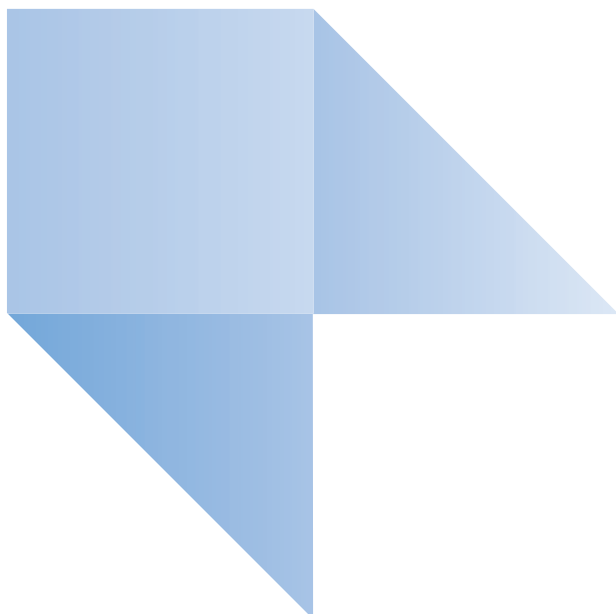

04/2025

MBFUCB1241S00

Cefla s.c. reserves the right to modify the products illustrated in the photos without prior notice. According to the standards in force, in extra-EU areas the availability and specifications of some products and/or characteristics may vary. Please contact your local distributor for further information.



**BU Medical Equipment
Sede Legale ed
Amministrativa
Headquarters**

CEFLA s.c.
Via Selice Provinciale, 23/a
40026 Imola (BO) - Italy
Tel. +39 0542 653111
Fax +39 0542 653344

Stabilimento / Plant

Via Bicocca, 14/C
40026 Imola (BO) - Italy
Tel. +39 0542 653441
Fax +39 0542 653601
www.mocom.it





SUPREME

**Top-tier sterilization:
performance and sustainability**

Water savings

50 sterilization cycles with only 5 litres of mains water.

Uses normal mains water and can retrieve used water to employ it in subsequent sterilization cycles. These features minimise waste, reduce costs and significantly increase efficiency, eliminating any demineralised water supply-storage problems.



Treating used water

The **recirculation filter** incorporated in the secondary reservoir allows used water to be demineralised and purified. This process makes it reusable in subsequent sterilization cycles and automatically controls the water delivery reservoir. Just 5 litres of mains water are needed to perform 50 sterilization cycles: a market-leading specific consumption of just 100 ml/cycle.



Water quality control

The built-in conductivity sensor ensures compliance with **water quality** parameters, protecting the internal components of the device. It also monitors the status of the filtration system. Clear messages on the display inform the user when the filters need replacing.



Replacing the filters

Easy access to the reservoirs and carefully designed filter ergonomics make replacement easy. After being informed by the on-screen messaging system that the filters need replacing, the user can follow the instructions contained in the preloaded video tutorials and proceed independently with replacement of **integrated filters**.



Integrated demineralisation

A **demineralisation filter** housed in the main tank lets users fill the reservoir with ordinary mains water, resulting in excellent rationalisation of the available space, streamlined processes and significant savings. Moreover, the filtration system delivers never-before-seen operational simplicity. To make water management even easier, optional automatic filling systems are available.

Ease of use and high performance

The 7" touchscreen is as simple and user-friendly as a tablet.

Screen size and performance - plus meticulous design of the user interface - allow users to start sterilizing immediately with ease.

Video tutorials and luminous indicators put it in a class of its own.

The adopted components and the advanced control software provide outstanding performance.



LED bar

The device also communicates using light. The **LED bar incorporated** in the door provides immediate information on machine status by varying the colours according to the phase of operation. Consequently, users can see which phase of the process the autoclave is performing at a glance, even from some distance away.



Shorter cycle times and Modular Drying

This sterilizer meets the needs of even the most demanding users. Reliable high-performance internal components and a control system that optimises each phase **reduce sterilization cycle times**. The exclusive **Modular Drying** function lets users select the load quantity to be sterilized. This adapts the duration of the drying phase, thus shortening cycle times. A complete B cycle in just 31 minutes.



NFC - Near Field Communication

The **NFC sensor** simplifies the assistant's workflow. Activating user ID ensures only authorised personnel can access the machine functions. To activate, simply bring the NFC card, supplied with the sterilizer and associated with the user, up to the machine.



Video tutorials, on-display info

High-resolution images make the **7" display** a valuable tool for all users. Simple **video tutorials** provide important use and maintenance instructions. A full complement of information - from indications on load positioning to instructions for periodic maintenance - is readily accessible on the machine. What's more, cycle reports saved on the autoclave memory can be viewed on the screen.



Customisable sterilization cycles

The autoclave has five sterilization cycles with pre-set parameters plus a **custom cycle** that can be personalised by the user. Additional functions allow the sterilizer to be used more effectively. The **delayed start** function lets you programme a deferred cycle start; the **extra drying** function is useful with particularly difficult loads as it lets you extend drying times.



Di.V.A.

Di.V.A. is an optional Cloud environment for sterilization devices. All saved data is made available to operators, allowing them to:

- view reports of completed cycles
- check device efficiency and status
- access video tutorials and user manuals
- consult machine usage statistics

Connectivity and data management

Integrated Wi-Fi, Cloud platforms for remote assistance and a mobile APP for optimised management.

Connecting Supreme to the network via the integrated Wi-Fi system or Ethernet links the sterilizer to an integrated data management system, essential for advanced traceability. Users can also take advantage of other features such as automatically saved cycle reports, local or remote consultation and printer management.



EasyCheck

An optional in-Cloud platform that delivers remote technical support and significantly reduces service times, **EasyCheck** guarantees efficiency and reliability. Software updates, maintenance interval checks, remote verification of components and sensors are just some of the tools available to ensure long-lasting autoclave performance.



SterilConnect

A **highly innovative tool** users will appreciate. Any network-connected mobile device - tablet or smartphone - can be used to interact with the autoclave, simplifying daily management of the sterilization process. A clear yet complete graphic interface lets you monitor device status and manage the various sterilizer functions.



QR code labels

Activating this function lets users create adhesive QR code labels to apply to sterile packages at the end of each cycle. **The QR code** contains unique information that identifies the sterilizer, the cycle used, its outcome and the expiry date of the sterile package. Scanning the QR code lets you associate the data it contains with the patient, ensuring comprehensive traceability. It's also possible to print Barcode labels.



Shared printer

By producing labels or reports, the optional printer allows completion of the sterilization process, providing users with the basis for proper traceability. To optimise management, the **printer can be shared** by multiple sterilizers, where enabled, and connected to the same network. One fast, reliable printing station rationalises use of space and delivers significant savings.

Automated sterilization protocol

The Mocom response to ensure correct implementation of sterilization protocols and protection of patients and health workers.



Collection

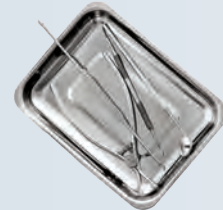

1

COLLECTION

The sterilization protocol begins with collecting instruments and materials.



Disinfection



Washing



Rinsing



Drying



2

TETHYS H10

Designed to give you the best. The best performance in a simple and fast work-flow. An innovative thermal disinfectant that replaces the numerous manual tasks typical of the stages preceding sterilization, thus reducing the workloads. Equipped with the optional HMD accessory, Tethys H10 extends the reconditioning process to rotating instruments, resulting in unparalleled performance.

3

4

5



Inspection and maintenance



6

THALYA - THALYA PLUS

Thalya is the dentist's ally for effective maintenance of rotary instruments. Simple and user-friendly, it allows perfect lubrication and purge maintenance of turbines and handpieces. In the Thalya Plus version, the instruments also undergo a cleaning, disinfection and drying process within a single cycle.



Packaging

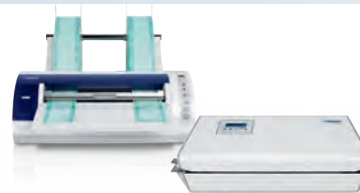

7

MILLSEAL

This thermal sealer range meets every possible need. The EVO version allows the automated creation of pouches. The Rolling version, also available with printer, combines sealing speed with flexible sizing of the packages to be sealed. The Manual version delivers user-friendliness and outstanding reliability.



Sterilization



8

AUTOCLAVES

Mocom autoclaves, available in 17, 22 and 28-litre versions, simplify the operator's work by optimising time and costs. Their excellent quality and high-level functions ensure safety, reliability and ease of use.



Traceability



9

MYTRACE

MyTrace is a traceability software that allows users to associate a set of sterilized dental instruments with a patient by reading the barcode or QR code.



Storage



10

STORAGE

If carried out correctly, storage ensures long-lasting the instrument sterility.

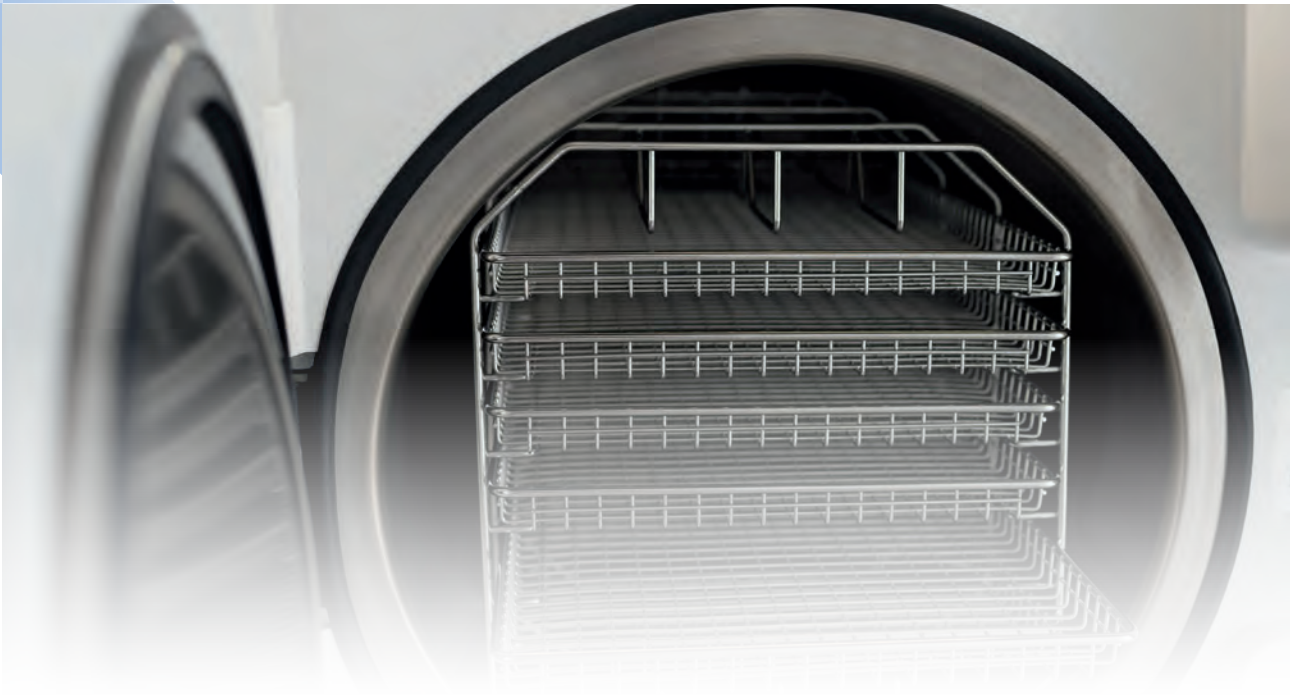

Technical data	Supreme 17	Supreme 22	Supreme 28
Power supply	2220/240 V 50Hz 220/230 V 60Hz		
Rated power	2300 W		
External dimensions (L x H x D)	500 x 490 x 600 mm		
Chamber dimensions (Diam. x Depth)	250 x 350 mm	250 x 450 mm	280 x 450 mm
Total weight	47 kg	50 kg	51 kg
Tank capacity	6l		
Autonomy	From 7 to 11 cycles	From 6 to 10 cycles	From 5 to 9 cycles

Sterilization cycles 220/240 V					
CYCLE	Cycle type	Sterilization time	Supreme 17	Supreme 22	Supreme 28
		(min.)	Cycle times including sterilization times and drying time (min.)*		
134 °C Universal	B	4	39 (31)	42 (34)	52 (44)
121 °C Universal	B	20	53 (45)	59 (51)	63 (55)
134 °C fast	S	4	21	24	27
134 °C Packed solid instruments	S	4	32 (25)	37 (30)	41 (34)
134 °C Prion	B	18	53 (45)	57 (49)	67 (59)
Xxx °C Custom	S	Users can personalise the cycle with temperatures of 134 °C/121 °C, sterilization times starting from 4' (134 °C) or 20' (121 °C) and drying times from 5 to 30 min.			
Vacuum Test		TEST	18	18	19
Helix/B&D Test		TEST	20	24	28
Vacuum Test + Helix/B&D Test (run in sequence)		TEST	42	46	51

* Drying varies according to machine model and volume

Note: times in brackets show performance with modular drying activated, observing the indicated loads

Note: times do not take the pre-heat time into account

Note: the indicated times are based on an average load

Note: times may vary depending on the load and power supply

Accessories

A complete array of accessories to expand the Supreme function range.

- 1

External printer
Connected to Supreme sterilizers, lets you print cycle-related data on thermal paper or on labels in Barcode or QR code format. To optimise management, the printer can be shared by multiple sterilizers (where enabled) and connected to the same network.
- 2

Front filling kit
This kit allows the sterilizer to be filled frontally via a quick coupling.
- 3

Automatic filling kit
Consists of an external pump powered by the sterilizer, allows demineralised water to be drawn from an external recipient.
- 4

EV aux kit
This kit allows the sterilizer to be interfaced with surgery demineralising systems so the sterilizer only draws water from the system as and when necessary.
- 5

Modular tray holder
Modular housing system to load the sterilizer. Supplied with three pairs of shelves to house trays: lets you make full use of the entire chamber diameter and insert even the bulkiest loads.
- 6

Barcode/QR code reader.
The reader - which can be used on most PCs - lets you complete the traceability process and pair Barcode or QR code labels with the patient.

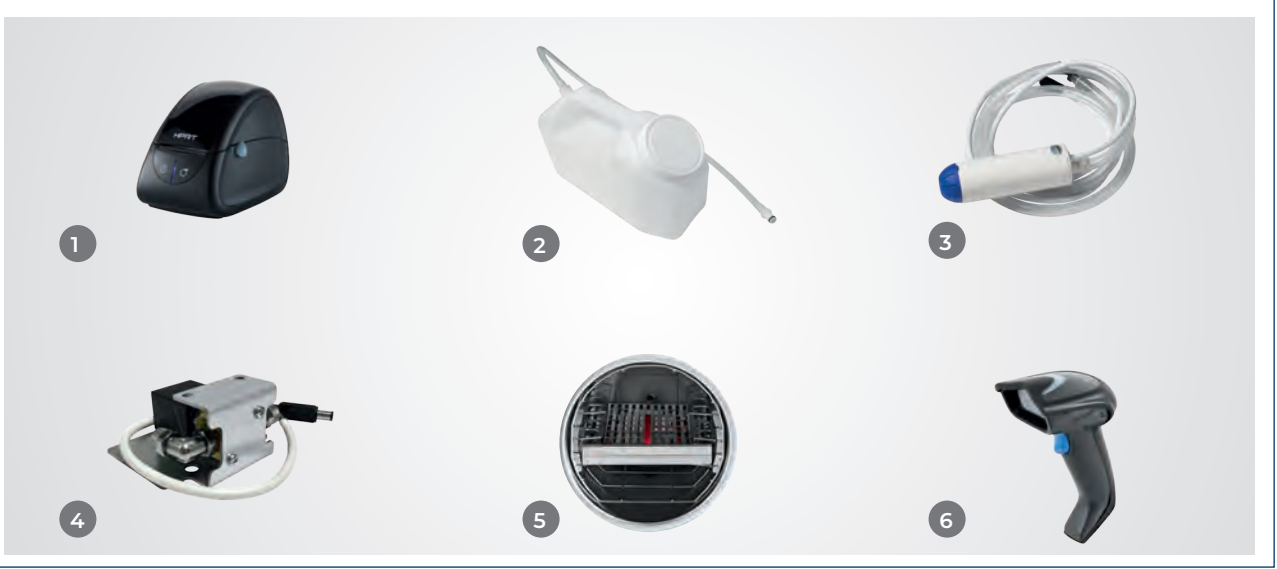

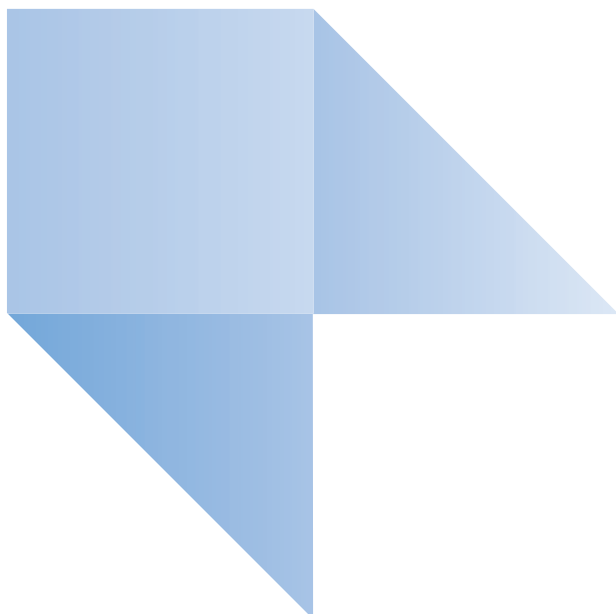

04/2025

MSUPGB1241S00

Cefla s.c. reserves the right to modify the products illustrated in the photos without prior notice. According to the standards in force, in extra-EU areas the availability and specifications of some products and/or characteristics may vary. Please contact your local distributor for further information.



**BU Medical Equipment
Sede Legale ed
Amministrativa
Headquarters**

CEFLA s.c.
Via Selice Provinciale, 23/a
40026 Imola (BO) - Italy
Tel. +39 0542 653111
Fax +39 0542 653344

Stabilimento / Plant

Via Bicocca, 14/C
40026 Imola (BO) - Italy
Tel. +39 0542 653441
Fax +39 0542 653601
www.mocom.it

