

Instructions for use  
—Type 1 Flush Fix



## Type 1 flush button-fix

The Button-fix concept is simple: durable Fixes are attached to the back of one panel and the mating Buttons are attached to the other. Bring the panels together and slide until the Button-fixes 'click'.

The Type 1 Flush Button-fix is moulded in glass-reinforced nylon. It is designed for applications where panel-panel contact is required and fits a simple oval recess. It can be recessed into the edge of a panel of at least 1.1" thick or the face of a panel of at least 0.75" thick, and orientated for vertical or sideways assembly.

Visit the website for more information on the complete Button-fix range, including videos of Button-fix in use. You can also obtain a new copy

of these instructions from the website in the event of loss or in the event that Buttonfix modifies the instructions.

Buttonfix Limited retains the right to modify the instructions as it deems appropriate and the consumer is responsible for checking the website for the latest information.

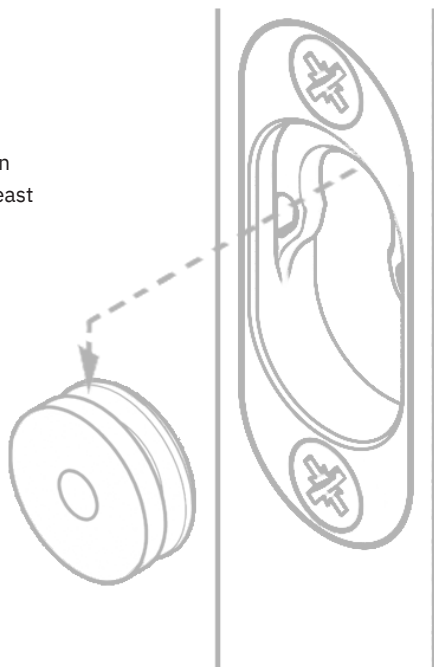

## Warnings

—Button-fix is intended for furniture construction and interior fittings and is not intended, nor should it be used, for any other purpose.

—**WARNING:** Serious damage to property and severe bodily injury can result from (1) improper use, application or installation of the Button-fix or (2) use as part of improperly designed or constructed assemblies or materials.

—Provided that the screws and substrate are properly matched, and all other instructions complied with, tests showed that a vertical panel fixed with four Type1 Flush Fixes can support loads weighing up to a maximum of 220lbs. For critical applications it is essential to perform your own tests.

—Avoid any contact with aggressive solvents and cleaning products.

—It is not possible for Buttonfix to warn the consumer about every possible danger related to use of the Button-fix and the consumer must use his or her own good judgment when installing and using the Button-fix.

## The button

There are two Buttons to suit different screw types. These are colour-coded lime green for #10 flat head wood screws, or orange for Ø6.2mm Varianta Euro screws (to fit Ø5mm pilot holes).

Check with your panel supplier which screw type is best for your application.

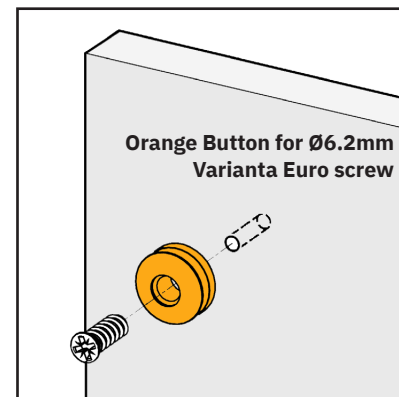
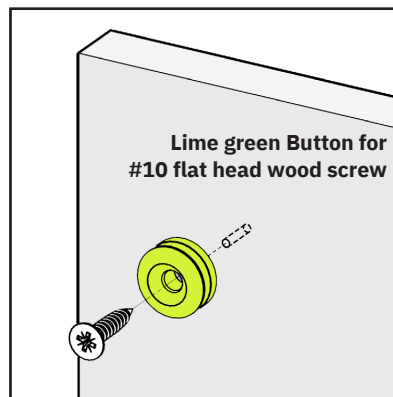

## Button marker accessory

The Button marker accessory helps to mark out where to install the Buttons.

Once you have attached the Fix mouldings (see following pages), insert a marker into each one. Then position the second panel and press firmly. The markers will leave indents in the panel surface, which can be used as guides for drilling pilot holes for the Buttons.

Remove the markers, which can be re-used to mark out the next panel.

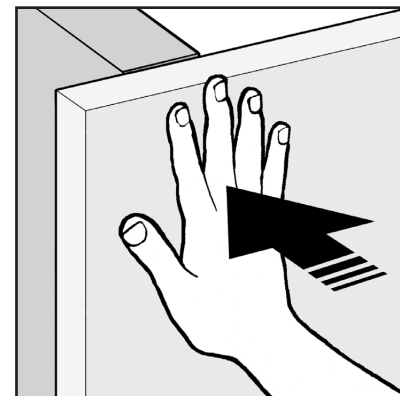
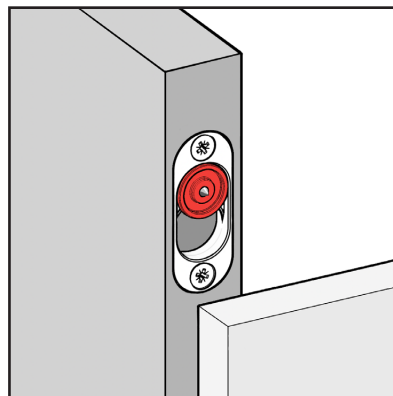

## Recessed fix

### 1. Edge-recessed fix

The Type 1 Flush Fix may be recessed into the edge of a panel of at least 1.1" thickness. An oval rebate measuring 0.87" x 2.2" x 0.315" is required.

**Ensure the 0.315" depth of the cutter is accurately set on the router.**

2 x #8 or #9 flat head wood screws at least 1" long are required.

The Fix may be installed either way up depending on the application.

### 2. Face-recessed fix

The Fix may be recessed into the face of a panel of at least 18mm thickness.

An oval rebate measuring 0.87" x 2.2" x 0.315" is required. As above, the accuracy of the 0.315" depth of the rebate is highly important.

The Fix may be installed either way up, or orientated horizontally or vertically, depending on the application.

## Surface-mounted fix

In some circumstances you may chose not to rebate the Fix. This creates an 0.32" gap between the panels.

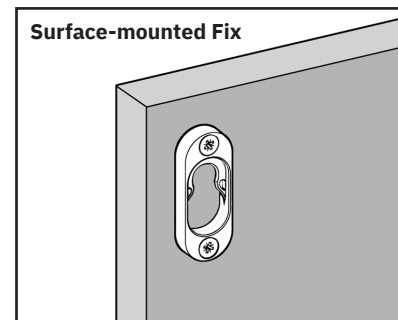
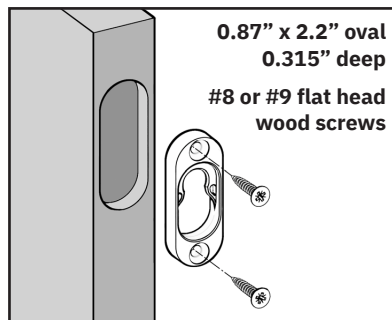
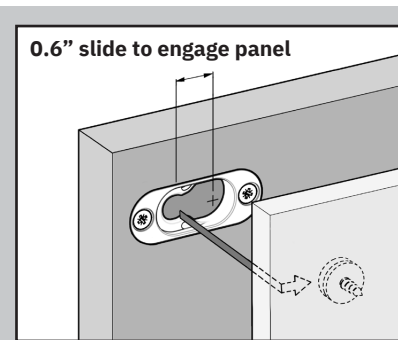
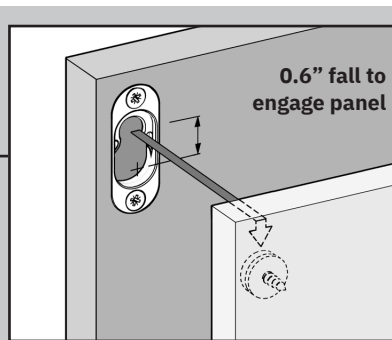
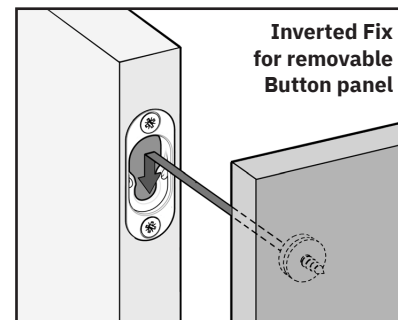
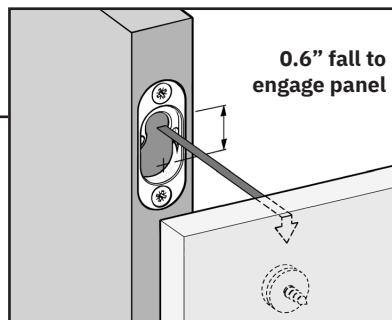

## A useful tip

When several Button-fixes are used on a panel, or if you require the panel to be easily removable, first try spraying the fixes with a PTFE or Silicone based lubricant spray.

The strength of the click-fit can be further reduced by adapting some (but not all) the Fix mouldings by snapping off the ears with needle-nosed pliers, as shown in the diagram on the right.

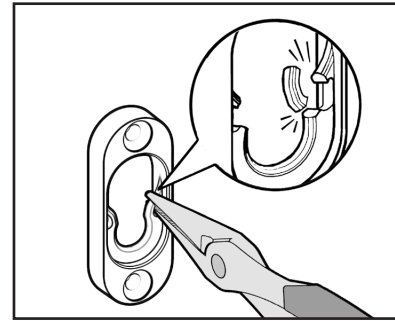

## Suggested layout

As an approximate guide, we suggest that Button-fix centres are no greater than 24" apart and no closer than 0.55" to the edge of the panel.

A Fix may also be rebated into the edge of a panel with a minimum thickness of 1.1".

Always remember to allow at least 0.6" clearance for the removable panel to disengage.

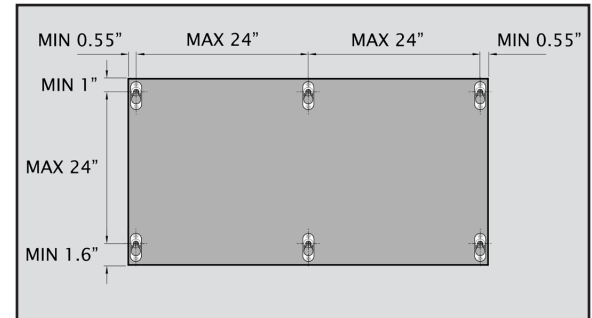



## Router jig accessory

A router jig can be ordered separately for accurately machining the recesses for the Fixes, described on the previous page.

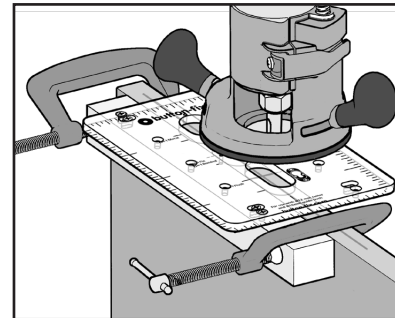
The jig is designed for use with a metric 12mm cutter and 16mm guide bush. Read the separate instructions supplied with the accessory before use.

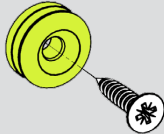
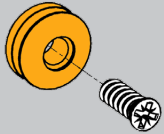

## Screw fixings guide

Product/configuration	Panel thickness/ material	Screw type	net thread length	Notes
<b>Button for flat head wood screw</b>  	<b>0.6" to 0.75" thick</b> Plywood, MDF, MFC	#10 × 0.75" flat head wood screw	0.44"	Spax or similar Timco (product code: 50020CLAF)
	<b>0.75" or greater</b> Plywood, MDF, MFC	#10 × 1" flat head wood screw	0.64"	Spax or similar. Screwfix (product code: 913PV) Timco (product code: 50025CLAF)
		#10 flat head machine screw		User-defined length e.g. M5 × 40mm Screwfix (product code: 7363J)
<b>Button for Varianta Euro screw</b>  	<b>0.4" to 0.5" thick</b> Plywood, MDF, MFC	Varianta Ø7.8 CSK × 13.5mm	0.24"	Häfele America (product code: 013.51.724) <b>Requires Ø5mm pilot hole</b>
	<b>0.5" to 0.6" thick</b> Plywood, MDF, MFC	Varianta Ø7.8 CSK × 16mm	0.33"	Häfele America (product code: 013.51.733) <b>Requires Ø5mm pilot hole</b>
<b>Type 1 Flush Fix</b>  	<b>0.75" thick</b> Plywood, MDF, MFC, solid grade laminate	Ø4.0 × 16mm CSK Plas-Tech 30	0.32"	TR Fastenings (product code: TR00031910-103) <b>Requires Ø3.4mm pilot hole</b>
	<b>1" thick or greater</b> Plywood, MDF, MFC	#9 × 0.75" flat head wood screw	0.48"	Spax or similar Timco (product code: 45020CLAF) <b>Always use flat head screws</b>

Suggestions are based on screws available in the UK which have been tested for compatibility with Type 1 Flush Button-fix. Screws from other suppliers may also be suitable but have not been validated by Buttonfix Limited—**always perform your own tests for critical applications.**

## Specifications

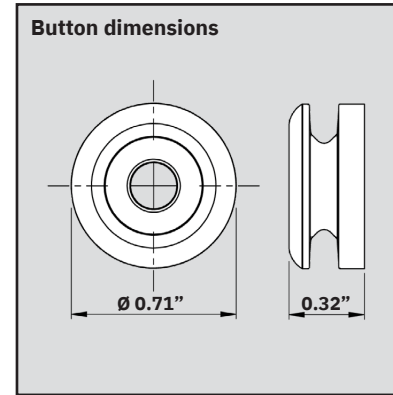
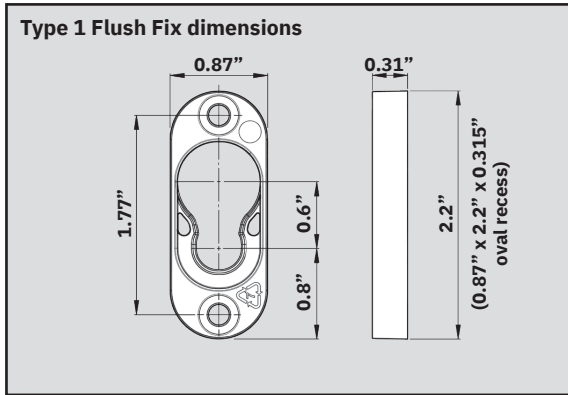

**Material:** Nylon PA6, 30% glass filled (Button & Fix)

**Guide loads:** Wall panel with 4 x Fixes = 220 lbs max.

Ceiling panel with 4 x Fixes = 220 lbs max.

—Advice on panel loads is given with the proviso that the screws and substrate are properly matched, and all other instructions complied with. For critical applications it is essential to perform your own tests.

—Advice is based on independent test reports, which can be found on our website:

**button-fix.com/technical-resources**

**Origin:** Manufactured in the UK

**Buttonfix Limited**

**Unit A, 1 Britton Street  
London, EC1M 5NW**

**T: +44 (0)20 8150 7190**

**E: [info@button-fix.com](mailto:info@button-fix.com)**

**EU Authorised Representative:**

AR Experts BV  
Boeingavenue 209  
1119PD Schiphol-Rijk  
The Netherlands

**button-fix.com**