



Functional Northeast Industrial Flex Bay

318 36 Ave NE, Calgary, AB T2E 5V1 | Greenview Industrial Park

OPPORTUNITY SUMMARY

NAI Advent is pleased to present the lease opportunity of an industrial flex bay located at 318 36 Avenue NE. Offering a functional combination of front office space, a rear warehouse, and outdoor storage, this ±1,560 SF unit is ideal for small-scale industrial, service, or light manufacturing operations. The office portion includes two private offices, a kitchen area, an open work area, and a washroom, while the clear-span warehouse provides efficient storage and operational space. With grade-level loading and ample on-site parking, the property offers excellent accessibility for both staff and clients. Strategically located just minutes from Deerfoot Trail, 32 Ave NE, and other major transportation routes, this location ensures strong connectivity throughout Calgary and the surrounding region.

LEASE DETAILS

AVAILABLE AREA	±1,560 SF
WAREHOUSE AREA	±1,000 SF
OFFICE AREA	±560 SF
YARD AREA	±950 SF (Outdoor storage)
ZONING	I-R (Industrial redevelopment)
LOADING	1 Drive-in door (10' w x 10' h)
CEILING HEIGHT	12' Clear
POWER	100 Amp
LEASE RATE	\$16.50 PSF (Base rent)
OP COSTS	\$10.42 PSF
OCCUPANCY	Immediate

For more information,
please contact:

topcommerciallistings.com



Aaron Gunn
+1 403 200 4026
agunn@naiadvent.com



Tyler Guluche
+1 403 404 8735
tguluche@naiadvent.com

PROPERTY LOCATION



For more information,
please contact:

topcommerciallistings.com

Aaron Gunn

+1 403 200 4026

agunn@naiadvent.com



Tyler Guluche

+1 403 404 8735

tguluche@naiadvent.com

FLOOR PLAN

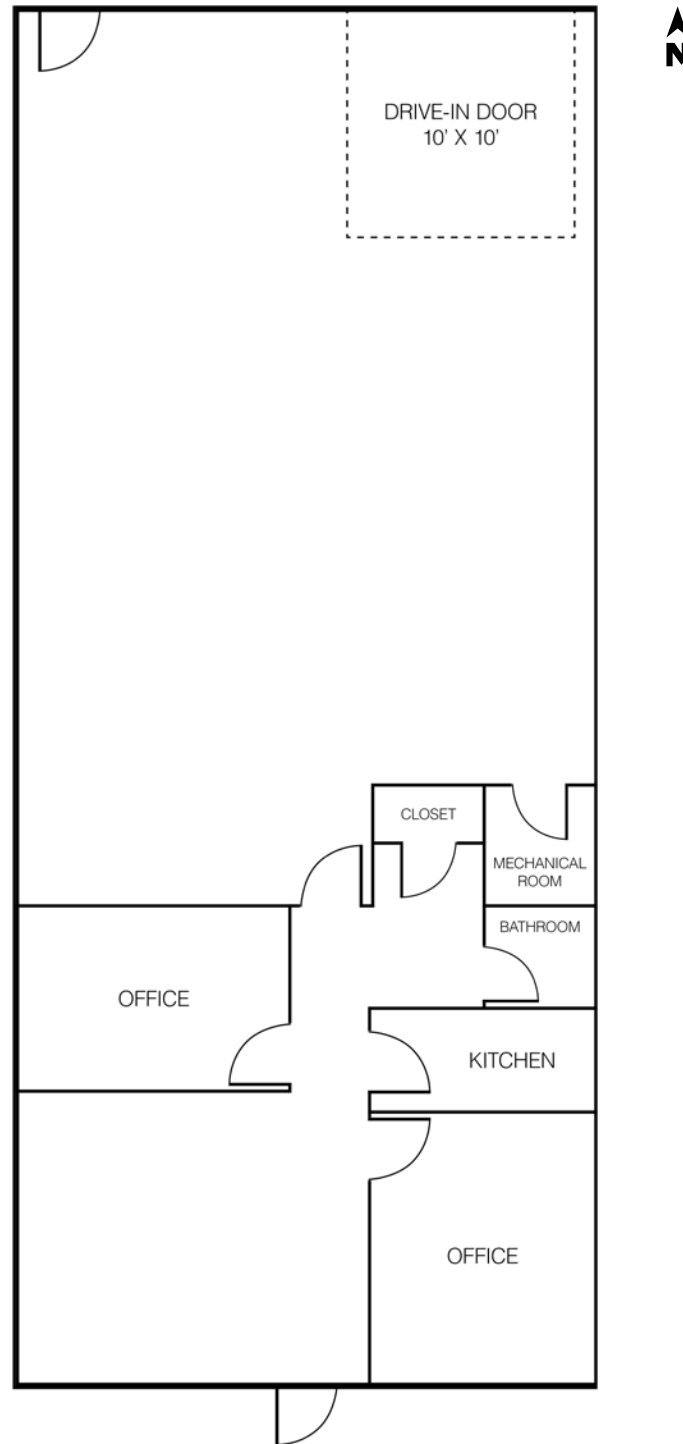

For more information,
please contact:

topcommerciallistings.com



Aaron Gunn
+1 403 200 4026
agunn@naiadvent.com



Tyler Guluche
+1 403 404 8735
tguluche@naiadvent.com



THIS BROCHURE IS INTENDED FOR INFORMATION PURPOSES ONLY AND SHOULD NOT BE RELIED UPON FOR ACCURATE FACTUAL INFORMATION BY THE RECIPIENTS HEREOF. THE INFORMATION CONTAINED HEREIN IS BASED ON INFORMATION WHICH NAI ADVENT DEEMS RELIABLE, HOWEVER, NAI ADVENT ASSUMES NO RESPONSIBILITY FOR THE DEGREE OF ACCURACY OF SUCH INFORMATION, NOR DOES NAI ADVENT REPRESENT OR WARRANT THE INFORMATION CONTAINED HEREIN. RECIPIENTS HEREOF SHOULD CONDUCT THEIR OWN INVESTIGATIONS TO DETERMINE THE ACCURACY OF INFORMATION CONTAINED HEREIN. THE INFORMATION CONTAINED HEREIN IS SUBJECT TO CHANGE WITHOUT NOTICE.

For more information,
please contact:



Aaron Gunn
+1 403 200 4026
agunn@naiadvent.com



Tyler Guluche
+1 403 404 8735
tguluche@naiadvent.com