

M2 Specifications

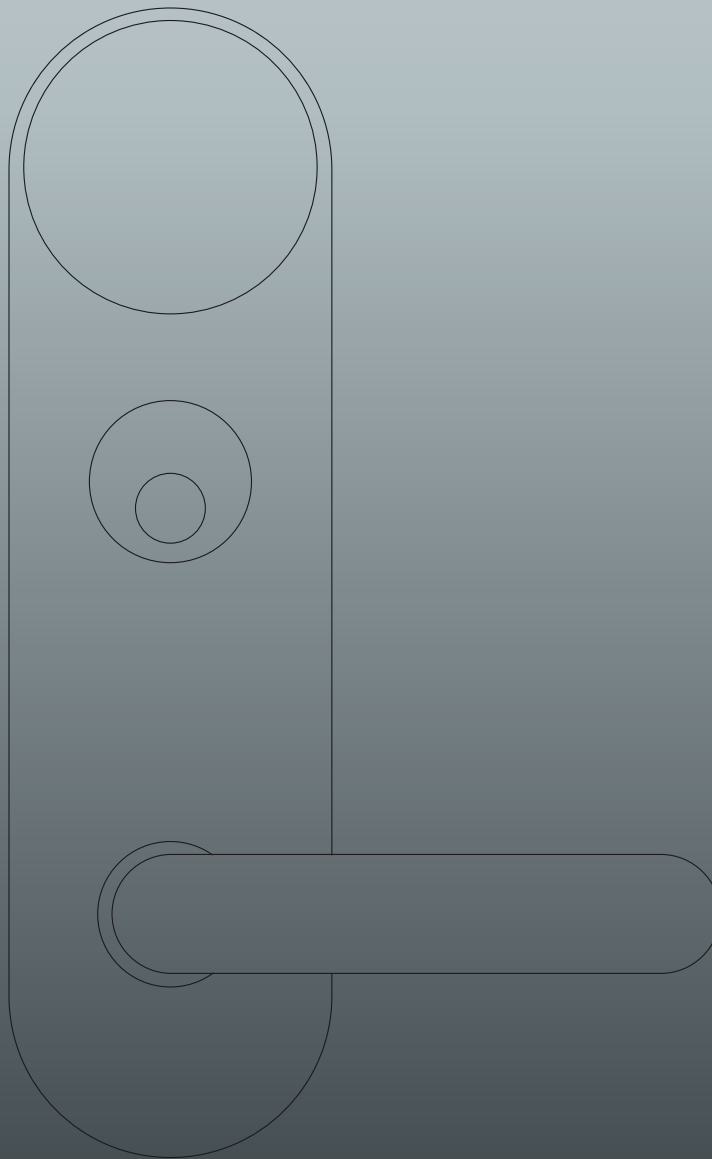

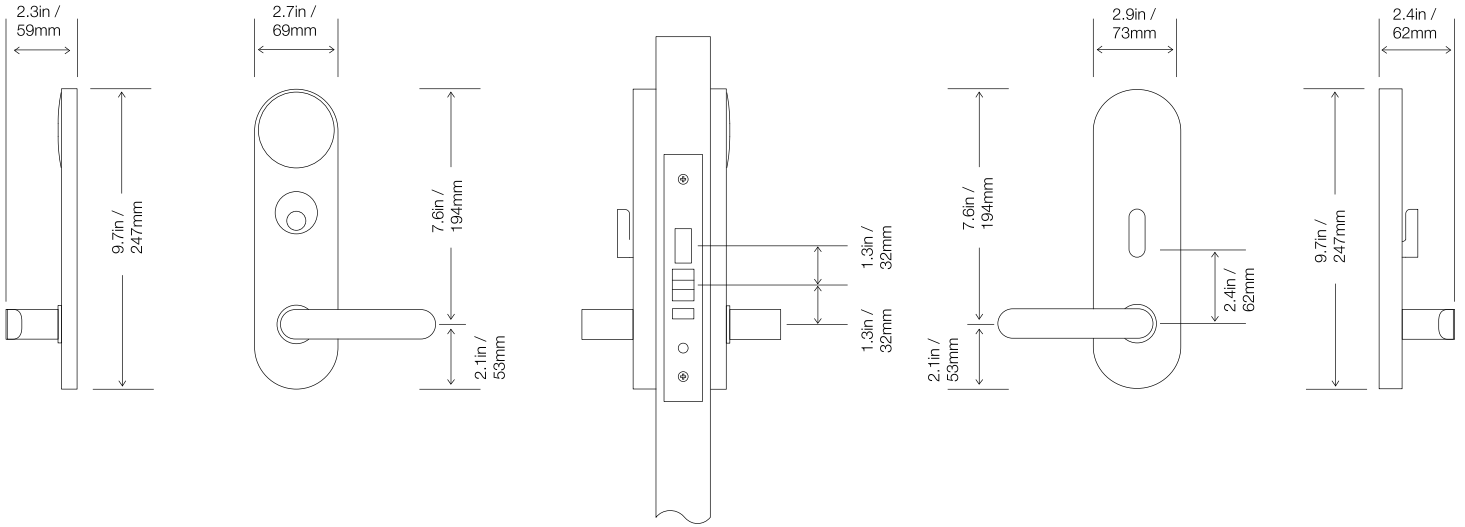

M2 Specifications 2026



Finishes



Black
Exterior & Interior

Matte Finish
Zinc Alloy Exterior & Turns
Polycarbonate Lens & Battery Cover

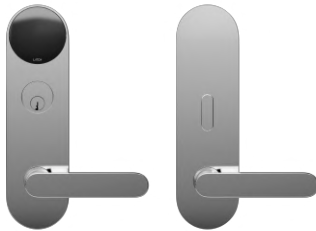

Satin Chrome
Exterior & Interior

Satin Finish
Zinc Alloy Exterior & Turns
Polycarbonate Lens & Battery Cover



Bright Chrome
Exterior & Interior

Bright Finish
Zinc Alloy Exterior & Turns
Polycarbonate Lens & Battery Cover

Lever Styles

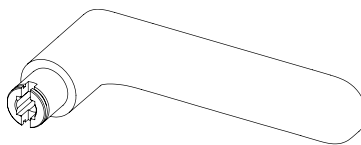

Standard

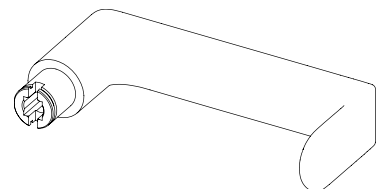

Return



Features

Credential Types Smartphone, NFC Keycard, Doorcode, Mechanical Key

Users 1500

Management App and Cloud

Communication

Wireless Standards Bluetooth Low Energy 5.0 (BLE), Near Field Communication (NFC)

NFC Frequency 13.56 MHz

NFC Type MIFARE DESFire Light

Supported Devices iOS, Watch OS, and Android

Power

Power Supply 6 AA non-rechargeable alkaline batteries

Battery Status Passive monitoring and active notifications via DOOR OS

Inductive Jumpstart Qi-compatible power source can wireless power a Bluetooth unlock in the event of battery failure

Environmental

Operating Temperature -4°F to 130°F

Operating Humidity 0–95% relative humidity, non-condensing

Weather Resistance Lens: IP65, Exterior/Interior Assemblies: IP55 — Interior assembly not intended for outdoor use

Certifications

Certifications UL 10B/C (90 min), CAN/ULC S104, FCC Part 15, IC RSS, FL TAS 201/202/203-94

Compliance Complies with Americans with Disabilities Act



Mechanical Specifications

Lock Format	Mortise
Handing	Field reversible
Door Thickness Compatibility (field configurable)	1-3/4" / 44.5mm
Backset Compatibility (field configurable)	2-3/4" / 69.9mm
Door Preparation	Templates available at support.door.com
Deadbolt Throw	1" / 25.4mm
Faceplate Options	8" x 1/4", 0.06" Thick / 203.2 x 6.4 mm, 1.5mm Thick
Strike Plate	ANSI 4-7/8" x 1-1/4" / 123.8 x 31.75 mm Curved Lip Strike