

ELIXIR DOOR & METALS CO.

NON-IMPACT MODEL 202-20S O.S. DOOR W/ VERT. SLIDE WINDOW

INSTALLATION ANCHORAGE DETAILS

GENERAL NOTES:

1. THE PRODUCT ANCHORAGE SHOWN HEREIN IS DESIGNED TO COMPLY WITH THE CURRENT EDITION OF THE FLORIDA BUILDING CODE (FBC) EXCLUDING HIGH VELOCITY HURRICANE ZONE AND THE DESIGN PRESSURE(S) STATED HEREIN.

1a. THE PRODUCT DETAILS CONTAINED HEREIN ARE BASED UPON SIGNED AND SEALED TEST REPORT CONSTRUCTION CONSULTING LABORATORY REPORT # CCL-19-193 AND ASSOCIATED LABORATORY STAMPED DRAWINGS.

1b. TESTED TO ASTM E330-14.
2. ADEQUACY OF THE EXISTING STRUCTURAL 2X FRAMING OR STEEL FRAMING AS A MAIN WIND FORCE RESISTING SYSTEM CAPABLE OF WITHSTANDING AND TRANSFERRING APPLIED PRODUCT LOADS TO THE FOUNDATION IS THE RESPONSIBILITY OF THE ENGINEER OR ARCHITECT OF RECORD.

3. 1X AND 2X BUCKS (WHEN USED) SHALL BE DESIGNED AND ANCHORED TO PROPERLY TRANSFER ALL LOADS TO THE STRUCTURE. BUCK DESIGN AND INSTALLATION IS THE RESPONSIBILITY OF THE ENGINEER OR ARCHITECT OF RECORD.

4. THE INSTALLATION DETAILS DESCRIBED HEREIN ARE GENERIC AND MAY NOT REFLECT ACTUAL CONDITIONS FOR A SPECIFIC SITE. IF SITE CONDITIONS CAUSE INSTALLATION TO DEVIATE FROM THE REQUIREMENTS DETAILED HEREIN, A LICENSED ENGINEER OR ARCHITECT SHALL PREPARE SITE SPECIFIC DOCUMENTS FOR USE WITH THIS DOCUMENT.
5. IN AREAS WHERE WINDBORNE DEBRIS PROTECTION REQUIREMENTS EXIST, USE OF AN IMPACT PROTECTIVE SYSTEM COMPLYING WITH THE FBC REQUIREMENTS FOR WINDBORNE DEBRIS REGIONS IS MANDATORY FOR THE PRODUCT HEREIN.

6. FRAME MATERIAL: ALUMINUM ALLOY 6063-T6
DOOR PANEL MATERIAL: STEEL CLAD.

7. GLASS MEETS THE REQUIREMENTS OF ASTM E1300-12AE1 GLASS CHARTS.

8. DESIGNATIONS "X" STAND FOR THE FOLLOWING:
X: OPERABLE PANEL
O: FIXED PANEL

9. HARDWARE:
A. HALF HINGES: (4) 6063-T6 EXTRUDED ALUMINUM
B. LATCH LOCK: KEYED
C. DEAD BOLT: SINGLE CYLINDER

10. SEE SHEET 1 FOR DESIGN PRESSURE CHART.

11. IF WATER INFILTRATION REQUIREMENT EXISTS, UNIT MUST BE INSTALLED BENEATH AN OVERHANG MEETING THE CURRENT EDITION OF THE FLORIDA BUILDING CODE - BUILDING AND RESIDENTIAL VOLUMES.

INSTALLATION NOTES:

1. ONE (1) INSTALLATION ANCHOR IS REQUIRED AT EACH ANCHOR LOCATION.

2. THE INSTALLATION ANCHORS AT THE SPACINGS SHOWN ARE THE MINIMUM NUMBER OF ANCHORS AND MAXIMUM SPACINGS TO BE USED FOR PRODUCT INSTALLATION.

3. SHIM AS REQUIRED AT EACH INSTALLATION ANCHOR WITH LOAD BEARING SHIM(S). MAXIMUM ALLOWABLE SHIM SIZE OF 1/4 INCH. SHIM WHERE SPACE OF 1/16 INCH OR GREATER OCCURS. SHIM(S) SHALL BE CONSTRUCTED OF HIGH DENSITY PLASTIC OR BETTER.

4. ANCHORS FOR INSTALLATION INTO WOOD FRAMING OR 14GA. MINIMUM STEEL FRAMING SHALL BE AS SHOWN IN "ANCHOR SCHEDULE" THIS SHEET.
5. MINIMUM EMBEDMENT AND EDGE DISTANCE EXCLUDE WALL FINISHES, INCLUDING BUT NOT LIMITED TO STUCCO, FOAM, BRICK VENEER AND SIDING.

6. INSTALLATION ANCHORS SHALL BE INSTALLED IN ACCORDANCE WITH ANCHOR MANUFACTURER'S INSTALLATION INSTRUCTIONS AND ANCHORS SHALL NOT BE USED IN SUBSTRATES WITH STRENGTHS LESS THAN THE MINIMUM STRENGTH SPECIFIED IN THE "ANCHOR SCHEDULE" THIS SHEET.

7. INSTALLATION ANCHORS AND ASSOCIATED HARDWARE MUST BE MADE OF CORROSION RESISTANT MATERIAL OR HAVE A CORROSION RESISTANT COATING.

| ANCHOR SCHEDULE | | | | | | | |
|------------------------------------------------------------------------------------------------------------------------------------------------------------------------------------------------------------------------|-----------------|----------|-------|-----------------------------------------------------------|-------------------------------------------------|---------------------------------------|-----------------------------------------------|
| SUBSTRATE | DOOR FRAME TYPE | TYPE | SIZE | MANUFACTURER AND/OR SPECIFICATION | EMBEDMENT (IN) ⁽¹⁾ | EDGE DISTANCE (IN) ^{(1) (2)} | ANCHOR CAPACITIES BASED ON |
| SHEET METAL/STEEL TUBING 14 GA. MIN. THICKNESS | FIN (Z-BAR) | PAN HEAD | NO. 8 | ASME B18.6.4 (TAPPING SCREW) | MIN. 3 THREADS PAST INSIDE SURFACE OF SUBSTRATE | 3/8" | MIN. 33 KSI YIELD STRNEGTH |
| 2X WOOD FRAMING | FIN (Z-BAR) | PAN HEAD | NO. 8 | ANSI B18.6.1 (WOOD SCREW) OR ASME B18.6.4 (TAPPING SCREW) | 1" | 1/2" | WOOD WITH A MINIMUM SPECIFIC GRAVITY OF 0.42. |
| <div>NOTES:</div> <div>1) FOR WOOD OR TAPPING SCREWS IF SPL.ITTING IS A CONCERN, DRILL 0.082" PILOT HOLE (DRILL SIZE 45).</div> <div>2) EDGE DISTANCE MEA SURED FROM EITHER SIDE OF ANCHOR TO EDGE OF SUBSTRATE.</div> | | | | | | | |

PROJECT #419-0903

ELIXIR DOOR & METALS CO.

1215 POPE DRIVE

DOUGLAS, GEORGIA 31533

TITLE: N/I MODEL 202-20S O.S. DOOR W/ VERT. SLIDE WINDOW

GENERAL AND INSTALLATION NOTES

PREPARED BY:

PTC PRODUCT DESIGN GROUP, LLC

PO BOX 520775

LONGWOOD, FLORIDA 32752

FBPE CA. NO. 25835

DRAWN BY: SMC

SCALE: N.T.S.

REV: B

DATE: 04/20/10

DRAWING NO: ELIX0034

SHEET: 1 OF 4

Robert J. Amoruso, P.E.
Florida P.E. No. 49752

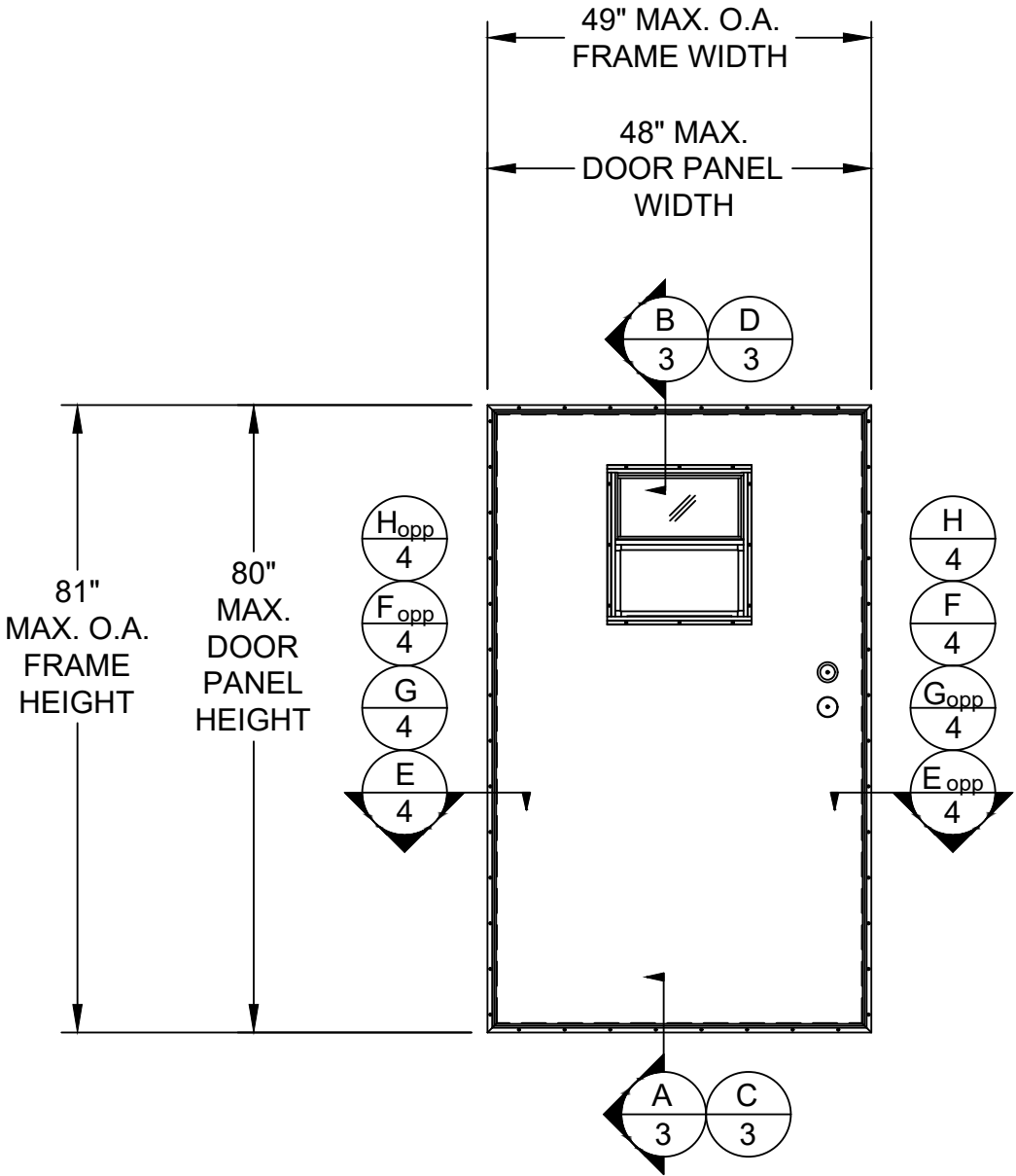

ELEVATION
EXTERIOR VIEW WITH
VERTICAL SLIDER WINDOW

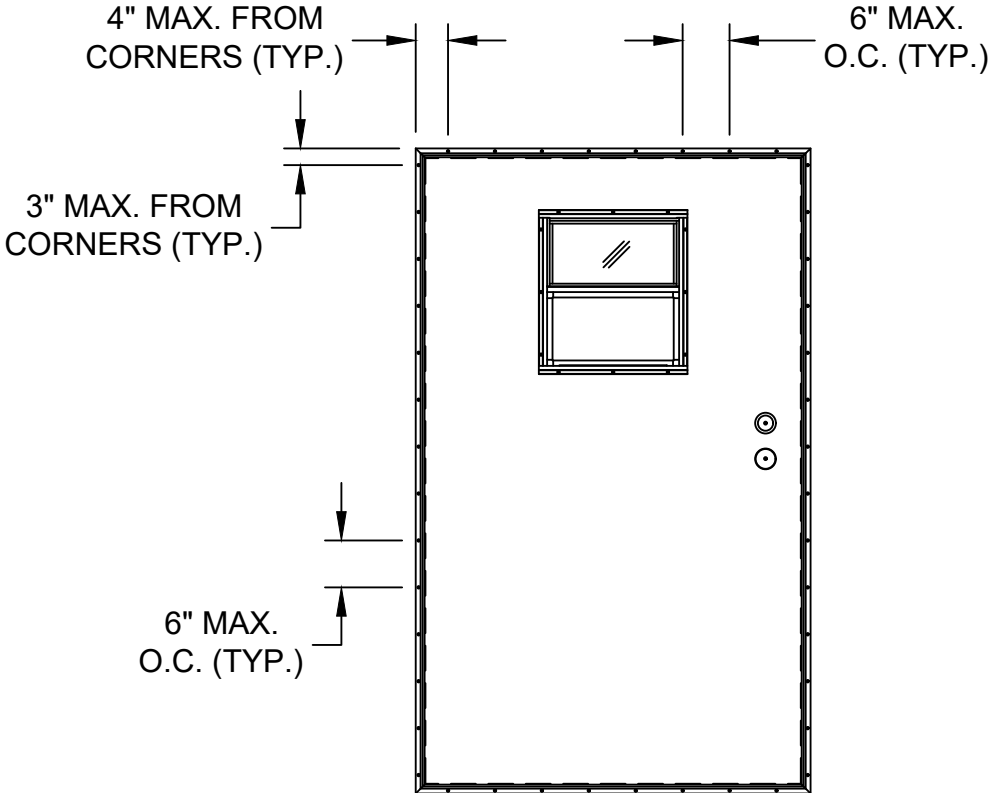

ANCHOR LAYOUT
EXTERIOR VIEW

- NOTE:
- 1. MINIMUM NUMBER OF ANCHORS IN JAMBS IS 14. ANCHOR SPACING VARIES, BUT NOT TO EXCEED 6" MAX. O.C.
 - 2. MINIMUM NUMBERS OF ANCHORS IN HEAD AND SILL IS 8. ANCHOR SPACING VARIES, BUT NOT TO EXCEED 6" MAX. O.C.

| | | | |
|--------------------------------------------------------------------------------------------------------------------------------------------------------------------------|-----------|-------------------------------|------|
| PROJECT #419-0903 | | | |
| | | UPDATE TO CURRENT FBC EDITION | RJA |
| | | UPDATE TO CURRENT FBC EDITION | RJA |
| | B | A | REV |
| | | DESCRIPTION | DATE |
| ELIXIR DOOR & METALS CO. 1215 POPE DRIVE DOUGLAS, GEORGIA 31533 | | | |
| TITLE: N/I MODEL 202-20S O.S. DOOR W/ VERT. SLIDE WINDOW ELEVATION & ANCHOR LAYOUT | | | |
| PREPARED BY: | DRAWN BY: | DATE: | |
| | SMC | 04/20/10 | |
| | SCALE: | DRAWING NO: | |
| | N.T.S. | ELIX0034 | |
| | REV: | SHEET: | |
| | B | 2 OF 4 | |
| PTC PRODUCT DESIGN GROUP, LLC PO BOX 520775 LONGWOOD, FLORIDA 32752 FBPE C.A. NO. 25935 Phone: 321.660.1788 Fax: 321.660.1789 Email: info@ptc-corp.com | | | |

Robert J. Amoruso, P.E.
Florida P.E. No. 49752

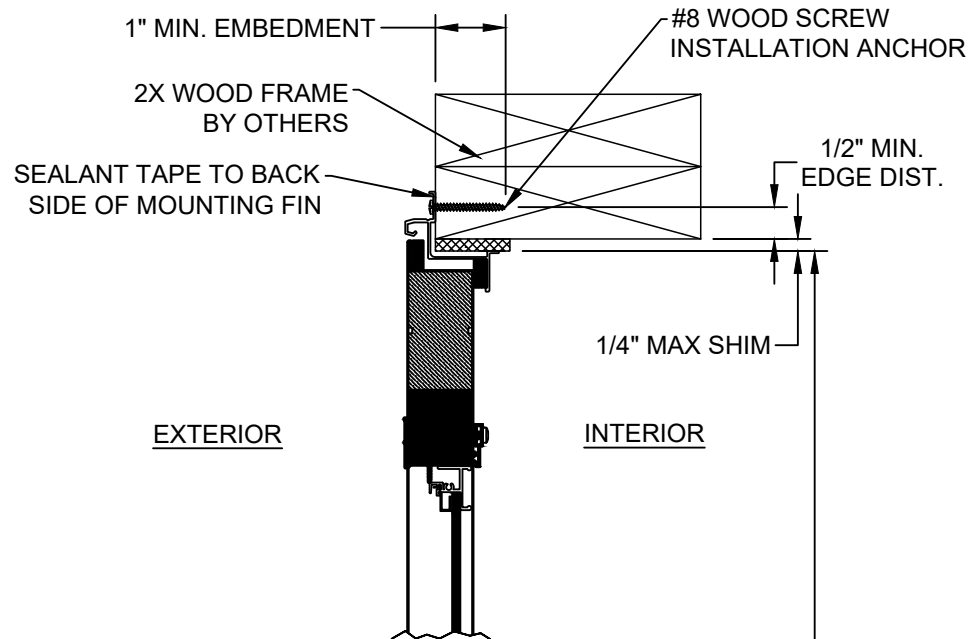

B **VERTICAL SECTION**
WOOD FRAME SUBSTRATE

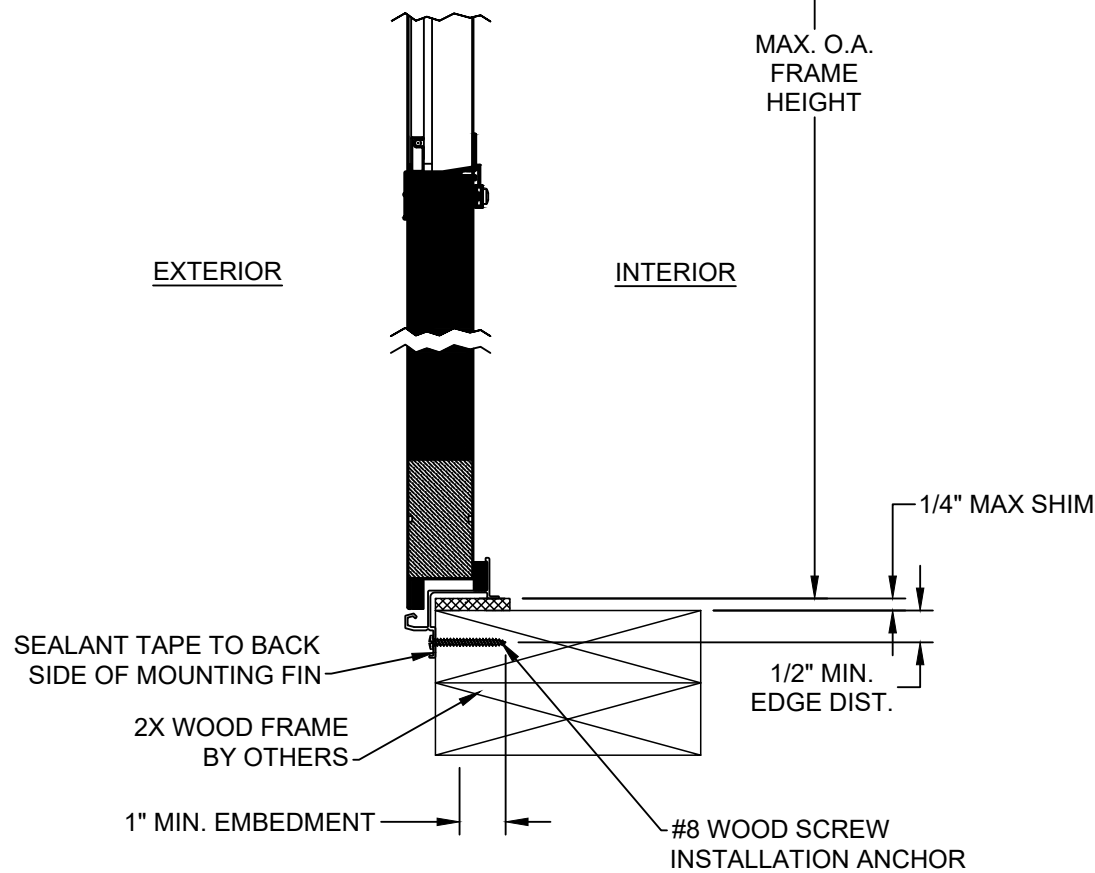

A **VERTICAL SECTION**
WOOD FRAME SUBSTRATE

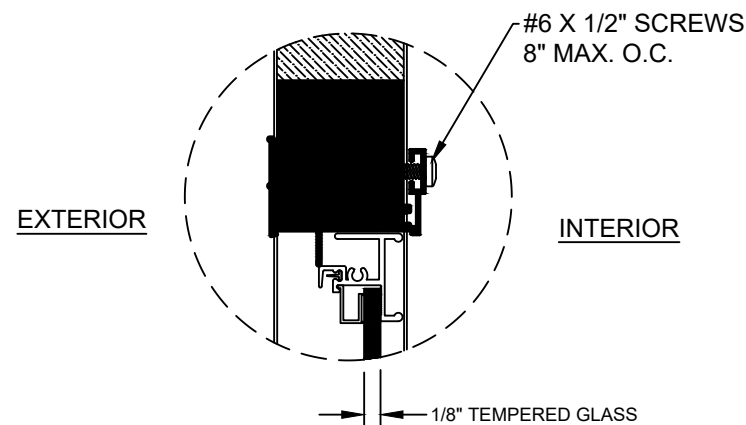

GLAZING DETAIL

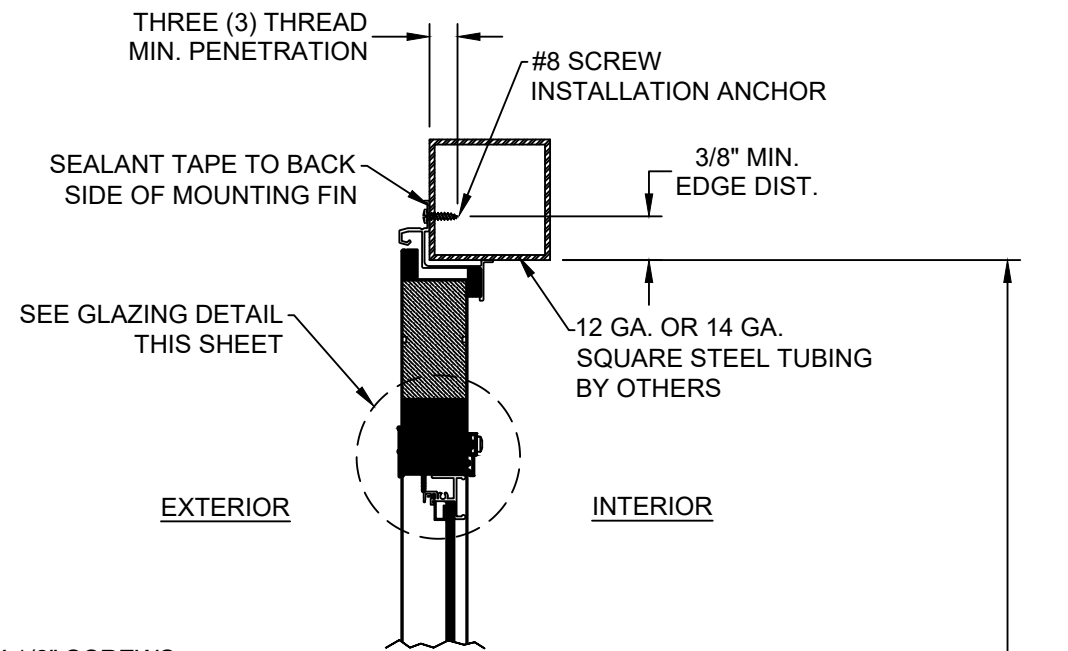

D **VERTICAL SECTION**
STEEL TUBING SUBSTRATE

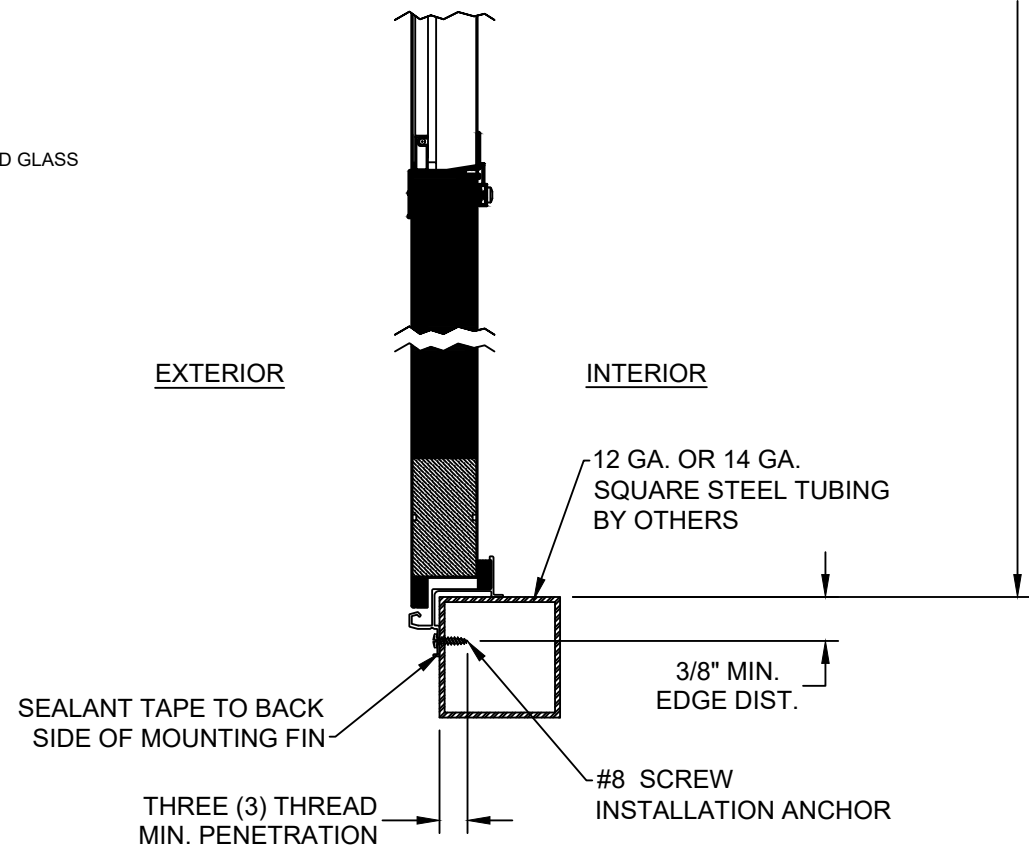

C **VERTICAL SECTION**
STEEL TUBING SUBSTRATE

ELIXIR DOOR & METALS CO.
1215 POPE DRIVE
DOUGLAS, GEORGIA 31533

TITLE: N/I MODEL 202-20S O.S. DOOR W/ VERT. SLIDE WINDOW
VERTICAL SECTIONS & GLAZING DETAIL

PREPARED BY:

DRAWN BY: SMC

SCALE: N.T.S.

REV: B

DATE: 04/20/10

DRAWING NO: ELIX0034

Robert J. Amoruso, P.E.
Florida P.E. No. 49752

PROJECT #419-0903

| REV | DESCRIPTION | DATE | BY |
|-----|-------------------------------|---------|-----|
| B | UPDATE TO CURRENT FBC EDITION | 1/25/21 | RJA |
| A | UPDATE TO CURRENT FBC EDITION | 8/3/15 | RJA |

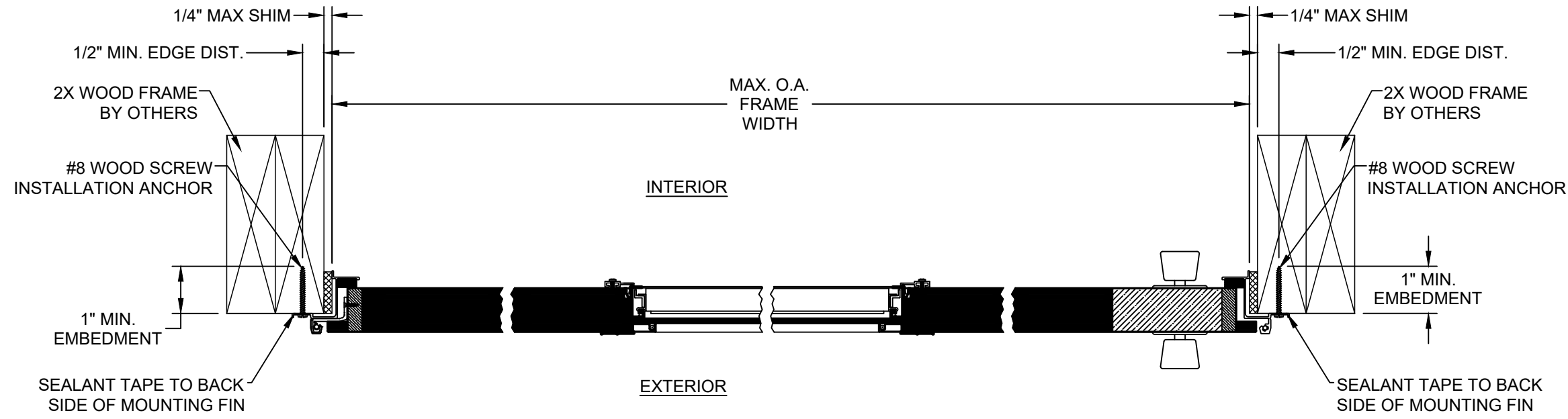

E **HORIZONTAL SECTION**
WOOD FRAME SUBSTRATE

F **HORIZONTAL SECTION**
WOOD FRAME SUBSTRATE

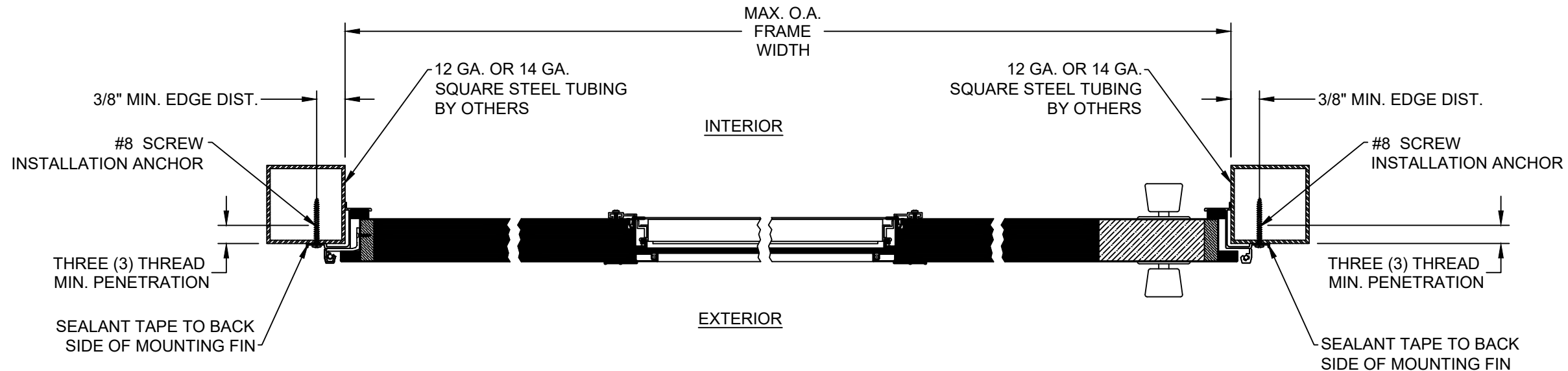

G **HORIZONTAL SECTION**
STEEL TUBING SUBSTRATE

H **HORIZONTAL SECTION**
STEEL TUBING SUBSTRATE

| | | | | | |
|---------------------------------------------------------------------------------|--|--------------------------------------------------------------------------------------------------------------------------------------------------------------------------|----------|-------------|----------|
| PROJECT #419-0903 | | | | RJA | BY |
| | | UPDATE TO CURRENT FBC EDITION | 1/25/21 | RJA | DATE |
| | | UPDATE TO CURRENT FBC EDITION | 8/3/15 | RJA | DATE |
| | | DESCRIPTION | REV | | BY |
| ELIXIR DOOR & METALS CO. 1215 POPE DRIVE DOUGLAS, GEORGIA 31533 | | DATE: | 04/20/10 | DRAWING NO: | ELIX0034 |
| TITLE: N/I MODEL 202-20S O.S. DOOR W/ VERT. SLIDE WINDOW HORIZONTAL SECTIONS | | DRAWN BY: | SMC | SCALE: | N.T.S. |
| | | REV: | B | SHEET: | 4 OF 4 |
| PREPARED BY: | | | | | |
| | | PTC PRODUCT DESIGN GROUP, LLC PO BOX 520775 LONGWOOD, FLORIDA 32752 FBPE C.A. NO. 25935 Phone: 321.660.1788 Fax: 321.660.1789 Email: info@ptc-corp.com | | | |

Robert J. Amoruso, P.E.
Florida P.E. No. 49752