



Maximize Your Impact

At Westin, we believe in empowering attendees to maximize their impact and effect change both in the boardroom and beyond. That's why we've made well-being a central part of our meetings. From Bright Breaks and energizing agendas, to inspiring, adaptable settings and responsible practices, we ensure attendees and planners feel accomplished, invigorated and ready to perform at their best.

Nestled just minutes from Calgary International Airport, The Westin Calgary Airport offers over 30,000 sq. ft. of thoughtfully designed event space, including Calgary's largest hotel ballroom at 16,620 sq. ft. Purpose-built for productivity and connection, our second-floor breakout rooms feature built-in audiovisual and flexible layouts to suit any agenda. As an Indigenous-owned hotel, we proudly integrate meaningful hospitality with elevated service and wellness-inspired touches, creating an environment where ideas thrive and guests feel empowered from arrival to adjournment. Whether it's a multi-day conference or a focused boardroom session, our expert team ensures every detail drives success.

THE WESTIN
CALGARY AIRPORT

**THE WESTIN
CALGARY AIRPORT**

671 Aero Drive NE
Calgary, AB T2E7Y5

T: 587-393-6129

[westincalgaryairport.com](https://www.westincalgaryairport.com)

This document contains approximate measurements that are for illustrative purposes only. We cannot guarantee the floor plan accuracy or completeness and therefore encourage you to review the space to make sure it is suitable for your event



Power Productivity

IMPACT

To fuel ideation before, during and after meetings, our Bright Breaks offer meaningful opportunities to refresh and recharge, whether with an energizing activity or a beneficial snack. And to take the work out of running better meetings, our Hit Your Stride Agendas are designed to power productivity and inspire breakthroughs on any schedule. From intuitive tools that help planners book meetings with ease to a free personalized website where attendees can make reservations and access documents via a custom URL, our hotels and resorts offer a variety of personalized services designed to ensure a unique and effortless experience. Responsible meetings empower attendees to make an active difference in the communities they serve through local involvement, donations through partnerships and sustainable meeting practices.

CONNECT

The hotel offers a total of 8 event rooms with 19,386 square feet of total event space for productivity and focus. Host your meeting or event in Calgary's largest hotel ballroom offering more than 16,000 square feet. In addition, we have a variety of adaptable spaces and unique meeting areas designed to inspire the interactive exchange of ideas.

RECHARGE

Unwind in our spacious, light-filled guestrooms and suites. Each of our 246 accommodation spaces features our Heavenly® Bed and Heavenly® Bath, high-speed Internet access, refreshment center, work desk with ergonomic chair and other essential amenities for a fulfilling stay. Our spacious guestrooms and suites are welcoming, light-filled spaces.

| | | |
|-------------------|-----|-----------------|
| Deluxe King | 9 | 400 - 475 sq ft |
| Executive King | 27 | 320 - 340 sq ft |
| Suite | 15 | 640 - 670 sq ft |
| Executive Suite | 2 | 640 - 670 sq ft |
| Traditional King | 103 | 320 - 340 sq ft |
| Traditional Queen | 91 | 375 - 400 sq ft |
| Total | 247 | |

REVITALIZE

The WestinWORKOUT fitness center is open 24 hours a day, offering weight machines and free weights, an indoor pool, hot tub, and cardiovascular equipment facing personal flat-screen televisions.

REFRESH

At Westin, we believe that feeling good starts with getting the nourishment that is right for you. That's why we aim to provide nutritious options that contribute to your overall well-being. We ensure that dishes are sourced responsibly, crafted flexibly and created thoughtfully to accommodate individual dietary needs and preferences without compromising flavor, taste or satisfaction.

The Lobby Bar offers an optimal setting for light, nutritious snacks and refreshments from the full bar, while 671 Kitchen + Bar offers healthful yet satisfying breakfast, lunch and dinner fare in a contemporary, family-friendly setting. The hotel also offers 24-hour In-Room Dining for your comfort and convenience.

EXPLORE

Departing and arriving is easy with free parking and shuttle service from Calgary International Airport, less than two kilometers from our hotel. Cross Iron Mills outlet shops and the Calgary Zoo are also in easy reach.

SEAMLESS SERVICE

Let us take care of the details with services such as the Concierge, business center, ATM, Service Express®, valet and self-parking.

To begin planning your next Westin event, please visit westincalgaryairport.com

THE WESTIN
CALGARY AIRPORT

Meeting Space

OVERVIEW

Whether you're catching up with colleagues or convening for a fête, our planners are here to make your meeting or event effortless. With 19,386 square feet of event space and 8 maximum breakout rooms, we offer countless ways to connect and collaborate. Host your meeting or event in Calgary's largest hotel ballroom offering more than 16,000 square feet. In addition, we have a variety of adaptable spaces and unique meeting areas designed to inspire the interactive exchange of ideas.



ROOMS AT A GLANCE

TOTAL GUESTROOMS: 247
TOTAL MEETING ROOMS: 8
LARGEST MEETING ROOM CAPACITY: 2,000 People
LARGEST MEETING ROOM SIZE: 16,620 SQ FT

Additional spaces for meetings and events, not displayed here, may also be available. Contact your hotel representative for more information.

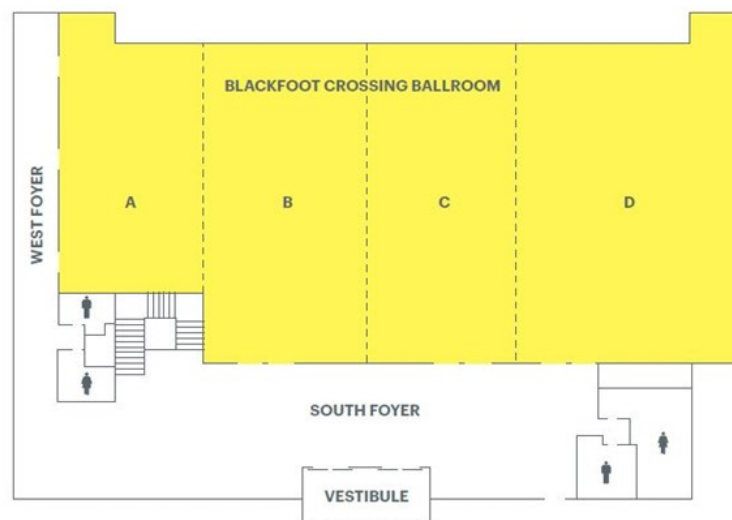
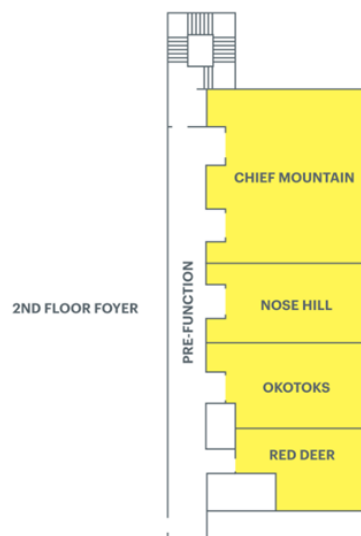

THE WESTIN
CALGARY AIRPORT

**THE WESTIN
CALGARY AIRPORT**

671 Aero Drive NE
Calgary, AB T2E7Y5

T: 587-393-6129

westincalgaryairport.com

This document contains approximate measurements that are for illustrative purposes only. We cannot guarantee the floor plan accuracy or completeness and therefore encourage you to review the space to make sure it is suitable for your event

Conference Level

MEETING SPACE

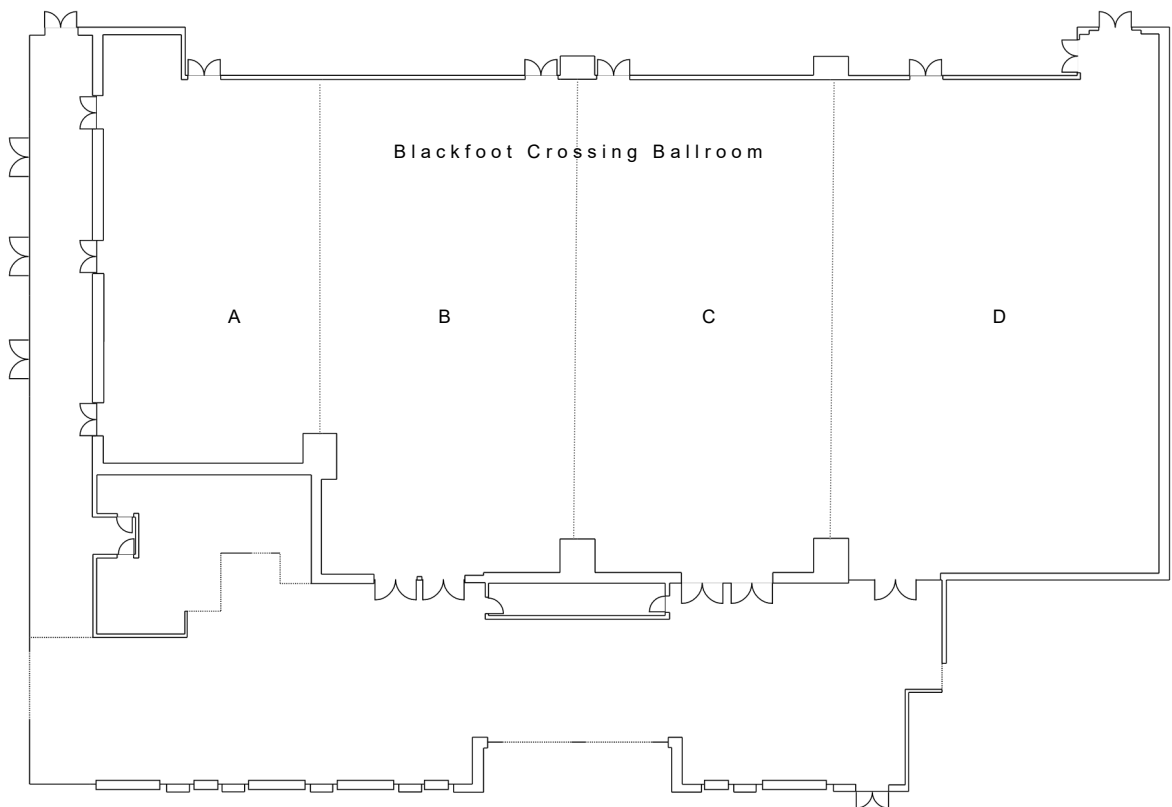

| ROOM NAME | DIMENSIONS | AREA SQ FEET | MAX CEILING HEIGHT | ROUNDS OF 8 | THEATRE | CONFERENCE | RECEPTION | CLASSROOM 2x6 | U-SHAPE | HOLLOW SQUARE | BOOTHS |
|-----------------------------|------------|-----------------|-----------------------|-------------|---------|------------|-----------|------------------|---------|------------------|--------|
| CONFERENCE LEVEL | | | | | | | | | | | |
| BLACKFOOT CROSSING BALLROOM | 188' x 92' | 16,620 | 20' | 1500 | 2000 | - | 2000 | 1275 | - | - | 100 |
| BLACKFOOT CROSSING A, B, C | 128' x 92' | 11,092 | 20' | 800 | 1400 | 82 | 1400 | 850 | 108 | 138 | 69 |
| BLACKFOOT CROSSING B, C, D | 152' x 92' | 13,922 | 20' | 1000 | 1600 | 102 | 1600 | 1060 | 128 | 158 | 87 |
| BLACKFOOT CROSSING A & B | 82' x 92' | 6,860 | 20' | 496 | 700 | 60 | 700 | 520 | - | - | 47 |
| BLACKFOOT CROSSING B & C | 92' x 92' | 8,402 | 20' | 600 | 950 | 60 | 950 | 625 | 9 | 120 | 60 |
| BLACKFOOT CROSSING C & D | 106' x 92' | 9,752 | 20' | 712 | 1100 | 72 | 1100 | 740 | 102 | 132 | 70 |
| BLACKFOOT CROSSING A | 39' x 69' | 2,690 | 20' | 192 | 300 | 50 | 300 | 140 | 57 | 68 | 17 |
| BLACKFOOT CROSSING B | 46' x 92' | 4,170 | 20' | 304 | 450 | 60 | 450 | 220 | 68 | 76 | 30 |
| BLACKFOOT CROSSING C | 46' x 92' | 4,232 | 20' | 304 | 450 | 60 | 450 | 220 | 68 | 76 | 30 |
| BLACKFOOT CROSSING D | 60' x 92' | 5,520 | 20' | 400 | 500 | 60 | 500 | 320 | 75 | 100 | 40 |
| BLACKFOOT CROSSING FOYER | | 4,500 | 18' | - | - | - | 650 | - | - | - | 16 |

THE WESTIN
CALGARY AIRPORT

**THE WESTIN
CALGARY AIRPORT**

671 Aero Drive NE
Calgary, AB T2E7Y5

T: 587-393-6129

westincalgaryairport.com

This document contains approximate measurements that are for illustrative purposes only. We cannot guarantee the floor plan accuracy or completeness and therefore encourage you to review the space to make sure it is suitable for your event

Second Floor

MEETING SPACE

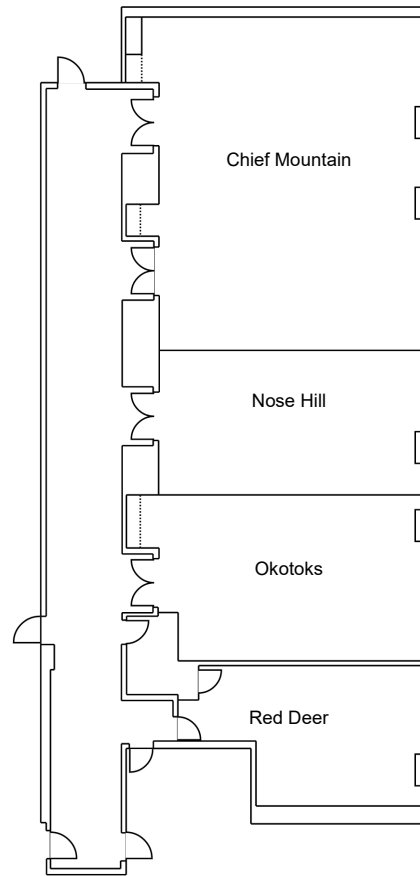

| ROOM NAME | DIMENSIONS | AREA SQ FEET | MAX CEILING HEIGHT | ROUNDS OF 8 | THEATRE | CONFERENCE | RECEPTION | CLASSROOM 2x6 | U-SHAPE | HOLLOW SQUARE | BOOTHS |
|----------------|------------|-----------------|-----------------------|-------------|---------|------------|-----------|------------------|---------|------------------|--------|
| SECOND FLOOR | | | | | | | | | | | |
| RED DEER | 22' x 17' | 374 | 11' | - | - | 12 | - | - | - | - | - |
| OKOTOKS | 30' x 22' | 660 | 11' | 48 | 40 | 14 | 40 | 30 | 17 | 22 | - |
| NOSE HILL | 30' x 18' | 560 | 11' | 40 | 30 | 14 | 30 | 25 | 16 | 18 | - |
| CHIEF MOUNTAIN | 30' x 40' | 1,220 | 11' | 96 | 100 | 22 | 100 | 54 | 30 | 38 | - |

THE WESTIN
CALGARY AIRPORT

THE WESTIN
CALGARY AIRPORT

671 Aero Drive NE
Calgary, AB T2E7Y5

T: 587-393-6129

westincalgaryairport.com

This document contains approximate measurements that are for illustrative purposes only. We cannot guarantee the floor plan accuracy or completeness and therefore encourage you to review the space to make sure it is suitable for your event