



YOU GET MORE WITH MURRAY

General Purpose Worm Drive Clamps - Gold Seal®

We offer multiple grades and sizes of traditional worm drive hose clamps.

Series	Screw	Housing	Band	Band Width
Good general purpose economy clamp				
H	5/16" Hex, Zinc Plated Carbon Steel with Trivalent Chromate	200/300 Stainless Steel	200/300 Stainless Steel	1/2"
Moderate corrosion resistance, perfect for industrial installations				
HSS	5/16" Hex, 400 Series Stainless Steel	200/300 Stainless Steel	200/300 Stainless Steel	1/2"
Well suited for marine applications				
HFSS	5/16" Hex, 300 Series Stainless Steel	300 Series Stainless Steel	300 Series Stainless Steel	1/2"
For harsh environments and marine applications				
HGSS	5/16" Hex, 304 Stainless Steel	304 Stainless Steel	304 Stainless Steel	1/2"
Best corrosion resistance. For plumbing, well, municipal drains, irrigation, marine				
HLSS	5/16" Hex, 316 Stainless Steel	316 Stainless Steel	316 Stainless Steel	1/2"
Moderate corrosion resistance, perfect for industrial installations, well water				
HMSS	5/16" Hex, 400 Series Stainless Steel	200 Series Stainless Steel	200 Series Stainless Steel	9/16"
Rated Ultimate Torque H Series 50 in. lbs. (6.8 Nm) All Other Series 60 in. lbs. (6.8 Nm)		Recommended Installation Torque H Series 30-40 in.lbs (3.4-4.5 Nm) All other series 35-45 in.lbs. (4-5.1 Nm)		



Email Your Purchase Order to orderentry@murraycorp.com

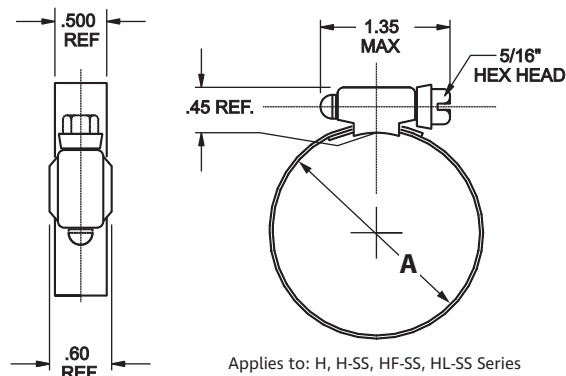

Applies to: H, H-SS, HF-SS, HL-SS Series

For bulk stock, add 00C to the end of your part number. E.g. H24SS00C
For packed stock, add 00P to the end of your part number. E.g. H24SS00P

Clamp Series							"A" Diameter Range		
SAE Size	H	HSS	HF	HG	HL	HM	Inches		Millimeters
6	H6	H6SS	HF6SS	HG6SS	HL6SS	HM6SS	7/16	25/32	11 20
8	H8	H8SS	HF8SS	HG8SS	HL8SS	HM8SS	7/16	29/32	11 23
10	H10	H10SS	HF10SS	HG10SS	HL10SS	HM10SS	9/16	1-1/16	14 27
12	H12	H12SS	HF12SS	HG12SS	HL12SS	HM12SS	11/16	1-1/4	18 32
16	H16	H16SS	HF16SS	HG16SS	HL16SS	HM16SS	3/4	1-1/2	19 38
20	H20	H20SS	HF20SS	HG20SS	HL20SS	HM20SS	13/16	1-3/4	21 44
24	H24	H24SS	HF24SS	HG24SS	HL24SS	HM24SS	1-1/16	2	27 51
28	H28	H28SS	HF28SS	HG28SS	HL28SS	HM28SS	1-5/16	2-1/4	33 57
32	H32	H32SS	HF32SS	HG32SS	HL32SS	HM32SS	1-9/16	2-1/2	40 64
36	H36	H36SS	HF36SS	HG36SS	HL36SS	HM36SS	1-13/16	2-3/4	46 70
40	H40	H40SS	HF40SS	HG40SS	HL40SS	HM40SS	2-1/16	3	52 76
44	H44	H44SS	HF44SS	HG44SS	HL44SS	HM44SS	2-5/16	3-1/4	59 83
48	H48	H48SS	HF48SS	HG48SS	HL48SS	HM48SS	2-9/16	3-1/2	65 89
52	H52	H52SS	HF52SS	HG52SS	HL52SS	HM52SS	2-13/16	3-3/4	71 95
56	H56	H56SS	HF56SS	HG56SS	HL56SS	HM56SS	3-1/16	4	78 102
60	H60	H60SS	HF60SS	HG60SS	HL60SS	HM60SS	3-5/16	4-1/4	84 108
64	H64	H64SS	HF64SS	HG64SS	HL64SS	HM64SS	3-9/16	4-1/2	90 114
72	H72	H72SS	HF72SS	HG72SS	HL72SS	HM72SS	4-1/16	5	103 127
80*	H80	H80SS	HF80SS	HG80SS	HL80SS	HM80SS	4-9/16	5-1/2	116 140
88*	H88	H88SS	HF88SS	HG88SS	HL88SS	HM88SS	5-1/16	6	129 152
96	H96	H96SS	HF96SS	HG96SS	HL96SS	HM96SS	5-9/16	6-1/2	141 165
104	H104	H104SS	HF104SS	HG104SS	HL104SS	HM104SS	6-1/16	7	154 178
116	H116	H116SS	HF116SS	HG116SS	HL116SS	HM116SS	6-1/2	7-3/4	165 197
128	H128	H128SS	HF128SS	HG128SS	HL128SS	HM128SS	5-11/16	8-1/2	144 216

*items not stocked. special order only **HG, HL, and HM Series are not standard stocked items and may need to be special ordered.



Murray Corporation
260 Schilling Circle
Hunt Valley, MD, 21031, USA

Ph: 410-771-0380
Fax: 410-771-5576

www.murraycorp.com