



M-15 US MOBILE UNIT INFORMATION

Updated 06/02/2026



1080p Capable | Single Trailer Unit

M-15: TECHNICAL SPECIFICATIONS

POWER REQUIREMENTS

- 208 VOLT 3 PHASE - 1 400 AMP OR 2 200 AMP SERVICE REQUIRED

PRODUCTION SWITCHER

- KAYENNE X FRAME 5.5 M/E

CAMERAS

- 4 GRASS VALLEY LDX 86N XTREMESPEED CAMERA
- 8 GRASS VALLEY LDX 86N WORLDCAM CAMERA
- 6 SUPEREXPANDERS
- 6 HEAVY PANHEAD W/STICKS
- 5 LIGHTWEIGHT STICKS

LENSES

- 6 HARD LENSES
- 3 HANDHELD LENSES
- 2 WIDE ANGLE LENSES

RECORD/REPLAY

- 3 EVS XT3 12 CHANNEL LSM
- 1 EVS XT3 8 CHANNEL LSM
- 1 EVS XS 6 CHANNEL SPOT BOX
- 1 EVS XFILE3
- 1 BLACK MAGIC HYPERDECK
- 1 BLACK MAGIC DUPLICATOR

AUDIO

- CALREC ARTEMIS BEAM WITH 64 FADERS

COMMS

- RTS ADAM INTERCOM SYSTEM

SUPPORT EQUIPMENT

- LAWO/ARISTA IP ROUTER WITH INTEGRATED MULTVIEWERS
- 424 INPUTS X 356 OUTPUTS (SDI), INCLUDING FIBER KITS
- 275 INPUTS X 275 OUTPUTS EMBED/DE-EMBED
- 121 INPUTS X 81 OUTPUTS HD VIDEO
- 64 INPUTS X 81 OUTPUTS IP
- MADI 18 INPUTS X 18 OUTPUTS
- AES 96 INPUTS X 96 OUTPUTS
- ANALOG AUDIO 48 INPUTS X 48 OUTPUTS
- 4 UTILITY FRAME SYNC
- 1 FIBER BOOTH FIELD KIT
- 2 HYDRA BOXES
- BASIC TRUCK COMPLIMENT OF CABLE, MICS, ETC.



M-15

FLOORPLAN

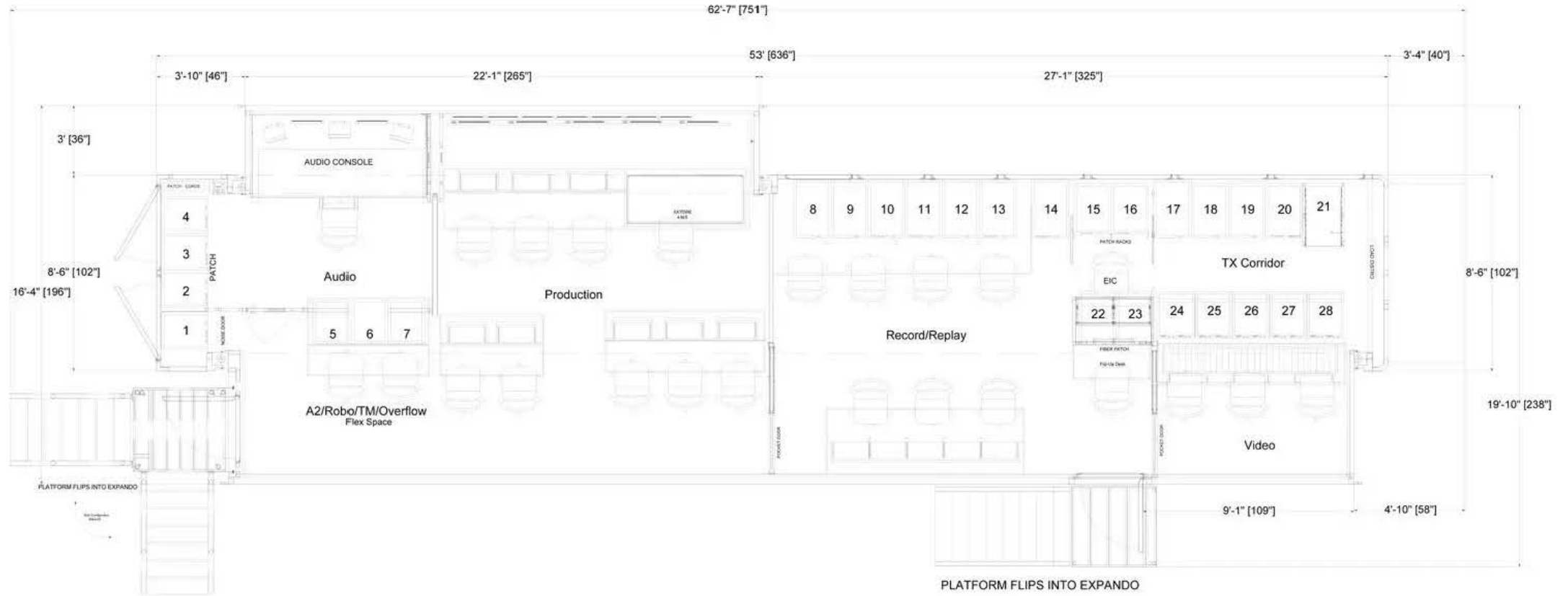

M-15

PRODUCTION MONITOR WALL

