



NCPXI US MOBILE UNIT INFORMATION

Updated 06/08/2026



1080p and HDR Capable | Supported by ST37

NCPXI: TECHNICAL SPECIFICATIONS

POWER REQUIREMENTS

- 400 AMP, 208 VOLT, 3 PHASE OR 2 200AMP,208 VOLT, 3 PHASE

PRODUCTION SWITCHER

- KAYENNE X FRAME - 5.5 M/E

CAMERAS

- 2 SONY HDC4300 CAMERAS
- 10 SONY HDC2500 CAMERAS
- 2 SONY HDC1500 CAMERAS
- 6 SLEDS
- 6 HEAVY PANHEAD W/STICKS
- 5 LIGHTWEIGHT STICKS
- 1 POV CAMERA

LENSES

- 6 HARD LENSES
- 4 HANDHELD LENSES
- 3 WIDE ANGLE LENSES

AUDIO

- CALREC ARTEMIS BEAM WITH 64 DUAL FADERS

COMMS

- RTS ADAM INTERCOM SYSTEM – 360 PORTS

RECORD/REPLAY

- 5 EVS XT VIA 12 CHANNEL
- 1 EVS XS VIA 6 CHANNEL SPOT BOX
- 1 EVS XFILE 3
- 1 EVS IP DIRECTOR
- 1 XT ACCESS
- 2 USB RECORDERS
- 1 PDW-F16 XD CAM VTR

SUPPORT EQUIPMENT

- UTAH SCIENTIFIC ROUTER
- HD VIDEO - 384 INPUTS X 720 OUTPUTS
- 96 INPUTS X 96 OUTPUTS EMBED/DE-EMBED
- MADI 24 INPUTS X 24 OUTPUTS
- AES 256 INPUTS X 256 OUTPUTS
- ANALOG AUDIO 64 INPUTS X 64 OUTPUTS
- 2 AJA FS2 FRAME SYNCs
- 1 AJA FS4 FRAME SYNCs
- 28 UTILITY FRAME SYNCs/PROCESSORS (20 HAVE COLOR CORRECTORS)
- 3 HYDRA BOXES
- BASIC TRUCK COMPLIMENT OF CABLE, MICS, ETC.



NCPXI

FLOORPLAN

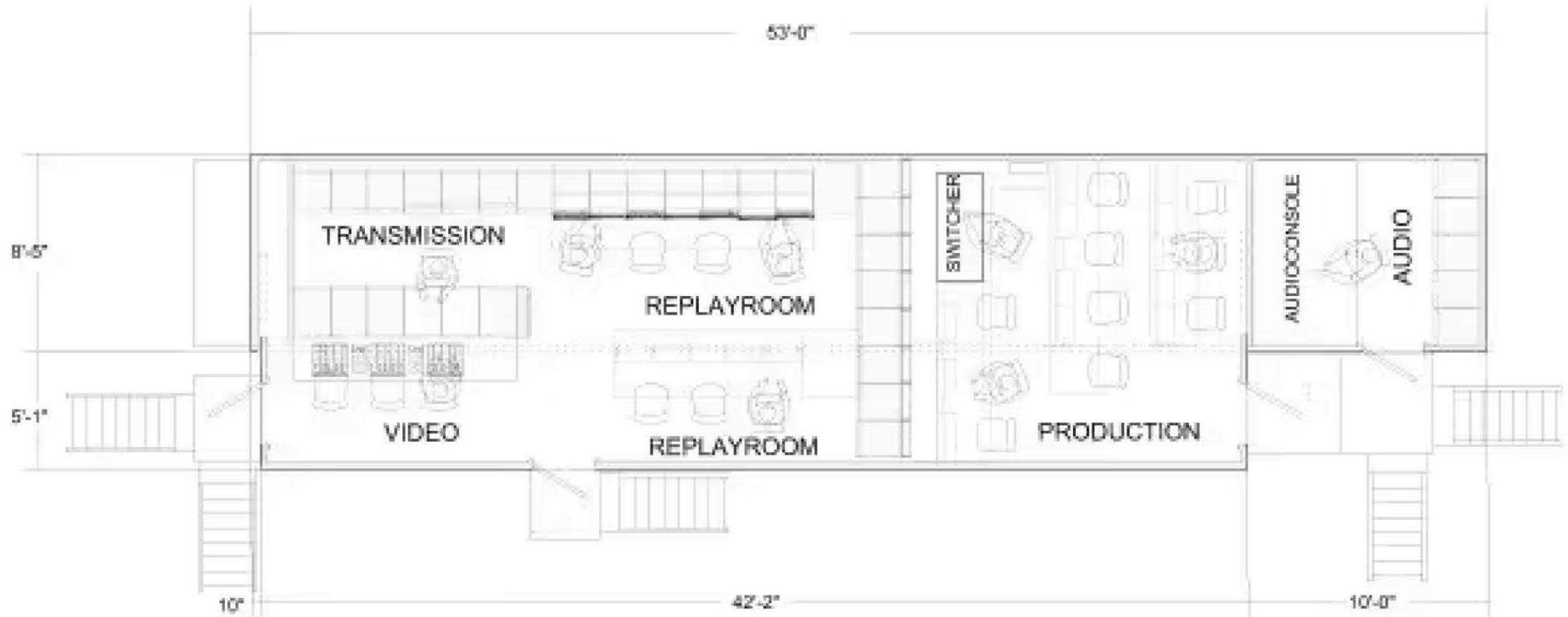

NCPXI

PRODUCTION MONITOR WALL

PROD 01		PROD 02		PROD 03		PROD 04		PROD 05		PROD 06		PROD 07		PROD 08					
PROD 09				PROD 10				PROD 11				PROD 12				PROD 13			
PROD 14				PROD 15				PROD 16				PROD 17				PROD 18			
PROD 19				PROD 20				PROD 21				PROD 22				PROD 23			

P2 BENCH			
KVM MONITOR			
P2-1	P2-2	P2-3	P2-4

P3 BENCH			
KVM MONITOR			
P3-1	P3-2	P3-3	P3-4



REPLAY MONITOR WALL

DATA PATCH			12:00:00	GREMI GEAR	ADAM FRAME		
			EVS X-HUBS				
		AJA KI PRO GO VTR 2	HITOMI MATCHBOX VTR 4		LANCE TD-100		
					RT ACCESS IF DIRECTOR		
TRC FVS SWITCH			X-FILE				
WOHLER 8	WOHLER 9	WOHLER 10	WOHLER 11	WOHLER 12	WOHLER 13	WOHLER 14	

KP PANEL	RTR PANEL	KP PANEL	RTR PANEL	KP PANEL RTR PANEL	KP PANEL	RTR PANEL

Show	Truck #	Type
	VT 1	XDCAM
	VT 2	
	VT 3	
	VT 4	HITOMI

Back Bench

Wohler 22	Wohler 23	TAPE AD RTR PANEL Wohler 24	Wohler 25	Wohler 26
KP PANEL	RTR PANEL	KP PANEL	KP PANEL	RTR PANEL

SHOW	TRUCK #	TYPE
	1A	LSM
	1B	LSM
	1C	LSM
	1D	LSM
	2A	LSM
	2B	LSM
	2C	LSM
	2D	LSM
	3A	LSM
	3B	LSM
	3C	LSM
	3D	LSM
	4A	LSM
	4B	LSM
	4C	LSM
	4D	LSM

SHOW	TRUCK #	TYPE
	5A	LSM
	5B	LSM
	5C	LSM
	5D	LSM
	6A	LSM
	6B	LSM
	6C	LSM
	6D	LSM
	SPOT A	SPOT
	SPOT B	SPOT
	SPOT C	SPOT
	SPOT D	SPOT
	SPOT E	SPOT
	SPOT F	SPOT



VIDEO MONITOR WALL

