



NCPVII US MOBILE UNIT INFORMATION

Updated 06/08/2026



Travels with A & B Unit

NCPVII: TECHNICAL SPECIFICATIONS

VEHICLE-SPECIFIC INFORMATION

- **A-UNIT:** 2 208 VOLT, 3 PHASE, 200 AMPS OR 1 208 VOLT, 3 PHASE, 400 AMPS
- **B-UNIT:** 1 208 VOLT, 3 PHASE, 200 AMPS

PRODUCTION SWITCHER

- GVG KAYENNE X-FRAME SWITCHER, 9 M/E

CAMERAS

- 2 SONY HDC 4300 CAMERA
- 14 SONY HDC 2500 CAMERA
- 1 SONY HDC 2400 CAMERA
- 5 SLEDS
- 5 HEAVY PANHEAD W/STICKS
- 5 LIGHTWEIGHT STICKS
- 4 SETS HH CAMERA WHEELS
- 1 SONY PDWXD ENG CAMERA PACKAGE

LENSES

- 1 CANON 100X9.3 HARD LENS
- 4 CANON 86X9.3 HARD LENS
- 5 CANON LENS 21:1 HAND HELD LENS
- 5 CANON 4.7 WIDE ANGLE LENS

RECORD & PLAYBACK

- 3 EVS XT3 6 CHANNEL LSM
- 1 EVS XT3 8 CHANNEL LSM
- 5 EVS XT3 12 CHANNEL LSM
- 1 EVS XS3 6 CHANNEL SPOTBOX
- 5 EVS X-FILE3
- 1 USB RECORDER/STREAMER

AUDIO

- CALREC ARTEMIS BEAM DIGITAL AUDIO CONSOLE WITH 64 DUAL LAYER FADERS

COMMUNICATIONS

- RTS ADAM INTERCOM SYSTEM - 280 PORTS

SUPPORT EQUIPMENT

- UTAH SCIENTIFIC ROUTER
- HD VIDEO - 384 INPUTS X 812 OUTPUTS
- EMBED/DE-EMBED 96 INPUTS X 96 OUTPUTS (16 CHANNELS)
- MADI 21 INPUTS X 21 OUTPUTS
- 43 UTILITY FRAME SYNC/PROCESSORS
- BASIC TRUCK COMPLIMENT OF CABLE, MICS, ETC.



NCPVII A-UNIT

FLOORPLAN

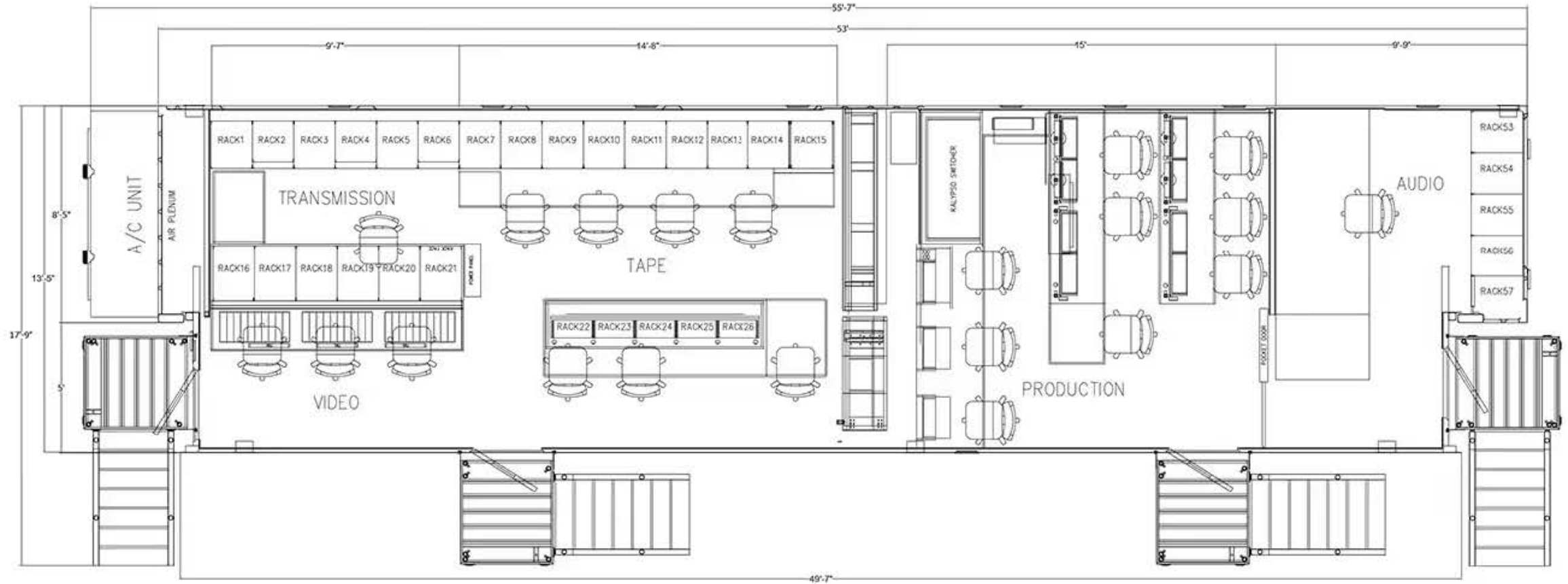

NCPVII B-UNIT

FLOORPLAN

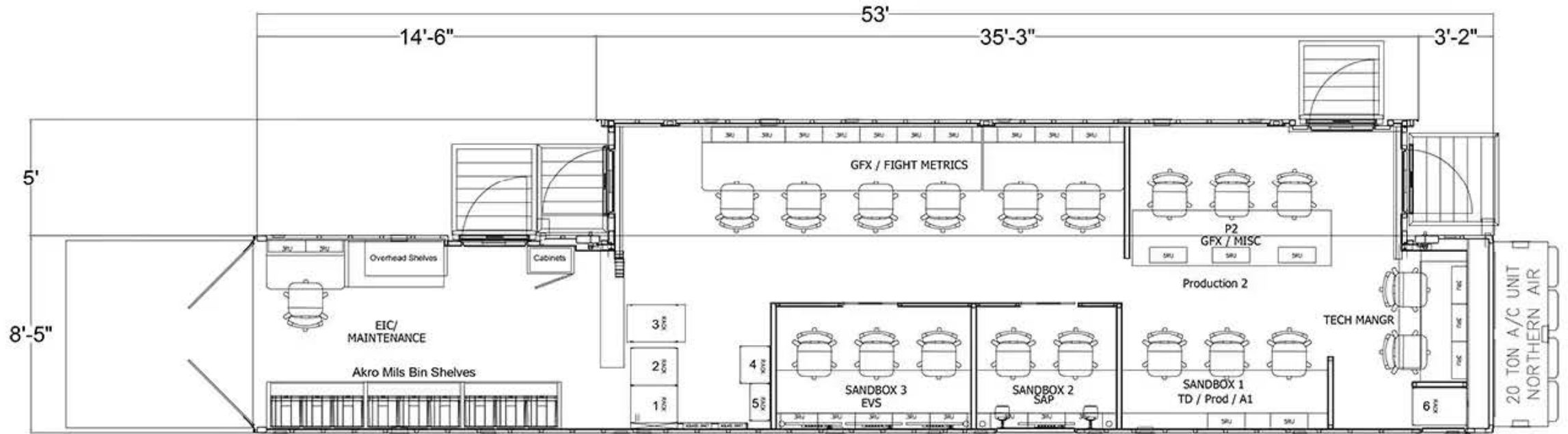

NCPVII

PRODUCTION MONITOR WALL

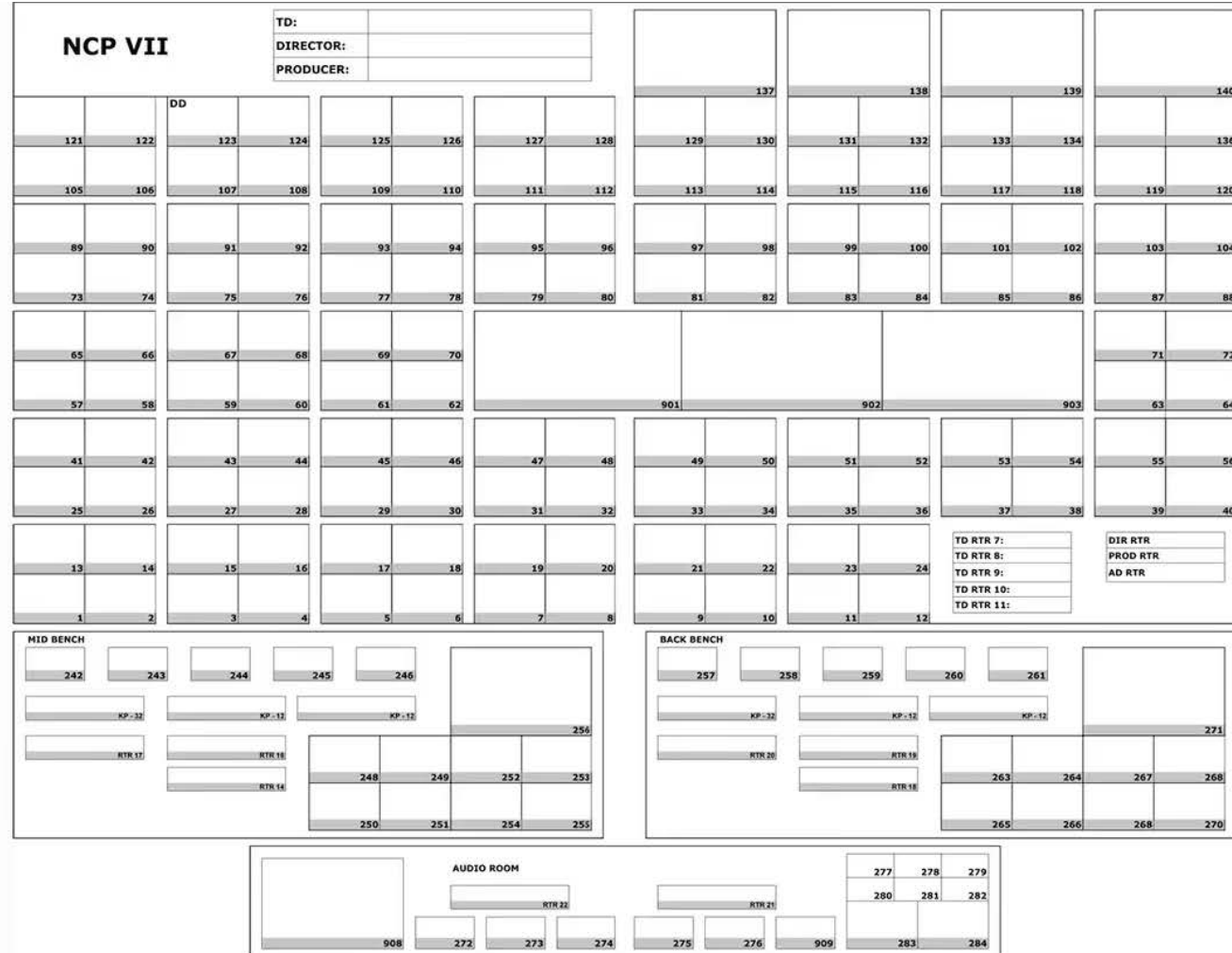

REPLAY MONITOR WALL

More Patching			More Patching			More Patching			More Patching			ADAM FRAME			TALLY FRAME USD 264			More Patching			VTR 40 D-5		
VTR 31			VTR 32			VTR 33			VTR 34			VTR 35			VTR 36			VTR 37			VTR 39		
WOHLER			WOHLER			WOHLER			WOHLER			WOHLER			WOHLER			WOHLER			WOHLER		
LCD 47			LCD 48			LCD 49			LCD 50			LCD 51			LCD 52			LCD 53			LCD 54		
293	294	295	301	302	303	309	310	311	317	318	319	325	326	327	333	334	335	341	342	342	349	350	
296	297	298	304	305	306	312	313	314	320	321	322	328	329	330	336	336	338	344	345	346	349	350	
299	300	307	308	315	316	323	324	331	332	339	340	347	348	349	350	351	352	353	354	357	358		
LCD 54			LCD 55			LCD 56			LCD 57			LCD 58			LCD 59			LCD 60			VTR 38		
349			353			357			361			365			369			373			349		
351			355			359			363			367			371			375			357		
RK 8			RK 9			RK 10			RK 11			RK 12			RK 13			RK 14			RK 15		
RTR 31			RTR 32			RTR 33			RTR 34			RTR 35			RTR 36			RTR 37			RTR 38		

BACK DESK

LCD 66				LCD 67			
481	482	483	484	493	494	495	496
485	486	487	488	497	498	499	500
489	490	491	492	501	502	503	504

LEFT LCD

LCD 61			LCD 62			LCD 63			LCD 64			LCD 65		
377	378	379	385	386	387	393	394	395	401	402	403	409	410	411
380	381	382	388	389	390	396	397	398	404	405	406	412	413	414
383	384	391	392	399	400	407	408	415	416					

Show	Truck #	Type	Show	Truck #	Type	Show	Truck #	Type
	31		41	XT2		53		
	32	DVC	42	XT2		54		
	33		43	XT2		55		
	34	HDCM	44	XT2		56		
	35	DVC	45	XT2		57		
	36		46	XT2		58		
	37		47	XT2		59		
	38		48	XT2		60		
	39	A500	49			85		
	40	A500	50			86		
			51	RO		87		
			52	RO		88		



NCPVII

VIDEO MONITOR WALL

Triax Patch		SPK		21:12:01		Radio		SPK			
LCD 68	DUO 68A	LCD 69	DUO 68B	LCD 70	DUO 70A	LCD 71	DUO 70B	LCD 72	DUO 72A	LCD 73	DUO 72B
505	506	509	510	513	514	517	518	521	522	525	526
507	508	511	512	515	516	519	520	523	524	527	528
MON 905		LCD 74	VIP 74	MON 906		LCD 75	VIP 75	MON 907		LCD 76	
		529	530			533	534			537	538
		531	532			535	536			539	540
WFM	VECTOR	FS CONTROL AMP		WFM	VECTOR	WFM		Vector			
RTS				RTS				RTS		TIE LINES	
CCU 1		CCU 5		CCU 9		CCU 13		CCU 17		CCU 21	
CCU 2		CCU 6		CCU 10		CCU 14		CCU 18		CCU 22	
CCU 3		CCU 7		CCU 11		CCU 15		CCU 19		CCU 23	
CCU 4		CCU 8		CCU 12		CCU 16		CCU 20		CCU 24	



NCPVII

BUNIT MONITOR WALLS

