



ND6 US MOBILE UNIT INFORMATION

Updated 06/02/2026



1080p and HDR Capable | ST3 Can Be Added for Additional Support

ND6: TECHNICAL SPECIFICATIONS

POWER REQUIREMENTS

- 208 VOLTS, 3 PHASE, 400 AMPS OR 1 –200AMPS

PRODUCTION SWITCHER

- KAYENNE K FRAME - 5 M/E

CAMERAS

- 2 SONY HDC4300 CAMERAS
- 10 SONY HDC3500 CAMERAS
- 6 SLEDS
- 6 HEAVY PANHEAD W/STICKS
- 6 LIGHTWEIGHT STICKS
- 1 ENG KIT

LENSES

- 6 HARD LENSES
- 6 HANDHELD LENSES
- 2 WIDE ANGLE LENSES

RECORD/REPLAY

- 5 EVS XT3 12 CHANNEL LSM
- 1 EVS XS 6 CHANNEL SPOT BOX
- 1 EVS XFILE3
- 1 EVS IP DIRECTOR

AUDIO

- CALREC ARTEMIS BEAM WITH 64 DUAL FADERS

COMMS

- RTS ADAM INTERCOM SYSTEM – 144 PORTS

SUPPORT EQUIPMENT

- PESA ROUTER
- HD VIDEO - 288 INPUTS X 288 OUTPUTS (16 CHANNELS)
- MADI 4 INPUTS X 6 OUTPUTS
- AES 512 INPUTS X 640 OUTPUTS
- ANALOG AUDIO 128 INPUTS X 128 OUTPUTS
- 22 UTILITY FRAME SYNCs/PROCESSORS
- 10 AJA FSHDR
- 2 AJA FS2
- 2 FIBER BOOTH FIELD KITS
- 3 HYDRA BOXES
- BASIC TRUCK COMPLIMENT OF CABLE, MICS, ETC.



ND6

FLOORPLAN

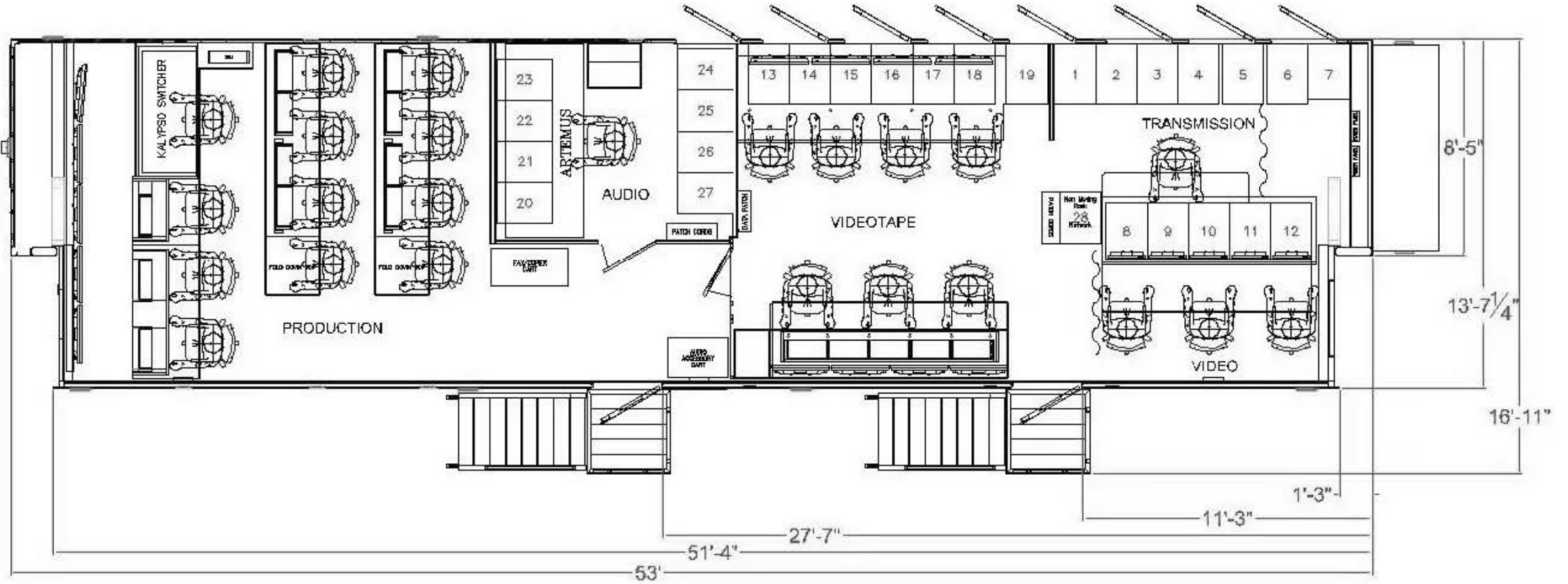

ND6

PRODUCTION MONITOR WALL

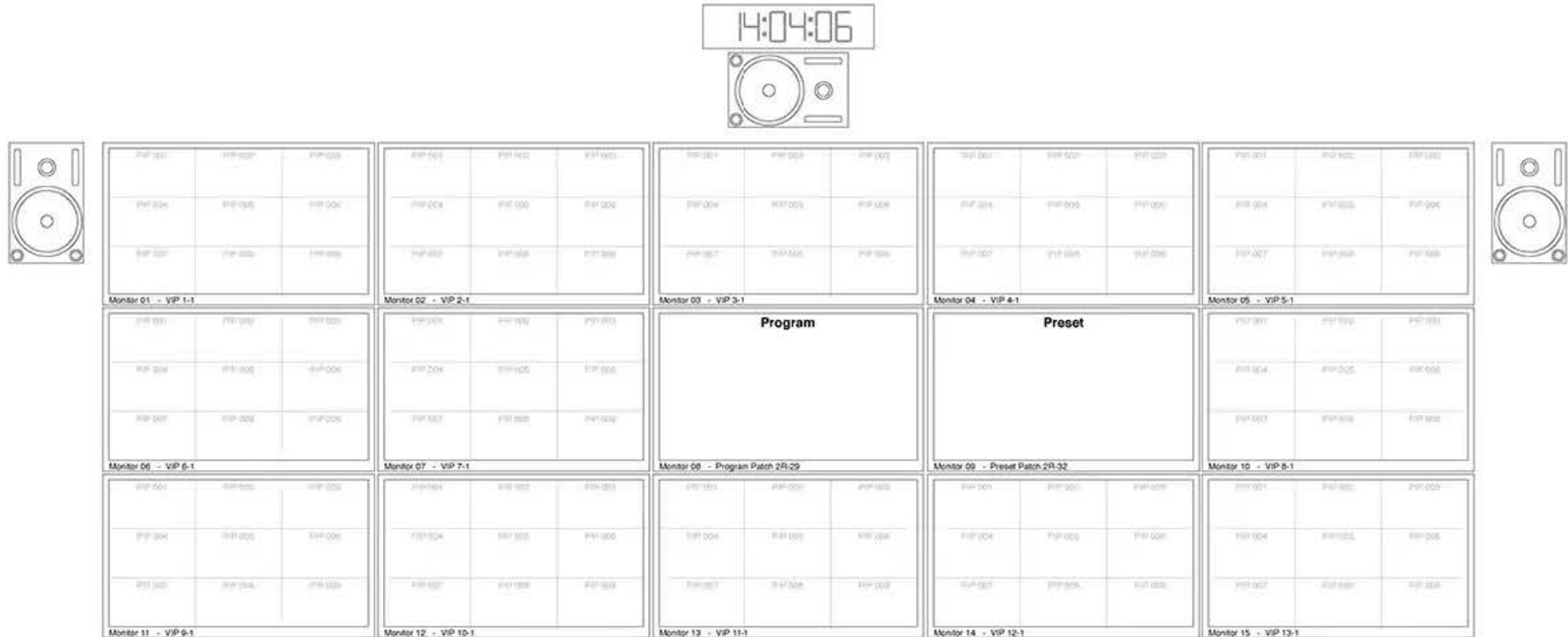

ND6 PRODUCTION P2 BENCH MONITOR WALL



ND6 PRODUCTION P3 BENCH MONITOR WALL

VP 101	VP 102	VP 103
VP 104	VP 105	VP 106
VP 107	VP 108	VP 109

Monitor 01 - VP 1-3

VP 201	VP 202	VP 203
VP 204	VP 205	VP 206
VP 207	VP 208	VP 209

Monitor 02 - VP 2-3

CG CANVAS 02

Monitor 03 - KVM Patch

ND6

REPLAY MONITOR WALL



ND6

REPLAY CONSOLE MONITOR WALL



ND6

VIDEO MONITOR WALL



ND6

AUDIO MONITOR WALL

