



SUPERSHOOTER 14 US MOBILE UNIT INFORMATION

Updated 06/01/2026

NEPGROUP.COM



Single Trailer Mobile Unit Based in Hawaii

SUPERSHOOTER 14: TECHNICAL SPECIFICATIONS

POWER REQUIREMENTS

- 400 AMP, 208 VOLT, 3 PHASE OR 2 200AMP, 208 VOLT, 3 PHASE

PRODUCTION SWITCHER

- GVG KALYPSO SWITCHER, 4 M/E

CAMERAS

- 6 SONY HDC1000 CAMERA
- 5 SONY HDC1500 CAMERA
- 1 SONY HDC1500R CAMERA
- 6 HEAVY PANHEAD W/STICKS
- 6 HLIGHTWEIGHT STICKS

LENSES

- 6 HARD LENSES
- 2 HANDHELD LENSES
- 2 WIDE ANGLE LENSES

RECORD & PLAYBACK

- 4 EVS XT3 6 CHANNEL
- 1 EVS XT3 SPOTBOX
- 1 EVS X-FILE3
- 1 SONY HDW-2000 HDCAM VTR
- 1 SONY HDW-M2000 HDCAM VTR
- 3 DVD RECORDER W/ REMOTE CONTROL

AUDIO

- CALREC ALPHA DIGITAL AUDIO CONSOLE WITH 60 DUAL LAYER FADERS
- 1 DOLBY ENCODER/DECODER PACKAGE
- 2 DIGICART
- 1 CD PLAYER

COMMUNICATIONS

- ADAM INTERCOM SYSTEM - 120 PORTS

SUPPORT EQUIPMENT

- THOMPSON ROUTER
- 1 HYDRA 1 BOX (24X8)
- 15 UTILITY FRAME SYNCs/PROCESSORS
- 4 HD VIDEO OVER FIBER TRANSMITTERS
- 2 FIBER BOOTH KITS
- BASIC TRUCK COMPLIMENT OF CABLE, MICS, ETC.



SUPERSHOOTER 14

FLOORPLAN

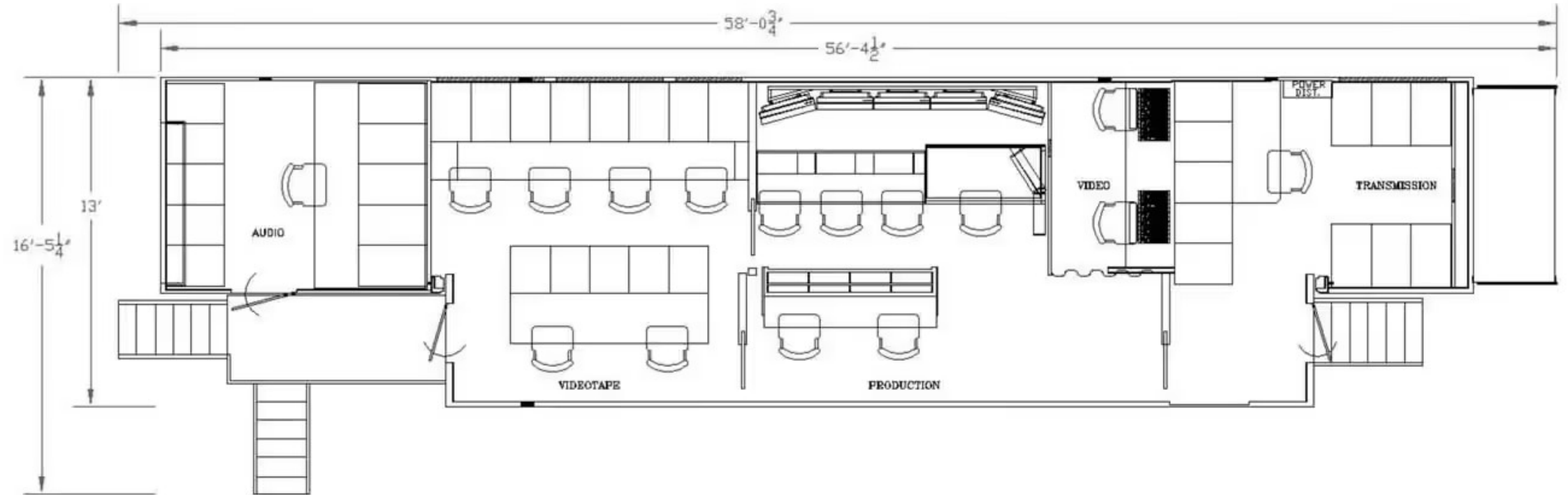

SUPERSHOOTER 14

PRODUCTION MONITOR WALL

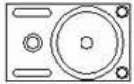

CLOCK

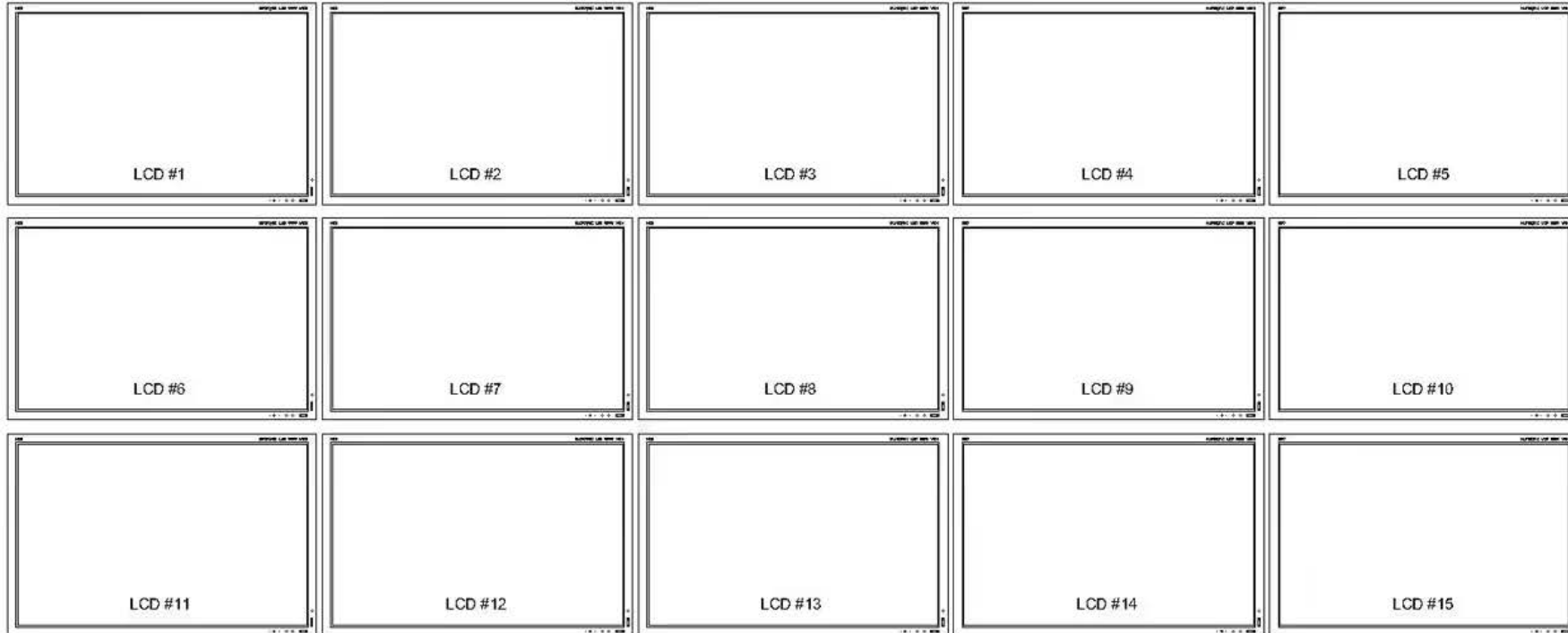
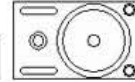

SUPERSHOOTER 14

TAPE MONITOR WALL

