



SUPERSHOOTER 22

US MOBILE UNIT

INFORMATION

Updated 05/28/2026



IP-Based, TFC Driven, 1080p and HDR Capable | Travels with B support unit, ST22

SUPERSHOOTER 22: TECHNICAL SPECIFICATIONS

POWER REQUIREMENTS

- 208 VOLT 3 PHASE
- A UNIT: 1 400 AMP OR 2 200 AMP SERVICE REQUIRED
- B UNIT: 1 200 AMP SERVICE REQUIRED

PRODUCTION SWITCHER

- KAYENNE K FRAME

CAMERAS

- 8 SONDY HDC5500 CAMERAS
- 5 SONY HDC3500 CAMERAS
- 2 SONY HDC2500 CAMERAS
- 8 SLEDS
- 9 HEAVY PANHEAD W/STICKS
- 8 LIGHTWEIGHT STICKS

LENSES

- 8 HARD LENSES
- 6 HANDHELD LENSES
- 5 WIDE ANGLE SENSES

RECORD/REPLAY

- 6 EVS XT-VIA 12 CHANNEL
- 1 EVS XS VIA 6 CHANNEL SPOT BOX
- 2 EVS XFILE3
- 2 EVS IP DIRECTOR
- 1 EVS XT ACCESS
- NO USB RECORDER

AUDIO

- MAIN MIX: CALREC APOLLO WITH 72 DUAL FADERS
- SUB MIX: CALREAC ARTEMIS BEAM WITH 48 DUAL FADERS

SUPPORT EQUIPMENT

- EVERTZ EQX ROUTER
- HD VIDEO - 324 INPUTS X 1152 OUTPUTS
- 224 INPUTS X 256 OUTPUTS EMBED/DE-EMBED
- MADI 35 INPUTS X 35 OUTPUTS
- AES 192 INPUTS X 192 OUTPUTS
- ANALOG AUDIO 96 INPUTS X 96 OUTPUTS
- 2 FIBER FIELD/BOOTH KITS
- 2 AJA FSD HDR
- 1 AJA FS4 FRAME SYNC
- 40 UDX CONVERTERS WITH COLOR CORRECTOR
- 3 HYDRA BOXES
- BASIC TRUCK COMPLIMENT OF CABLE, MICS, ETC.



SUPERSHOOTER 22 A-UNIT FLOORPLAN

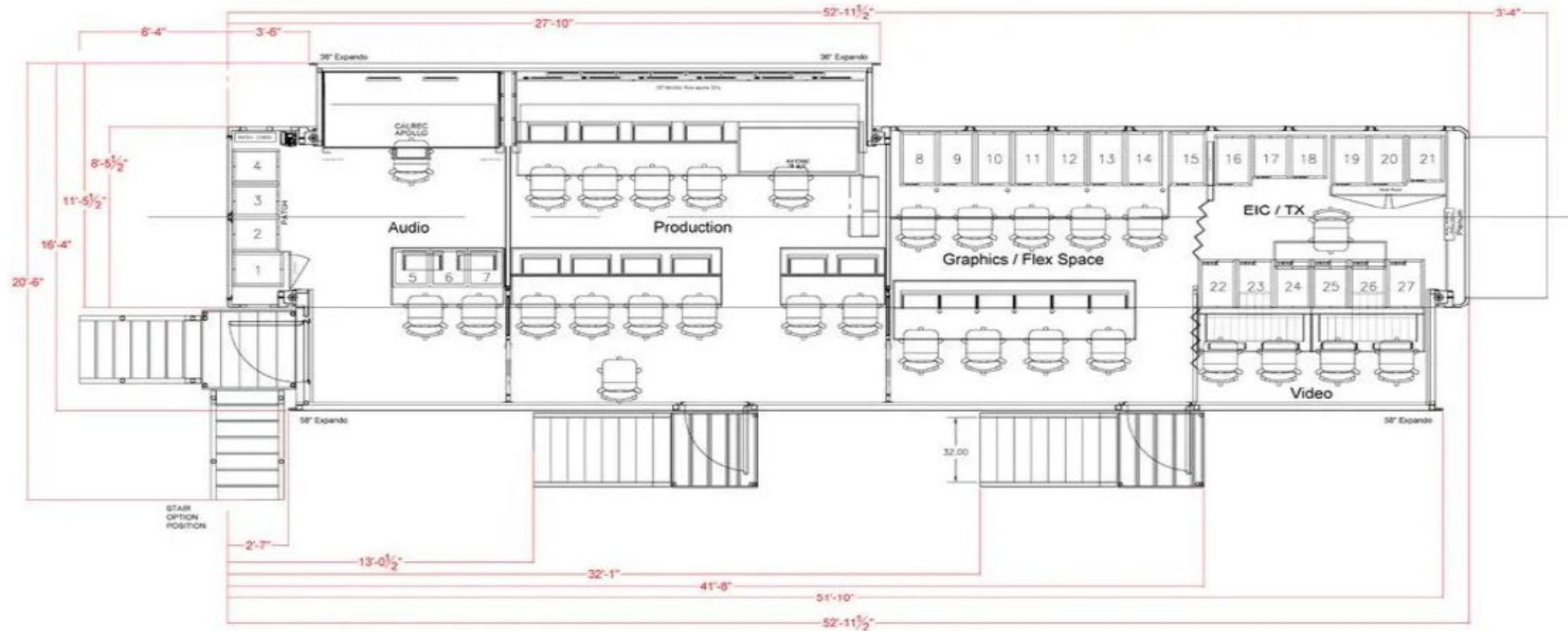

ST22 B-UNIT

FLOORPLAN

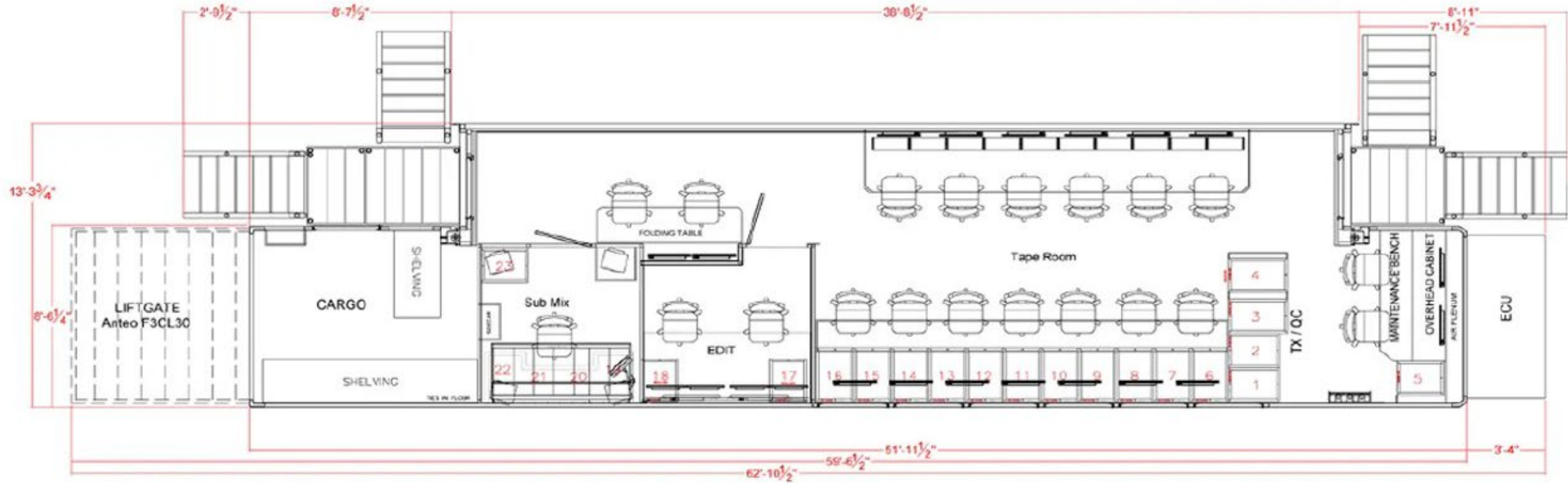

SUPERSHOOTER 22

VIDEO MONITOR WALL

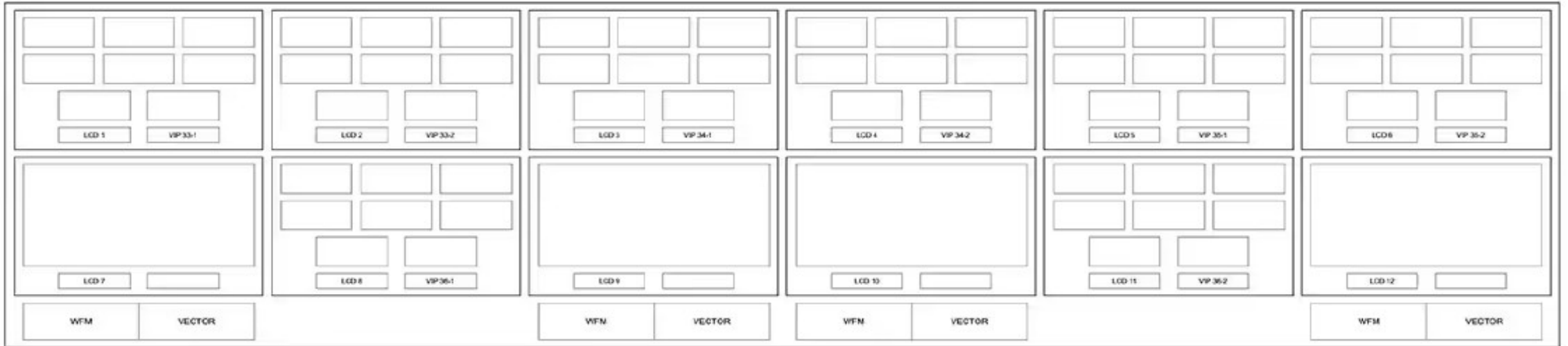

SUPERSHOOTER 22

PRODUCTION MONITOR WALL

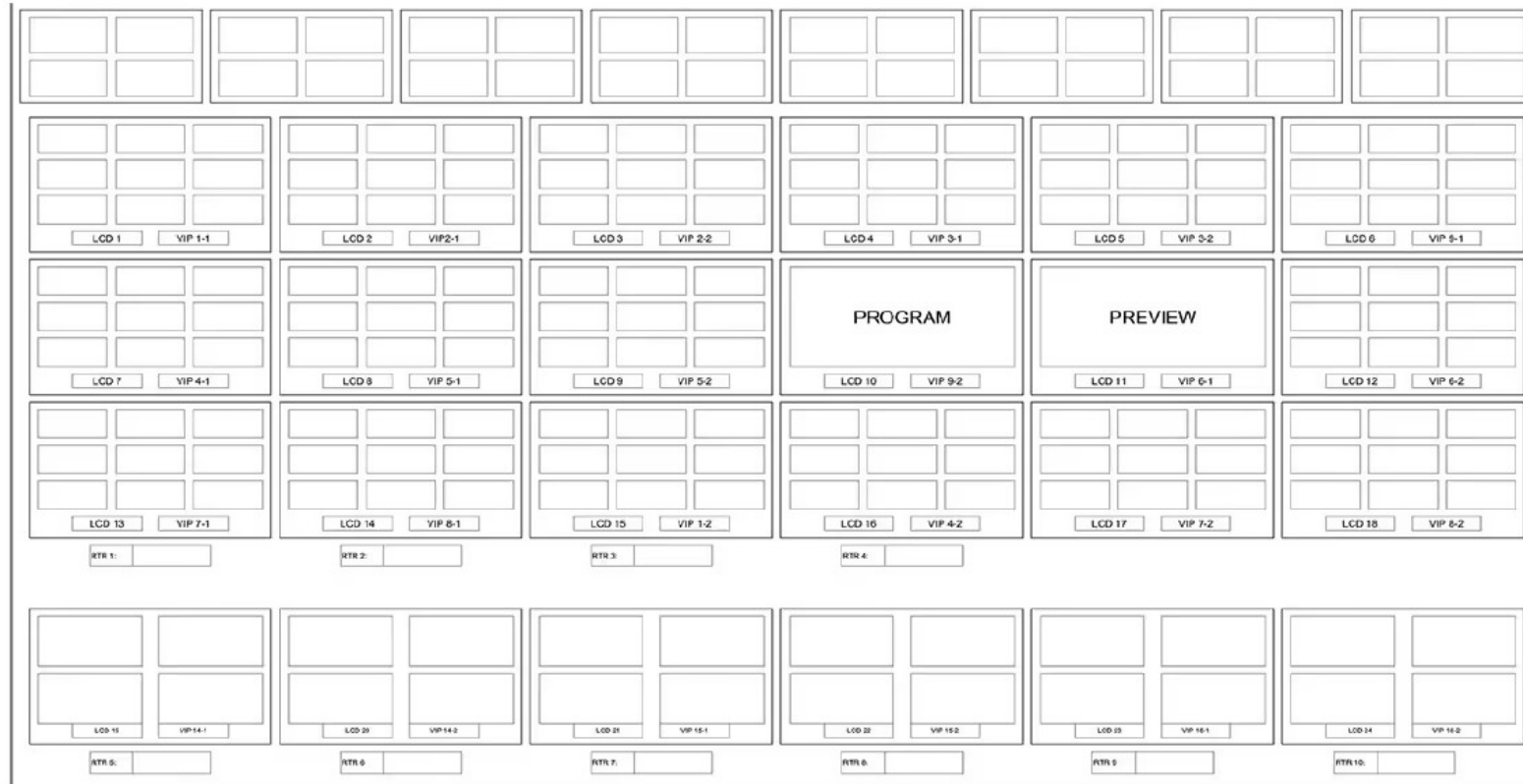

SUPERSHOOTER 22

FLEX MONITOR WALL



SUPERSHOOTER 22

AUDIO MONITOR WALL

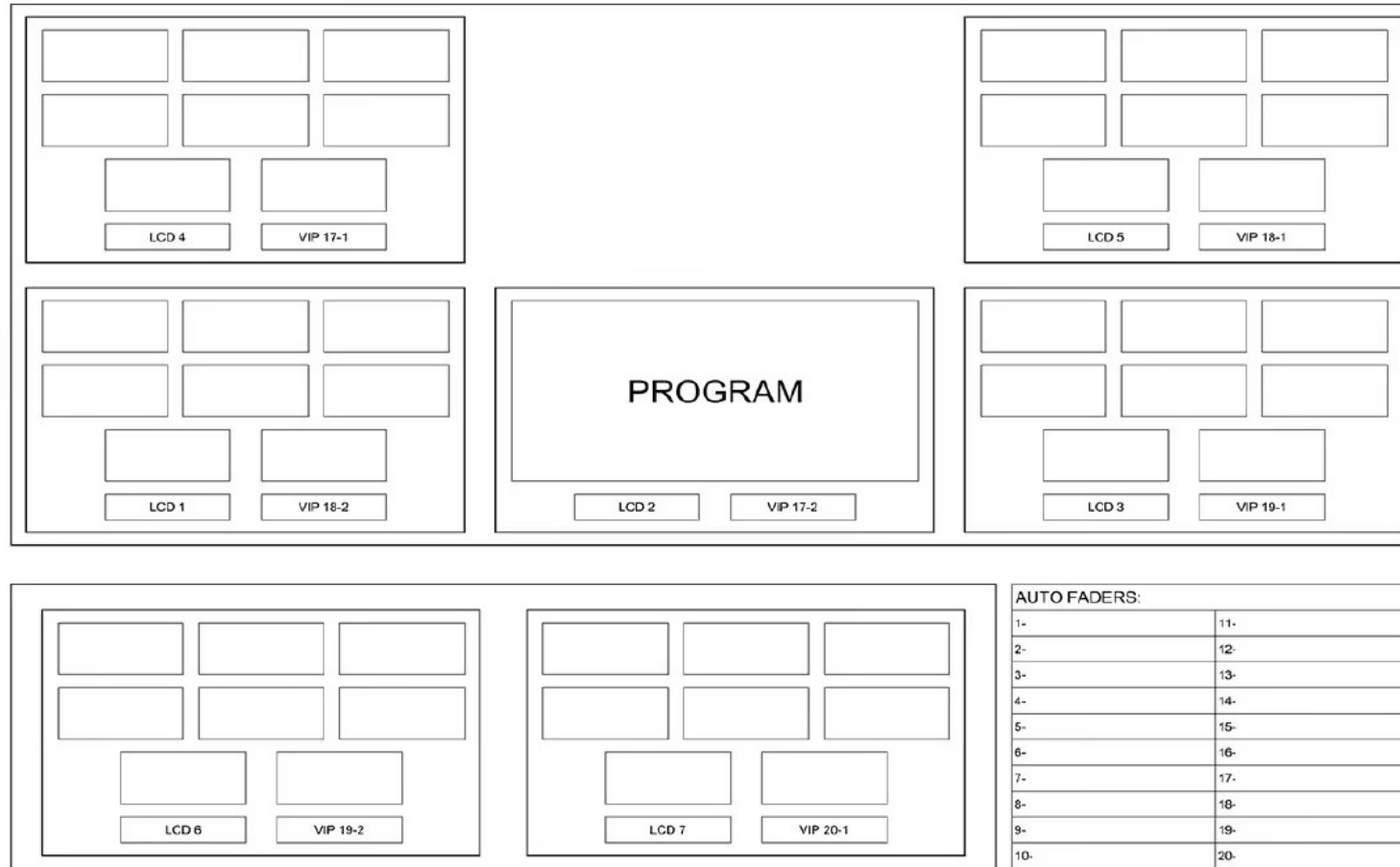

SUPERSHOOTER 22

RECORD & REPLAY MONITOR WALL



SUPERSHOOTER 22

SUBMIX & EDIT MONITOR WALL

