



SUPERSHOOTER 26 US MOBILE UNIT INFORMATION

Updated 05/29/2026



Travels with support B-unit, ST26

SUPERSHOOTER 26: TECHNICAL SPECIFICATIONS

POWER REQUIREMENTS

- POWER: 208-240 VOLTS/SINGLE
- POWER: 208-240 VOLTS/SINGLE
- "A" UNIT IRIIDIUM: 208-240 VOLTS THREE PHASE - NO NEUTRAL, 400 AMP SERVICE REQUIRED OR TWO 200 AMP SERVICES\
- ENVIRONMENTAL AND TECHNICAL POWER SPLIT AVAILABLE; TECH POWER TRANSFORMER TAP SELECTABLE
- 3 STACO REGULATORS W/BYPASS
- "B" UNIT ZINC: 208-240 VOLTS SINGLE PHASE, 150 AMP SERVICE REQUIRED

PRODUCTION SWITCHER

- KAYENNE K FRAME - 9 M/E

CAMERAS

- 2 SONY HDC4300 CAMERAS
- 12 SONY HDC2500 CAMERAS
- 2 SONY HDC1550 CAMERAS
- 8 SLEDS
- 8 HEAVY PANHEADS W/STICKS
- 8 LIGHTWEIGHT STICKS
- 1 ENG KIT

LENSES

- 8 HARD LENSES
- 6 HANDHELD LENSES
- 1 WIDE ANGLE LENSES

RECORD/REPLAY

- 3 EVX XT3 12 CHANNEL LSM
- 3 EVX XT3 6 CHANNEL LSM
- 1 EVS XS3 4 CHANNEL SPOT BOX
- 1 EVS XFILE 3
- 1 EVS IP DIRECTOR
- 2 1 EVX XT ACCESS
- 1 PDW-F1500 XDCAM VTR

AUDIO

- CALREC SIGMA WITH 64 DUAL FADERS

COMMS

- RTS ADAM INTERCOM SYSTEM

SUPPORT EQUIPMENT

- EVERTZ EQX ROUTER
- HD VIDEO - 396 INPUTS X 436 OUTPUTS
- MADI 20 INPUTS X 20 OUTPUTS
- 128 INPUTS X 144 OUTPUTS EMBED/DE-EMBED
- AES 224 INPUTS X 320 OUTPUTS
- ANALOG AUDIO 160 INPUTS X 96 OUTPUTS
- 18 UDX FRAME SYNCs WITH COLOR CORRECTORS
- 4 AJA FS2 FRAME SYNCs
- 1 BOOTH KIT
- 2 HYDRA BOXES
- BASIC TRUCK COMPLIMENT OF CABLE, MICS, ETC.



SUPERSHOOTER 26

FLOORPLAN

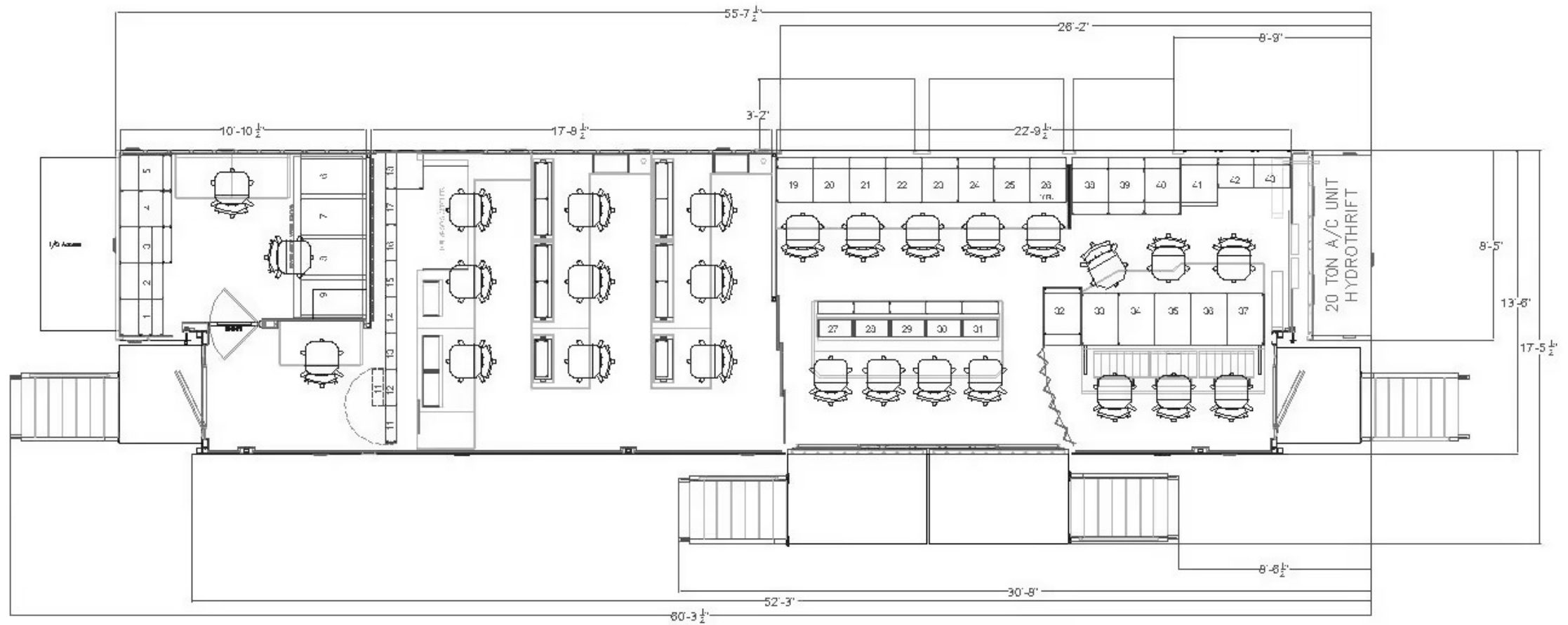

ST26

FLOORPLAN

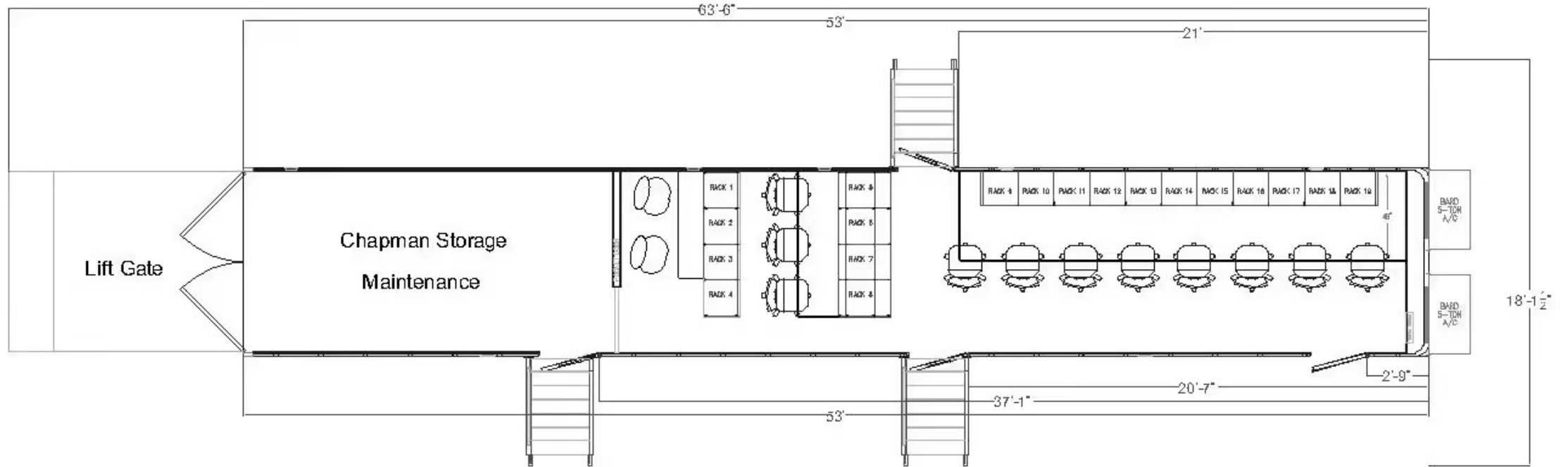

SUPERSHOOTER 26

MONITOR WALL

