



SUPERSHOOTER CBS US MOBILE UNIT INFORMATION

Updated 06/02/2026

NEPGROUP.COM



IP-Based, TFC-Driven, 1080p and HDR Capable | Travels with A, B, C, and D Unit

SUPERSHOOTER CBS: TECHNICAL SPECIFICATIONS

POWER REQUIREMENTS

- A, C AND D UNITS: 208 VOLTS, 3 PHASE, 200 AMPS
- B-UNIT: 208 VOLTS, 3 PHASE, 400 AMPS OR2 - 200 AMPS

PRODUCTION SWITCHER

- KAYENNE K FRAME, 9 M/E

CAMERAS

- 7 SONY HDC 5500 CAMERAS
- 14 SONDY HDC 3500 CAMERAS
- 11 SLEDS
- 11 HEAVY PANHEAD W/STICKS
- 10 LIGHTWEIGHT STICKS
- 1 ENG KIT

LENSES

- 11 HARD LENSES
- 14 HANDHELD LENSES
- 9 WIDE ANGLE LENSES

RECORD/REPLAY

- 8 EVS XT-VIA 12 CHANNEL
- 1 EVS XS VIA 6 CHANNEL SPOT BOX
- 2 EVS XFILE3
- 5 EVS IP DIRECTOR
- 2 EVS XT ACCESS
- 2 EVS SQL DATABASE SERVERS
- EVS XNET VIA

AUDIO

- MAIN MIX: CALREC APOLLO DIGITAL AUDIO CONSOLE WITH 72 DUAL FADERS
- SUB MIX: CALREC ARTEMIS BEAM DIGITAL AUDIO CONSOLE WITH 64 DUAL FADERS

COMMS

- RTS ADAM INTERCOM SYSTEM – 864 PORTS

SUPPORT EQUIPMENT

- NEP TFC/CISCO ROUTER
- HDI/SDI VIDEO - 954 INPUTS X 842 OUTPUTS
- MADI 28 INPUTS X 43 OUTPUTS
- AES 320 INPUTS X 64 OUTPUTS
- ANALOG AUDIO 320 INPUTS X 128 OUTPUTS
- 22 UTILITY FRAME SYNC/PROCESSORS
- 5 FIBER/BOOTH FIELD KITS
- 10 HYDRA BOXES
- BASIC TRUCK COMPLIMENT OF CABLE, MICROPHONES AND OTHER SUPPORT EQUIPMENT



SUPERSHOOTER CBS A-UNIT

FLOORPLAN

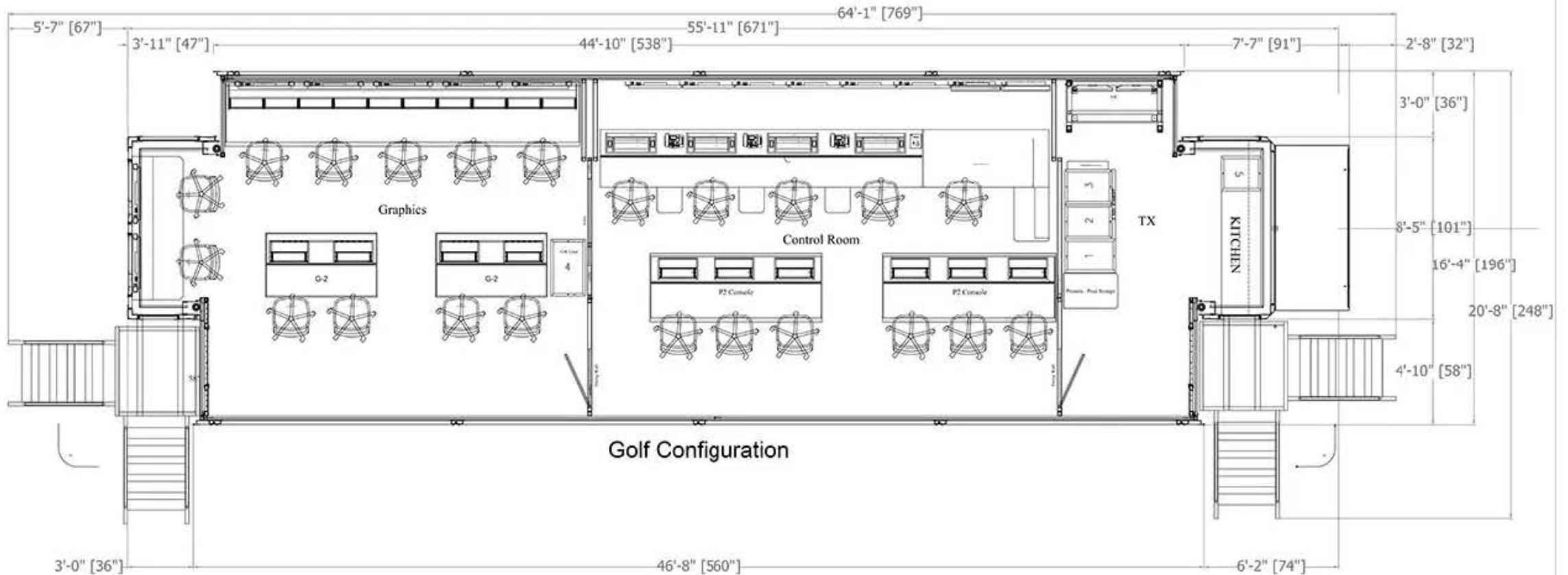

SUPERSHOOTER CBS A-UNIT

FLOORPLAN

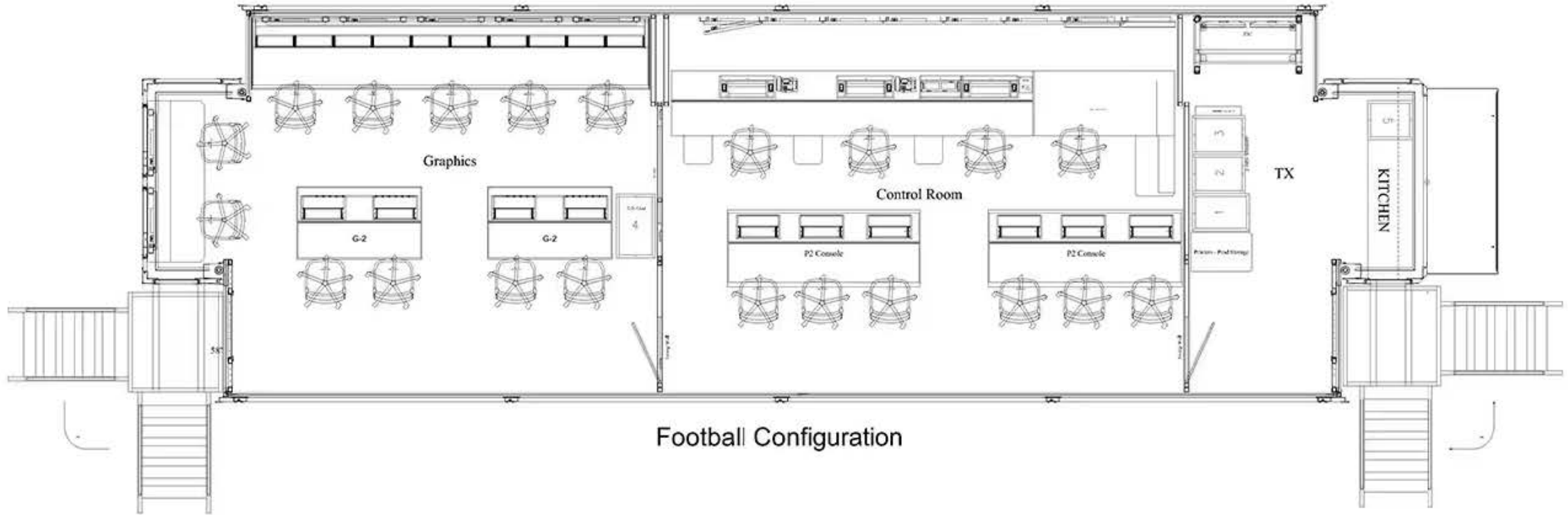

SUPERSHOOTER CBS B-UNIT

FLOORPLAN

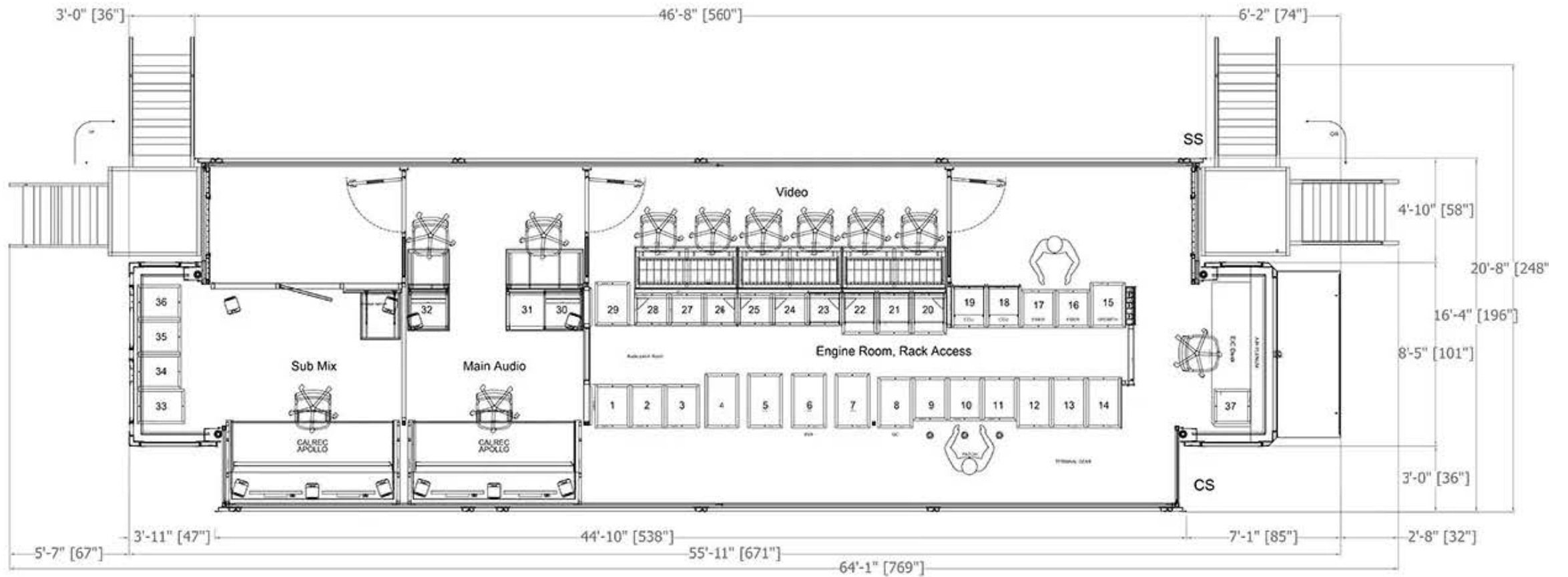

SUPERSHOOTER CBS C-UNIT

FLOORPLAN

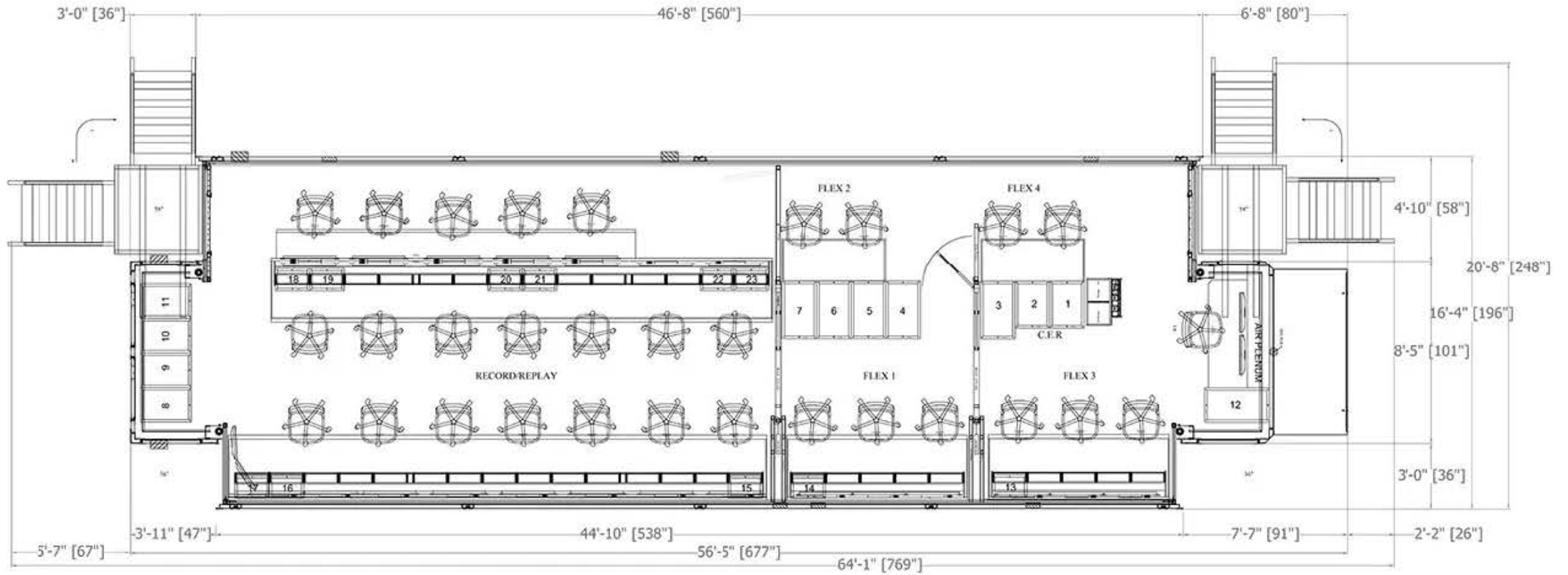

SUPERSHOOTER CBS D-UNIT

FLOORPLAN

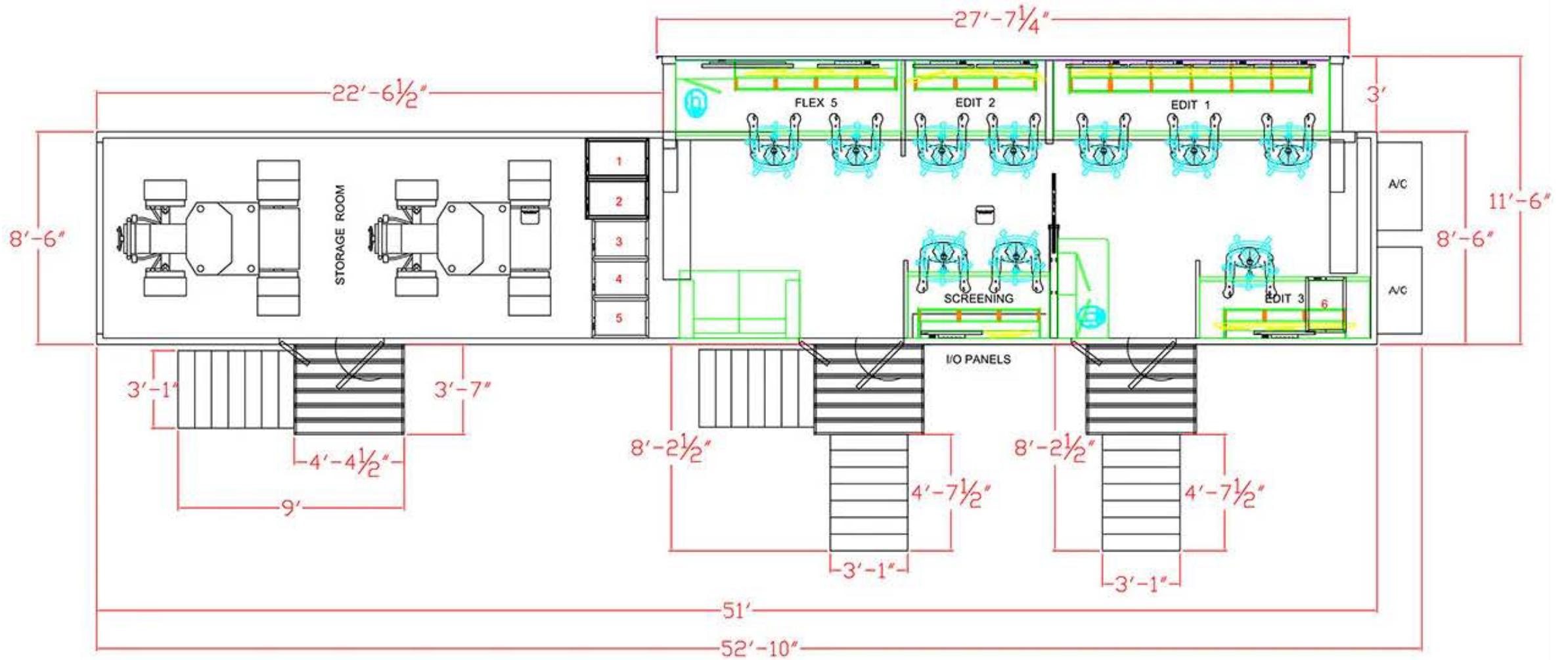

SUPERSHOOTER CBS

PRODUCTION MONITOR WALL

1	2	3	10	11	12	19	20	21	28	29	30	1	2	3	10	11	12	19	20	21	28	29	30
4	5	6	13	14	15	22	23	24	31	32	33	4	5	6	13	14	15	22	23	24	31	32	33
7	8	9	16	17	18	25	26	27	34	35	36	7	8	9	16	17	18	25	26	27	34	35	36
1	2	3	10	11	12	19	20	21	28	29	30				19	20	21	28	29	30			
4	5	6	13	14	15	22	23	24	31	32	33				22	23	24	31	32	33			
7	8	9	16	17	18	25	26	27	34	35	36				25	26	27	34	35	36			
1	2	3	10	11	12	19	20	21	28	29	30	1	2	3	10	11	12	19	20	21	28	29	30
4	5	6	13	14	15	22	23	24	31	32	33	4	5	6	13	14	15	22	23	24	31	32	33
7	8	9	16	17	18	25	26	27	34	35	36	7	8	9	16	17	18	25	26	27	34	35	36
PROGRAM			AVAILABLE VIPS: 																				
1	2	3	10	11	12	19	20	21	28	29	30	1	2	3	10	11	12	19	20	21	28	29	30
4	5	6	13	14	15	22	23	24	31	32	33	4	5	6	13	14	15	22	23	24	31	32	33
7	8	9	16	17	18	25	26	27	34	35	36	7	8	9	16	17	18	25	26	27	34	35	36



REPLAY MONITOR WALL

RECORD / REPLAY CONSOLE 1

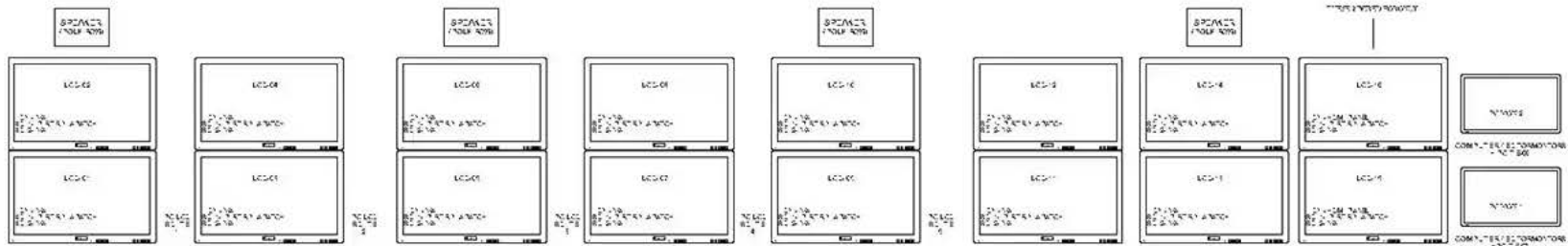

RECORD / REPLAY CONSOLE 2

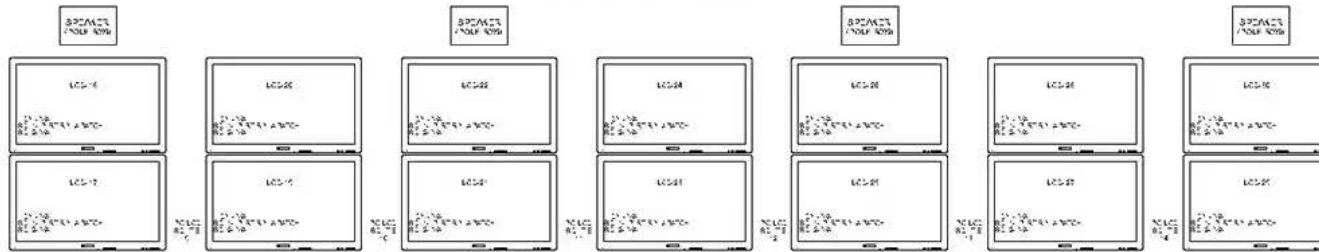

RECORD / REPLAY CONSOLE 3

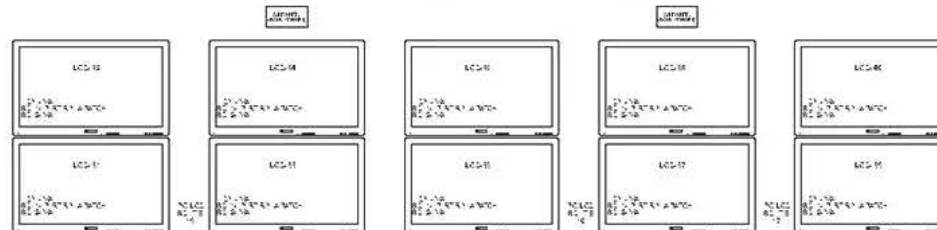

SUPERSHOOTER CBS

GRAPHICS MONITOR WALL

Front Graphics Console



G2-LEFT CONSOLE



G2-RIGHT CONSOLE



GRAPHICS 3



SUPERSHOOTER CBS

FLEX 1 MONITOR WALL

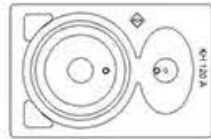

SPEAKER
(POLK ATRIUM-4)

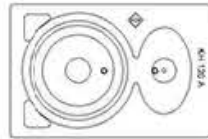

SPEAKER
(POLK ATRIUM-4)

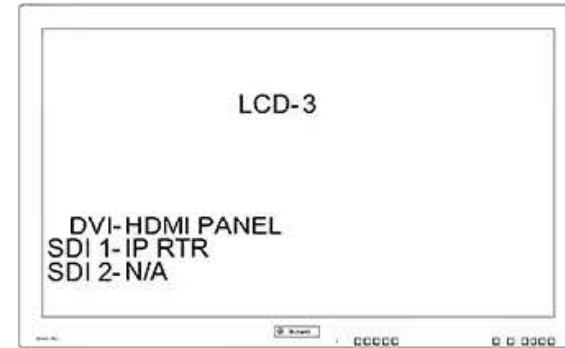
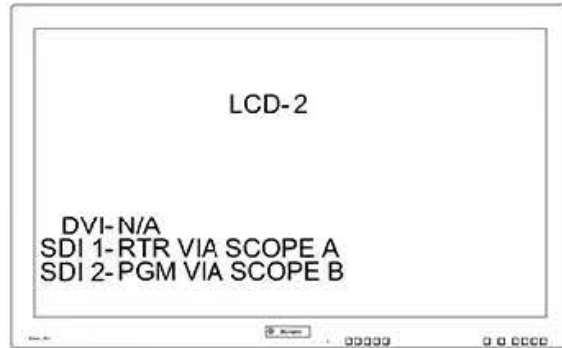
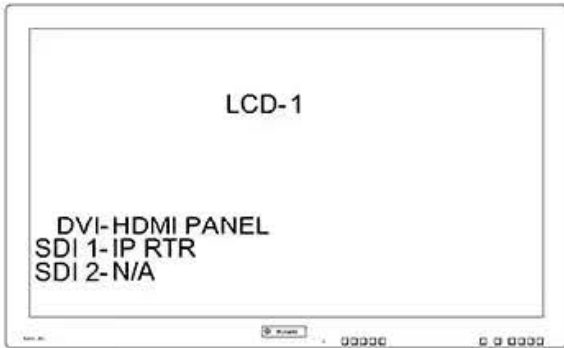
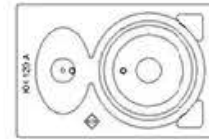

PC / EDITOR MONITORS xSDI-1 x1MON NET



PC / EDITOR MONITORS xSDI-2 x1MON NET



PC / EDITOR MONITORS xSDI-3 x1MON NET

FLEX 3 MONITOR WALL

