



H2 US MOBILE UNIT INFORMATION

Updated 05/29/2026

NEPGROUP.COM



Single Trailer Unit based in Hawaii

H2: TECHNICAL SPECIFICATIONS

DIMENSIONS

- 70' LONG X 13'6" HIGH X 20' WIDE - EXPANDED WITH TRACTOR
- STREET SIDE EXPANDO

POWER REQUIREMENTS

- 400 AMP, 208 VOLT, 3 PHASE OR 2 200AMP, 208 VOLT, 3 PHASE

PRODUCTION

- GVG KAYENNE CLASSIC SWITCHER, 96 INPUTS / 48 OUTPUTS
- 4.5 M/E
- 16 IDPM / EDPM / 2D DPM
- 32G STILL STORE
- 32 CHROMAKEYERS
- FLEXKEY
- DOUBLETAKE

COMMUNICATIONS

- ADAM INTERCOM SYSTEM - 112 PORTS
- 15 DUAL LISTEN BELTPACKS
- 20 SINGLE MUFF HEADSETS
- 11 DOUBLE MUFF HEADSETS
- 13 IFB BELTPACKS
- 6 WALKIE TALKIES WITH 1 BASE STATION
- 1 PHONE SYSTEM WITH 12 LINES
- 4 RING DOWN PHONE LINES
- 6 TIF - TELEPHONE INTERFACES
- 6 QKT

CAMERAS

- 6 SONY HDC2500 CAMERA
- 3 SONY HDLA LARGE LENS ADAPTER
- 3 HARD CAMERA PANHEAD & TRIPOD
- 6 HH CAMERA PANHEAD & TRIPOD
- 10 CCUS ON BOARD

LENSES

- 1 CANON 100X9.3 HARD LENS
- 2 CANON 86X9.3 HARD LENS
- 1 CANON LENS 21:1 HAND HELD LENS
- 1 CANON 4.7 WIDE ANGLE LENS
- 1 CANON 4.3 WIDE ANGLE LENS

SUPPORT EQUIPMENT

- UTAH SCIENTIFIC
- HD VIDEO - 288 INPUTS X 528 OUTPUTS
- 96 INPUTS X 96 OUTPUTS EMBED/DE-EMBED
- MADI 2 INPUTS X 2 OUTPUTS
- AES 96 INPUTS X 96 OUTPUTS
- ANALOG AUDIO 32 INPUTS X 64 OUTPUTS
- 38 UTILITY FRAME SYNC/PROCESSORS
- 10 HD VIDEO OVER FIBER TRANSMITTERS
- 2 EMBEDDERS WITH 16 AUDIO CHANNELS
- 2 DE-EMBEDDERS WITH 16 AUDIO CHANNELS
- 2 LIGHT KITS
- MONITORS: **8** - 17" LCD, **6** - 9" LCD

AUDIO

- CALREC ARTEMIS BEAM DIGITAL AUDIO CONSOLE
- BLUEFIN 2 HIGH DENSITY SIGNAL PROCESSING
- 340 CHANNELS WITH FULL SIGNAL PROCESSING
- 128 MIX BUSSES FOR GROUP AND MAIN OUTPUTS
- 64 MULTI-TRACK BUSSES
- 32 AUX BUSSES
- 64 FADERS
- 128 ANALOG INPUTS & 128 ANALOG OUTPUTS
- 32 AES INPUTS & 32 AES OUTPUTS
- 10 MADI INPUTS & 10 MADI OUTPUTS
- CONSOLE ENABLED WITH 1 DANTE CARD
- 1 HYDRA II FIELD BOX (24X8)
- 2 DIGICART
- 1 CD PLAYER

MICROPHONES

- 6 ANNOUNCER HEADSETS
- 8 DALTECH ANNOUNCE CONSOLES
- 18 SHORT SHOTGUN MICROPHONES
- 3 LONG SHOTGUN MICROPHONES
- 9 STICK MICROPHONES
- 8 LAVALIER MICROPHONES

RECORD & PLAYBACK

- 1 EVS XT VIA 12 CHANNEL LSM
- 1 EVS XSVIA 6 CHANNEL SPOTBOX
- 1 EVS XHUB VIA
- 1 SONY PDW- F1600 HD XDCAM VTR
- 1 SONY HDW-M2000 HD CAM VTR
- 7 VIDEO DEVICES PIX270I
- 2 DVD RECORDER W/ REMOTE CONTROL

GRAPHICS

- UPON REQUEST

CABLES

- DT12 8 -250' 8 -100'
- 4 DT12 FANOUT SETS
- 4 DT12 FEED THROUGH BOXES
- 6 PAIR MULT 2 -100'
- 4 PAIR MULT 2 -100'
- ASSORTED SINGLE LINE XLR
- TAC-12 ST-ST 3 - 250'
- 5 PAIR HD COAX LOOM 4 -125'
- ASSORTED SINGLE LINE COAX
- 1 SETS OF 100' 4/0 CAMLOCK POWER CABLE



H2 FLOORPLAN

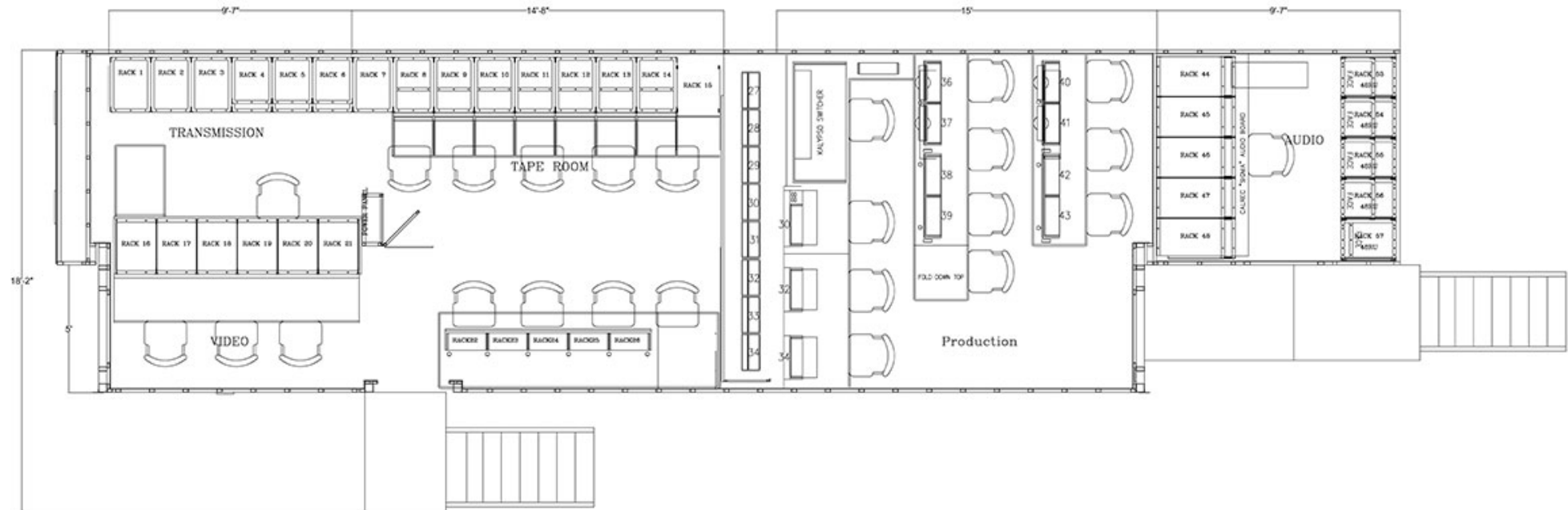

H2

PRODUCTION MONITOR WALL

NCP 14												TD:																					
												Dir:																					
												Prod:																					
												201		202		203		204															
185		186		187		188		189		190		191		192		193		194		195		200											
169		170		171		172		173		174		175		176		177		178		179		184											
161		162		163		164		165		166										167		168											
16153		154		155		156		157		158		901		902		903		159		160													
139		138		137		136		135		134		133		132		131		130		129		128											
121		122		123		124		125		126		127		128		129		130		131		132											
111		112		113		114		115		116		117		118		119		120		220		221											
101		102		103		104		105		106		107		108		109		110		222		223											
												TD Rtr 1:																					
												TD Rtr 2:																					
												TD Rtr 3:																					
												TD Rtr 4:																					
												TD Rtr 5:																					
Mid Bench																																	
												DUET KVM																					
												211																					
206		207		208		209		210		211		212		213		214		215		216		217											
												214		215		216		217															
												229																					
224		225		226		227		228		229		230		231		232		233		234		235											
												234		235		236		237															



H2

TAPE MONITOR WALL

