

# Soundcheck Studios at Rock Nashville: Technical Packet

Version 2.3  
04.03.26

Updated by:  
Bom Bom

615-726-1165  
[Booking@Soundchecknashville.com](mailto:Booking@Soundchecknashville.com)

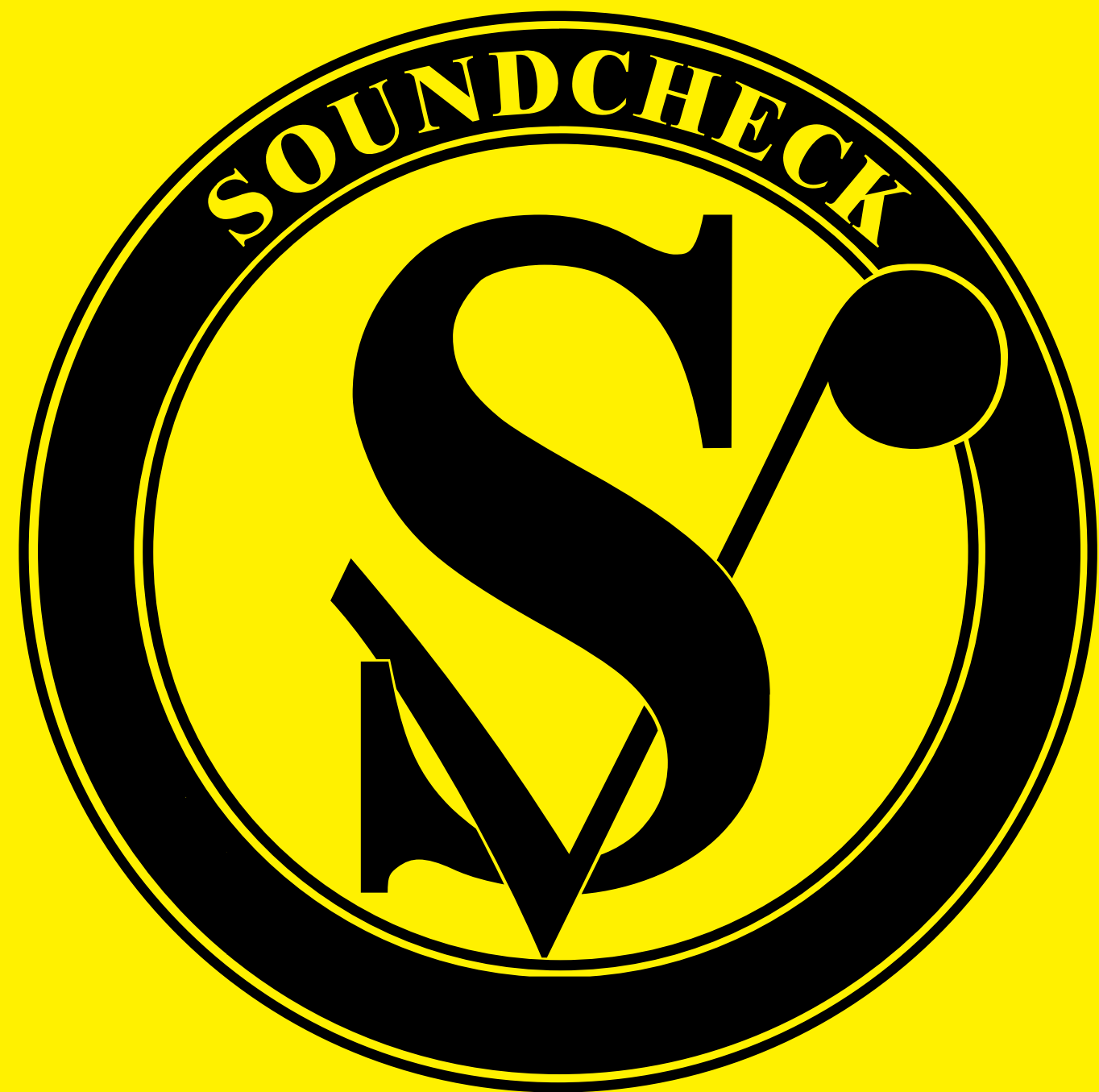

**ROCK**  
**NASHVILLE**

# Studios Overview

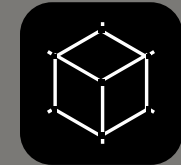

	1	2	3A 3B	4A 4B 4C 4D	5A 5B 5C	6A 6B 6C 6D
<b>SQFT</b>	26,445 sqft	12,177 sqft	5,390 sqft	3,350 sqft	2,400 sqft	560 sqft
<b>DIMS</b>	215' x 123'	123' x 99'	77' x 70'	67' x 50'	60' x 40'	28' x 20'
<b>TRIM</b>	80' to grid	65' to grid	26'11" to grid	26'11" to grid (AB Only)	32' to ceiling	12'4" to ceiling
<b>RIGGING</b>	900,000 lbs	500,000 lbs	80,000 lbs	39,000 lbs (AB Only)	N/A	N/A
<b>AUDIO</b>	N/A	N/A	FOH PA	FOH PA, Monitor System, FOH and Mon. Consoles	FOH PA, Monitor System, FOH and Mon. Consoles	Monitor System, Monitor Console
<b>POWER</b>	[7] 400A, 3Φ + [1] 200A, 3Φ	[4] 400A, 3Φ + [2] 200A, 3Φ	[1] 400A 3Φ [1] 200A 3Φ [1] 100A 3Φ [2] L21-30 services powering stage power and FOH PA	[2] 200A 3Φ [1] 100A 3Φ [2] L21-30 services powering stage power, MON power, and FOH PA	[1] 200A 3Φ [1] 100A 3Φ [2] L21-30 services powering stage power, MON power, and FOH PA	[4] 120V 20A Duplex Outlets [1] L21-30 30A services powering stage power, MON power



# Studio 1

Soundcheck Studio 1 at Rock Nashville is the largest full production studio on campus, offering space, strength and support for large scale productions and rehearsals.

**DIMS** 215' × 123'

**SQFT** 26,445 sqft

**TRIM** 80'

**RIGGING** 450 US Tons / 900,000 lbs

**POWER** [7] 400A, 3Φ +  
[1] 200A, 3Φ

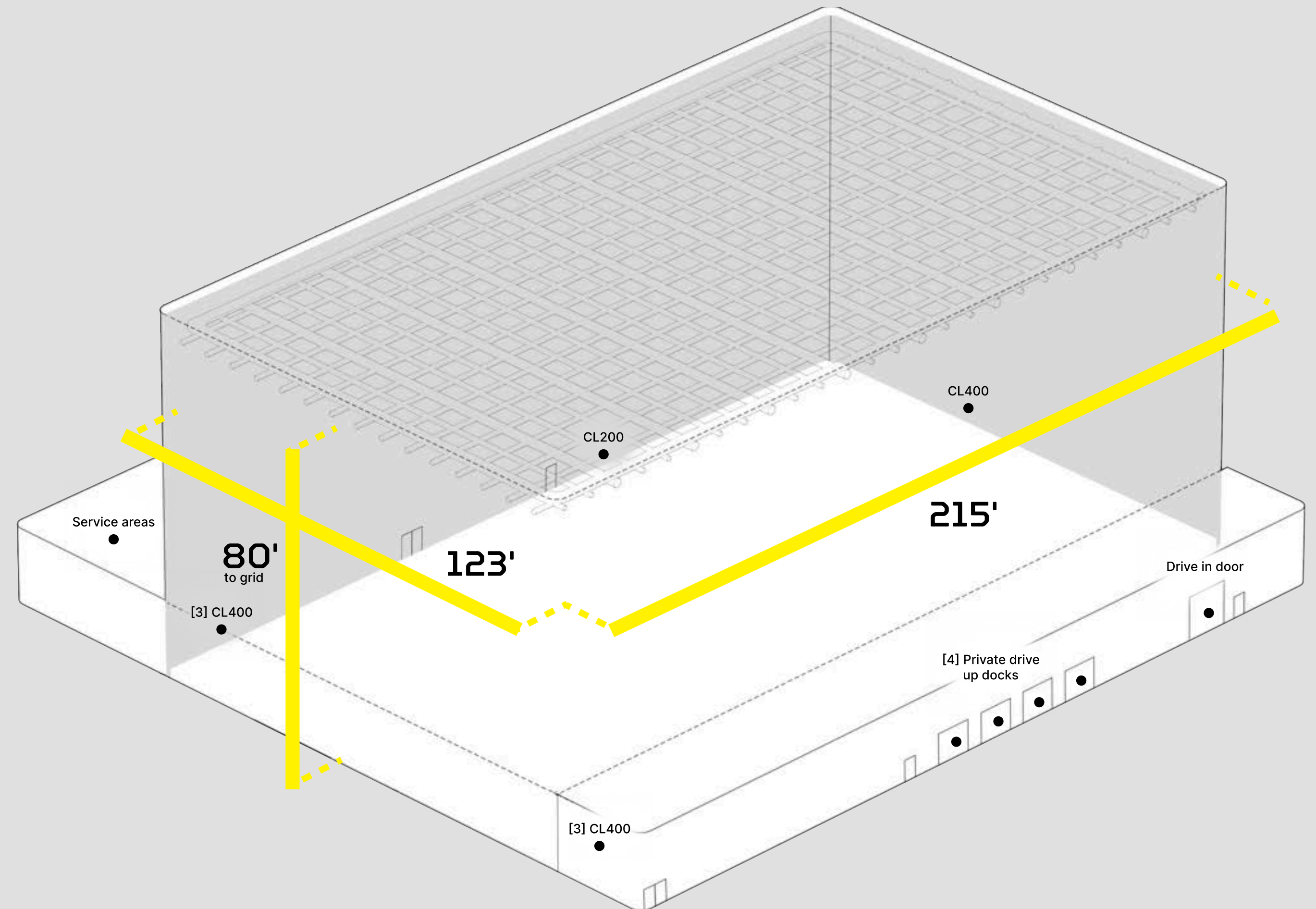

# Studio 1 Rigging

<b>TRIM</b>	80'
<b>GRID</b>	8'x8' grid of wide flange beams
<b>MAX CAP</b>	450 US Tons / 900,000 lbs
<b>RIGGING</b>	8'x8' Rigging Grid, Horizontal Lifeline System, Max 3-ton point load on any 8ft span, Max 50-tons on any truss girder, straight hangs only on W10x30 beams, Bridle loads allowed on W18x40 beams minimum of 5ft below grid
<b>SAFETY</b>	Fall protection cable system installed 6'8" above each beam in grid system

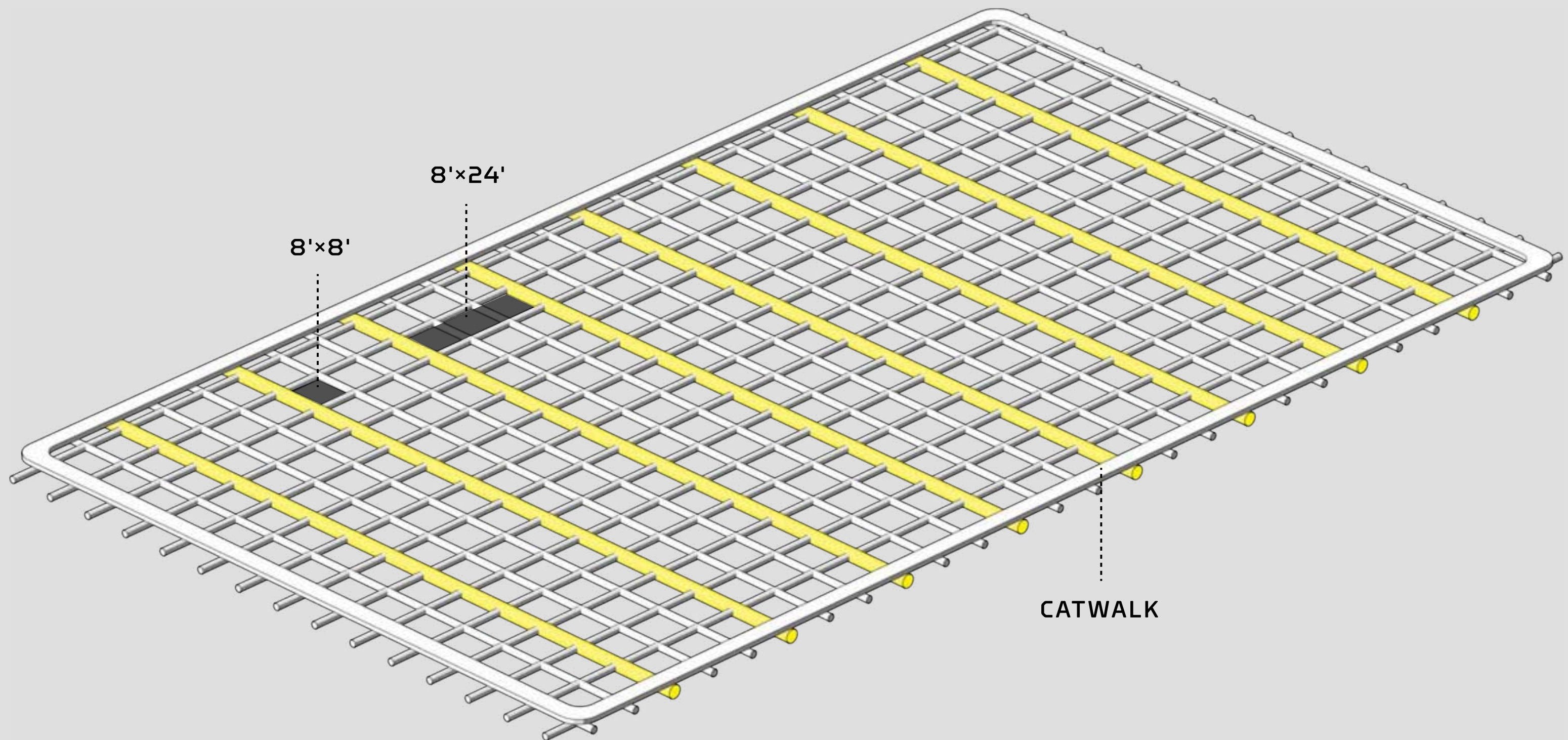

# Studio 1 Rooms

1	Main Studio Space	123' x 215'	37.49m x 65.53m	26.45k sq/ft of uninterrupted floor space
2	Production Office	23' x 36'	7m x 10.97m	Desks & data for 8 people, small lounge
3	Tour Office	11' x 12'	3.35m x 3.65m	Desk for 1 person
4	Tour Office	11' x 12'	3.35m x 3.65m	Desk for 1 person
5	Tour Office	11' x 12'	3.35m x 3.65m	Desk for 1 person
6	Conference Room	13' x 22'	3.96m x 6.7m	1 Conference table with seating for 10
7	Multi-Purpose Room	40' x 25'	12.19m x 7.62m	Can be configured to suit any need
8	Dressing Room	26' x 34'	7.92m x 10.36m	Fully furnished with private full bath
9	Dressing Room Restroom	20' x 13'	6.09m x 3.96m	Full bath - 1 toilet, 1 sink, 1 shower
10	Dressing Room	26' x 34'	7.92m x 10.36m	Fully furnished with private full bath
11	Dressing Room Restroom	20' x 13'	6.09m x 3.96m	Full bath - 1 toilet, 1 sink, 1 shower
12	Men's Restroom	10' x 23'	3.04m x 7.01m	2 stalls, 2 urinals, 3 sinks
13	Women's Restroom	10' x 23'	3.04m x 7.01m	4 stalls, 3 sinks
14	Dining Area	40' x 35'	12.19m x 10.66m	Seating for up to 50, kitchen

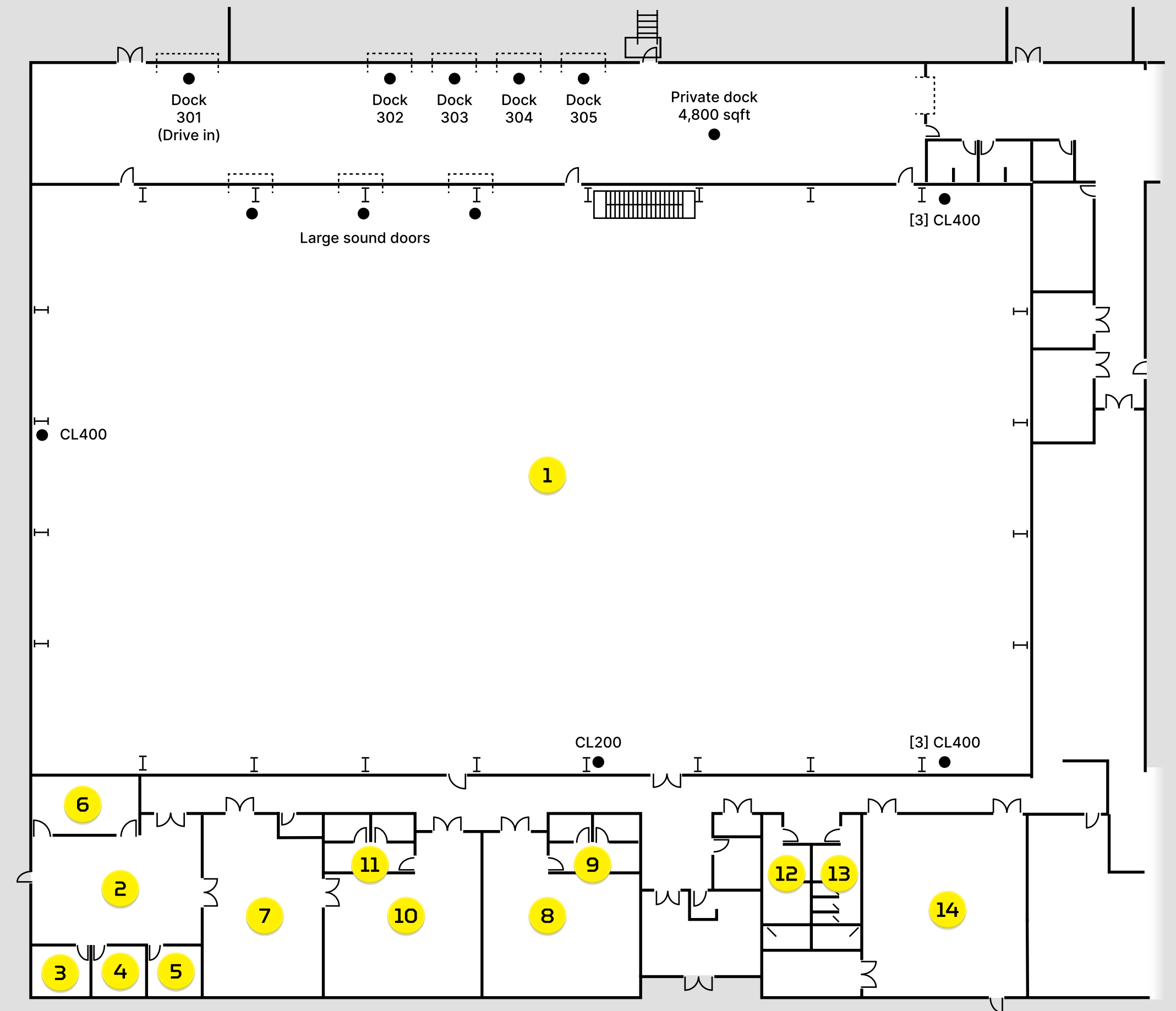

# Studio 2

Soundcheck Studio 2 at Rock Nashville is ideal for full production rehearsals, offering space, strength and support.

<b>DIMS</b>	123' × 99'
<b>SQFT</b>	12,177 sqft
<b>TRIM</b>	65'
<b>RIGGING</b>	250 US Tons / 500,000 lbs
<b>POWER</b>	[4] 400A, 3Φ + [2] 200A, 3Φ

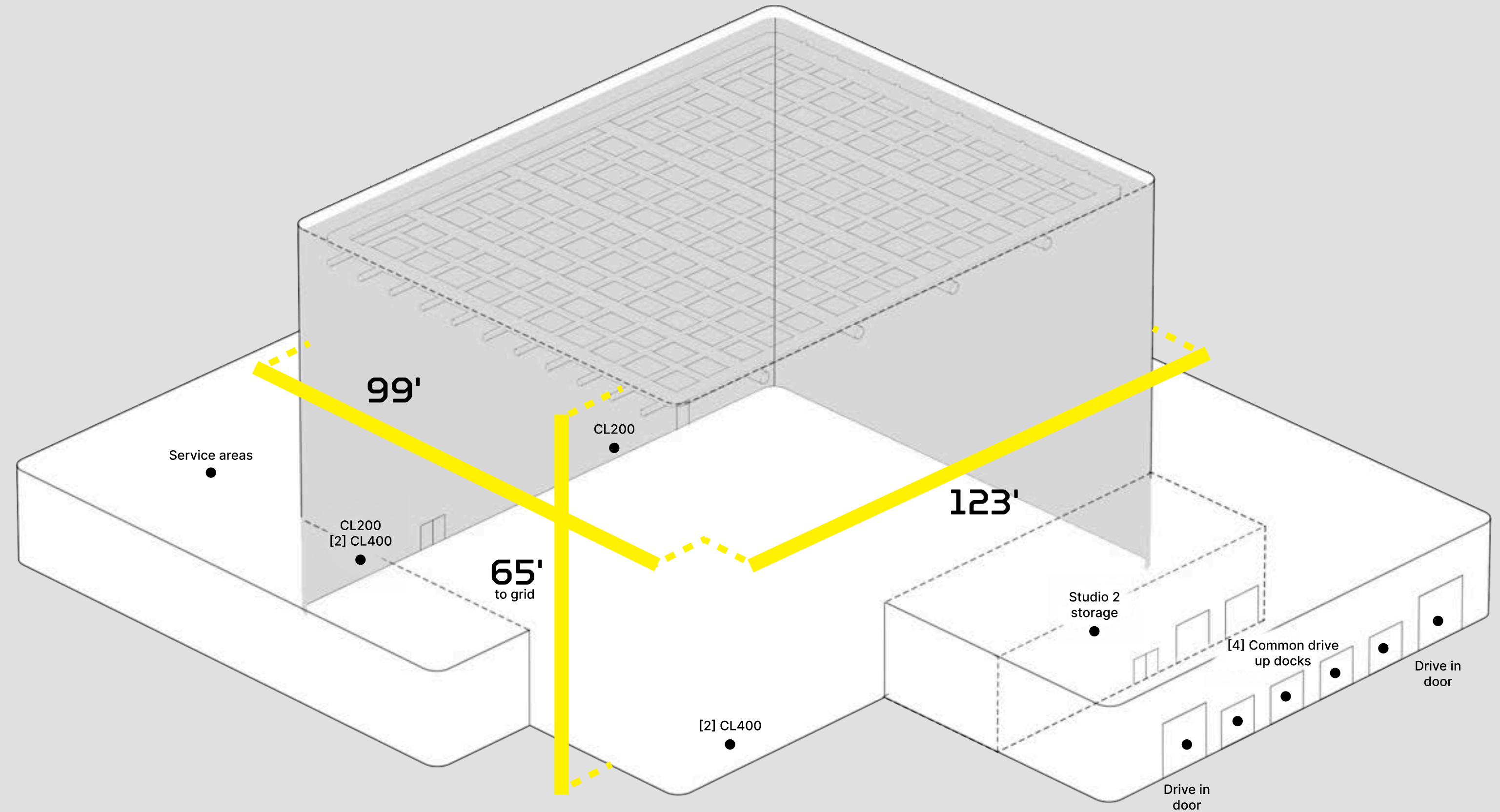

# Studio 2 Rigging

<b>TRIM</b>	65'
<b>GRID</b>	8'x8' grid of wide flange beams
<b>MAX CAP</b>	250 US Tons / 500,000 lbs
<b>RIGGING</b>	8'x8' Rigging Grid, Horizontal Lifeline System, Max 3-ton point load on any 8ft span, Max 50-tons on any truss girder, straight hangs only on W10x30 beams, Bridle loads allowed on W18x40 beams minimum of 5ft below grid
<b>SAFETY</b>	Fall protection cable system installed 6'8" above each beam in grid system

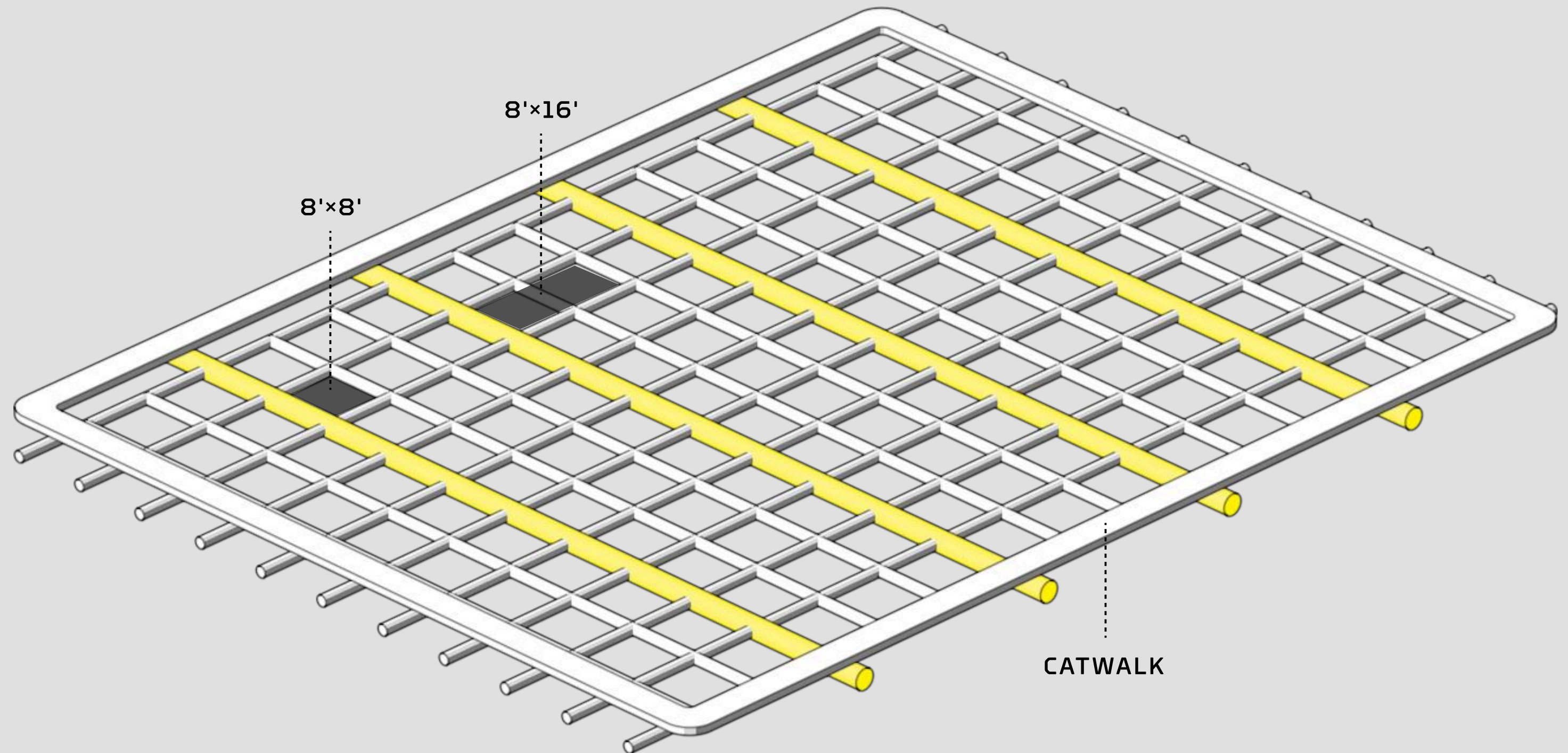

# Studio 2 Rooms

1	Main Studio Space	123' x 99'	37.49m x 30.17m	12.17k sq/ft of uninterrupted floor space
2	Dining Area	40' x 30'	12.19m x 9.14m	Seating for up to 50, kitchen
3	Production Office	40' x 26'	12.19m x 7.92m	Desks & data for 8 people, small lounge
4	Tour Office	11' x 10'	3.35m x 3.04m	Desk for 1 person
5	Tour Office	11' x 10'	3.35m x 3.04m	Desk for 1 person
6	Dressing Room	21' x 21'	6.4m x 6.4m	Fully furnished with private full bath
7	Dressing Room Restroom	14' x 16'	4.26m x 4.87m	Full bath - 1 toilet, 1 sink, 1 shower
8	Dressing Room	21' x 21'	6.4m x 6.4m	Fully furnished with private full bath
9	Dressing Room Restroom	14' x 16'	4.26m x 4.87m	Full bath - 1 toilet, 1 sink, 1 shower
10	Women's Restroom	10' x 23'	3.04m x 7.01m	4 stalls, 3 sinks
11	Men's Restroom	10' x 23'	3.04m x 7.01m	2 stalls, 2 urinals, 3 sinks

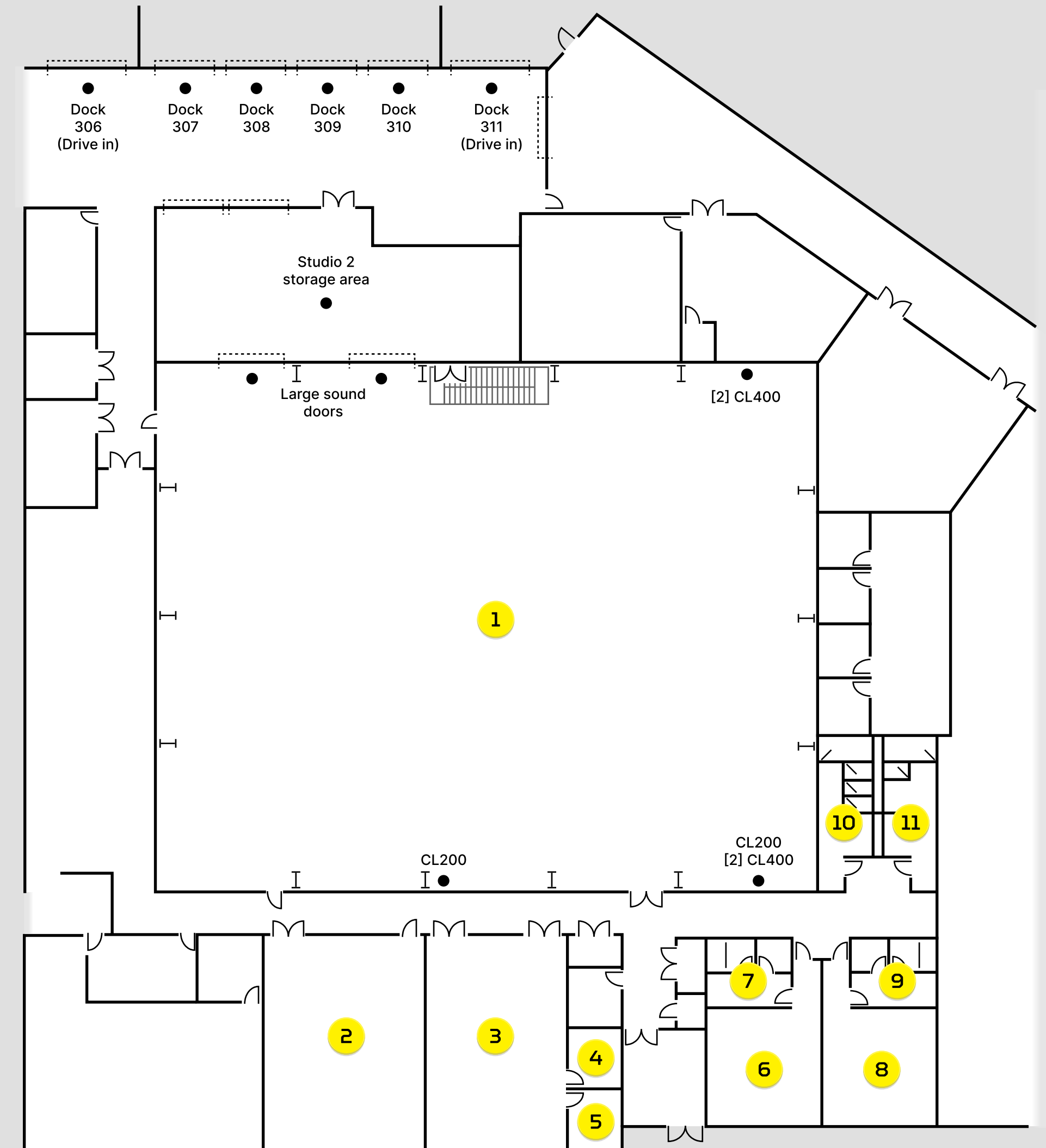

# Studios 3 A B

Soundcheck Studios 3, Rooms A + B are efficient and flexible spaces for band and crews to rehearse. Opens to shared, common hall with 14 docks, load in through a 10' x 10' soundproof door.

**DIMS** 77' x 70'

**SQFT** 5,390 sqft

**POWER**

- [1] 400A 3Ø 120/208V AC
- [1] 200A 3Ø 120/208V AC
- [1] 100A 3Ø 120/208V AC
- [2] L21-30 services powering stage power and FOH PA

**AUDIO**

**Front of House**

- Flown PA: CO10 (80°) Cohesion Line Array - [3] per side
- Ground stacked on carts: CP218-11+ Self-powered subwoofer - [1] per side

**Monitors**

- N/A

**Consoles**

- N/A

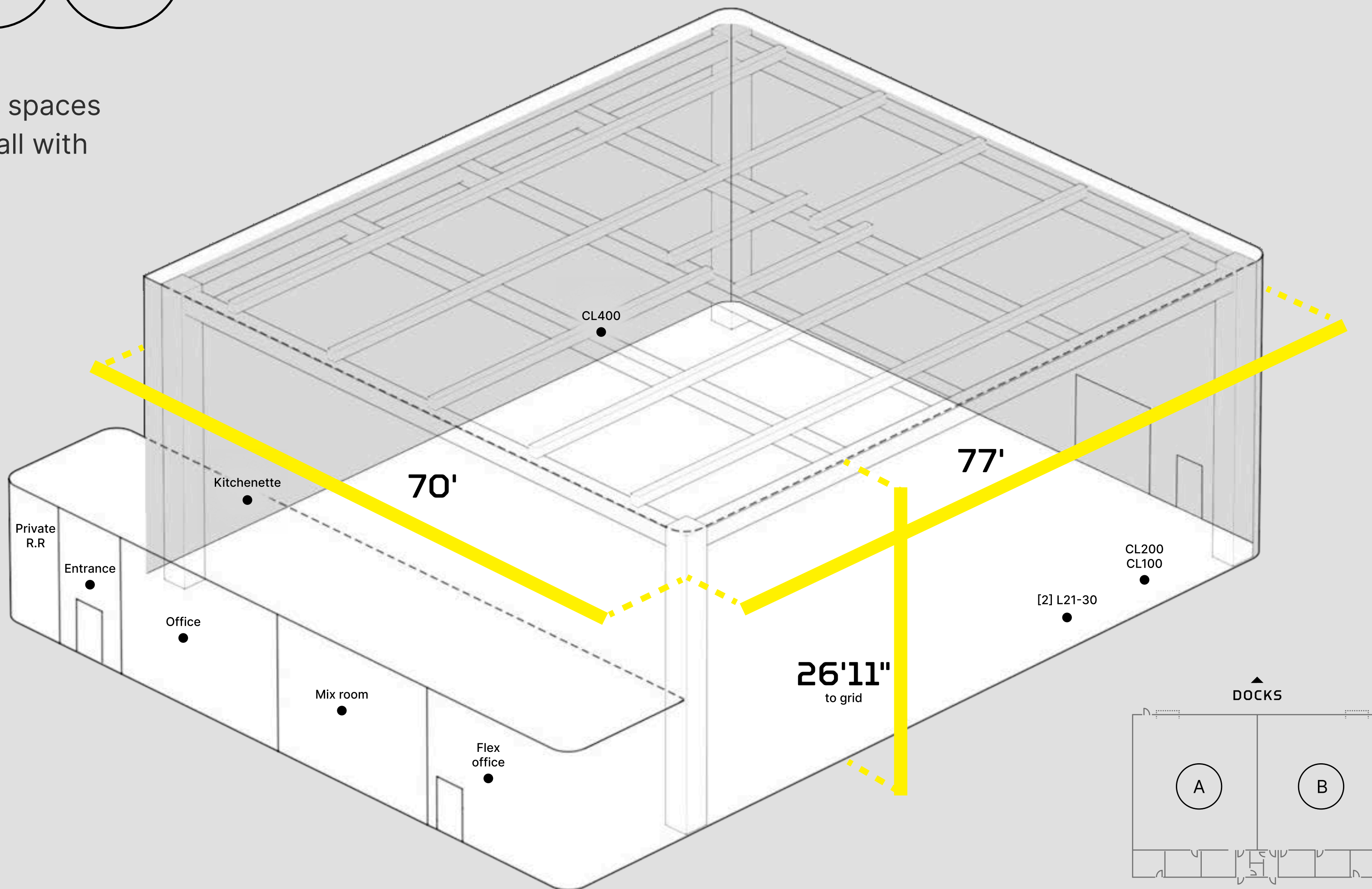

# Studios 3 Rigging

TO GRID	26'11"
TO CEILING	32'
TRUSS	20.5" Ground Support
MAX CAP	40 US Tons / 80,000 lbs

## RIGGING LOAD LIMITS 3A/B - PLEASE READ

The listed maximum system capacity reflects the overall structural design and is not the allowable load for individual rigging points or truss members.

All show rigging must comply with the member-specific limits below:

- 12" Up/Down Spanner Runs: 1,500 lbs max per run (Some are 1000 lbs)
- 36" Cross-Stage Truss: 6,000 lbs total (distributed)

These capacities are not additive. Loading the 12" spanners and 36" cross-stage simultaneously affects the same structural system and must be reviewed as a combined load case.

All productions must submit a plot showing weight per point for review prior to load-in.

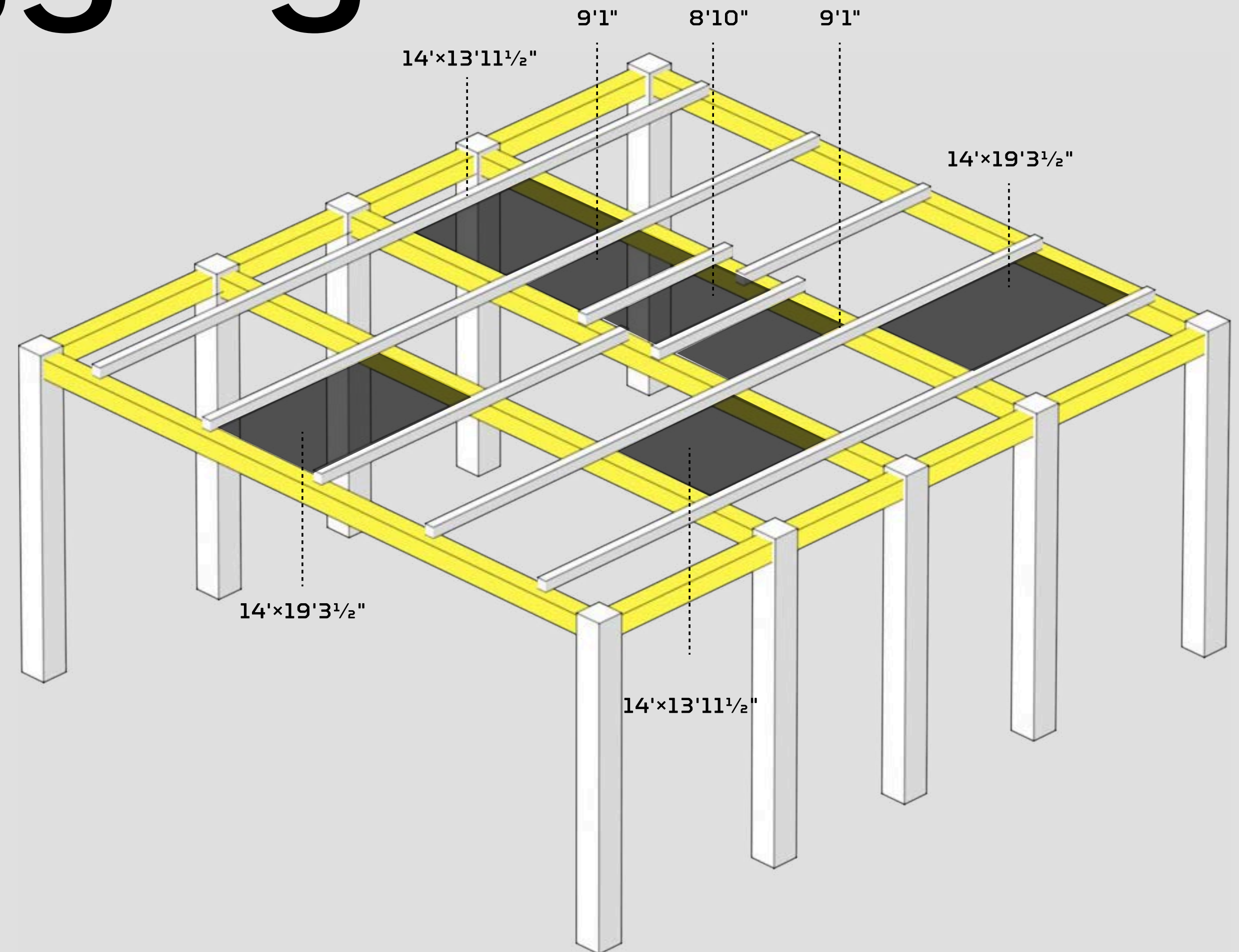

# Studios 4 A B

Soundcheck Studios 4, Rooms A, B, C, + D are individual, flexible studio spaces for band and crews to rehearse. Opens to shared, common hall with 14 docks, load in through a 10' x 10' soundproof door.

<b>DIMS</b>	67' x 50'
<b>SQFT</b>	3,350 sqft
<b>POWER</b>	[2] 200A 3Φ 120/208V AC [1] 100A 3Φ 120/208V AC [2] L21-30 services powering stage power, MON power, and FOH PA

- AUDIO**
- Front of House**
- Flown PA: CO10 (80°) Cohesion Line Array - [3] per side
  - Ground stacked on carts: CP218-11+ Self-powered subwoofer - [1] per side
- Monitors**
- [8] CM-14 Cohesion wedges [1] CP-118 Cohesion Sub (Drum sub)
- Consoles**
- FOH: Yamaha DM7
  - Monitors: Yamaha DM7

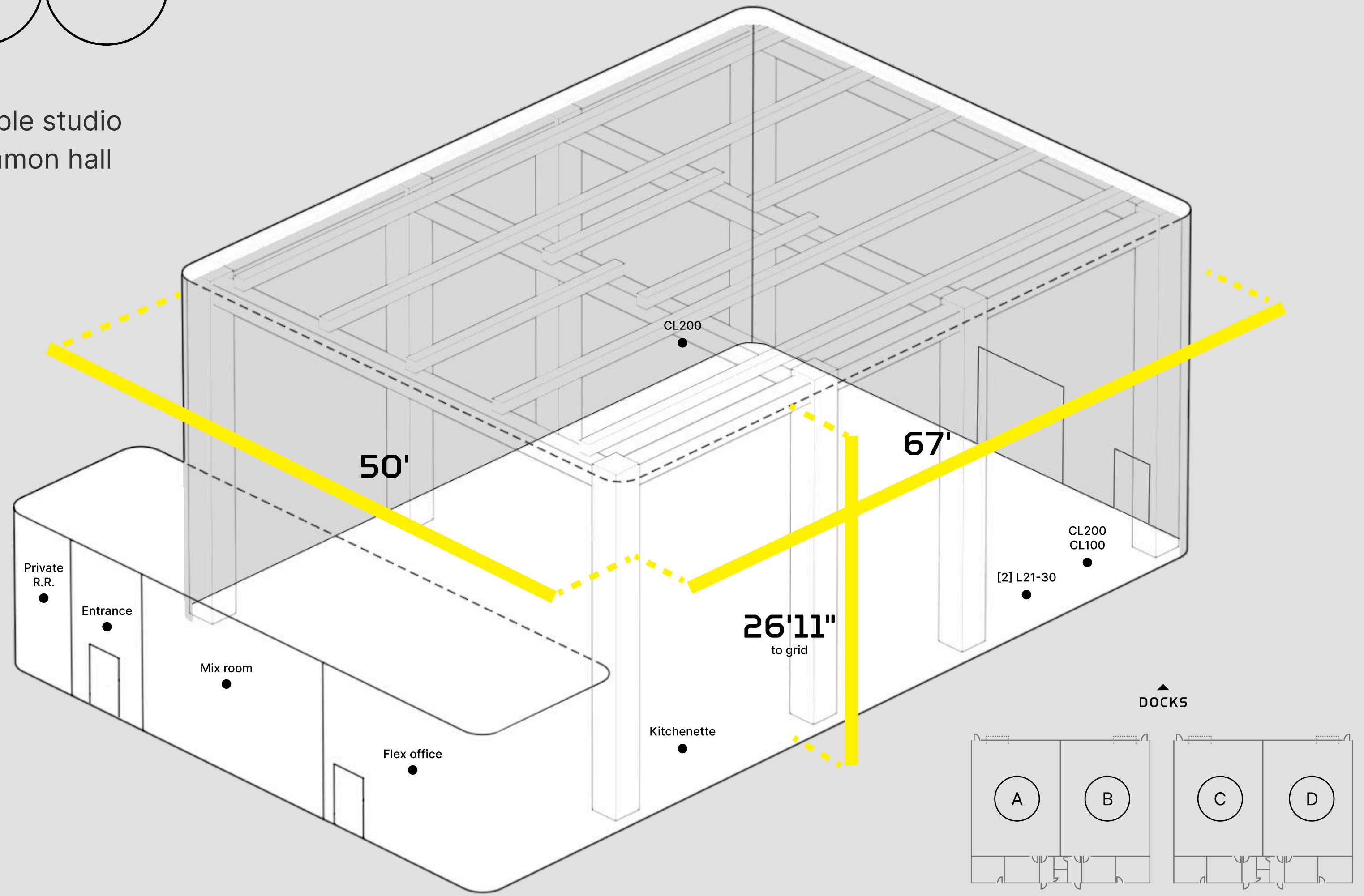

# Studios 4A+4B Rigging

TO GRID	28'
TO CEILING	32'
TRUSS	20.5" Ground Support
MAX CAP	19.5 US Tons / 39,000 lbs

## RIGGING LOAD LIMITS 4A/B - PLEASE READ

The listed maximum system capacity reflects the overall structural design and is not the allowable load for individual rigging points or truss members.

All show rigging must comply with the member-specific limits below:

- 12" Up/Down Spanner Runs: 1,000 lbs max per run
- 36" Cross-Stage Truss: 4,000 lbs total (distributed)

These capacities are not additive. Loading the 12" spanners and 36" cross-stage simultaneously affects the same structural system and must be reviewed as a combined load case.

All productions must submit a plot showing weight per point for review prior to load-in.

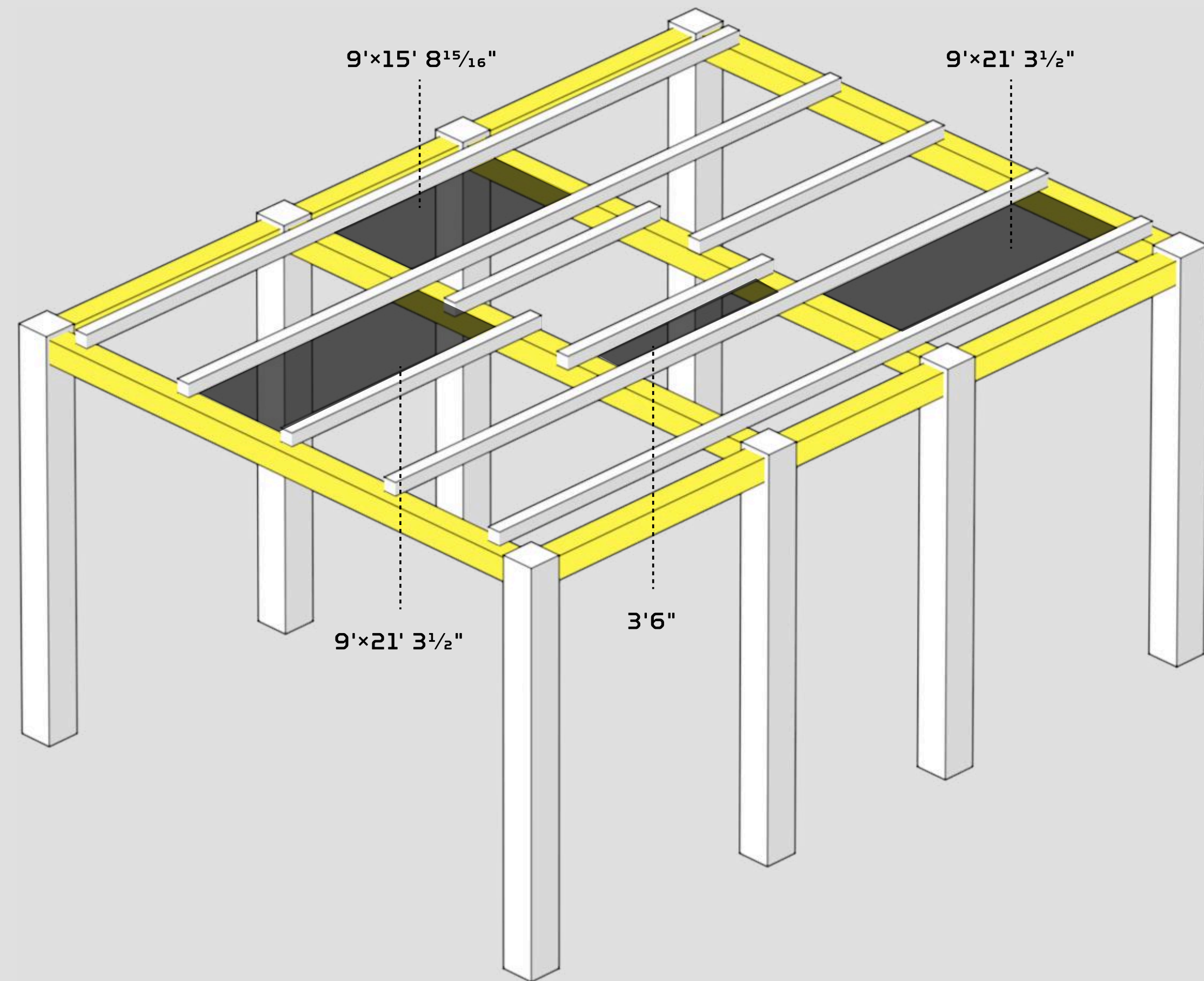

# Studios 4 C D

Soundcheck Studios 4, Rooms A, B, C, + D are individual, flexible studio spaces for band and crews to rehearse. Opens to shared, common hall with 14 docks, load in through a 10' x 10' soundproof door.

**DIMS** 67' x 50'

**SQFT** 3,350 sqft

**POWER**  
 [2] 200A 3Φ 120/208V AC  
 [1] 100A 3Φ 120/208V AC  
 [2] L21-30 services powering stage power, MON power, and FOH PA

**AUDIO**

**Front of House**

- Flown PA: CO10 (80°) Cohesion Line Array - [3] per side
- Ground stacked on carts: CP218-11+ Self-powered subwoofer - [1] per side

**Monitors**

- [8] CM-14 Cohesion wedges [1] CP-118 Cohesion Sub (Drum sub)

**Consoles**

- FOH: Yamaha DM7
- Monitors: Yamaha DM7

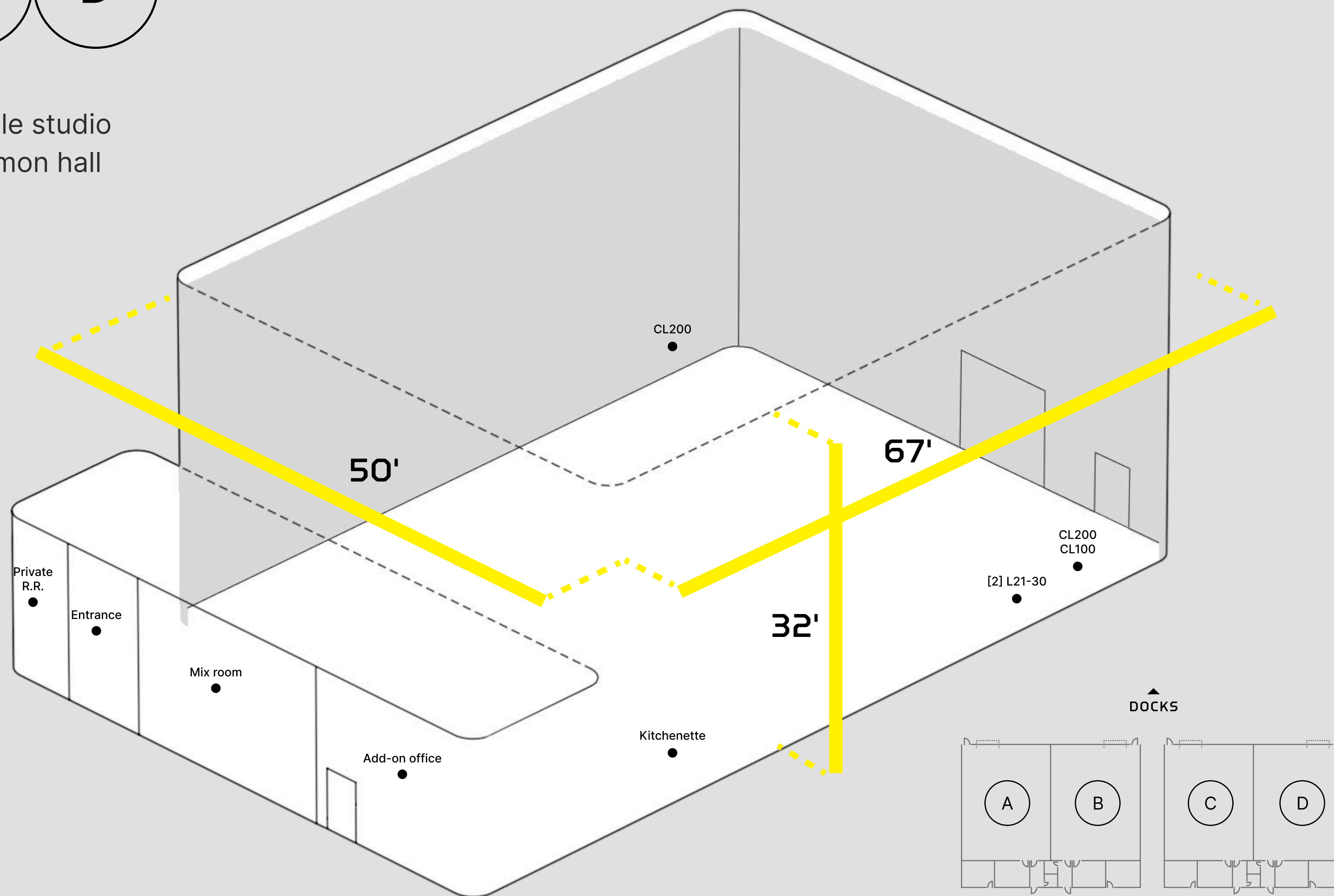

# Studios 5

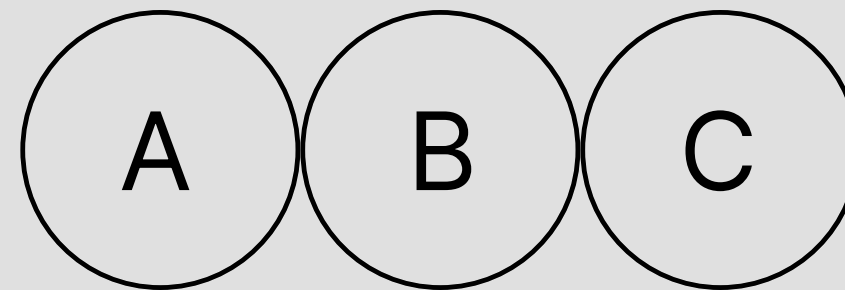

Soundcheck Studios 5, Rooms A, B, + C are individual, flexible studio offering private rehearsal space for any event. Opens to shared, common hall with 14 docks, load in through a 10' x 10' soundproof door.

**DIMS** 60' x 40'

**SQFT** 2,400 sqft

**POWER** [1] 200A 3Φ 120/208V AC  
[1] 100A 3Φ 120/208V AC  
[2] L21-30 services powering stage power, MON power, and FOH PA

## AUDIO

### Front of House

- Flown PA: CO10 (80°) Cohesion Line Array - [3] per side
- Ground stacked-on carts: CP218-11+ Self-powered subwoofer - [1] per side

### Monitors

- [8] CM-14 Cohesion wedges
- [1] CP-118 Cohesion Sub (Drum sub)

### Consoles

- FOH: Yamaha DM7
- Monitors: Yamaha DM7

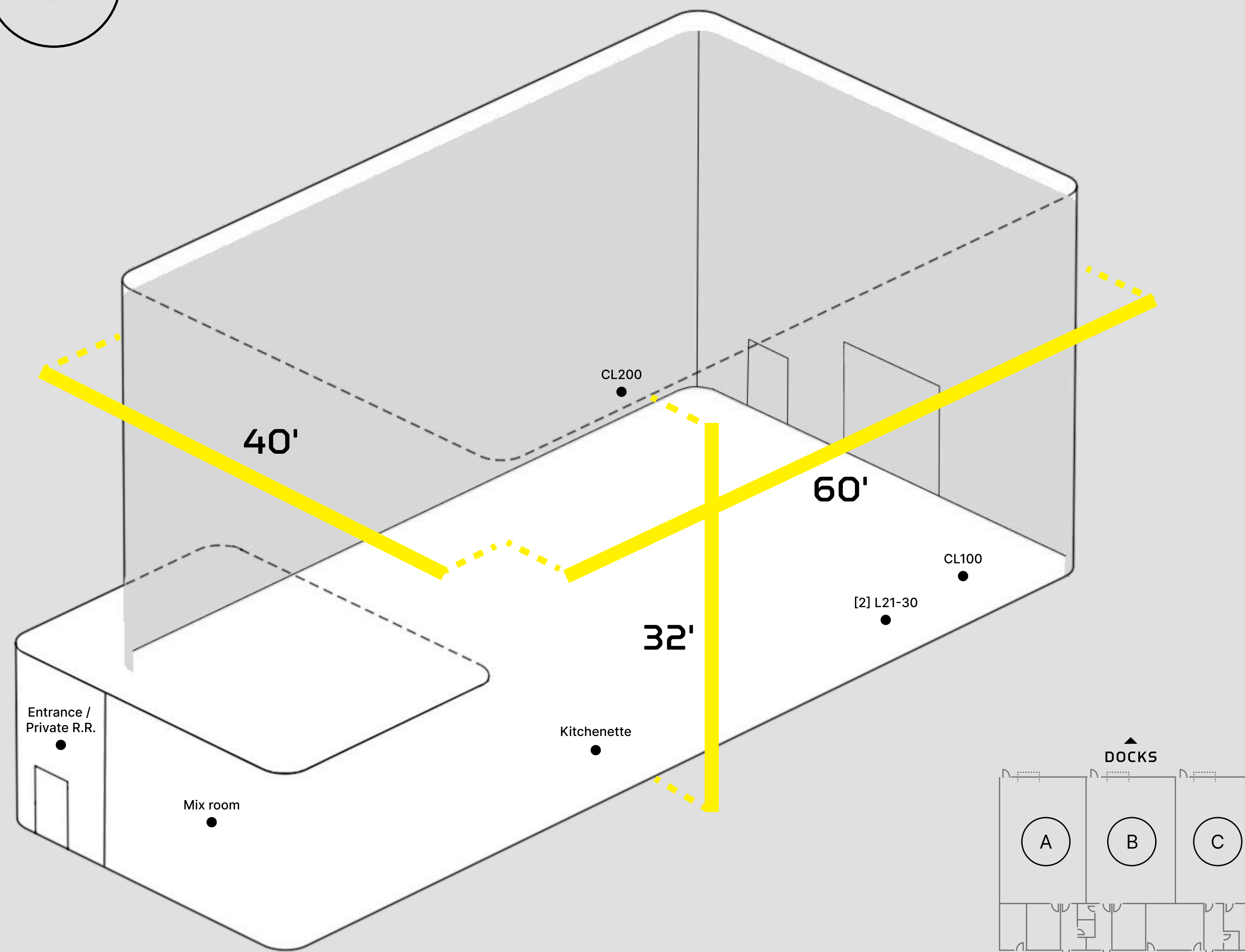

# Studios 6

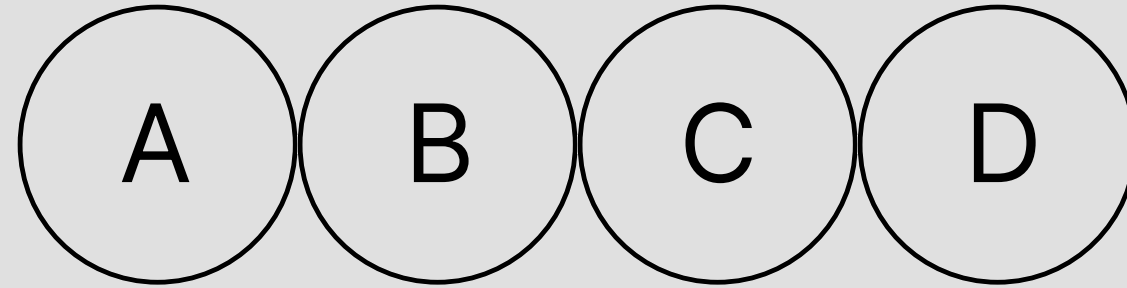

Soundcheck Studios 6, Rooms A, B, C, + D are individual, flexible studio offering private rehearsal space for any event.

**DIMS** 28' x 20'

**SQFT** 560 sqft

**POWER** [4] 120V 20A Duplex  
[1] L21-30 services powering stage power and MON power

**AUDIO**

**Front of House**

- N/A

**Monitors**

- [8] CM-14 Cohesion wedges
- [1] CP-118 Cohesion Sub (Drum sub)

**Consoles**

- Monitors: Yamaha DM7

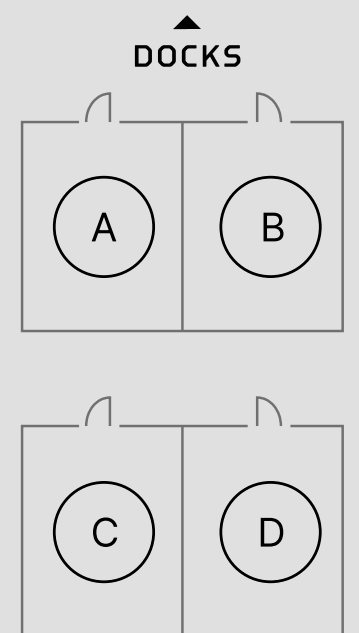
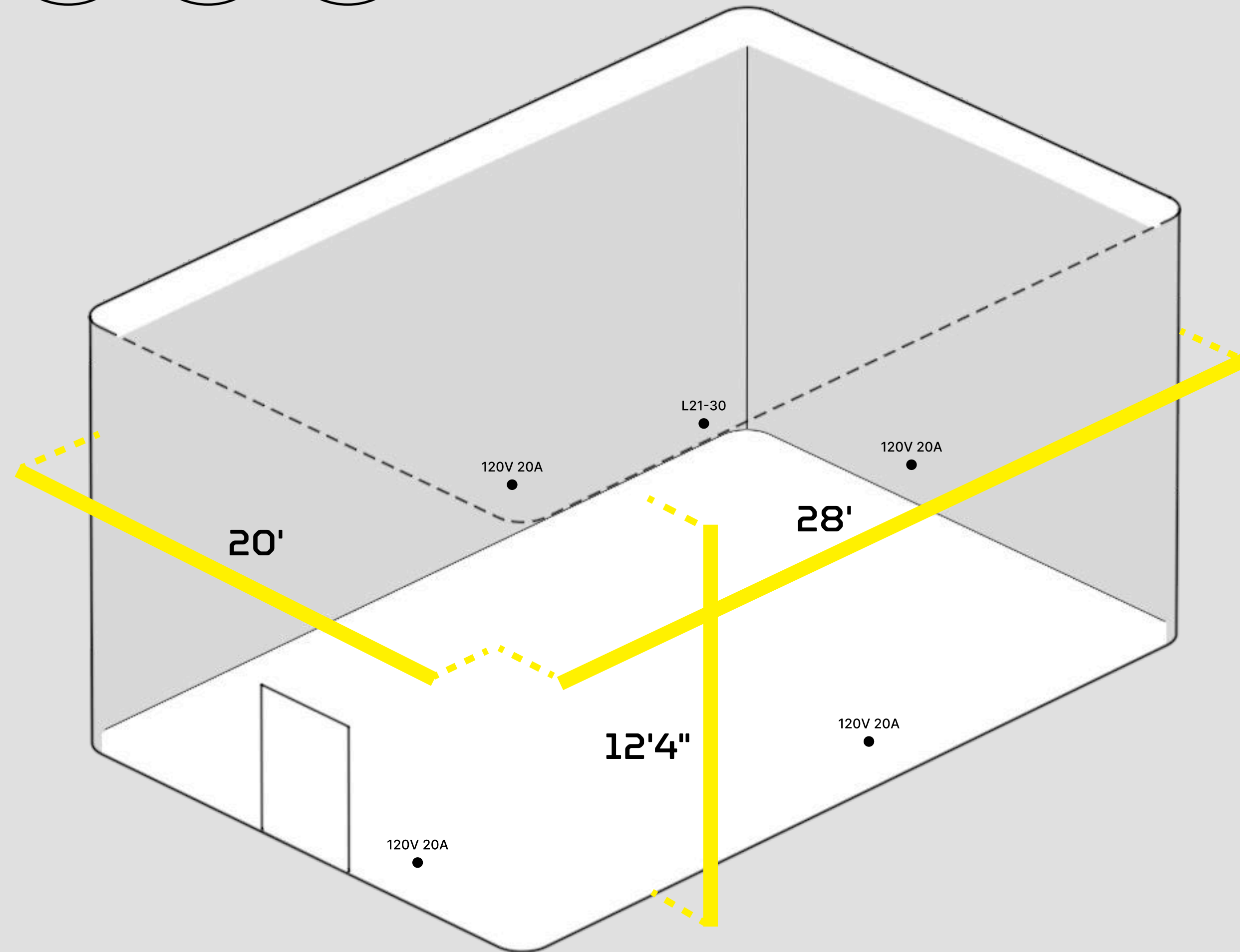

# Common Dock



# Parking Map

Please be mindful of traffic while on campus.  
All trucks, please follow designated truck traffic as marked. Parking questions? Email [Booking@Soundchecknashville.com](mailto:Booking@Soundchecknashville.com)

- Parking lot name
- Truck + bus traffic
- Local labor crew
- General parking
- Entrance

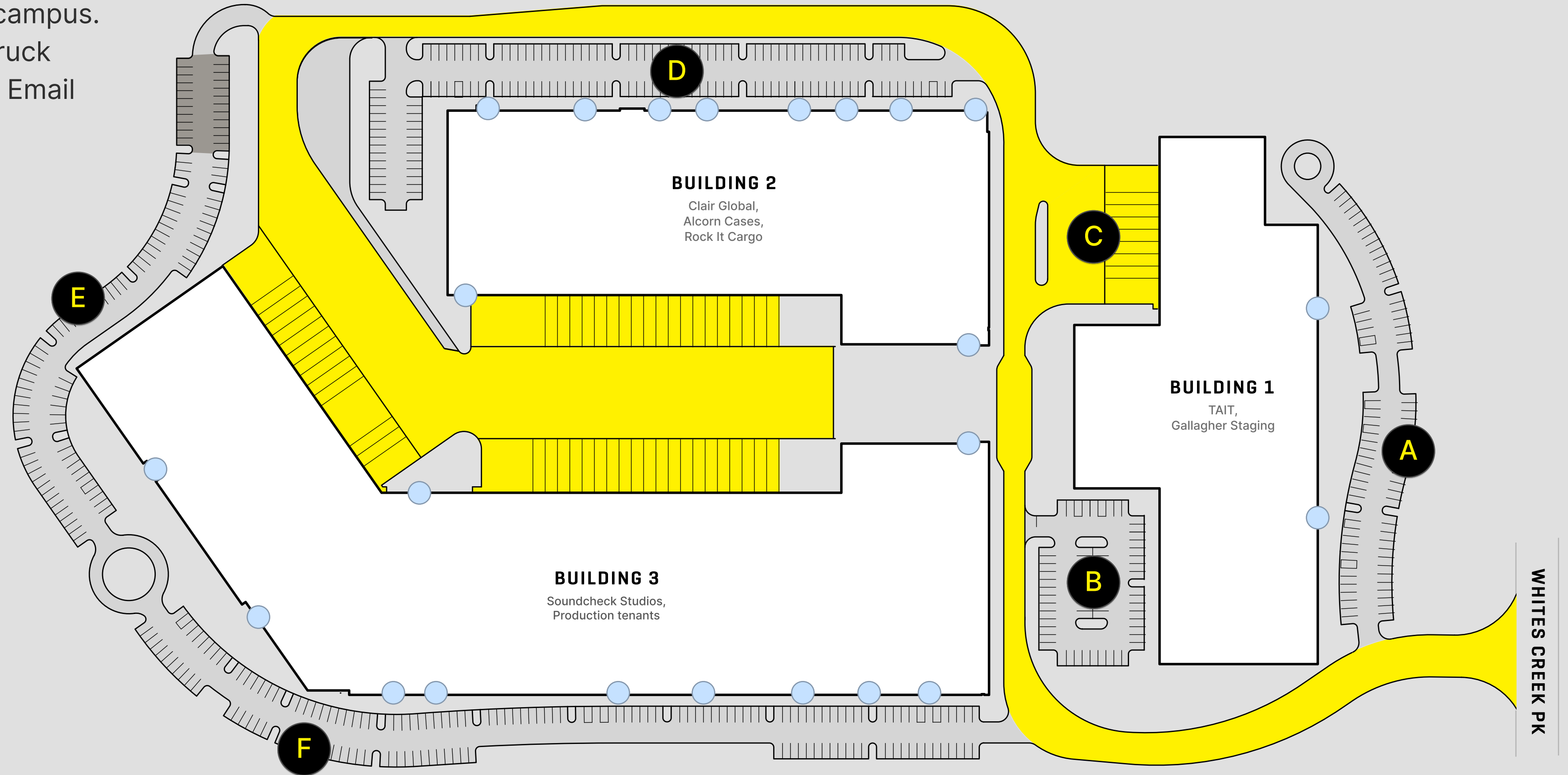

# Additional Campus Services



## → Storage

Keep your gear close between gigs. Rock Nashville offers secure, on-site storage lockers in all sizes.



## → Backline + Cartage

Soundcheck offers quality backline rentals on-site, ready to support rehearsals, tours, and live events.



## → Coworking

Work from the Rock Nashville campus with a variety of shared industry and co-working space.



## → Trainings + More

Coordinate on-campus trainings and experiences (CPR, gear demos, team building etc) through the Community.

# About Rock Nashville

Rock Nashville is a live entertainment campus offering purpose-designed rehearsal studios and industry-driving initiatives for a collaborative community of creative and technical live entertainment professionals.



# Rock Nashville Campus

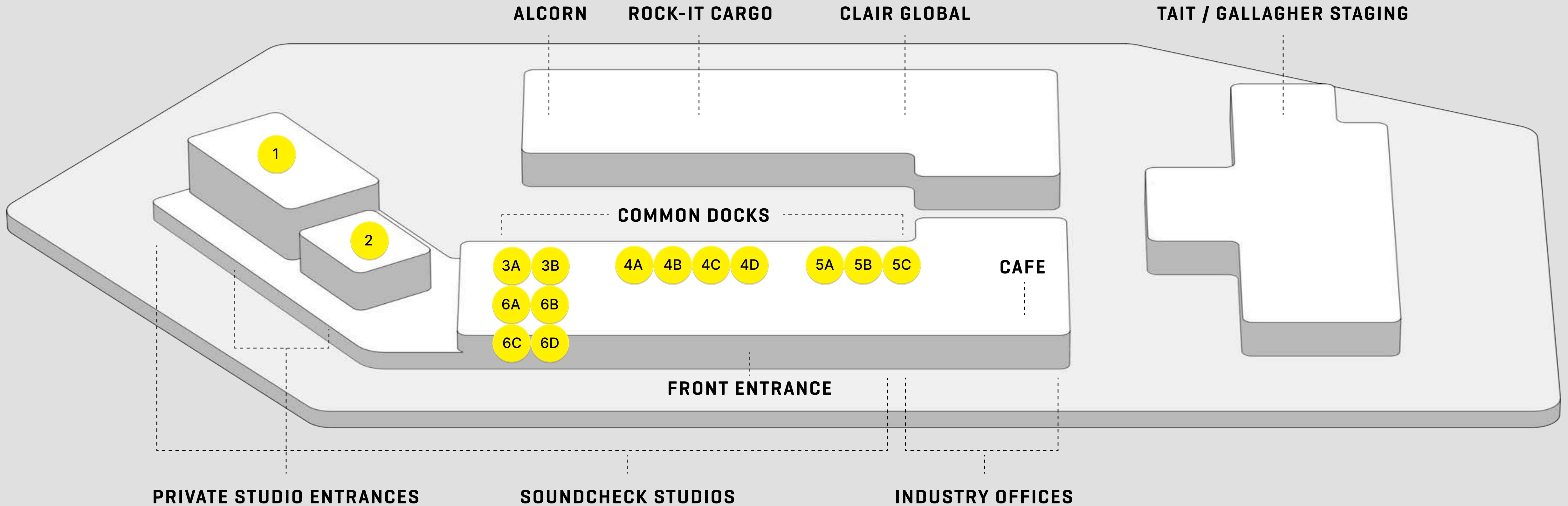

# Location

3200 Whites Creek Pike  
Nashville, TN 37207

The Rock Nashville campus is proud to join a vibrant music city in Nashville, TN. Located in the Whites Creek Pike neighborhood, just off the Briley Parkways, Rock Nashville is an easy drive from both the airport, and downtown.

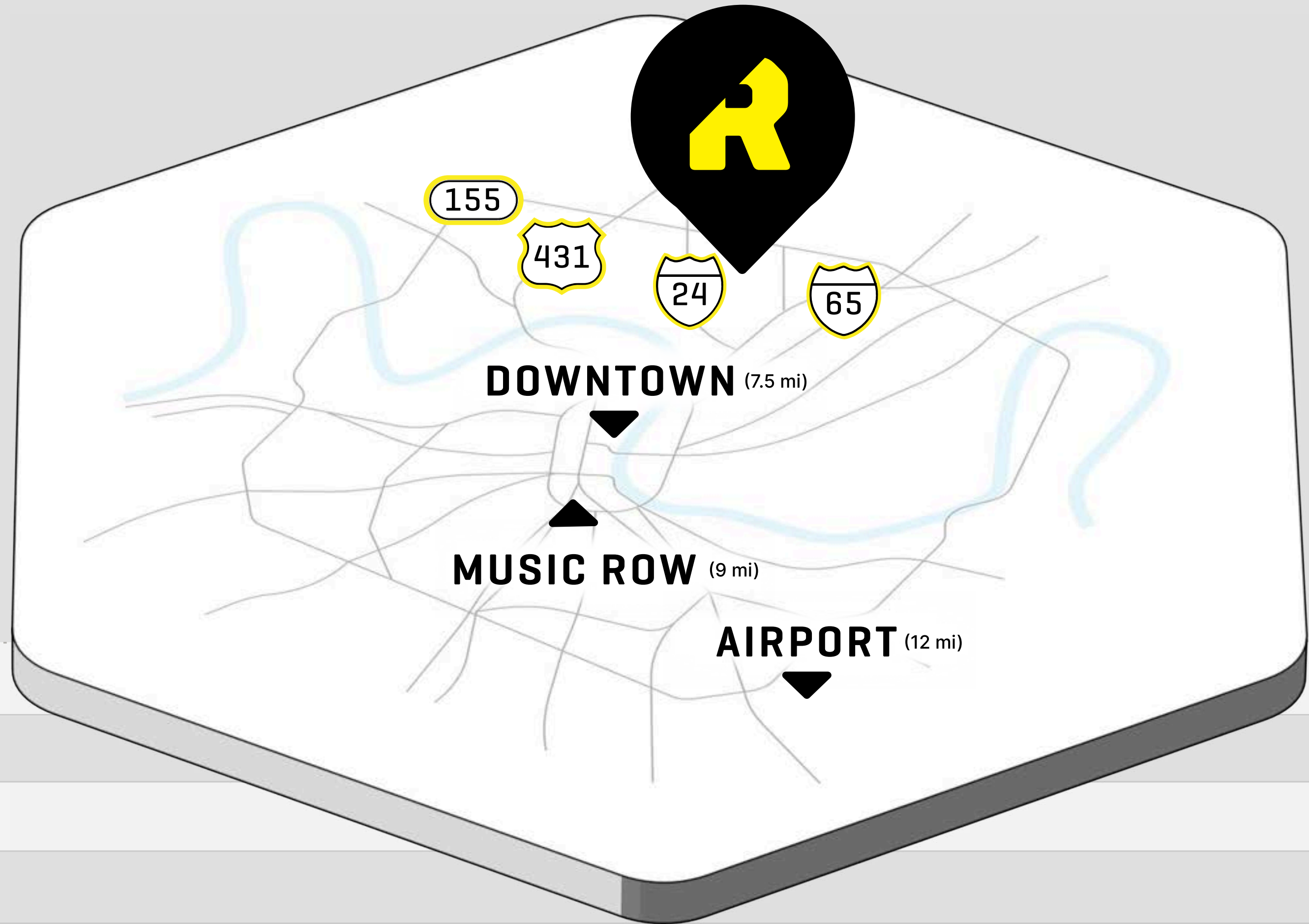

LOCATION	DISTANCE	BY CAR
BNA Airport	12 miles	17 minutes
Music Row	9 miles	20 minutes
Nissan Stadium	6 miles	15 minutes
Old Soundcheck Building	4 miles	10 minutes

# Areas of Impact



## → Rock Nashville Community

A membership-based network of live entertainment professionals, connecting across networks and skillsets to support a strong, vibrant industry.



## → Workforce LIVE

A non-profit committed to recruiting and retaining the next generation of live event pros by providing financial resources for programs and students.



## → Nashville Trainings

Partnering with other industry leaders, we host a variety of crew-focused trainings and certifications. Watch for opportunities located at Rock Nashville.

# Rock Nashville Community

The Rock Nashville Community unites live entertainment professionals across skillsets to support a strong, vibrant industry. Members gain access to tailored training, unique development opportunities, and a passionate network focused on creating unforgettable live experiences. Ask our team about become a member.



**Thank you**  
for your interest in  
Soundcheck Studios  
at Rock Nashville

---

Version 2.3  
04.03.26

Updated by:  
Bom Bom

615-726-1165  
[Booking@Soundchecknashville.com](mailto:Booking@Soundchecknashville.com)



**ROCK**  
**NASHVILLE**