

Soundcheck Studios at Rock Nashville: Technical Packet

Version 2.4
05.06.26

Updated by:
Bom Bom

615-726-1165
Booking@Soundchecknashville.com

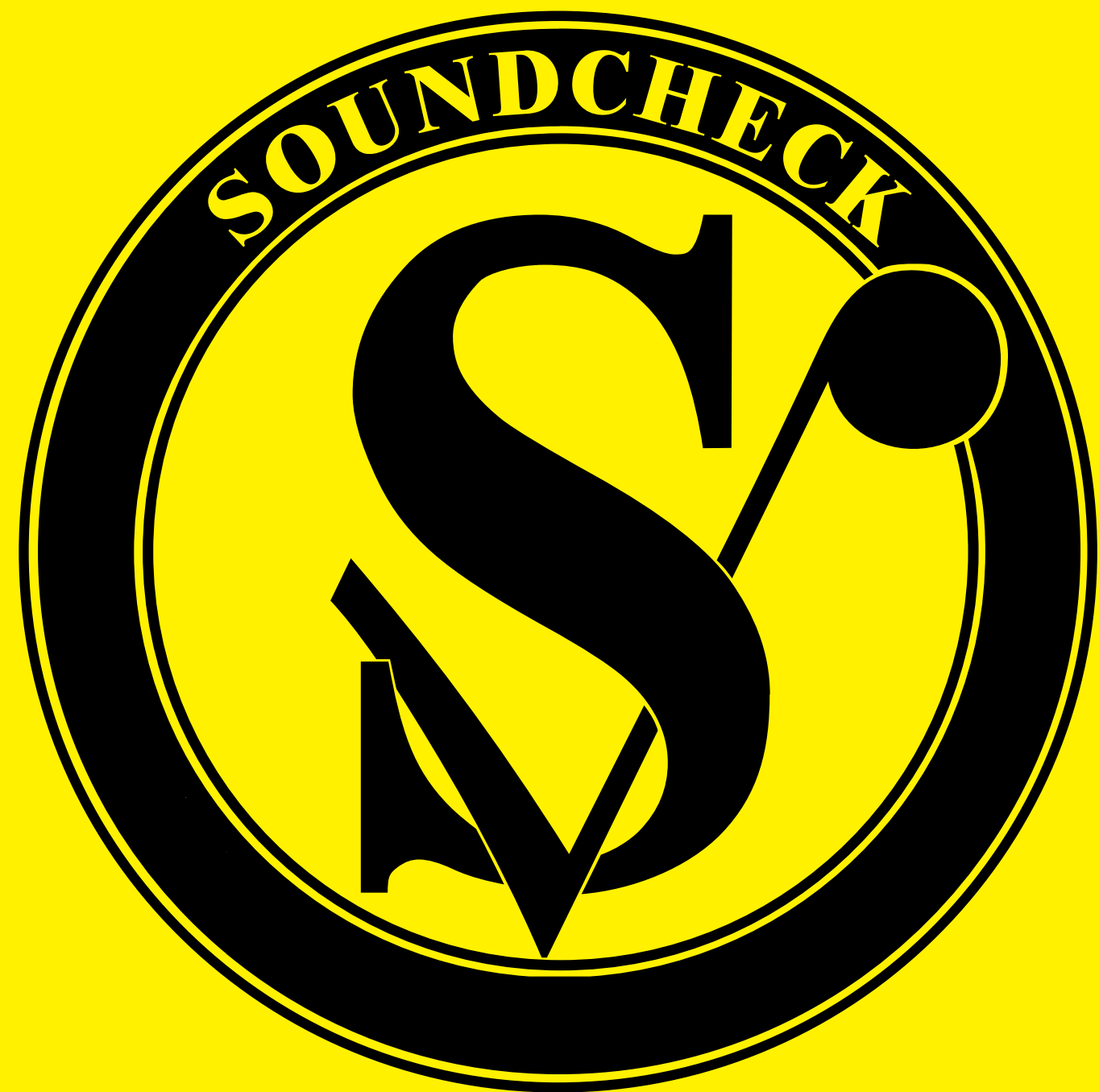

ROCK
NASHVILLE

Studios Overview

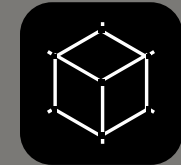

	1	2	3A 3B	4A 4B 4C 4D	5A 5B 5C	6A 6B 6C 6D
SQFT	26,445 sqft	12,177 sqft	5,390 sqft	3,350 sqft	2,400 sqft	560 sqft
DIMS	215' x 123'	123' x 99'	77' x 70'	67' x 50'	60' x 40'	28' x 20'
TRIM	80' to grid	65' to grid	27'5" to grid	26'11" to grid (AB Only)	32' to ceiling	12'4" to ceiling
RIGGING	900,000 lbs	500,000 lbs	80,000 lbs	39,000 lbs (AB Only)	N/A	N/A
AUDIO	N/A	N/A	FOH PA	FOH PA, Monitor System, FOH and Mon. Consoles	FOH PA, Monitor System, FOH and Mon. Consoles	Monitor System, Monitor Console
POWER	[7] 400A, 3Φ + [1] 200A, 3Φ	[4] 400A, 3Φ + [2] 200A, 3Φ	[1] 400A 3Φ [1] 200A 3Φ [1] 100A 3Φ [2] L21-30 services powering stage power and FOH PA	[2] 200A 3Φ [1] 100A 3Φ [2] L21-30 services powering stage power, MON power, and FOH PA	[1] 200A 3Φ [1] 100A 3Φ [2] L21-30 services powering stage power, MON power, and FOH PA	[4] 120V 20A Duplex Outlets [1] L21-30 30A services powering stage power, MON power



Studios 4 A B

Soundcheck Studios 4, Rooms A, B, C, + D are individual, flexible studio spaces for band and crews to rehearse. Opens to shared, common hall with 14 docks, load in through a 10' x 10' soundproof door.

DIMS	67' x 50'
SQFT	3,350 sqft
POWER	[2] 200A 3Φ 120/208V AC [1] 100A 3Φ 120/208V AC [2] L21-30 services powering stage power, MON power, and FOH PA

- AUDIO**
- Front of House**
- Flown PA: CO10 (80°) Cohesion Line Array - [3] per side
 - Ground stacked on carts: CP218-11+ Self-powered subwoofer - [1] per side
- Monitors**
- [8] CM-14 Cohesion wedges [1] CP-118 Cohesion Sub (Drum sub)
- Consoles**
- FOH: Yamaha DM7
 - Monitors: Yamaha DM7

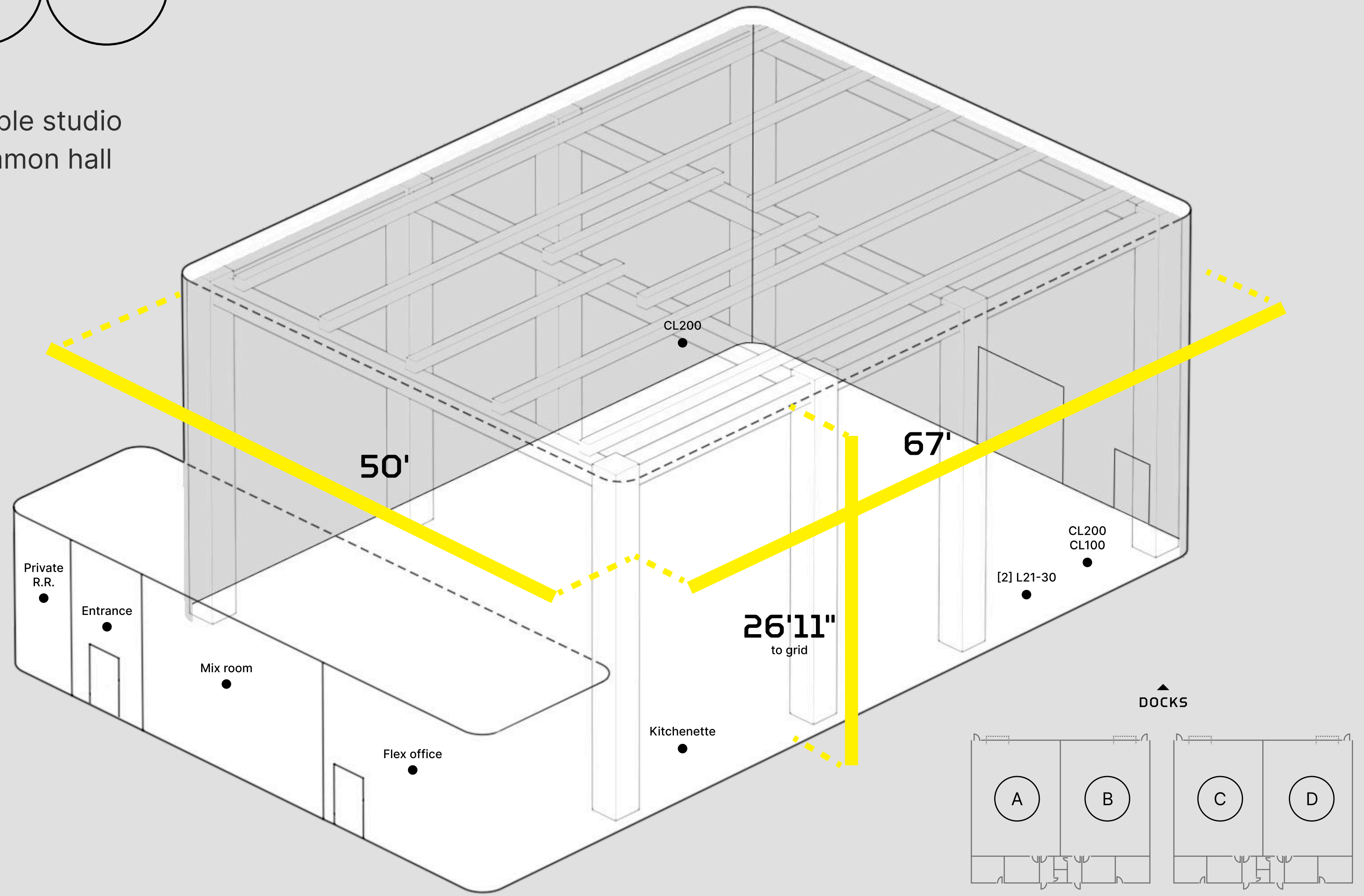

Studios 4A+4B Rigging

TO GRID	28'
TO CEILING	32'
TRUSS	20.5" Ground Support
MAX CAP	19.5 US Tons / 39,000 lbs

RIGGING LOAD LIMITS 4A/B - PLEASE READ

The listed maximum system capacity reflects the overall structural design and is not the allowable load for individual rigging points or truss members.

All show rigging must comply with the member-specific limits below:

- 12" Up/Down Spanner Runs: 1,000 lbs max per run
- 36" Cross-Stage Truss: 4,000 lbs total (distributed)

These capacities are not additive. Loading the 12" spanners and 36" cross-stage simultaneously affects the same structural system and must be reviewed as a combined load case.

All productions must submit a plot showing weight per point for review prior to load-in.

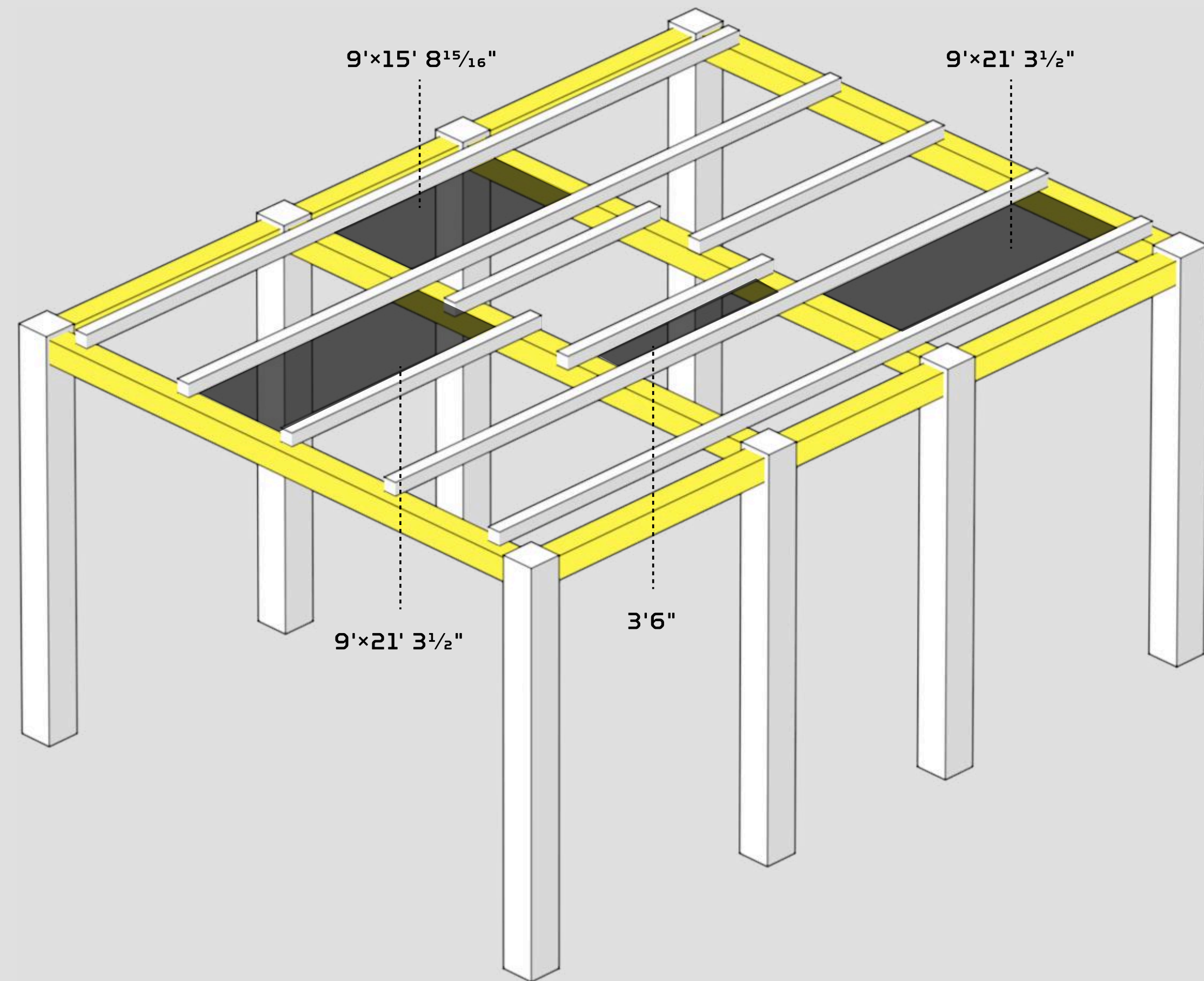

Studios 4 C D

Soundcheck Studios 4, Rooms A, B, C, + D are individual, flexible studio spaces for band and crews to rehearse. Opens to shared, common hall with 14 docks, load in through a 10' x 10' soundproof door.

DIMS	67' x 50'
SQFT	3,350 sqft
POWER	[2] 200A 3Φ 120/208V AC [1] 100A 3Φ 120/208V AC [2] L21-30 services powering stage power, MON power, and FOH PA

- AUDIO**
- Front of House**
- Flown PA: CO10 (80°) Cohesion Line Array - [3] per side
 - Ground stacked on carts: CP218-11+ Self-powered subwoofer - [1] per side
- Monitors**
- [8] CM-14 Cohesion wedges [1] CP-118 Cohesion Sub (Drum sub)
- Consoles**
- FOH: Yamaha DM7
 - Monitors: Yamaha DM7

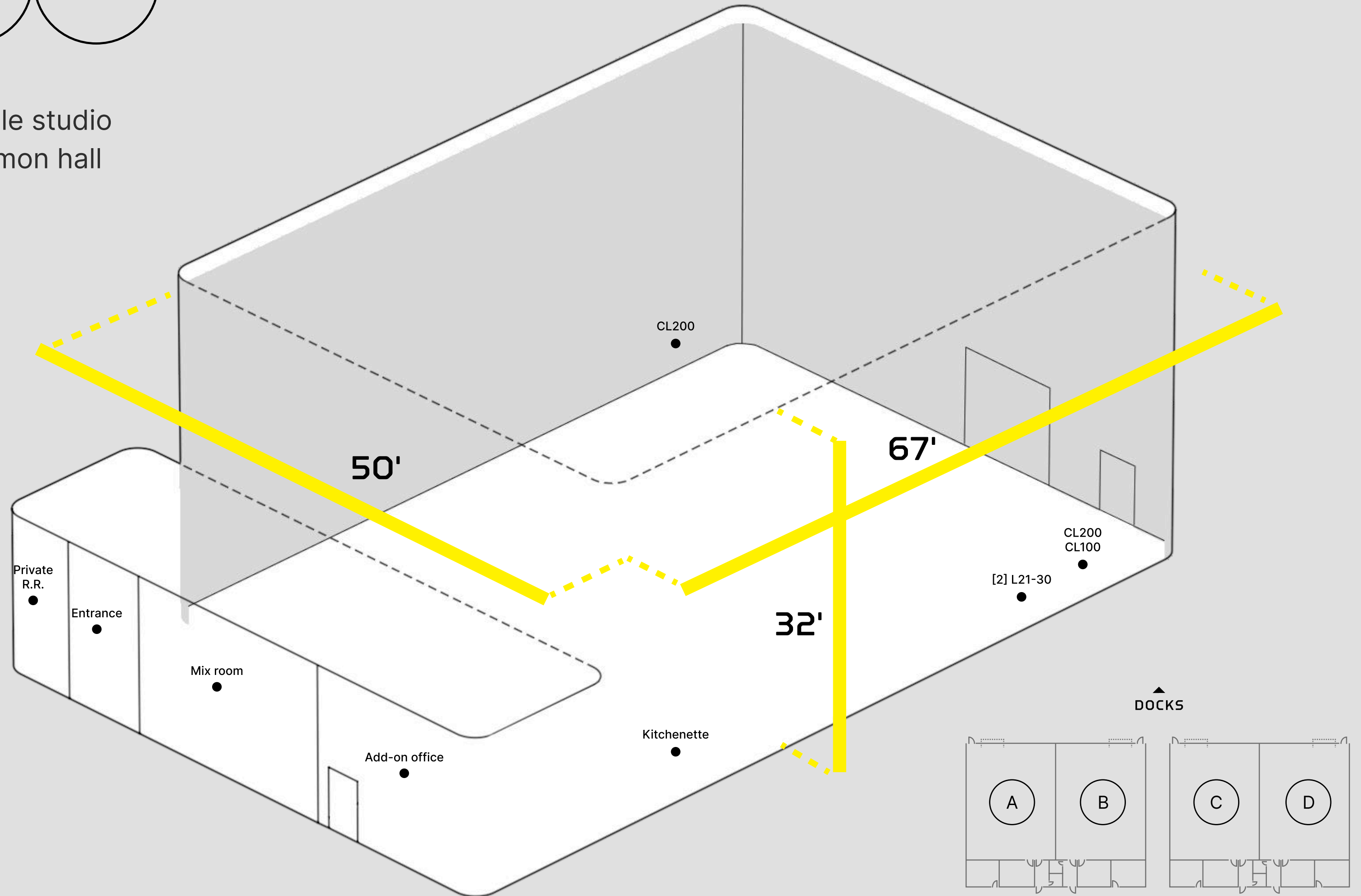

Common Dock



Parking Map

Please be mindful of traffic while on campus.
All trucks, please follow designated truck traffic as marked. Parking questions? Email Booking@Soundchecknashville.com

- Parking lot name
- Truck + bus traffic
- Local labor crew
- General parking
- Entrance

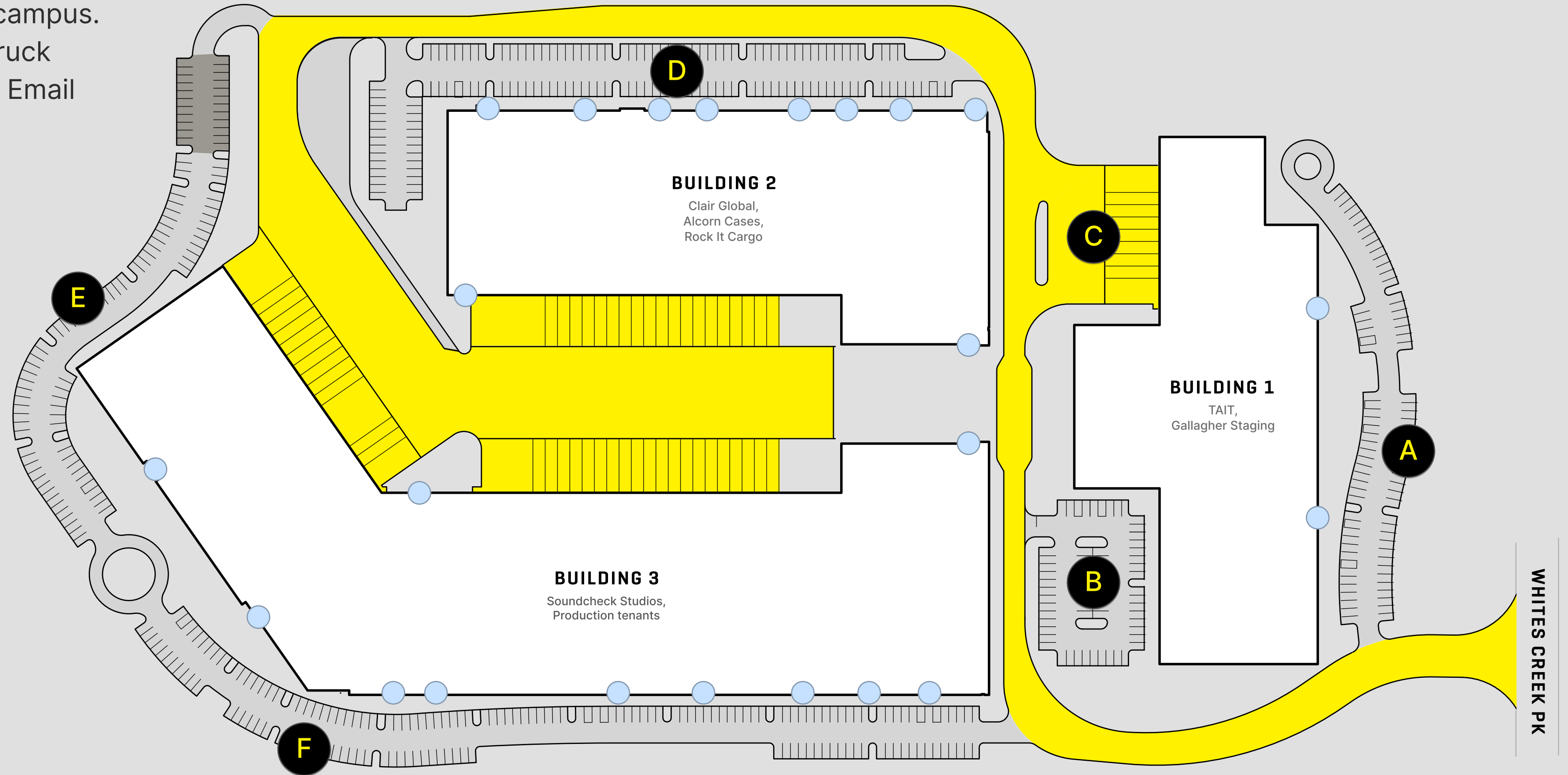

Additional Campus Services



→ Storage

Keep your gear close between gigs. Rock Nashville offers secure, on-site storage lockers in all sizes.



→ Backline + Cartage

Soundcheck offers quality backline rentals on-site, ready to support rehearsals, tours, and live events.



→ Coworking

Work from the Rock Nashville campus with a variety of shared industry and co-working space.



→ Trainings + More

Coordinate on-campus trainings and experiences (CPR, gear demos, team building etc) through the Community.

About Rock Nashville

Rock Nashville is a live entertainment campus offering purpose-designed rehearsal studios and industry-driving initiatives for a collaborative community of creative and technical live entertainment professionals.



Rock Nashville Campus

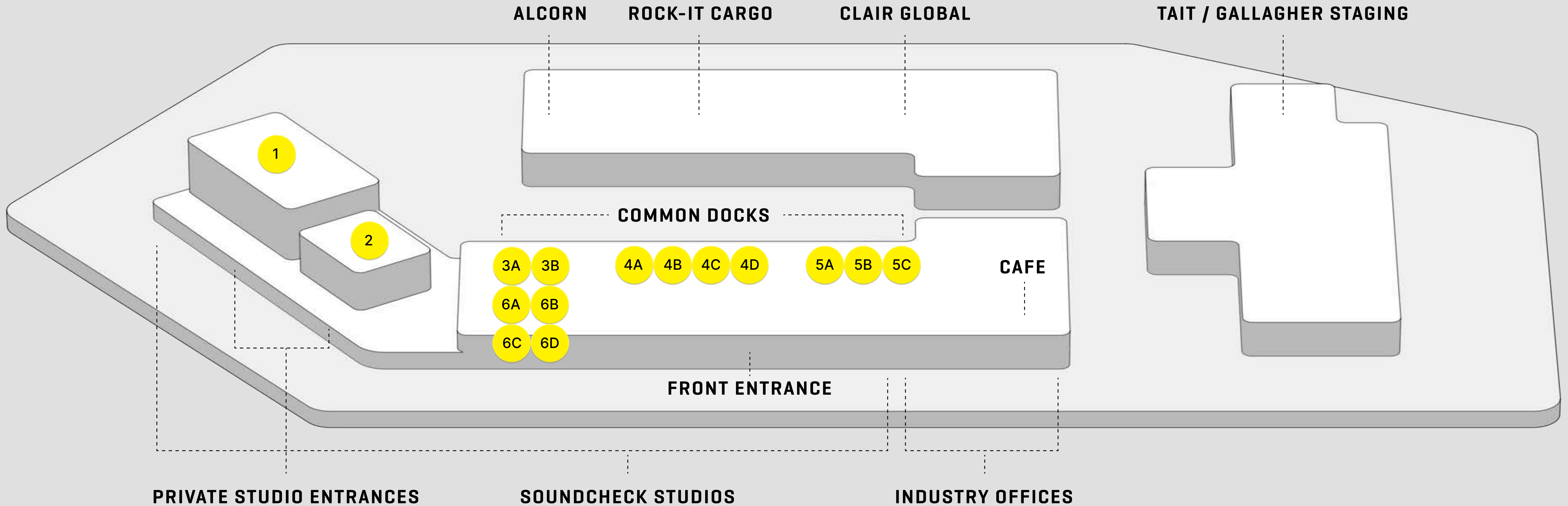

Location

3200 Whites Creek Pike
Nashville, TN 37207

The Rock Nashville campus is proud to join a vibrant music city in Nashville, TN. Located in the Whites Creek Pike neighborhood, just off the Briley Parkways, Rock Nashville is an easy drive from both the airport, and downtown.

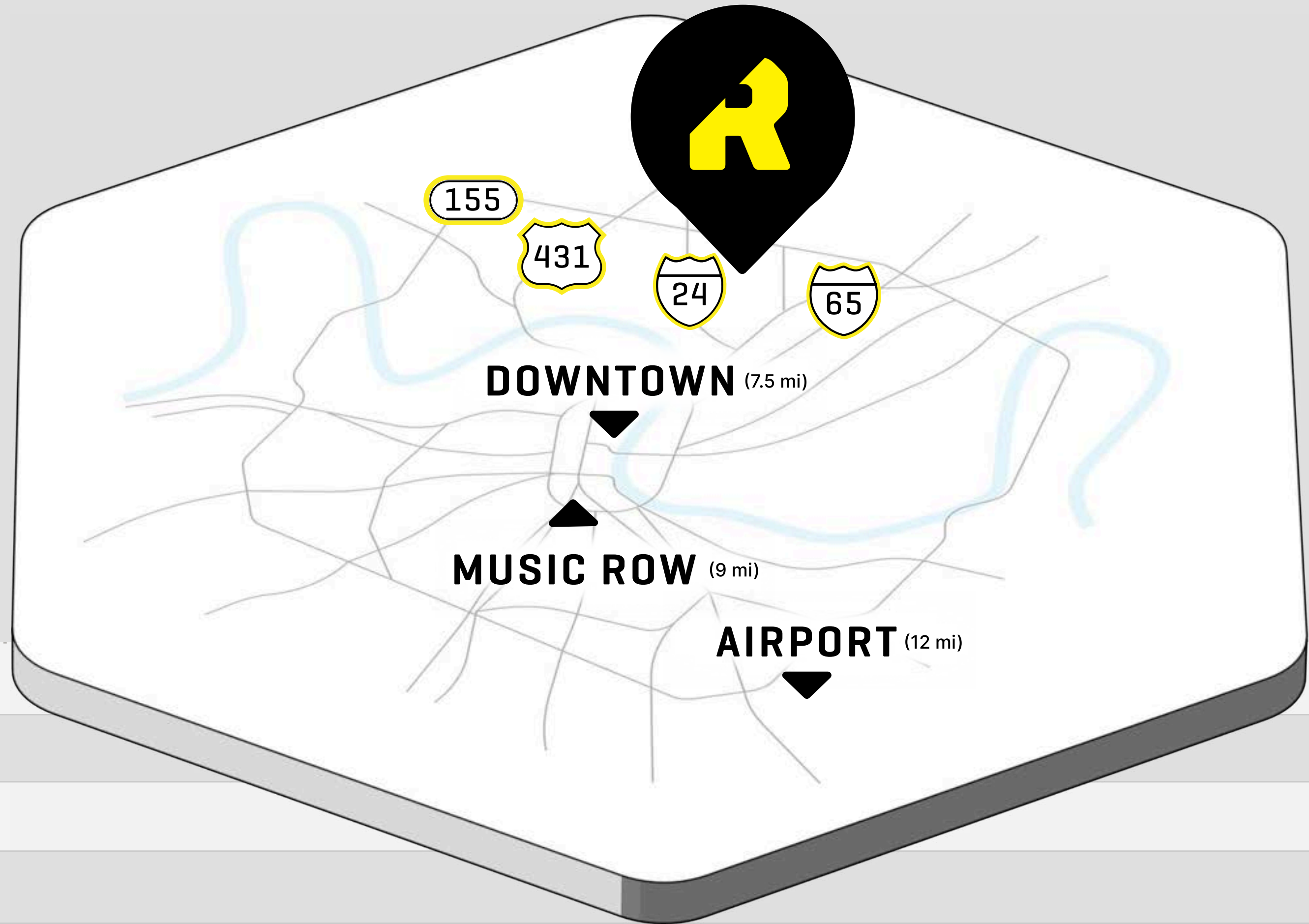

LOCATION	DISTANCE	BY CAR
BNA Airport	12 miles	17 minutes
Music Row	9 miles	20 minutes
Nissan Stadium	6 miles	15 minutes
Old Soundcheck Building	4 miles	10 minutes

Areas of Impact



→ Rock Nashville Community

A membership-based network of live entertainment professionals, connecting across networks and skillsets to support a strong, vibrant industry.



→ Workforce LIVE

A non-profit committed to recruiting and retaining the next generation of live event pros by providing financial resources for programs and students.



→ Nashville Trainings

Partnering with other industry leaders, we host a variety of crew-focused trainings and certifications. Watch for opportunities located at Rock Nashville.

Rock Nashville Community

The Rock Nashville Community unites live entertainment professionals across skillsets to support a strong, vibrant industry. Members gain access to tailored training, unique development opportunities, and a passionate network focused on creating unforgettable live experiences. Ask our team about become a member.



Thank you
for your interest in
Soundcheck Studios
at Rock Nashville

Version 2.4
05.06.26

Updated by:
Bom Bom

615-726-1165
Booking@Soundchecknashville.com



ROCK
NASHVILLE