



# Altitude

# Altitude 27



## Designer

Width: 14.63m      Depth: 16.19m

## Area Sizes

### Upper Level:

Living 183.38m<sup>2</sup>  
 Balcony 13.92m<sup>2</sup>  
 Sub Total 197.30m<sup>2</sup>

### Lower Level:

Living 10.03m<sup>2</sup>  
 Garage 36.98m<sup>2</sup>  
 Porch 2.11m<sup>2</sup>

TOTAL AREA 246.42m<sup>2</sup> / 26.52sq

## Lower Level

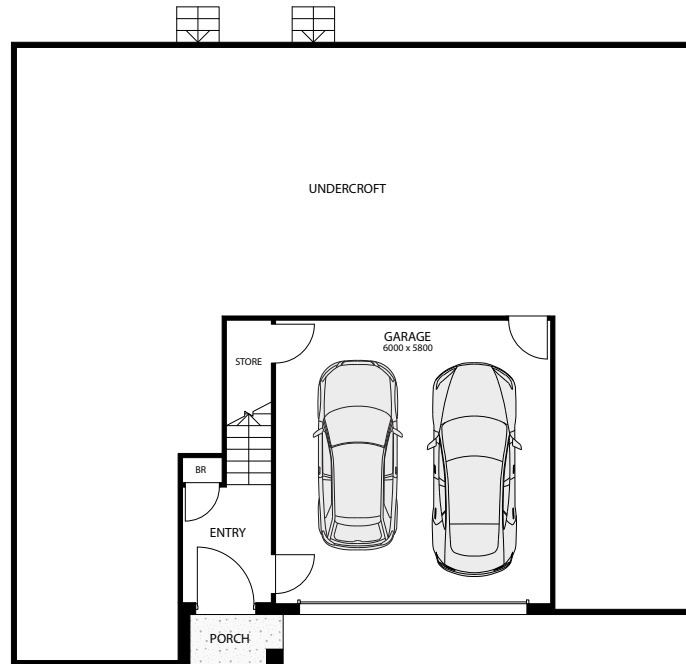

## Upper Level



Phone: (07) 5569 9400 / [enquiries@perryhomes.com.au](mailto:enquiries@perryhomes.com.au) / [perryhomes.com.au](http://perryhomes.com.au)

Plans, prices and inclusions are subject to variation without notice. Dimensions are approximate only. For more details please consult with your sales consultant. The copyright on all floor plans is owned by Perry Homes (Aust.) Pty Ltd. These floor plans may not be reproduced, copied or dealt with in any manner which infringes the exclusive rights of Perry Homes (Aust.) Pty Ltd. as prescribed by the Copyright Act 1968 without the express written authorisation of Perry Homes (Aust.) Pty Ltd. © Perry Homes (Aust.) Pty Ltd ABN 53 090 866 630. NSW Lic. No. 110970C. QBCC Act Lic. No. 718748. April 2026. 34979

# Altitude 27+



## Designer Plus

Width: 14.63m

Depth: 16.19m

## Area Sizes

### Upper Level:

Living 183.38m<sup>2</sup>

Balcony 13.92m<sup>2</sup>

Sub Total 197.30m<sup>2</sup>

### Lower Level:

Living 10.03m<sup>2</sup>

Garage 36.98m<sup>2</sup>

Porch 2.11m<sup>2</sup>

TOTAL AREA 246.42m<sup>2</sup> / 26.52sq

## Lower Level

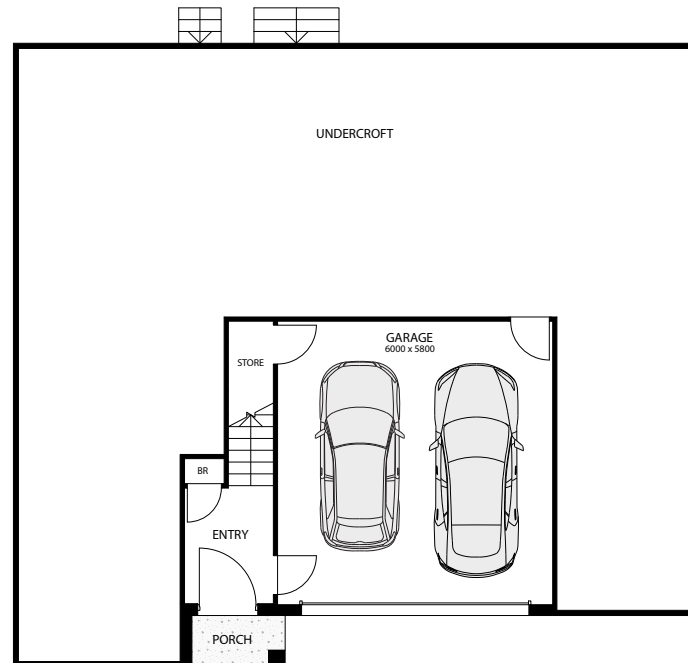

## Upper Level



**Perry Homes**

Built to inspire. Built for you.

Phone: (07) 5569 9400 / [enquiries@perryhomes.com.au](mailto:enquiries@perryhomes.com.au) / [perryhomes.com.au](http://perryhomes.com.au)

Plans, prices and inclusions are subject to variation without notice. Dimensions are approximate only. For more details please consult with your sales consultant. The copyright on all floor plans is owned by Perry Homes (Aust.) Pty Ltd. These floor plans may not be reproduced, copied or dealt with in any manner which infringes the exclusive rights of Perry Homes (Aust.) Pty Ltd. as prescribed by the Copyright Act 1968 without the express written authorisation of Perry Homes (Aust.) Pty Ltd. © Perry Homes (Aust.) Pty Ltd ABN 53 090 866 630. NSW Lic. No. 110970C. QBCC Act Lic. No. 718748. April 2026. 34979