

Keystone Pinch Clamp (Mechanical)- SAE Type "J" KSC

- All 300 series stainless steel pinch clamp featuring mechanical attachment for easy installation
- Provides a uniform, tamper evident seal
- Used on poly pipe, rigid plastic and soft hose
- Unique Keystone ear geometry and patented crimp lobes eliminates miscrimps during installation
- Most common applications are Poly Irrigation Lines, Water Supply, Fuel & Vapor Lines, Beverage Supply Lines, Car Wash Supply Lines, Dust Shields & Air Filters and Bundles of Cable.



Many of our Seamless (KVG) clamps offer our patented crimp lobe technology. This feature ensures that the crimping tool is properly positioned to help eliminate miscrimps which can result in leaks.



This clamp requires a tool to seal correctly, available from Murray. See Tools page near the back of this catalog for more details.



Base Part Number	"A" Diameter Range		Decimals	
	Min	Metric Max	Min	Max
KSC 3198*	16.6	19.8	.655	.780
KSC 3210*	17.9	21.0	.705	.830
KSC 3256*	22.5	25.6	.885	1.010
KSC 3271*	24.0	27.1	.945	1.070
KSC 3316*	28.5	31.6	1.120	1.245
KSC 3331*	30.0	33.1	1.180	1.300
KSC 3346*	31.5	34.6	1.240	1.360
KSC 3410*	37.9	41.0	1.490	1.615
KSC 3425*	39.4	42.5	1.550	1.675
KSC 3485*	45.5	48.5	1.787	1.910

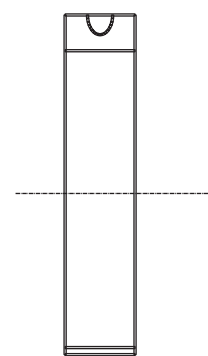
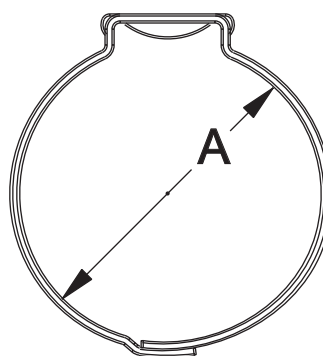

*Popular irrigation sizes are available for immediate shipment packaged in poly bags. Please inquire on availability of other packaging configurations and lead time for other sizes. Other sizes, shapes and materials are available upon request, subject to minimum order quantities

Full part number consists of base part number plus packaging suffix. Add 00C to end of base part number for bulk, or 00P100 to end of base part number if packed.



Email Your Purchase Order to orderentry@murraycorp.com