

2.1 - Kenosha SWEF

5/24/04

— Snow removal
 — Mowing

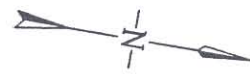

OR
 OR/EMITTER (HONEYWELL)
 AL

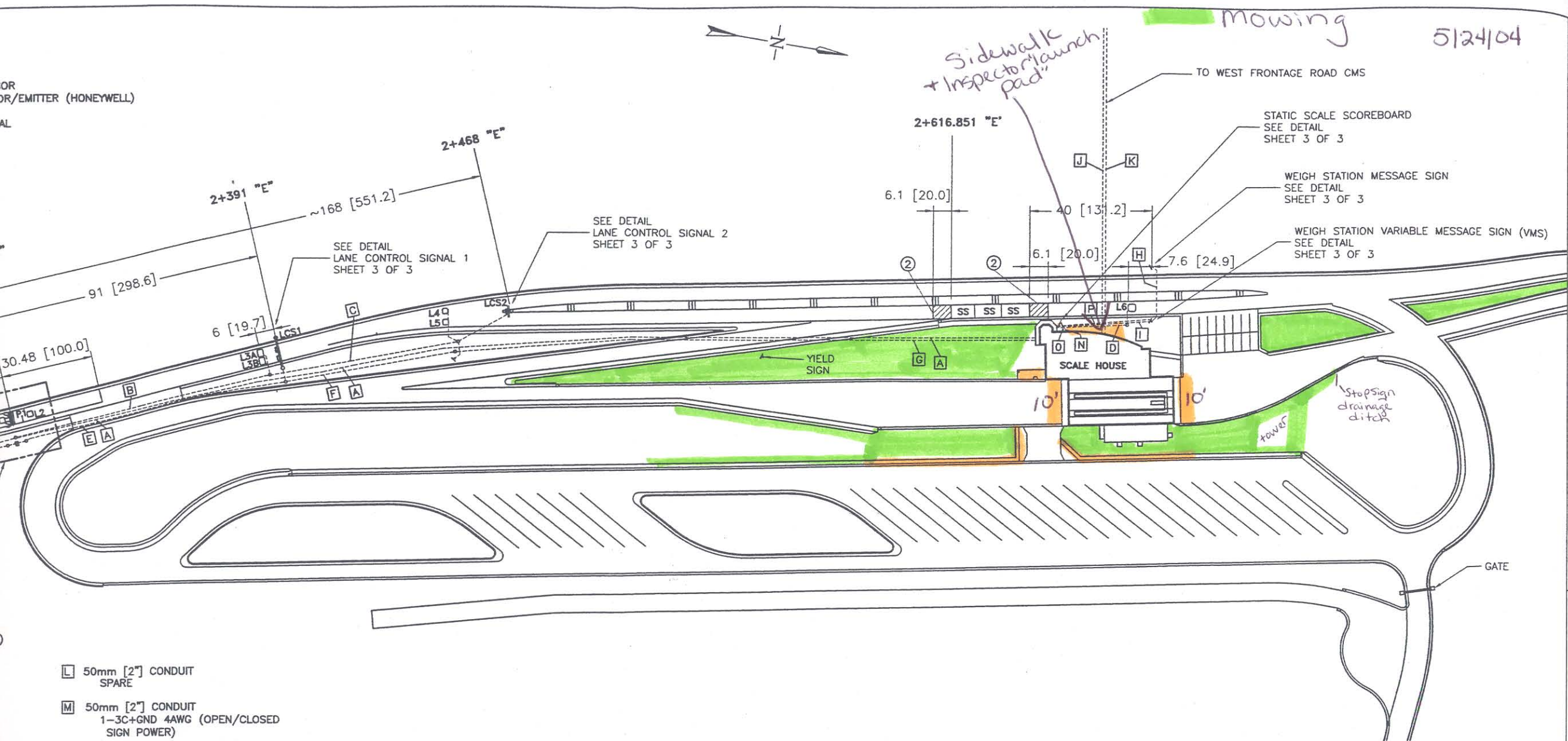

- [L] 50mm [2"] CONDUIT
SPARE
- [M] 50mm [2"] CONDUIT
1-3C+GND 4AWG (OPEN/CLOSED
SIGN POWER)
- [N] 50mm [2"] CONDUIT
1-4C 20AWG (SCOREBOARD COMMUNICATION)
- [O] 50mm [2"] CONDUIT
1-2C+GND 14AWG (SCOREBOARD POWER)
- [P] 50mm [2"] CONDUIT
1-8 STRAND F/O CABLE (VMS COMMUNICATION)

NOTES:

LOOP DETAILS:

LOOP #	SIZE	NUMBER OF TURNS
1	1.83m x 1.83m [6' X 6']	4